



Ace & Taylor[®]

H B 2 2 8 M A N U A L

WARNING!

Make sure that the hot surface of the device does not come into direct contact with the skin, eyes, ears, face and neck. Do not touch the hot air outlet and inlet during or after use.

USAGE

- Make sure the hair is combed through and tangle free.
- Turn on the device by pressing the button on the backside upwards.
- Set the desired temperature.
- Wait until the desired temperature is reached.
- Let the hair cool down before combing through.
- Let the appliance cool down before you put it away.

TEMPERATURE SETTINGS

If you have fine, thin, bleached or colored hair, use a lower temperature. If you have thicker hair, you can use a higher temperature. It is recommended that you always do a test before using for the first time to make sure you have selected the correct temperature for your hair type. Start with the lowest setting and increase the temperature until the desired result is achieved.

1. Cool button
2. Speed and temperature control button
3. Air inlet cover
4. Concentrator nozzles
5. Diffuser

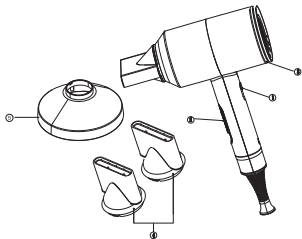

- The presence of a water source can be dangerous, even if the appliance is switched off. If you use the appliance in a bathroom, always remove the plug from the socket after use.
- To avoid a hazard, if the power supply cable is damaged, it must be replaced by the manufacturer or a person with similar expertise.
- If you experience any problems during use, remove the plug from the socket immediately.
- Never leave the dryer unattended when connected to the power supply.
- Avoid contact between the hot outlet and your skin, ears, eyes, face and neck.
- This hair dryer should not be used by persons with physical, sensory or mental disabilities.

END OF LIFE FOR ELECTRICAL AND ELECTRONIC APPLIANCES

In the interest of all and to actively participate in the protection of the environment and public health, we ask that you:

- Do not dispose of your products in the household waste.
- At the end of the life of this dryer, it must be collected separately.
- By disposing of this product correctly, you will help to avoid possible negative consequences for the environment and human health due to potentially hazardous substances that may be incorporated into the dryer.

If you would like more information on how to dispose of this product, please contact your local household waste disposal service.

www.aceandtaylor.com



TECHNICAL SPECIFICATIONS

- Professional AC motor – 1800 – 2000 W
- Single voltage – 110V/60Hz and 220V/50Hz
- 3 heat settings, 2 speed settings and one cool setting
- 2.5 meter swivel chord with safety plug
- Intended for household, hotel and professional use

CLEANING INSTRUCTIONS

Remove the cover as indicated in the picture and clean the ventilating filter using a damp cloth.

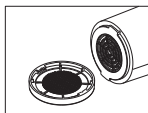

www.aceandtaylor.com





THANKS FOR CHOOSING US

Distributed by
DAJA Logistics
Huigensstraat 2
Gendt 6691EL
The Netherlands
[Not for returns]