



## User Manual M618XSU

Thank you for choosing DELUX SEEKER, please read all instructions thoroughly before beginning the installation.

### SYSTEM

Windows7/Windows8/Windows10/ MacOS

### FUNCTIONS

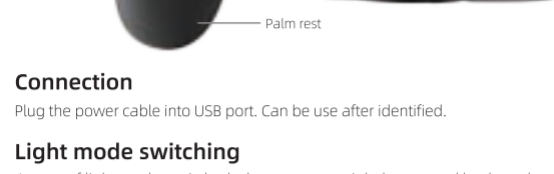

### Connection

Plug the power cable into USB port. Can be use after identified.

### Light mode switching

4 types of light can be switched when you press right button and backward button at the same time.

### DPI switching

Tap DPI button to switch the DPI.

800 (red light) -1200 (green light) -1600 (blue light) -2400 (purple light) -4000 (yellow light)

Switching DPI successfully when the corresponding light flashed twice.

Default DPI:1200(600-4000)

1.

### Report rate

125Hz-250Hz-500Hz-1000Hz,

Default 500Hz, can be changed by the driver.

### Thumb scroll wheel

Rolling up→Moving to the left

Rolling down→Moving to the right

(can be used in office software, browser, etc.)

### Driver installation

#### 1、Installation

Download from DELUX website: [www.deluxworld.com](http://www.deluxworld.com)

#### 2、Setting

Opening the driver (when using the mouse) to set the functions.

##### A、Multi-group file configuration

Click "+" on the top-left of the interface to create a new configuration file.

Click  The current configuration file can be deleted.

Click  The current configuration file can be copied.

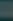
Click  The current configuration file can be renamed.

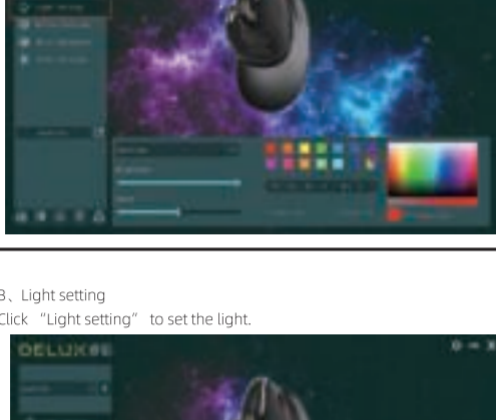

2.

##### B、Light setting

Click "Light setting" to set the light.



3.

##### C、Button setting

Click "Button settings" to set the buttons.

Click  after all settings done.



4.

##### D、Macro management

Click "Macro management" to set the Macro.

Click "+" to create a new Macro, then click "REC" to record. Entering the key that you need on the keyboard when recording. Click "STOP" to stop the Macro recording.

Import Macro instruction:select the button you need to set, then click

"Macro function" to choose Macro name, then click "save" to complete the setting.

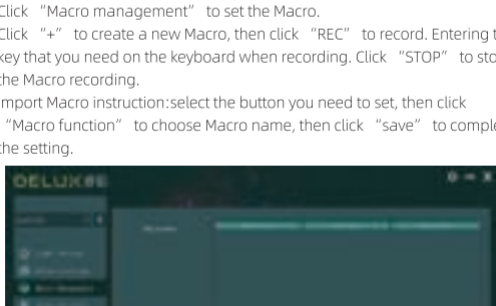

5.

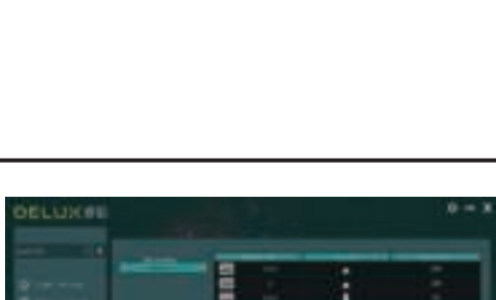

##### E、DPI setting

Click "Other settings" to set the DPI.

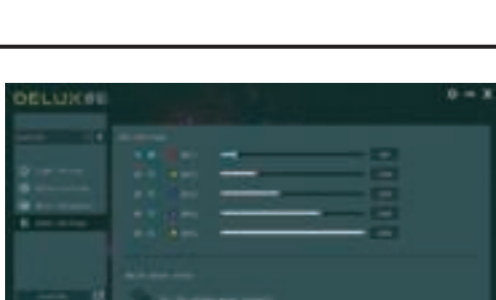
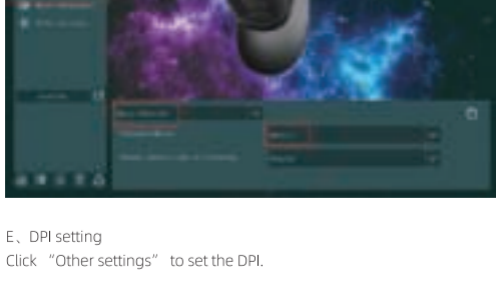

6.

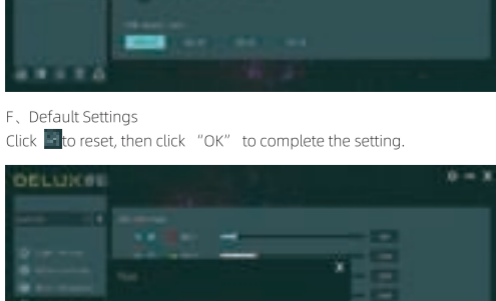

##### F、Default Settings

Click  to reset, then click "OK" to complete the setting.



7.