

# **Handleiding Vaatwasmachine**

# **Exquisit EGSP2112.1E**

## **Deel 2 Snelstartgids**

Lees deze handleiding goed door voordat u de afwasmachine gebruikt.  
Bewaar deze gebruiksaanwijzing voor toekomstig gebruik.

# || INHOUD

	<b>4</b>	<b>UW VAATWASMACHINE GEBRUIKEN</b>
	4	Bedieningspaneel
	6	Wateronthardingsniveau instellen
01	7	Vaatwerk voorbereiden en inladen
	10	Functie glansspoelmiddel en vaatwasmiddel
	11	Glansspoelmiddelreservoir vullen
	12	Vaatwasmiddelreservoir vullen
	<b>13</b>	<b>VAATWASMACHINEPROGRAMMA INSTELLEN</b>
	13	Overzicht vaatwasprogramma's
02	14	Een programma starten
	14	Ingestelde programma tussentijds wijzigen
	15	Tussentijds extra vaatwerk inladen?
03	<b>16</b>	<b>FOUTMELDINGEN</b>
04	<b>17</b>	<b>TECHNISCHE GEGEVENS</b>



## **OPMERKING:**

- Door het hoofdstuk van de tips voor probleemoplossingen in Handleiding Deel 1 te bekijken kunt u enige algemene vraagstukken zelf oplossen.
- Als u de problemen niet zelf kunt oplossen, dient u de hulp in te roepen van professionele technici.
- De fabrikant volgt een beleid van voortdurende ontwikkeling en vernieuwing van het product en behoudt zich daarom het recht voor om wijzigingen aan te brengen zonder voorafgaande kennisgeving .
- Deze gebruiksaanwijzing is ook verkrijgbaar via de fabrikant of de verantwoordelijke leverancier.















## Bovenkorf laden

De bovenkorf is ontworpen voor het plaatsen van delicaat en lichter vaatwerk zoals glazen, koffie- en theebehaltes en schotels, maar ook borden, kleine kommen en ondiepe pannen (zolang deze niet te vuil zijn). Plaats de schalen en het kookgerei zo zodat ze niet worden verplaatst door de waterstraal.



## Onderkorf laden

Wij raden u aan om grote en moeilijk te reinigen items in de onderkorf te plaatsen: zoals potten, pannen, deksels, serveerschalen en kommen, zoals weergegeven in bijgaande afbeelding. Het heeft de voorkeur om serveerschalen en deksels aan de zijkant van de rekken te plaatsen om te voorkomen dat het ronddraaien van de bovenste sproeiarm wordt verhinderd. De max. diameter voor borden die voor het vaatwasmiddelreservoir worden geplaatst, is 19 cm. Dit om het openen van de vaatwasmiddelreservoir niet te belemmeren.

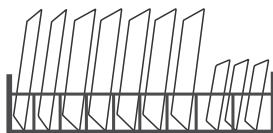

## Bestekkorf laden

Bestek moet apart van elkaar in het bestekrek worden geplaatst op de juiste posities. Zorg ervoor dat het bestek niet in/tegen elkaar nestelt, dit kan leiden tot slechte reinigingsresultaten.

### ⚠ LET OP!



Laat geen enkel item door de onderzijde van de korf uitsteken!

Laad scherpe en/of puntige items **ALTIJD** met de punt naar beneden in !



Voor optimale reinigingsresultaten, laad u de korven volgens de aangegeven richtlijnen in, zie Handleiding Deel 1, Hoofdstuk 7.



# Glansspoelmiddelreservoir vullen

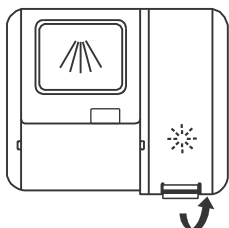

- 1 Haal het afdekkapje los door deze op te lichten

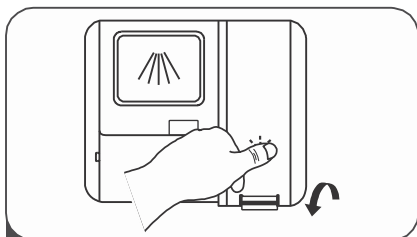

- 3 Sluit het afdekkapje

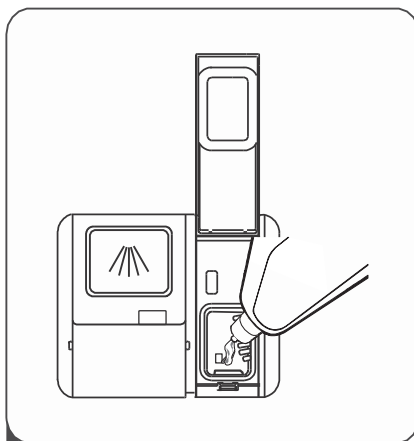

- 2 Schenk voorzichtig en langzaam glansspoelmiddel in het reservoir; pas op: doe niet te vol

## Doseerafgifte glansspoelmiddel instellen

Voor een zo optimaal droogresultaat met een minimale hoeveelheid glansspoelmiddel is de machine zo uitgerust dat u de dosering van de afgifte zelf kunt instellen. Volg hiervoor onderstaande stappen.

1. **Steek de stekker in het stopcontact;**
2. Binnen 60 sec. na stap 1, druk 6 sec. op de **SNEL** knop en druk dan op de Startuistel knop om het instellingsproces te starten. Het Spoelmiddel symbool knippert.
3. **Druk op de SNEL knop om de juiste stand in te stellen gebaseerd op uw gebruiksomstandigheden.**  
De volgende standen zijn mogelijk: D1->D2->D3->D4->D5->D1, D5 geeft de hoogste afgiftedosis af. De fabrieksinstelling is D3.
4. **Wanneer u 5 sec. geen handeling verricht of u drukt op de Aan/Uit knop om het instelproces te verlaten, dan is uw keuze ingesteld.**

Instelling	Hoeveelheid glansspoelmiddel (ml)
D1	1.2
D2	2.4
D3	3.6
D4	4.8
D5	6.0

# Vaatwasmiddelreservoir vullen

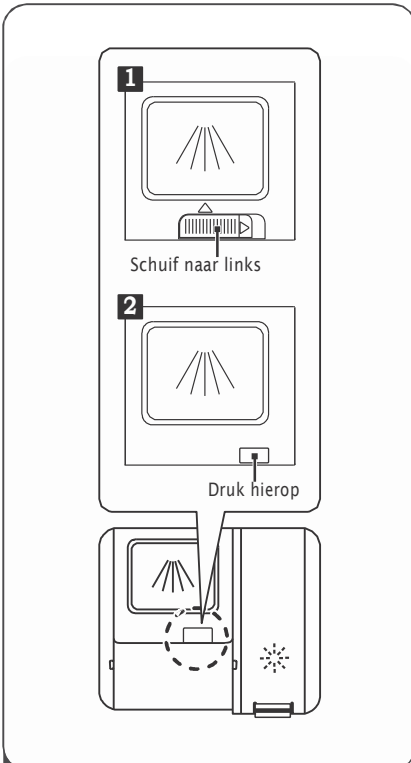

**1** Kies de manier die overeenkomt met uw machine.

**1. Ontgrendel de afdekkap door de sluiting te schuiven.**

**2. Ontgrendel de afdekkap door op de sluiting te drukken.**

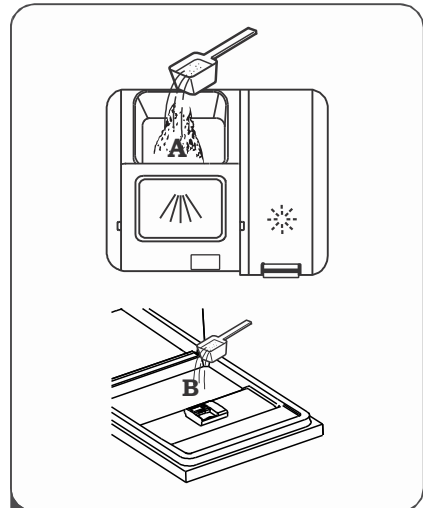

Doe het vaatwasmiddel in het grote bakje A) voor de hoofdwas fase . Voor een beter reinigingsresultaat, vooral als er zeer vuile items in staan, giet u een kleine hoeveelheid extra vaatwasmiddel op de deur. Het extra vaatwasmiddel wordt tijdens de voorwas fase geactiveerd.

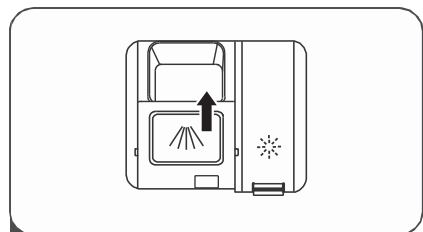

Sluit de afdekkap door deze naar voren te schuiven en naar beneden te drukken.

## **OPMERKING:**





- Let op: afhankelijk van de vervuiling van het water kan de instelling anders zijn.
- Neem de aanbevelingen van de fabrikant op de verpakking van het wasmiddel in acht.

# Vaatwasmachineprogramma instellen

## Overzicht vaatwasprogramma's

In onderstaande tabel ziet u welke programma's geschikt zijn voor welke vervuilingsgraad met voedselresten en hoeveel vaatwasmiddel er nodig is. U ziet ook extra informatie over de programma's.

(●) Betekent: Glansspoelmiddel bijvullen in reservoir

Programma	Beschrijving van cyclus	Vaatwasmiddel Voor/Hoofd	Tijdsduur (min)	Energie (Kwh)	Water (L)	Glansspoelmiddel
 <b>Intensief</b>	Voorwas(50C)					
	Was(65C)					
	Spoelen	5/25g	205	1.621	17.8	●
	Spoelen	(1 of 2 stuks)				
	Spoelen65C Drogen					
 <b>Standaard</b>	Voorwas(45C)					
	Was(55C)					
	Spoelen	5/25g	175	1.302	14.3	●
	Spoelen(65C) Drogen	(1 of 2 stuks)				
<b>ECO</b> (*EN50242)	Was(45C)					
	Spoelen	5/25g	220	0.908	11.0	●
	Spoelen(60C) Drogen	(1 of 2 stuks)				
 <b>Glas</b>	Voorwas					
	Was(50C)					
	Spoelen	5/25g	120	1.100	14.3	●
	Spoelen(65C) Drogen	1 stuks				
 <b>90 Min</b>	Was(60C)					
	Spoelen	30g	90	1.350	11.7	●
	Spoelen(65C)	1 stuks				
	Drogen					
 <b>Snel</b>	Wassen(50C)					
	Spoelen	25g	30	0.751	11.2	○
	Spoelen(45C)					





### OPMERKING :

EN50242: Dit programma is de testcyclus. De informatie voor de vergelijkbaarheidstest in overeenstemming met EN50242.

# ● Overzicht vaatwasprogramma's

In onderstaande tabel ziet u welke programma's geschikt zijn voor welke vervuilingsgraad met voedselresten en hoeveel vaatwasmiddel er nodig is. U ziet ook extra informatie over de programma's.

(●) Betekent: Glansspoelmiddel bijvullen in reservoir

Programma	Omschrijving van cyclus	Vaatwasmiddel Voor/Hoofd	Tijdsduur (min)	Energie (Kwh)	Water (L)	Glansspoelmiddel
 Intensief	Voorwas(50C) Was(65C) Spoelen Spoelen Spoelen65C Drogen	$\frac{4/16g}{(1 \text{ of } 2 \text{ stuks})}$	205	1.621	17.8	●
 Standaard	Voorwas(45C) Was(55C) Spoelen Spoelen(65C) Drogen	$\frac{4/16g}{(1 \text{ of } 2 \text{ stuks})}$	175	1.302	14.3	●
ECO (*EN60436)	Was(45C) Spoelen Spoelen(60C) Drogen	$\frac{4/16g}{(1 \text{ of } 2 \text{ stuks})}$	220	0.923	11.0	●
 Glas	Voorwas Was(50C) Spoelen Spoelen(65C) Drogen	$\frac{4/16g}{(1 \text{ of } 2 \text{ stuks})}$	120	1.100	14.3	●
 90 Min	Was(60C) Spoelen Spoelen(65C) Drogen	$\frac{20g}{(1 \text{ stuks})}$	90	1.350	11.7	●
 Snel	Was(50C) Spoelen Spoelen(45C)	$\frac{20g}{(1 \text{ of } 2 \text{ stuks})}$	30	0.751	11.2	○

## 💡 OPMERKING:

**EN60436:** Dit programma is de testcyclus. De informatie voor de vergelijkbaarheidstest in overeenstemming met EN60436.















## Product fiche (EN50242)

Sheet of household dishwasher according to EU Directive 1016/2010 & 1059/2010:

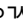
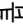
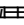
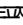
Manufacturer	Exquisit EGSP2112.1E
Type / Description	        
Standard place settings	12
Energy efficiency class <b>1</b>	A++
Annual energy consumption <b>2</b>	258 kWh
Energy consumption of the standard cleaning cycle	0,908 kWh
Power consumption of off-mode	0,45 W
Power consumption of left-on mode	0,49W
Annual water consumption <b>3</b>	3080 liter
Drying efficiency class <b>4</b>	A
Standard cleaning cycle <b>5</b>	ECO 45°C
Program duration of the standard cleaning cycle	220 min
Noise level	49 dB(A) re 1 pW
Mounting	Built-in
Could be built-in	YES
Power consumption	1 760-2100W
Rated voltage / frequency	220-240V/50Hz
Water pressure (flow pressure)	0,04-1,0MPa=0,4-10 bar

### NOTE :

- 1** A + + + (highest efficiency) to D (lowest efficiency)
- 2** Energy consumption based on 280 standard cleaning cycles using cold water fill and the consumption of the low power modes. Actual energy consumption will depend on how the appliance is used.
- 3** Water consumption based on 280 standard cleaning cycles. Actual water consumption will depend on how the appliance is used.
- 4** A (highest efficiency) to G (lowest efficiency)
- 5** This program is suitable for cleaning soiled normally soiled tableware and that it is the most efficient program in terms of its combined energy and water consumption for that type of tableware.

# Product information sheet (EN60436)

Supplier's name or trade mark: 

Supplier's address see page 21

General product parameters:

Parameter	Value	Parameter	Value	
Rated capacity <sup>(a)</sup> (ps)	12	Dimensions in cm	Height	81,5
			Width	59,8
			Depth	55,0
EEI <sup>(a)</sup>	55,9	Energy efficiency class <sup>(a)</sup>	E ( ) <sup>c</sup>	
Cleaning performance index <sup>(a)</sup>	1,13	Drying performance index <sup>(a)</sup>	1,07	
Energy consumption in kWh [per cycle], based on the eco programme using cold water fill. Actual energy consumption will depend on how the appliance is used.	0,923	Water consumption in litres [per cycle], based on the eco program. Actual water consumption will depend on how the appliance is used and on the hardness of the water.	11,0	
Program duration <sup>(a)</sup> (h:min)	3:40	Type	Built-in	
Airborne acoustical noise emissions <sup>(a)</sup> (dB(A) re 1 pW)	49	Airborne acoustical noise emission class <sup>(a)</sup>	C ( ) <sup>c</sup>	
Off-mode (W)	0,49	Standby mode (W)	N/A	
Delay start (W) (if applicable)	1,00	Networked standby (W) (if applicable)	N/A	

**Minimum duration of the guarantee offered by the supplier <sup>(b)</sup>:**

**Additional information:**

Weblink to the supplier's website, where the information in point 6 of Annex II to Commission Regulation (EU) 2019/2022 <sup>(1)</sup> (b) is found:

(a) for the eco program.

(b) changes to these items shall not be considered relevant for the purposes of paragraph 4 of Article 4 of Regulation (EU) 2017/1369.

(c) if the product database automatically generates the definitive content of this cell the supplier shall not enter these data.

(1) Commission Regulation (EU) 2019/2022 of 1 October 2019 laying down eco design requirements for household dishwashers pursuant to Directive 2009/125/EC of the European Parliament and of the Council amending Commission Regulation (EC) No 1275/2008 and repealing Commission Regulation (EU) No 1016/2010 (see page 267 of this Official Journal).



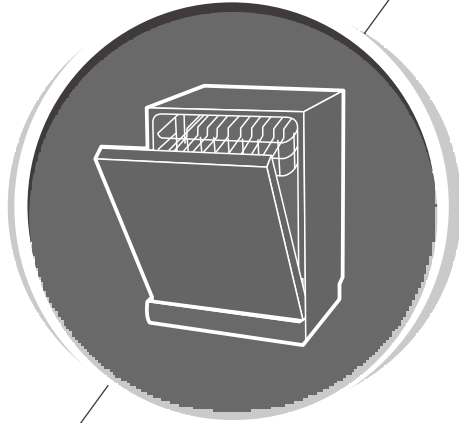

# **Dishwasher** Instruction Manual

## **PART II**

Please read this manual carefully  
before using the dishwasher and  
Keep this manual for future reference.

# CONTENTS

01	<b>4</b>	<b>USING YOUR DISHWASHER</b>
	<b>4</b>	Control Panel
	<b>6</b>	Water Softener
	<b>7</b>	Preparing And Loading Dishes
	<b>10</b>	Function Of The Rinse Aid And Detergent
02	<b>11</b>	Filling The Rinse Aid Reservoir
	<b>12</b>	Filling The Detergent Dispenser
	<b>13</b>	<b>PROGRAMMING THE DISHWASHER</b>
	<b>13</b>	Wash Cycle Table
	<b>14</b>	Starting A Cycle Wash
03	<b>14</b>	Changing The Program Mid-cycle
	<b>15</b>	Forget To Add A Dish?
	<b>16</b>	<b>ERROR CODES</b>
04	<b>17</b>	<b>TECHNICAL INFORMATION</b>



## NOTE:

- If you cannot solve the problems by yourself, please ask for help from a professional technician.
- The manufacturer, following a policy of constant development and updating of the product, may make modifications without giving prior notice.
- If lost or out-of-date, you can receive a new user manual from the manufacturer or responsible vendor.

# QUICK USER GUIDE

Please read the corresponding content on the instruction manual for detailed operating method.

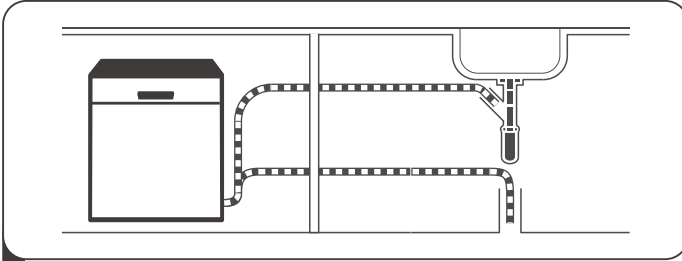

- 1 Install the dishwasher  
**(Please check the section 5 "INSTALLATION INSTRUCTION" of PART I :Generic Version.)**



- 2 Removing the larger residue on the cutlery

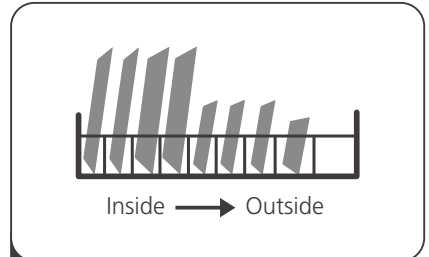

- 3 Loading the baskets

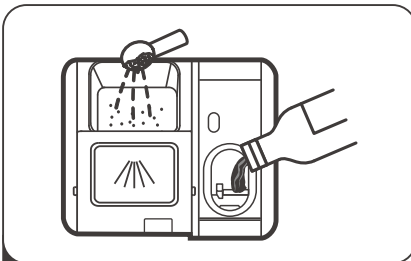

- 4 Filling the dispenser



- 5 Selecting a program and running the dishwasher





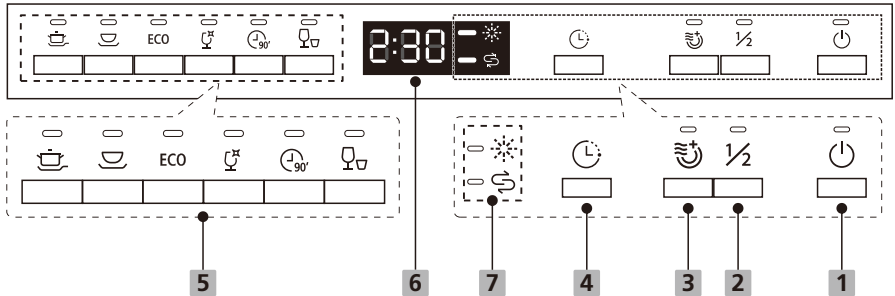

# USING YOUR DISHWASHER

## Control Panel





### Operation (Button)

<b>1 Power</b>	Press this button to turn on your dishwasher, the screen lights up.
<b>2 Half-load</b>	When you have about or less than half of full place setting dishware to wash, you can choose this function to save energy and water. (It can be used programs except rapid)
<b>3 Extra Drying</b>	To dry dishes more completely. (It can only be used with Intensive, Universal, ECO, Glass and 90 min.) When pressing this button, corresponding indicator will be lit.
<b>4 Delay</b>	Press this button to set the delayed hours for washing. You can delay the start of washing up to 24 hours. One press on this button delays the start of washing by one hour.

<b>5 Program indicator</b>		<b>Intensive</b> Heavily soiled items include pots and pans. With dried on food.
		<b>Universal</b> For normally soiled loads, such as pots, plates, glasses and lightly soiled pans.
	<b>ECO</b>	<b>ECO</b> This is the standard program suitable for normally soiled loads, such as pots, plates, glasses and lightly soiled pans.
		<b>Glass</b> For lightly soiled crockery and glass.
		<b>90min</b> For normally soiled loads that need quick wash.
		<b>Rapid</b> A shorter wash for lightly soiled loads that do not need drying.

## Display

<b>7 Warning indicator</b>		<b>Rinse Aid</b> If the " ✨ " indicator is lit, it means the dishwasher is low on dishwasher rinse aid and requires a refill.
		<b>Salt</b> If the " 🧂 " indicator is lit, it means the dishwasher is low on dishwasher salt and needs to be refilled.
<b>6 Screen</b>	To show the reminding time and delay time,error codes etc.	

# Water Softener

The water softener must be set manually, using the water hardness dial.

The water softener is designed to remove minerals and salts from the water, which would have a detrimental or adverse effect on the operation of the appliance.

The more minerals there are, the harder your water is.

The softener should be adjusted according to the hardness of the water in your area.

Your local Water Authority can advise you on the hardness of the water in your area.

## Adjusting salt consumption

The dishwasher is designed to allow for adjustment in the amount of salt consumed based on the hardness of the water used. This is intended to optimise and customise the level of salt consumption.

Please follow the steps below for adjustment in salt consumption.

- 1. Open the door, Switch on the appliance.**
- 2. Press the Rapid button for more than 5 seconds, when the salt indicator blinks as 1Hz frequency means entering the water softener settings. set model within 60 seconds after the appliance was switched on.**
- 3. Press the Rapid button to select the proper set according to your local environment, the sets will change in the following sequence: H1->H2->H3->H4->H5->H6.**
- 4. Press the Power button to end the setup model.**

WATER HARDNESS				Water softener level	Salt consumption (gram/cycle)
German °dH	French °fH	British °Clarke	Mmol/l		
0 - 5	0 - 9	0 - 6	0 - 0.94	H1	0
6 - 11	10 - 20	7 - 14	1.0 - 2.0	H2	9
12 - 17	21 - 30	15 - 21	2.1 - 3.0	H3	12
18 - 22	31 - 40	22 - 28	3.1 - 4.0	H4	20
23 - 34	41 - 60	29 - 42	4.1 - 6.0	H5	30
35 - 55	61 - 98	43 - 69	6.1 - 9.8	H6	60

1°dH=1.25 °Clarke=1.78 °fH=0.178mmol/l

The manufactory setting: H3

Contact your local water board for information on the hardness of your water supply.



Please check the section 3 “Loading The Salt Into The Softener” of PART I :Generic Version, If your dishwasher lacks salt.



## **NOTE:**

**If your model does not have any water softener, you may skip this section.**

### **Water Softener**

The hardness of the water varies from place to place. If hard water is used in the dishwasher, deposits will form on the dishes and utensils.

The appliance is equipped with a special softener that uses a salt container specifically designed to eliminate lime and minerals from the water.

## **Preparing And Loading Dishes**

---

- Consider buying utensils which are identified as dishwasher-proof.
- For particular items, select a program with the lowest possible temperature.
- To prevent damage, do not take glass and cutlery out of the dishwasher immediately after the program has ended.

### **For washing the following cutlery/dishes**

#### **Are not suitable**

- Cutlery with wooden, horn china or mother-of-pearl handles
- Plastic items that are not heat resistant
- Older cutlery with glued parts that are not temperature resistant
- Bonded cutlery items or dishes
- Pewter or cooper items
- Crystal glass
- Steel items subject to rusting
- Wooden platters
- Items made from synthetic fibres

#### **Are of limited suitability**

- Some types of glasses can become dull after a large number of washes
- Silver and aluminum parts have a tendency to discolour during washing
- Glazed patterns may fade if machine washed frequently

## Recommendations for loading the dishwasher

Scrape off any large amounts of leftover food. Soften remnants of burnt food in pans. It is not necessary to rinse the dishes under running water.

For best performance of the dishwasher, follow these loading guidelines.

**(Features and appearance of baskets and cutlery baskets may vary from your model.)**

Place objects in the dishwasher in following way:

- Items such as cups, glasses, pots/pans, etc. are faced downwards.
- Curved items, or ones with recesses, should be loaded aslant so that water can run off.
- All utensils are stacked securely and can not tip over.
- All utensils are placed in the way that the spray arms can rotate freely during washing.
- Load hollow items such as cups, glasses, pans etc. With the opening facing downwards so that water cannot collect in the container or a deep base.
- Dishes and items of cutlery must not lie inside one another, or cover each other.
- To avoid damage, glasses should not touch one another.
- The upper basket is designed to hold more delicate and lighter dishware such as glasses, coffee and tea cups.
- Long bladed knives stored in an upright position are a potential hazard!
- Long and / or sharp items of cutlery such as carving knives must be positioned horizontally in the upper basket.
- Please do not overload your dishwasher. This is important for good results and for reasonable consumption of energy.

### **NOTE:**

Very small items should not be washed in the dishwasher as they could easily fall out of the basket.

## Removing the dishes

To prevent water dripping from the upper basket into the lower basket, we recommend that you empty the lower basket first, followed by the upper basket.

### **WARNING**



**Items will be hot!** To prevent damage, do not take glass and cutlery out of the dishwasher for around 15 minutes after the program has ended.

## Loading the upper basket

The upper basket is designed to hold more delicate and lighter dishware such as glasses, coffee and tea cups and saucers, as well as plates, small bowls and shallow pans (as long as they are not too dirty). Position the dishes and cookware so that they will not get moved by the spray of water.



## Loading the lower basket

We suggest that you place large items and the most difficult to clean items are to be placed into the lower basket: such as pots, pans, lids, serving dishes and bowls, as shown in the figure below. It is preferable to place serving dishes and lids on the side of the racks in order to avoid blocking the rotation of the top spray arm. The maximum diameter advised for plates in front of the detergent dispenser is of 19 cm, this not to hamper the opening of it.

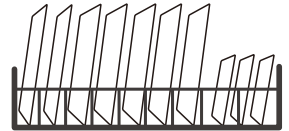

## Loading the cutlery basket

Cutlery should be placed in the cutlery rack separately from each other in the appropriate positions, and do make sure the utensils do not nest together, this may cause bad performance.

### ⚠ WARNING



Do not let any item extend through the bottom.  
Always load sharp utensils with the sharp point down!



For the best washing effect, please load the baskets refer to standard loading options on last section of PART | : Generic Version

# Function Of The Rinse Aid And Detergent

The rinse aid is released during the final rinse to prevent water from forming droplets on your dishes, which can leave spots and streaks. It also improves drying by allowing water to roll off the dishes. Your dishwasher is designed to use liquid rinse aids.

## ⚠ WARNING

Only use branded rinse aid for dishwasher. Never fill the rinse aid dispenser with any other substances (e.g. Dishwasher cleaning agent, liquid detergent). This would damage the appliance.

## When to refill the rinse aid

The regularity of the dispenser needing to be refilled depends on how often dishes are washed and the rinse aid setting used.

- The Low Rinse Aid indicator (  ) will be lit when more rinse aid is needed.
- Do not overfill the rinse aid dispenser.

## Function of detergent

The chemical ingredients that compose the detergent are necessary to remove, crush and dispense all dirt out of the dishwasher. Most of the commercial quality detergents are suitable for this purpose.

## ⚠ WARNING

- Proper Use of Detergent

Use only detergent specifically made for dishwashers use. Keep your detergent fresh and dry.

Don't put powdered detergent into the dispenser until you are ready to wash dishes.



**Dishwasher detergent is corrosive! Keep dishwasher detergent out of the reach of children.**

# Filling The Rinse Aid Reservoir

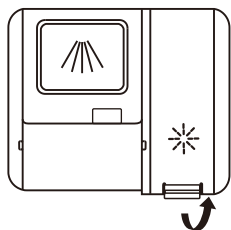

- 1 Remove the rinse reservoir cap by lifting up the handle .

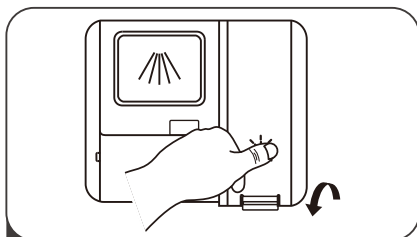

- 3 Close the cap after all.

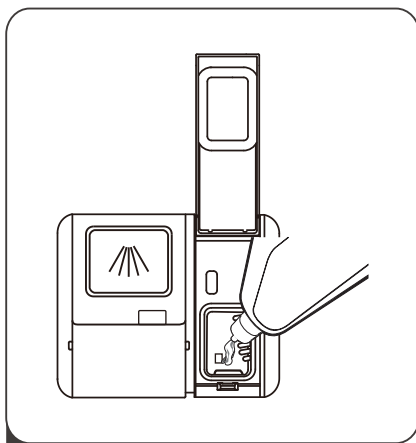

- 2 Pour the rinse aid into the dispenser, being careful not to overfill.

## Adjusting the rinse aid reservoir

To achieve a better drying performance with limited rinse aid, the dishwasher is designed to adjust the consumption by user. Follow the below steps.

1. **Power on the dishwasher by plugging in;**
2. Within 60 seconds after step 1, press the **Rapid** button more than 5 seconds, and then press the Delay Button to enter the set model, the rinse aid indication blinks as 1Hz frequency.
3. **Press the Rapid button to select the proper set according to your using habits ,** the sets will change in the following sequence: D1->D2->D3->D4->D5->D1, Dispenser drops more rinse aid in D5 level than in another, the manufactory setting is D3.
4. **Without operation in 5 seconds or press the power button to exit the set model,** the set success.

Selector position	Amount of rinse aid (mL)
D1	1.2
D2	2.4
D3	3.6
D4	4.8
D5	6.0



# Filling The Detergent Dispenser

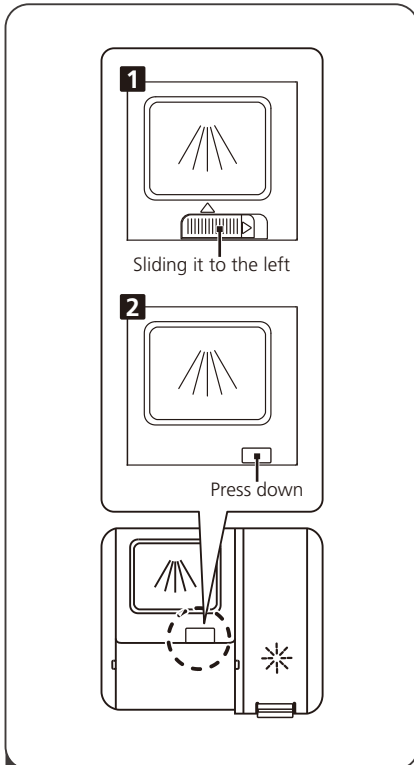

**1** Please choose an open way according to the actual situation.

**1. Open the cap by sliding the release catch.**

**2. Open the cap by pressing down the release catch.**

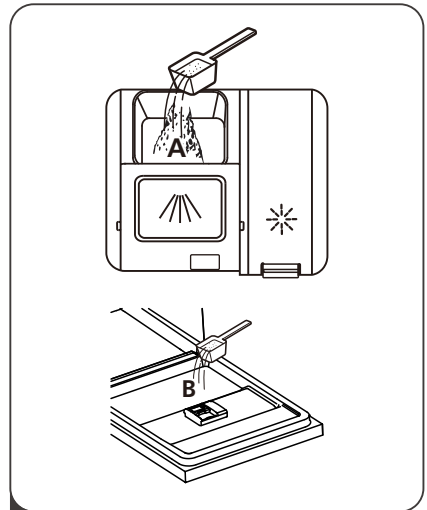

**2** Add detergent into the larger cavity (A) for the main wash cycle . For better cleaning result, especially if you have very dirt items, pour a small amount of detergent onto the door. The additional detergent will activate during the pre-wash phase.

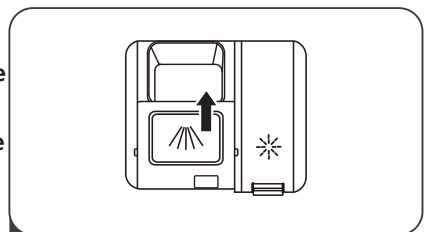

**3** Close the flap by sliding it to the front and then pressing it down.

## NOTE:





- Be aware that depending on the soiling of water, setting may be different.
- Please observe the manufacturer's recommendations on the detergent packaging.

# PROGRAMMING THE DISHWASHER

## Wash Cycle Table

The table below shows which programs are best for the levels of food residue on them and how much detergent is needed. It also show various information about the programs.

(●) Means: need to fill rinse into the Rinse-Aid Dispenser.

Program	Description Of Cycle	Detergent Pre/Main	Running Time(min)	Energy (Kwh)	Water (L)	Rinse Aid
 <b>Intensive</b>	Pre-wash(50°C)					
	Wash(65°C)					
	Rinse	5/25g	205	1.621	17.8	●
	Rinse	(1 or 2 pieces)				
	Rinse(65°C)					
Drying						
 <b>Universal</b>	Pre-wash(45°C)					
	Wash(55°C)					
	Rinse	5/25g	175	1.302	14.3	●
	Rinse(65°C)	(1 or 2 pieces)				
	Drying					
<b>ECO</b> (*EN50242)	Wash(45°C)					
	Rinse	5/25g	220	0.908	11.0	●
	Rinse(60°C)	(1 or 2 pieces)				
	Drying					
 <b>Glass</b>	Pre-wash					
	Wash(50°C)					
	Rinse	5/25g	120	1.100	14.3	●
	Rinse(65°C)	(1 piece)				
	Drying					
 <b>90 Min</b>	Wash(60°C)					
	Rinse	30g	90	1.350	11.7	●
	Rinse(65°C)	(1 piece)				
	Drying					
 <b>Rapid</b>	Wash(50°C)					
	Rinse	25g	30	0.751	11.2	○
	Rinse(45°C)					





### NOTE:

**EN50242: This program is the test cycle. The information for comparability test in accordance with EN50242.**

# Wash Cycle Table

The table below shows which programs are best for the levels of food residue on them and how much detergent is needed. It also show various information about the programs.

(●) Means: need to fill rinse into the Rinse-Aid Dispenser.

Program	Description Of Cycle	Detergent Pre/Main	Running Time(min)	Energy (Kwh)	Water (L)	Rinse Aid
 <b>Intensive</b>	Pre-wash(50°C)					
	Wash(65°C)					
	Rinse	4/16g	205	1.621	17.8	●
	Rinse	(1 or 2 pieces)				
	Rinse65°C)					
Drying						
 <b>Universal</b>	Pre-wash(45°C)					
	Wash(55°C)					
	Rinse	4/16g	175	1.302	14.3	●
	Rinse(65°C)	(1 or 2 pieces)				
	Drying					
<b>ECO</b> (*EN60436)	Wash(45°C)					
	Rinse	4/16g	220	0.923	11.0	●
	Rinse(60°C)	(1 or 2 pieces)				
	Drying					
 <b>Glass</b>	Pre-wash					
	Wash(50°C)					
	Rinse	4/16g	120	1.100	14.3	●
	Rinse(65°C)	(1 or 2 pieces)				
	Drying					
 <b>90 Min</b>	Wash(60°C)					
	Rinse	20g	90	1.350	11.7	●
	Rinse(65°C)	(1 piece)				
	Drying					
 <b>Rapid</b>	Wash(50°C)					
	Rinse	20g	30	0.751	11.2	○
	Rinse(45°C)	(1 or 2 pieces)				

## NOTE:

**EN60436: This program is the test cycle. The information for comparability test in accordance with EN60436.**

## Starting A Cycle Wash

- 1. Draw out the lower and upper basket, load the dishes and push them back.**  
It is commended to load the lower basket first, then the upper one.
- 2. Pour in the detergent.**
- 3. Insert the plug into the socket. The power supply refer to last page "Product fiche".**  
Make sure that the water supply is turned on to full pressure.
- 4. Open the door, Press the power button.**
- 5. Choose a program, the response light will turn on. Then close the door, the dishwasher will start its cycle.**

## Changing The Program Mid-cycle

A wash cycle can only be changed if it has been running for a short time otherwise, the detergent may have already been released and the dishwasher may have already drained the wash water. If this is the case, the dishwasher needs to be reset and the detergent dispenser must be refilled. To reset the dishwasher, follow the instructions below:

- 1. Open the door a little to stop the dishwasher, after the spray arm stop working,** you can open the door completely.
- 2. Press Program button more than three seconds the machine will be in stand by state.**
- 3. You can change the program to the desired cycle setting.**

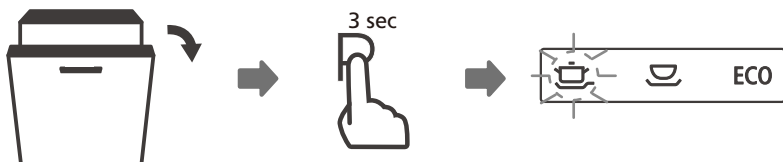

## Forget To Add A Dish?

A forgotten dish can be added any time before the detergent dispenser opens. If this is the case, follow the instructions below:

1. **Open the door a little to stop the washing.**
2. **After the spray arms stop working, you can open the door completely.**
3. **Add the forgotten dishes.**
4. **Close the door.**
5. **The dishwasher will start running again.**

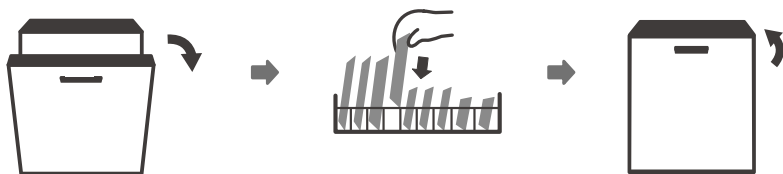

### **⚠ WARNING**



It is dangerous to open the door mid-cycle, as hot steam may scald you.

# ERROR CODES

If there is a malfunction, the dishwasher will display error codes to identify these:

Codes	Meanings	Possible Causes
E1	Longer inlet time.	Faucets is not opened, or water intake is restricted, or water pressure is too low.
E3	Not reaching required temperature.	Malfunction of heating element.
E4	Overflow.	Some element of dishwasher leaks.
Ed	Failure of communication between main PCB with display pcb.	Open circuit or break wiring for the communication.

## **⚠ WARNING**

- If overflow occurs, turn off the main water supply before calling a service.
- If there is water in the base pan because of an overfill or small leak, the water should be removed before restarting the dishwasher.

# TECHNICAL INFORMATION

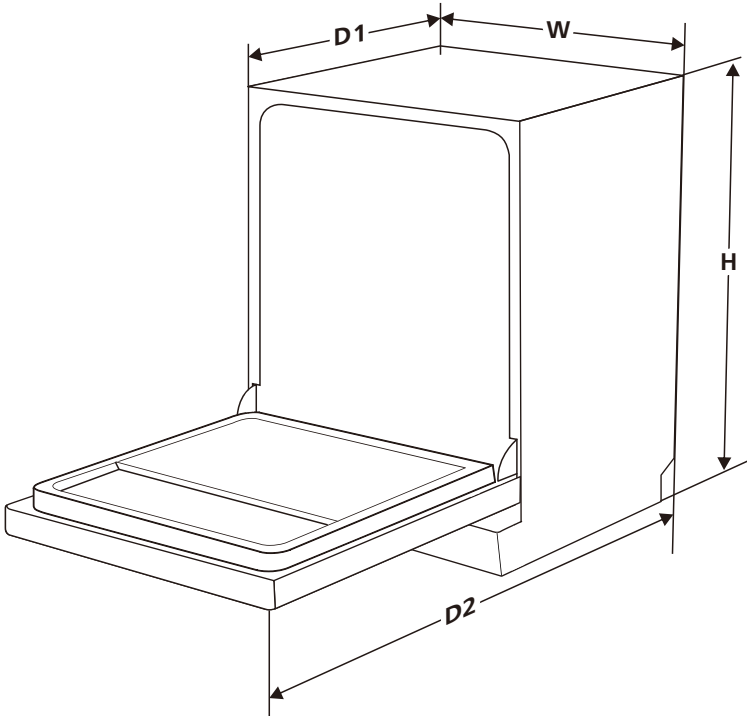

<b>Height (H)</b>	815mm
<b>Width (W)</b>	598mm
<b>Depth (D1)</b>	550mm (with the door closed)
<b>Depth (D2)</b>	1150mm (with the door opened 90° )

## Product fiche (EN50242)

Sheet of household dishwasher according to EU Directive 1016/2010 & 1059/2010:

Manufacturer	
Type / Description	
Standard place settings	12
Energy efficiency class <b>1</b>	A++
Annual energy consumption <b>2</b>	258 kWh
Energy consumption of the standard cleaning cycle	0,908 kWh
Power consumption of off-mode	0,45 W
Power consumption of left-on mode	0,49W
Annual water consumption <b>3</b>	3080 liter
Drying efficiency class <b>4</b>	A
Standard cleaning cycle <b>5</b>	ECO 45°C
Program duration of the standard cleaning cycle	220 min
Noise level	49 dB(A) re 1 pW
Mounting	Built-in
Could be built-in	YES
Power consumption	1760-2100W
Rated voltage / frequency	220-240V/50Hz
Water pressure (flow pressure)	0,04-1,0MPa=0,4-10 bar

### NOTE:

- 1** A + + + (highest efficiency) to D (lowest efficiency)
- 2** Energy consumption based on 280 standard cleaning cycles using cold water fill and the consumption of the low power modes. Actual energy consumption will depend on how the appliance is used.
- 3** Water consumption based on 280 standard cleaning cycles. Actual water consumption will depend on how the appliance is used.
- 4** A (highest efficiency) to G (lowest efficiency)
- 5** This program is suitable for cleaning soiled normally soiled tableware and that it is the most efficient program in terms of its combined energy and water consumption for that type of tableware.



## Product information sheet (EN60436)

Supplier's name or trade mark: 

Supplier's address see page 21

Model identifier:

### General product parameters:

Parameter	Value	Parameter	Value	
Rated capacity <sup>(a)</sup> (ps)	12	Dimensions in cm	Height	81,5
			Width	59,8
			Depth	55,0
EEI <sup>(a)</sup>	55,9	Energy efficiency class <sup>(a)</sup>	E ( ) <sup>c</sup>	
Cleaning performance index <sup>(a)</sup>	1,13	Drying performance index <sup>(a)</sup>	1,07	
Energy consumption in kWh [per cycle], based on the eco programme using cold water fill. Actual energy consumption will depend on how the appliance is used.	0,923	Water consumption in litres [per cycle], based on the eco program. Actual water consumption will depend on how the appliance is used and on the hardness of the water.	11,0	
Program duration <sup>(a)</sup> (h:min)	3:40	Type	Built-in	
Airborne acoustical noise emissions <sup>(a)</sup> (dB(A) re 1 pW)	49	Airborne acoustical noise emission class <sup>(a)</sup>	C ( ) <sup>c</sup>	
Off-mode (W)	0,49	Standby mode (W)	N/A	
Delay start (W) (if applicable)	1,00	Networked standby (W) (if applicable)	N/A	

### Minimum duration of the guarantee offered by the supplier <sup>(b)</sup>:

### Additional information:

Weblink to the supplier's website, where the information in point 6 of Annex II to Commission Regulation (EU) 2019/2022 <sup>(1)</sup> <sup>(b)</sup> is found:

(a) for the eco program.

(b) changes to these items shall not be considered relevant for the purposes of paragraph 4 of Article 4 of Regulation (EU) 2017/1369.

(c) if the product database automatically generates the definitive content of this cell the supplier shall not enter these data.

<sup>(1)</sup> Commission Regulation (EU) 2019/2022 of 1 October 2019 laying down eco design requirements for household dishwashers pursuant to Directive 2009/125/EC of the European Parliament and of the Council amending Commission Regulation (EC) No 1275/2008 and repealing Commission Regulation (EU) No 1016/2010 (see page 267 of this Official Journal).

## WARRANTY TERMS & CONDITIONS

1. These warranty conditions apply exclusively to the original buyer and for domestic use of the appliance in the Netherlands. If the appliance is resold from user to user, the warranty becomes null and void.
2. The warranty only applies if, in the event of a warranty claim, this warranty certificate with the original purchase invoice is shown by the original buyer.
3. No guarantee shall apply to defects caused by: damage, rough or injudicious handling, negligence on the part of the user, use of the appliance at an incorrect voltage or use for a purpose other than that for which it was supplied. Nor can the warranty be invoked when the rating plate with serial number has been changed or removed and/or when the device has been worked on by unqualified persons.
4. Not covered under the terms of this warranty: glass(ceramic), lighting, plastic/metal parts and/or accessories (i.e. filters, grills, pan supports), wire baskets and/or separation partitions, lacquer and/or enamel damage.
5. The warranty period commences on the day of purchase and covers:  
A two-year guarantee on the entire device and its electrical parts such as thermostat, thermal protection, relay, ventilation fan, transformer, switch, etc. with the exception of all parts mentioned under 4.
6. The warranty only covers the replacement of defective- or damaged parts in accordance with the stated responsibility in these warranty conditions.
7. Call-out charges, labour costs, transport and/or packaging costs as well as the transportation risk (for equipment that can only be repaired in our service department) are not covered by the guarantee and will be charged to the user. Please also read the 'Service Terms' below in which, among other things, calculation of call-out charges and labour costs are specified.  
P.S. Repair costs must be paid directly in cash. If invoicing of the mechanic's costs is required, please take into account that additional administration costs will be charged.
8. We are not responsible for any work- and/or repair costs carried out by third parties, not commissioned by us. Nor are we, at any time, responsible for any (extra) costs and/or any consequences hereof, in any case, directly or indirectly resulting from a malfunction, defect or injudicious use of the device caused by a 3<sup>rd</sup> party not deployed by Exquisit, its importer and/or suppliers.
9. Replacement of parts does not extend the original warranty period.

## SERVICE TERMS EXQUISIT

1. Do not use damaged appliances upon receipt, but report this immediately to your supplier.  
It is not possible to return damaged, used appliances!
2. During the first 24 months after the date of purchase on the original invoice no costs will be charged for services which are covered by these applicable warranty terms and conditions.
3. After a warranty period of two years, starting on the date of purchase on the original invoice, costs will be charged for:
  - a. Call-out costs
  - b. Labour costs
  - c. All replaced parts
4. In case of a visit to the customer all costs and materials used, must be paid directly in cash in accordance with the stipulations stated in point 7 in the Warranty Terms & Conditions and in points 2-4 in the Service Terms Exquisit, regardless of the nature of the work.
5. Dispatch of any parts will always take place under the conditions of cash on delivery, C.O.D.

---

**For service →**      **EXQUISIT** [www.domest.nl](http://www.domest.nl) - see service  
**Phone**    **0314 - 362244 (optie 2)**  
**Fax**        **0314 - 378232**  
**E-mail:**    [service@domest.nl](mailto:service@domest.nl)

**exquisit** 

**Buyer →**            Name \_\_\_\_\_  
                          Address \_\_\_\_\_  
                          City \_\_\_\_\_  
                          Purchase \_\_\_\_\_

**Importer →**        **DOMEST MULTIBRAND SALES & SERVICES B.V.**  
                          J.F.Kennedy/laan 101b 7001CZ Doetinchem NL  
                          Phone 0314 - 362244  
                          Fax 0314 - 378232  
                          E-mail: [service@domest.nl](mailto:service@domest.nl)

**DOMEST**  **MULTIBRAND SALES & SERVICES**  
Service and installation department