

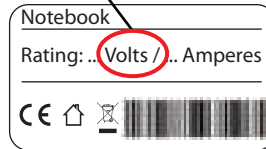

## Quick Installation Guide

65W Netbook Power Adapter

### 1 Find your laptop's voltage

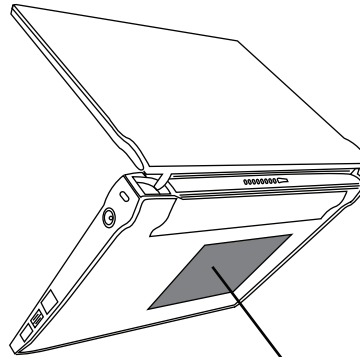

### 2 Set Voltage before use

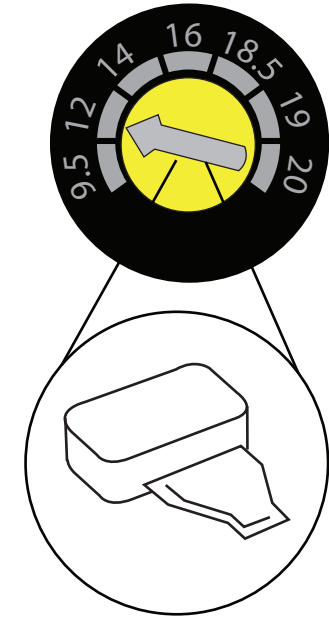

### 3 Select the correct connector (see details on backside)

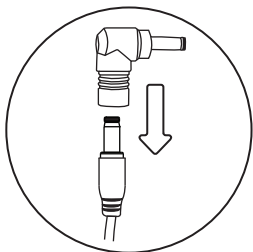
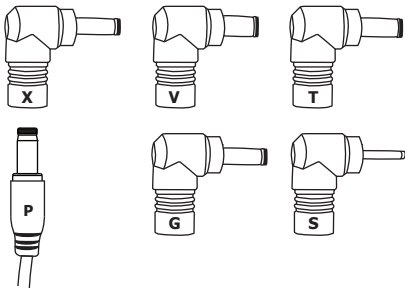

### 4 Connect to your laptop (65 Watts Max.)

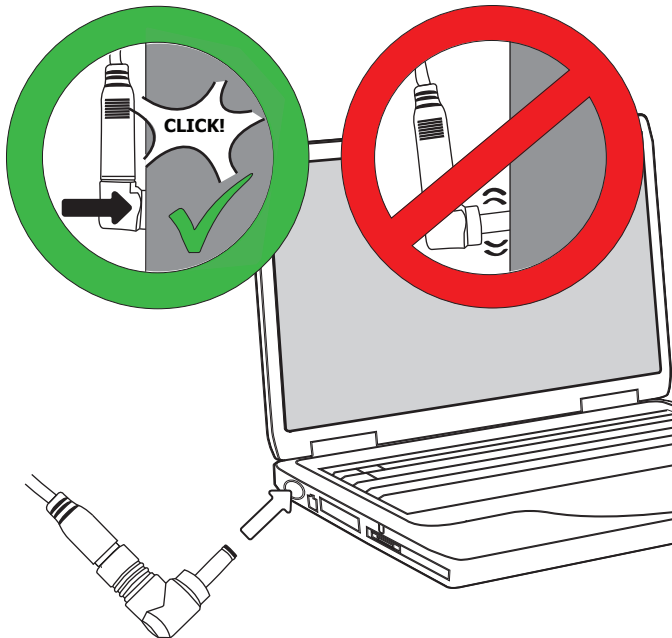

### 5 Connect to wall power-plug

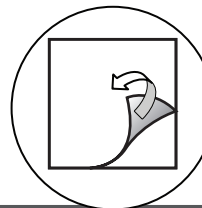
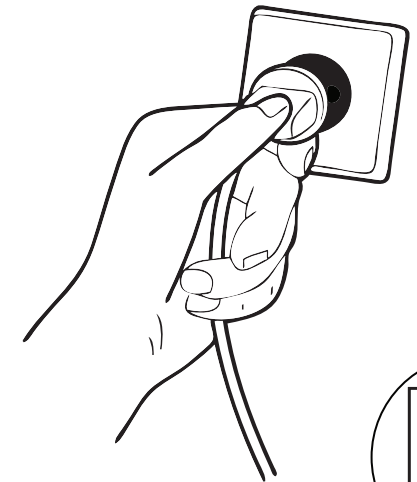

? **FAQ** → [trust.com/16665/faq](http://trust.com/16665/faq)

Acer:

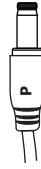
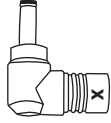

Magalhães:



Asus:

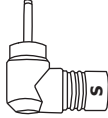
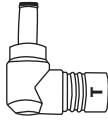
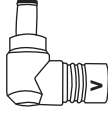

MSI:



Compaq:

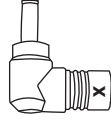
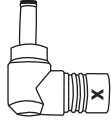

Packard Bell:



Dell:

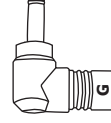
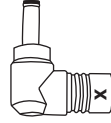

Samsung:

HP:

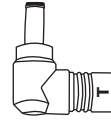
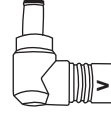

Toshiba:



**EN**

If the power adapter is not working, get a compatible connector for your notebook (for FREE) at [trust.com/16665/freeconnector](http://trust.com/16665/freeconnector). For more detailed information and questions, refer to the included "Safety & Usage guide", or to the online FAQ at [trust.com/16665/faq](http://trust.com/16665/faq).

**FR**

Si l'adaptateur ne fonctionne pas, obtenez un embout compatible avec votre ordinateur (gratuitement) sur [trust.com/16665/freeconnector](http://trust.com/16665/freeconnector). Pour plus d'information et toutes questions, consultez le "Safety & Usage guide" inclus, ou les FAQ en ligne sur [trust.com/16665/faq](http://trust.com/16665/faq).

**DE**

Wenn das Netzteil nicht funktioniert, können Sie einen geeigneten Stecker kostenlose über die Webseite nachbestellen: [trust.com/16665/freeconnector](http://trust.com/16665/freeconnector). Für weitere Informationen und Fragen, nehmen Sie die beigelegte Anleitung und Sicherheitshinweise zu Rate oder schauen Sie mal auf der Webseite nach unter Unterstützung und Fragen (FAQ) [trust.com/16665/faq](http://trust.com/16665/faq).