

Wooden Tool Cart

Assembly Instruction

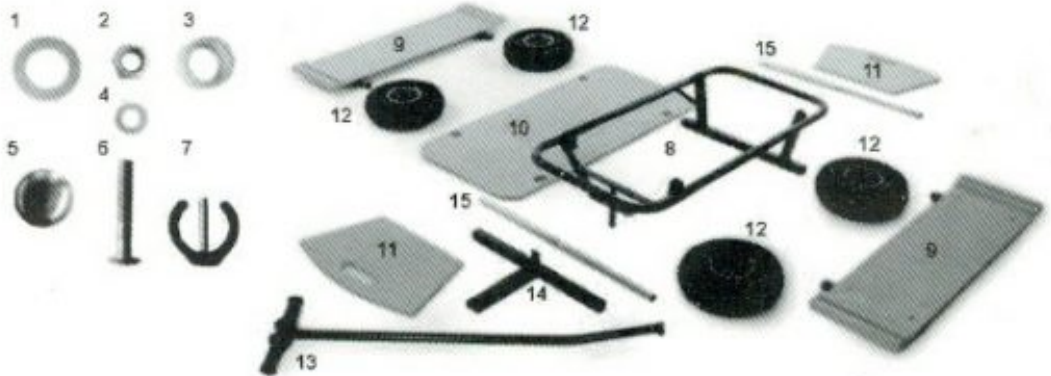

- 1 Large washer
- 2 Lock nut
- 3 Spacer
- 4 Small washer
- 5 Cover nut
- 6 Bolt
- 7 Pin
- 8 Frame
- 9 Side panel
- 10 Base panel
- 11 Front and rear panel
- 12 Wheels
- 13 Handlebar
- 14 Steering shaft
- 15 Axle



Mounting the wheels

- 1) Place the two axles into the frame. Repeat this for the front and backside.
- 2.1) Put the wheels onto the axle, then put large washer onto axle.
- 2.2) Now secure the wheels by placing cover nut over the axle.
- 2.3) Now let the cart rest on the four wheels and check if all wheels are secured properly.

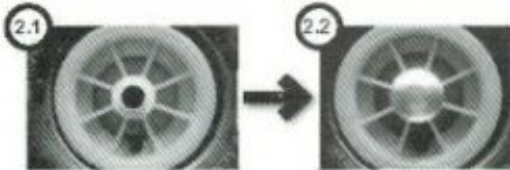

Mounting of the steering shaft

- 3) Check whether a rubber space holder on the metal pen of the frame first
- 3.1) Now mount the steering shaft on the frame.
- 3.2 + 3.3) Then place a second space holder onto the pen and secure it with the provide split pin.



Check and Inflate the Wheels

- 3.5) Before using the cart for the first time, the wheels must be check and inflated with max pressure of 2,0 Bar.

Mounting the handlebar

- 4) Slide the handlebar into the opening of the front axle. Then slide the screw with the small washer through the holes of the front axle. Finally, tighten the lock nut on the screw.

