

böppi

www.bopster.co.uk

⚠ Warning!

Choking Hazard. Small parts. Contains small balls.
Not suitable for children under 3 years.

⚠ Avertissement !

Risque d'étouffement. Contient de petites pièces.
Contient de petites billes.
Ne convient pas aux enfants de moins de 3 ans.

⚠ Attenzione!

Pericolo di soffocamento. Parti piccole.
Contiene piccole palline.
Non adatto a bambini sotto i 3 anni.

⚠ Warnung!

Erstickengefahr. Kleine Teile. Enthält kleine Kugeln.
Nicht für Kinder unter 3 Jahren geeignet.

⚠ ¡Atención!

Peligro de asfixia. Contiene piezas pequeñas.
Contiene bolas pequeñas.
No apto para menores de 3 años.

⚠ Waarschuwing!

Verstikkingsgevaar. Kleine onderdelen.
Bevat kleine balletjes.
Niet geschikt voor kinderen jonger dan 3 jaar.

**Click
Europe**
OOOOO



+44 (0) 2086 700 223



info@bopster.eu



bopster



bopstereu



@bopster.eu

bopster.co.uk

Responsible Person:
Click Europe B.V.
Zekeringstraat 17-A
1014 BM Amsterdam
Netherlands
raffaele@clিকেurope.com



Made in China

böppi

Bamboo Wooden Marble Run
Bambus Holz Murmelbahn
Parcours de billes en bambou
Laberinto de canicas de madera de bambú
Percorso per biglie in legno di bambù
Knikkerbaan van bamboe



Think

Build

Create

Play

boppi is a registered trademark owned by Click Europe Ltd

In cooperation with UDEAS



Bamboo Wooden Marble Run
 Bambus Holz Mummelbahn
 Parcours de billes en bambou
 Laberinto de canicas de madera de bambú
 Pista biglie in legno di bambuo
 Knikkerbaan van bamboe

The boppi bamboo marble run allows children to create and build structures from various tracks, direction cylinders, and spirals, that will enable marbles to journey from the top of the marble run, through different routes and actions, and to exit at the bottom of the structure. Multiple structures and configurations can be created.

Die Boppi-Bambus-Mummelbahn ermöglicht es Kindern, Strukturen aus verschiedenen Bahnen, Richtungszyllindern und Spiralen zu erstellen und zu bauen. Das ermöglicht es den Mummeln, von der Oberseite des Mummellaufs über verschiedene Routen zu reisen und am unteren Ende des Laufs auszutreten. Es können mehrere Strukturen und Konfigurationen erstellt werden.

Avec le parcours de bille en bambou Boppi, les enfants peuvent créer et construire différentes structures à l'aide de plusieurs pistes, cylindres directionnels et spirales, qui feront voyager les billes de leur point de départ au sommet jusqu'en bas du parcours, en empruntant une multitude d'itinéraires et en performant toute sorte d'actions. Toute une variété de structures et d'assemblages peuvent être créés.

El laberinto de canicas de madera de bambú de boppi permite a los niños crear y construir estructuras por medio de diferentes rampas, cilindros de dirección y espirales para que las canicas hagan el recorrido desde la cima del laberinto, a través de diferentes rutas y acciones, hasta salir al final del laberinto. Se pueden crear múltiples estructuras y configuraciones.

La pista delle biglie in bambú boppi permette ai bambini di creare e costruire strutture con vari binari, con forme cilindriche e spiroidale, che permetteranno alle biglie di scivolare dalla cima della pista, attraverso diversi percorsi e azioni, e di uscire in fondo alla struttura. Si possono creare strutture e configurazioni multiple.

Met de knikkerbaan van bamboe van boppi kunnen kinderen bouwwerken maken met verschillende banen, cilinders en spiralen. Hiermee rollen knikkers vanaf de top van de knikkerbaan, via verschillende routes en bewegingen, naar buiten aan de onderkant van het bouwwerk. Er kunnen meerdere bouwwerken en opstellingen worden gemaakt.



PARTS



D1

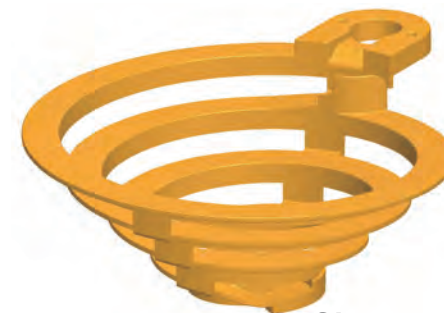

G1



E1

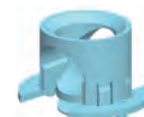

E2



E3



F1



F2



F3



B1



B2



C1



A1



A2

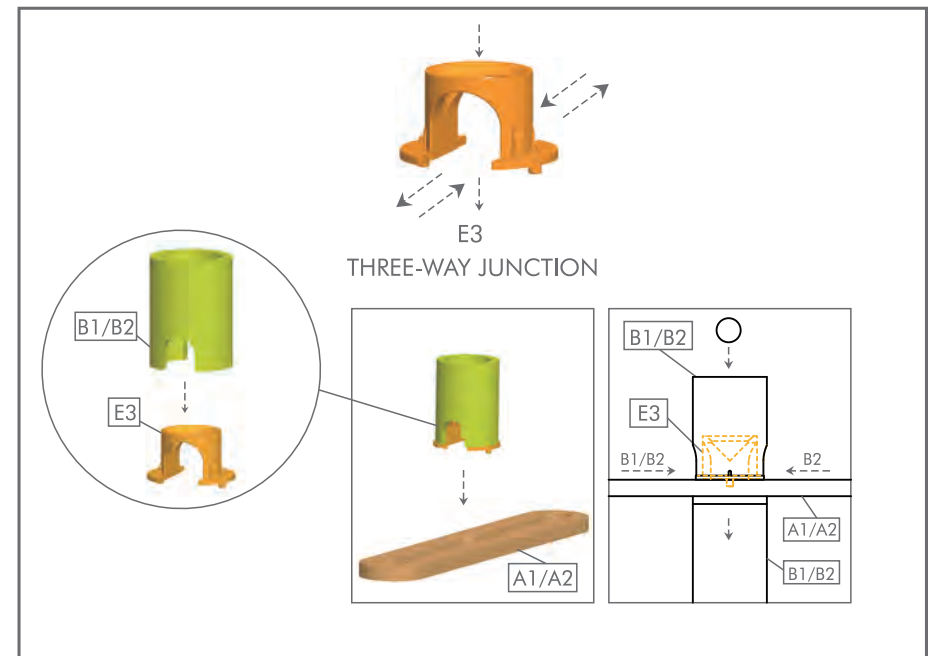
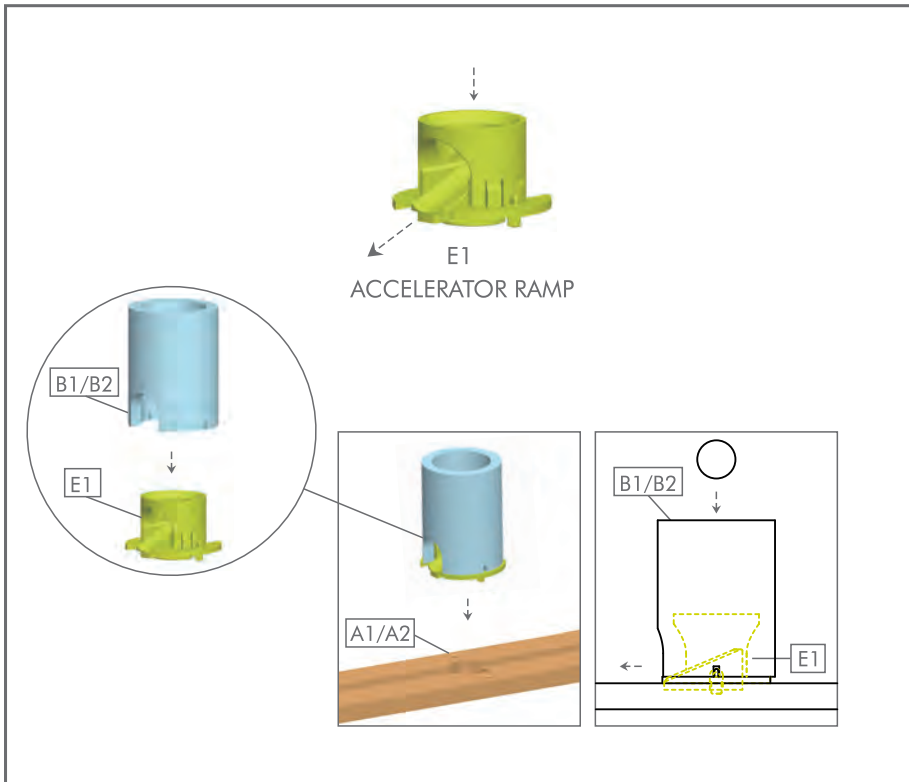
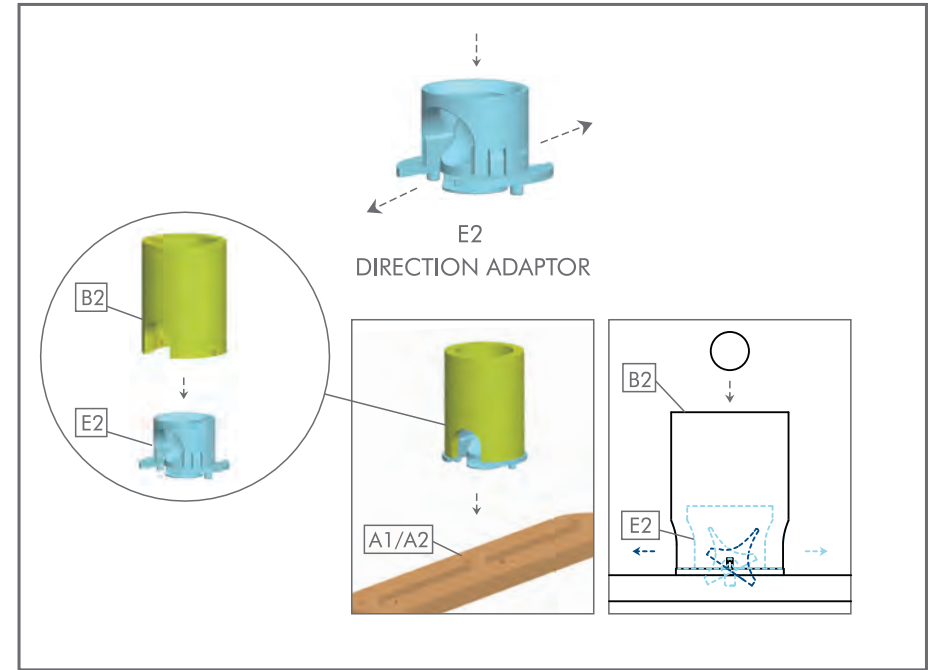
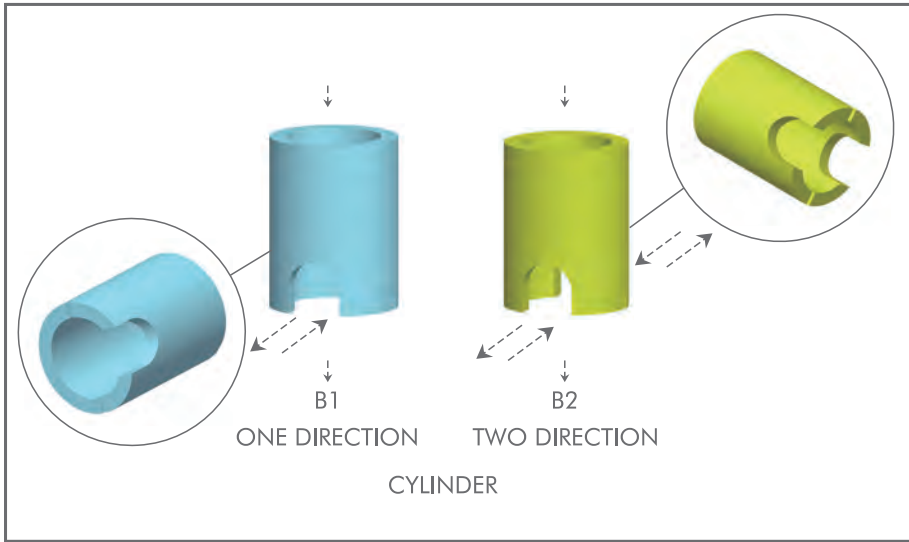

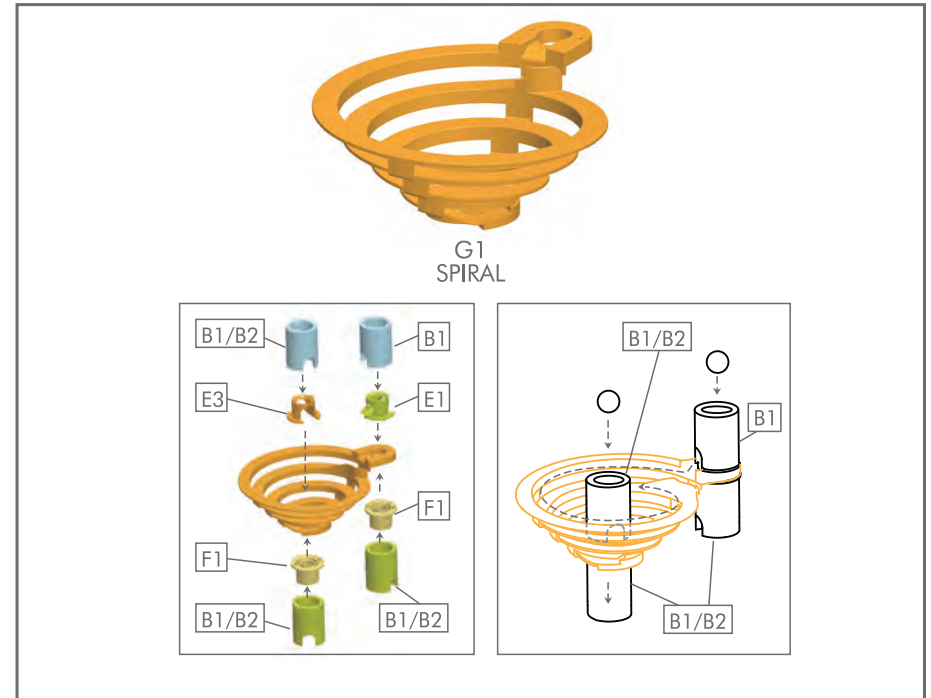
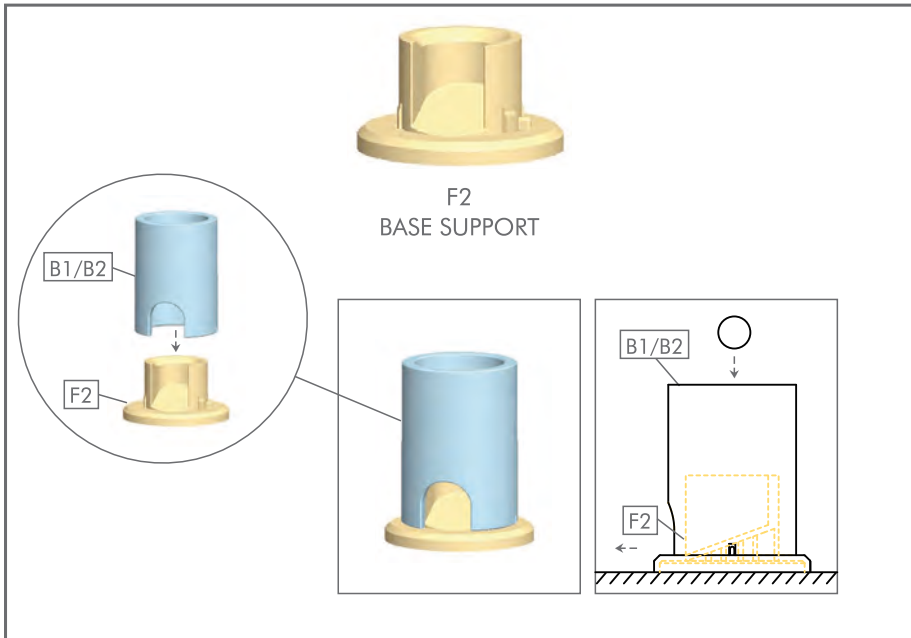
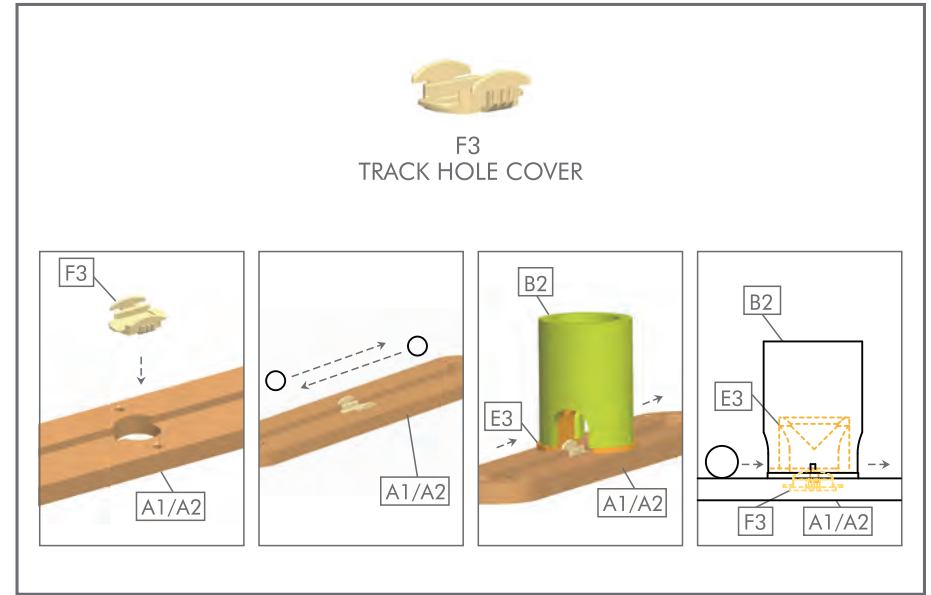
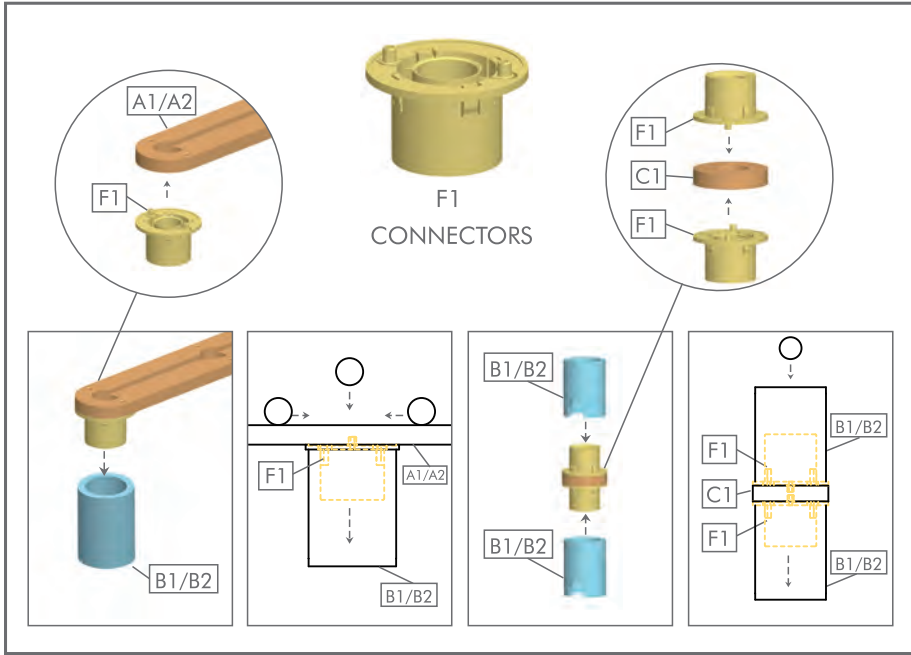

Starter Pack
Anfänger Packet
Pack débutant
Pack de inicio
Pacchetto iniziale
Starterspakket



PARTS

D1 (X2)
 G1 (X1)
 E1 (X3)
 E2 (X1)
 E3 (X3)
 F1 (X14)
 F2 (X4)
 F3 (X3)
 B1 (X8)
 B2 (X3)
 C1 (X3)
 A1 (X1)
 A2 (X2)

Assembly Instructions • Montageanleitung • Notice de montage
 Instrucciones de montaje • Istruzioni per il montaggio • Montage-instructies

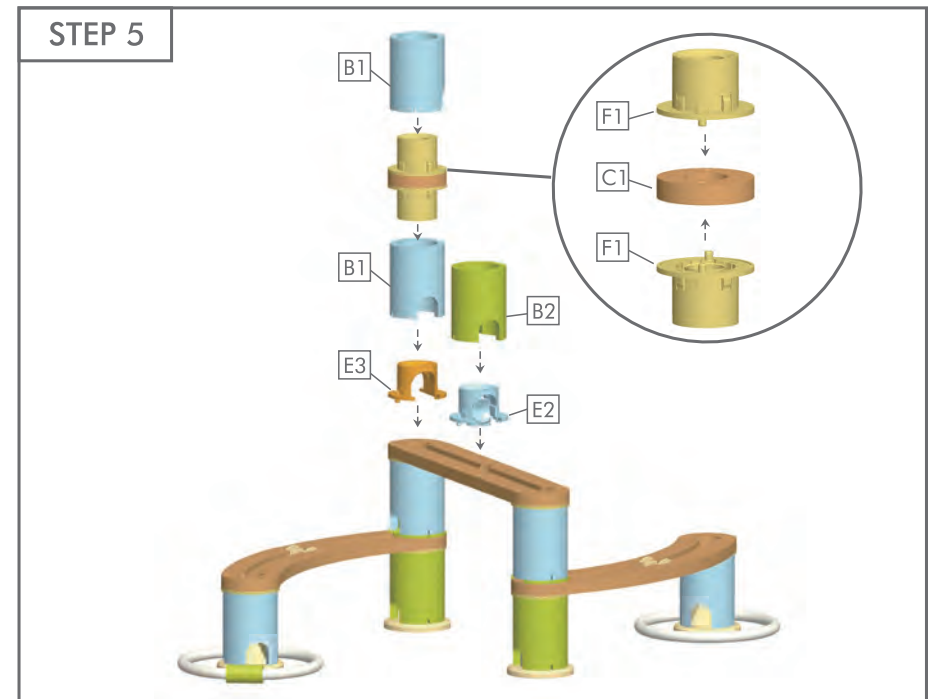
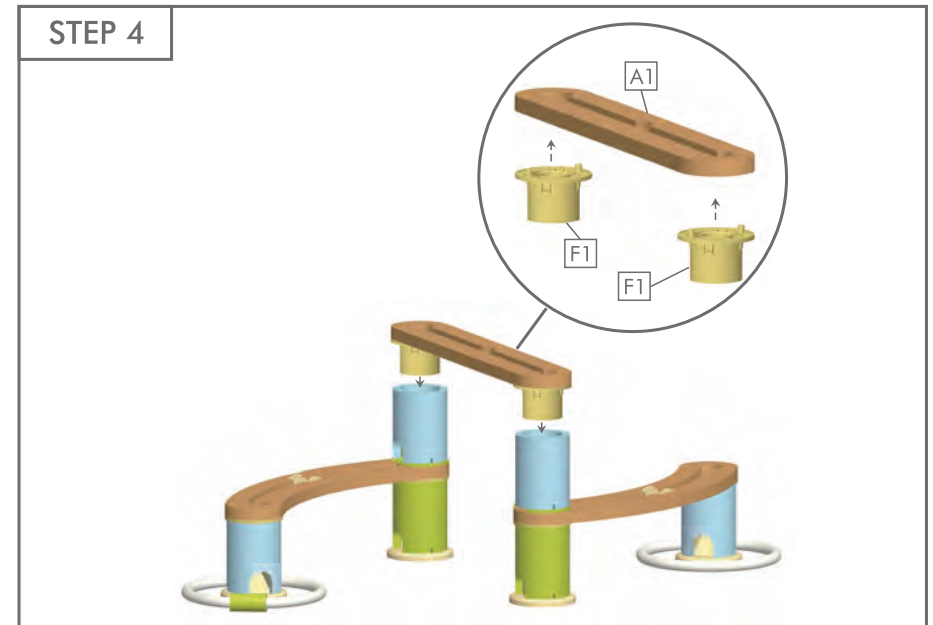
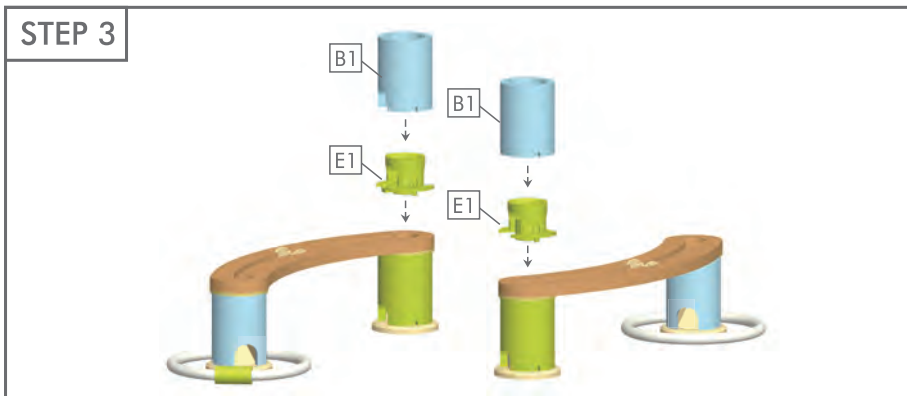
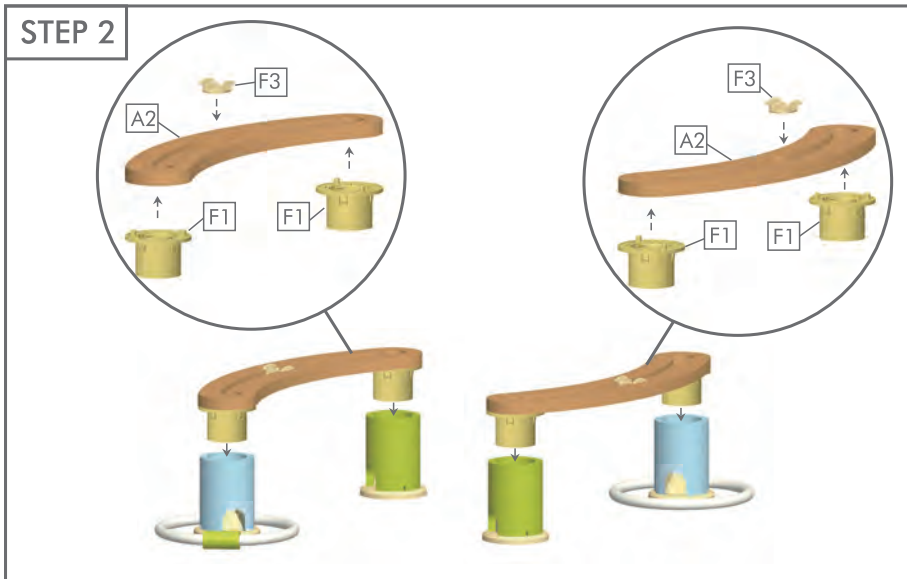
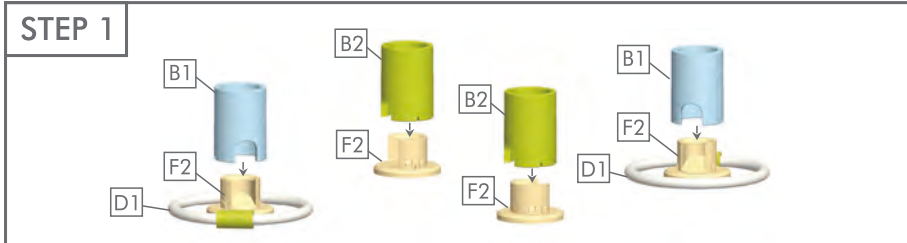

STEP 6

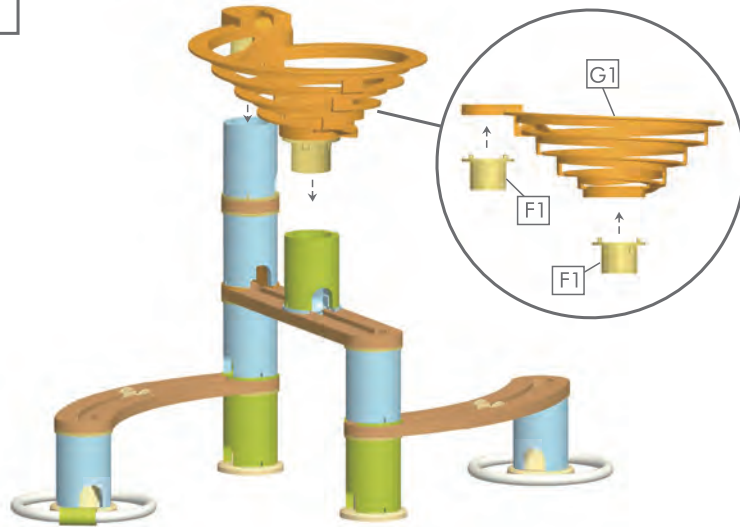

STEP 7

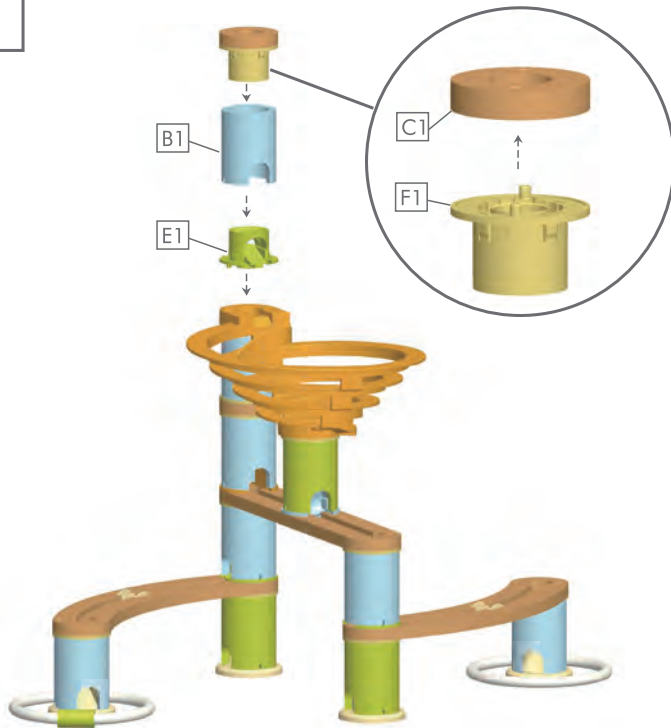

- Starter Pack
- Anfänger Packet
- Pack débutant
- Pack de inicio
- Pacchetto iniziale
- Starterspaket

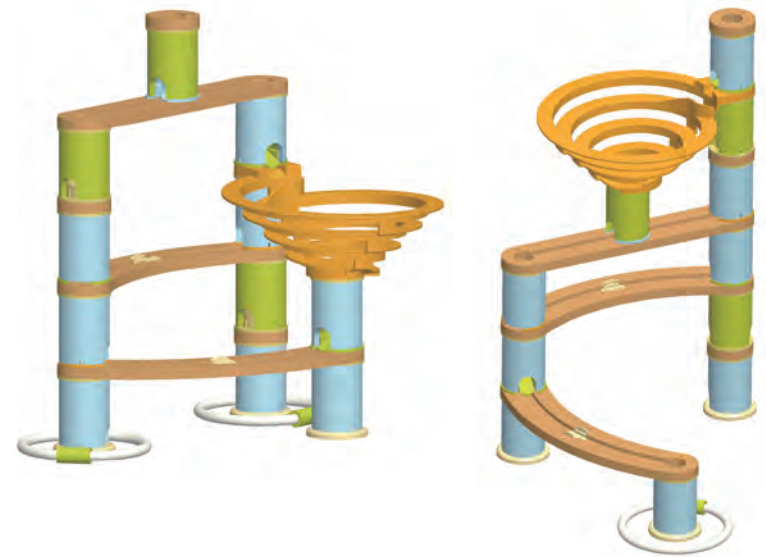
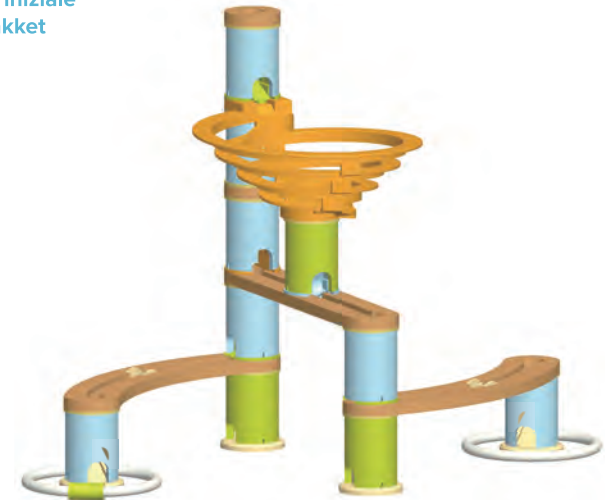

Advanced Pack
 Erweitertes Paket
 Pack avancé
 Pack avanzado
 Pacchetto avanzato
 Middenpakket



PARTS

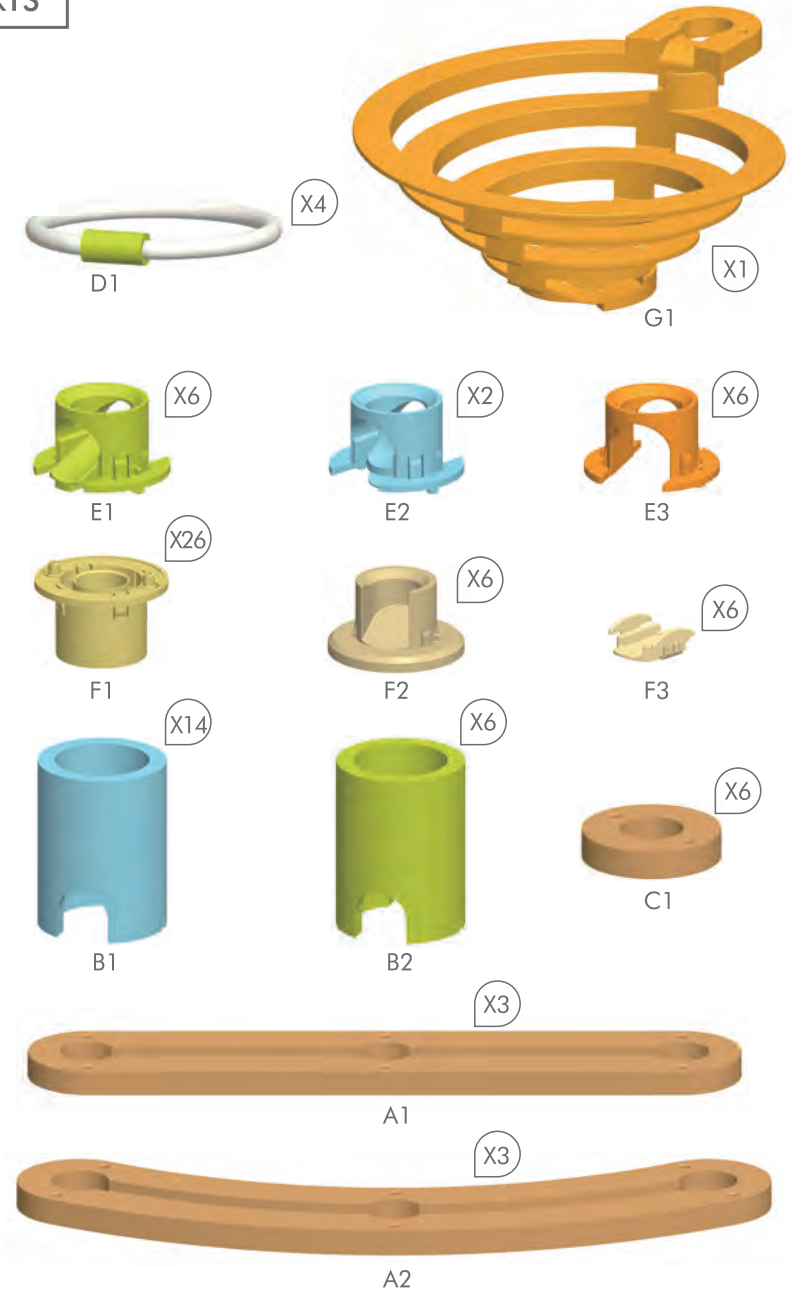

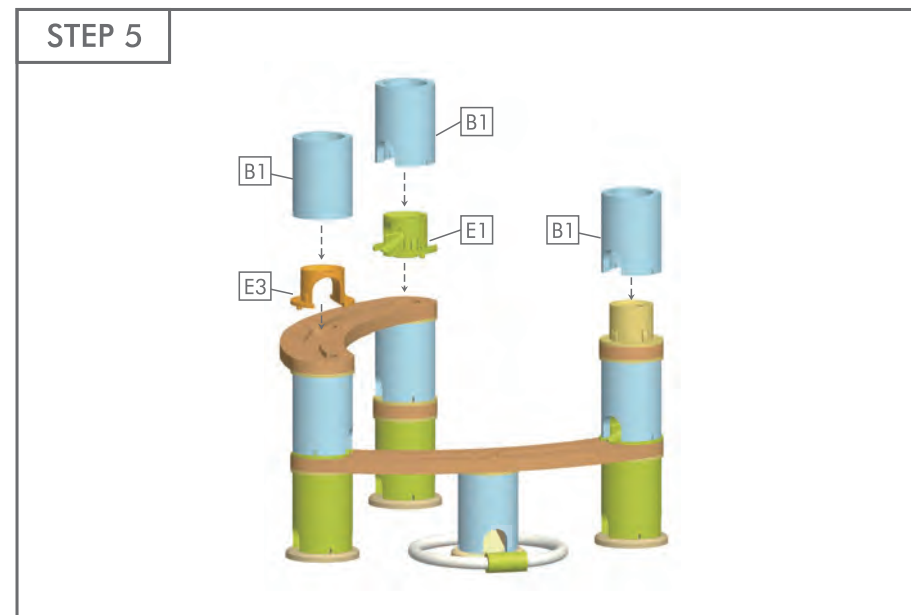
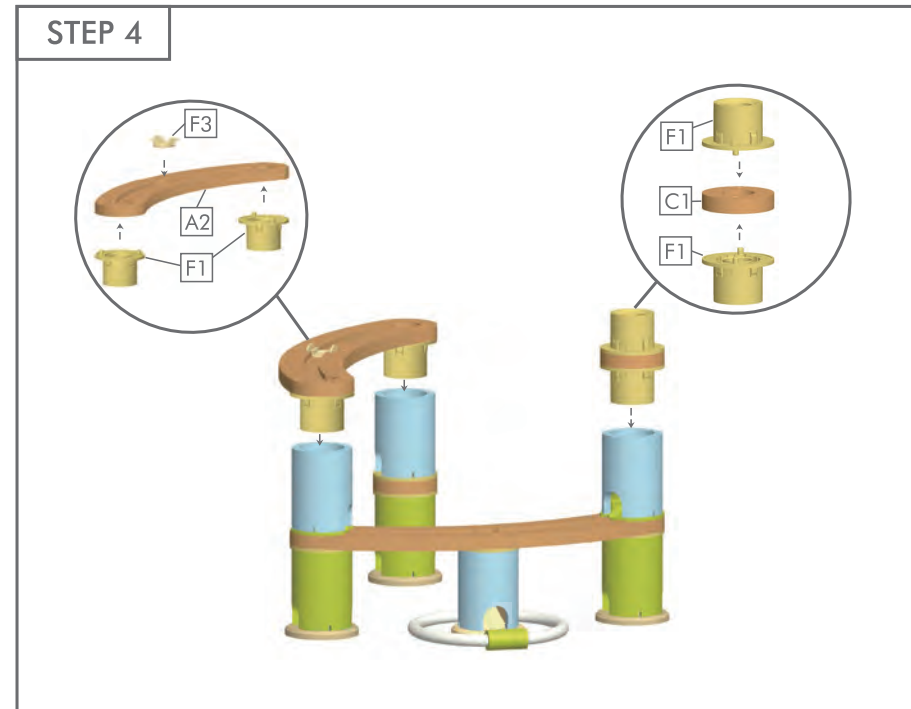
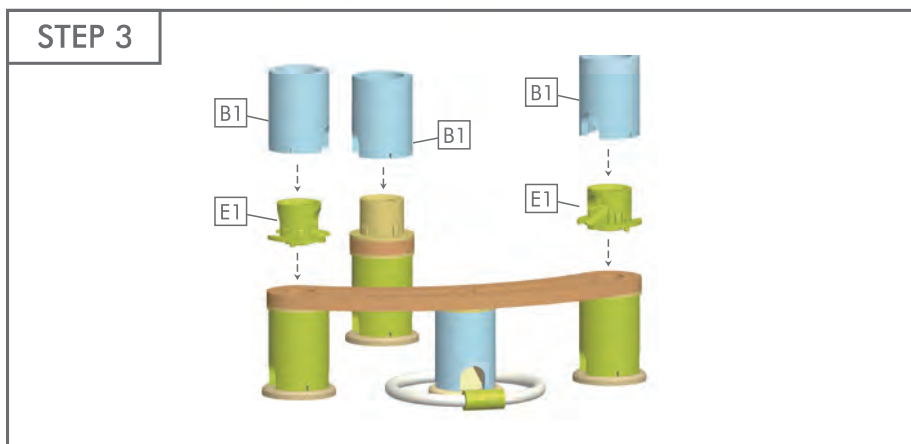
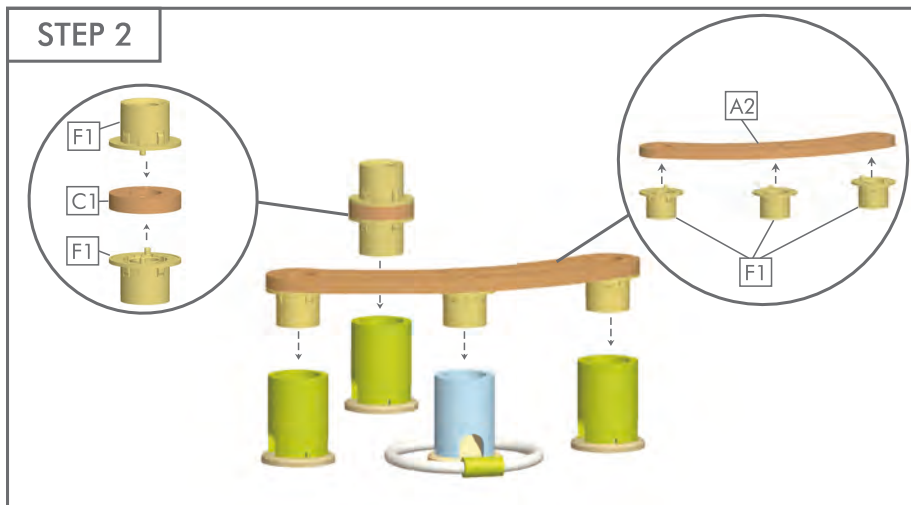
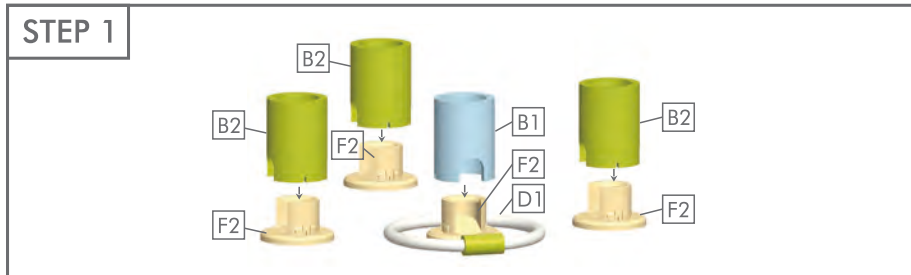

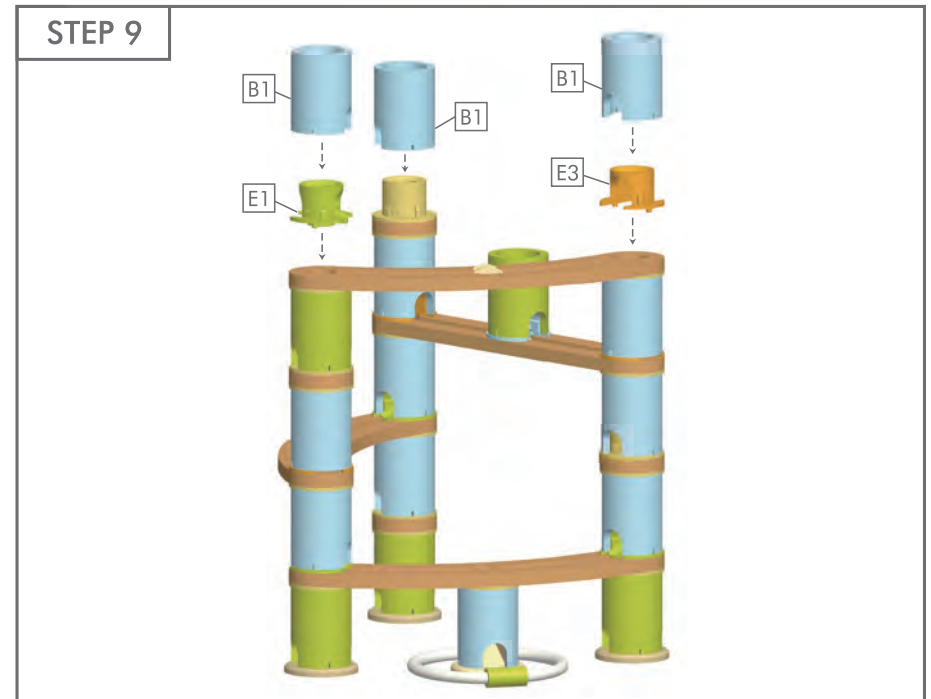
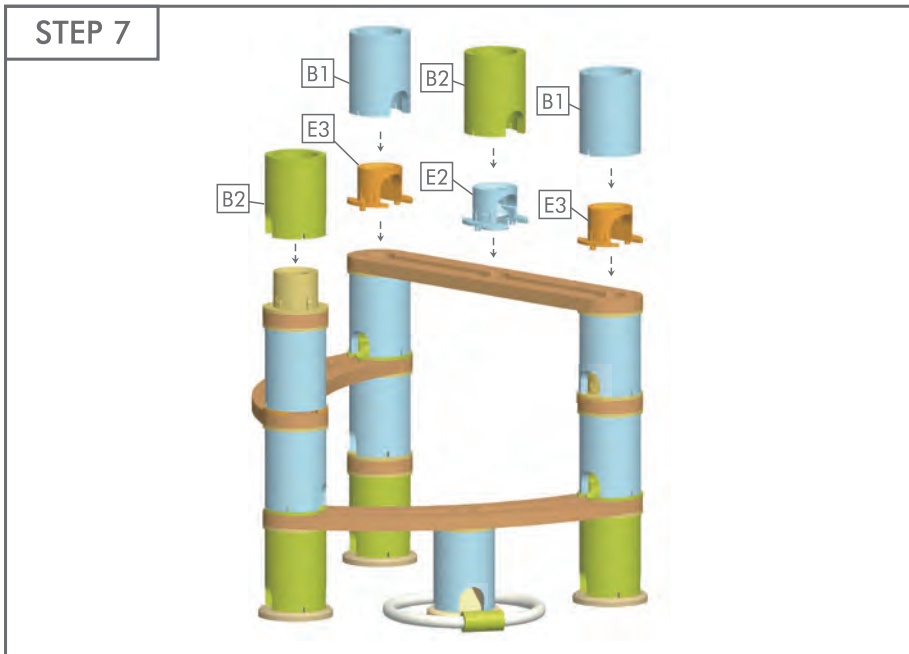
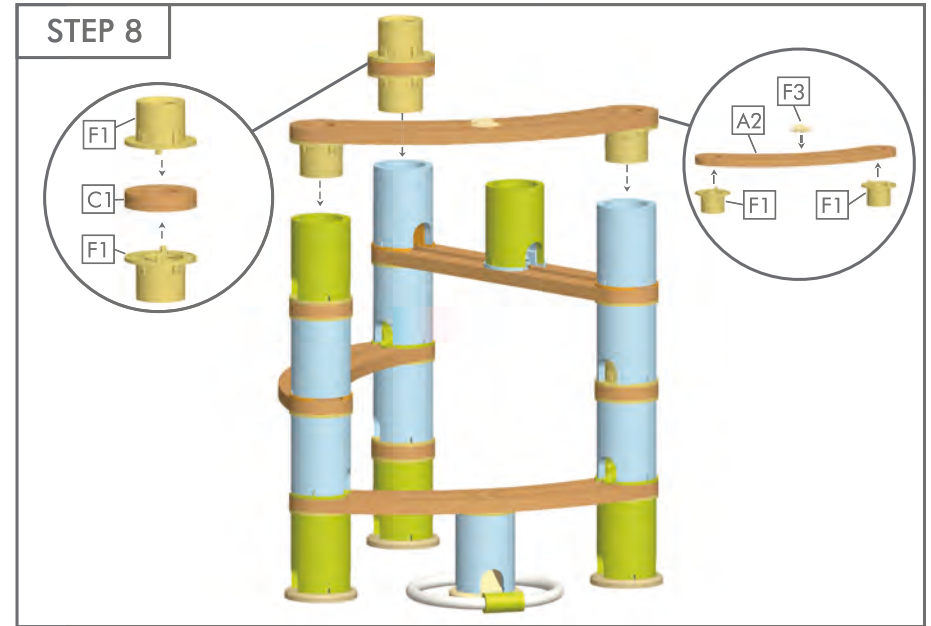
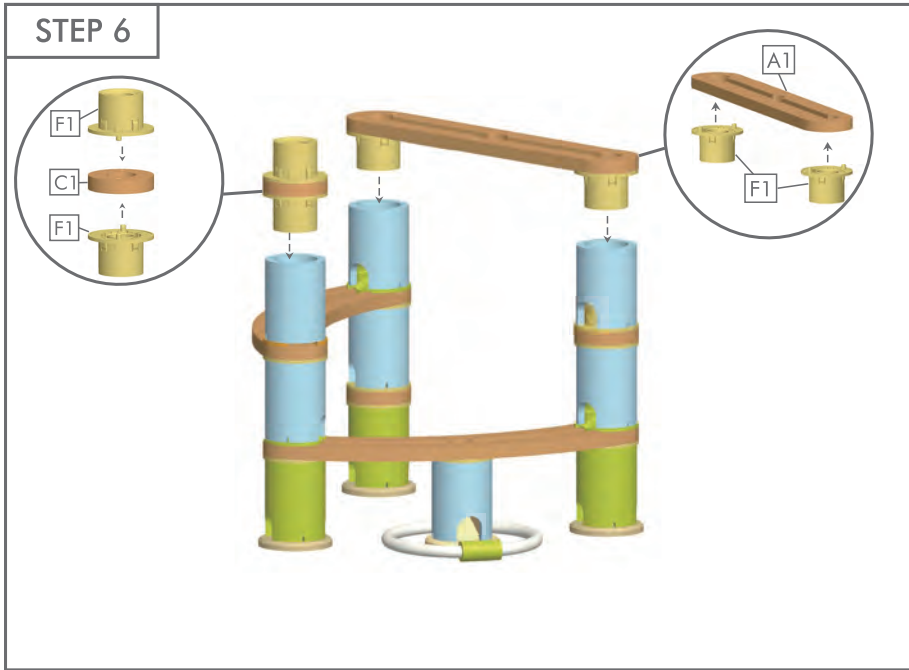

STEP 10

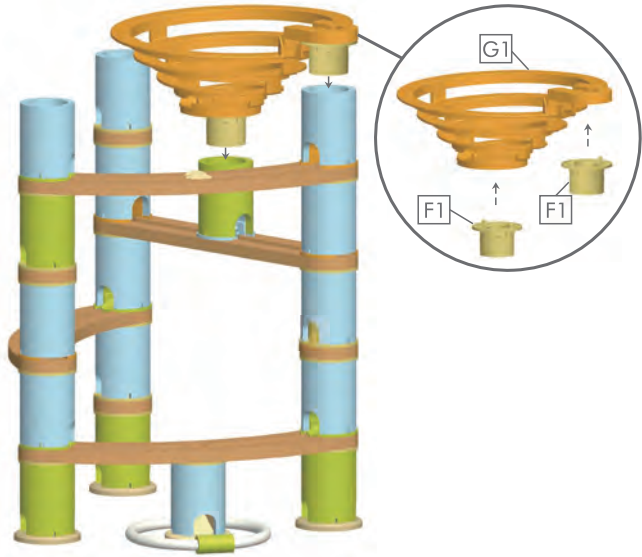

STEP 11

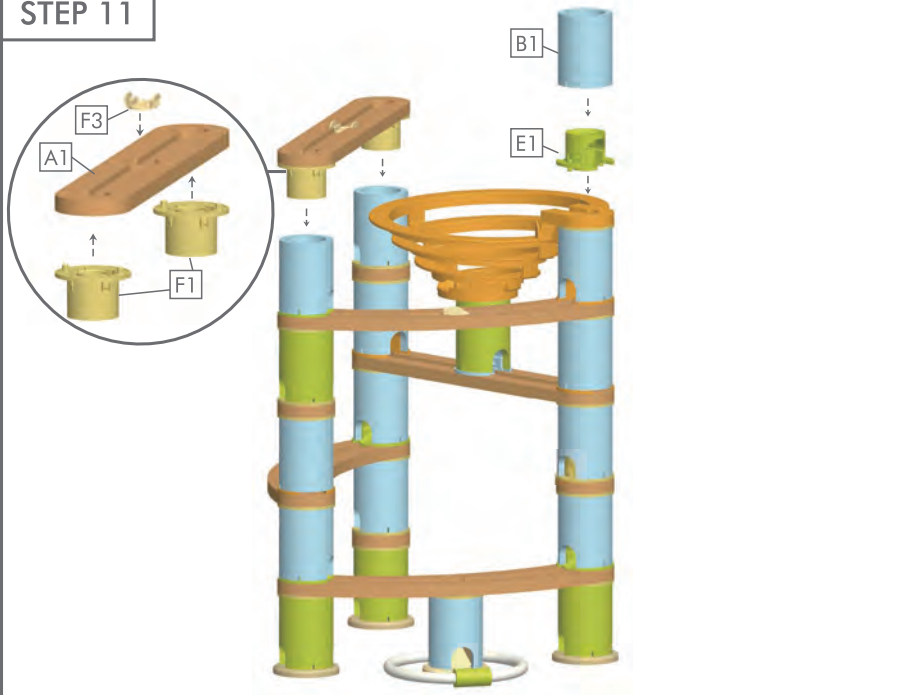

STEP 12

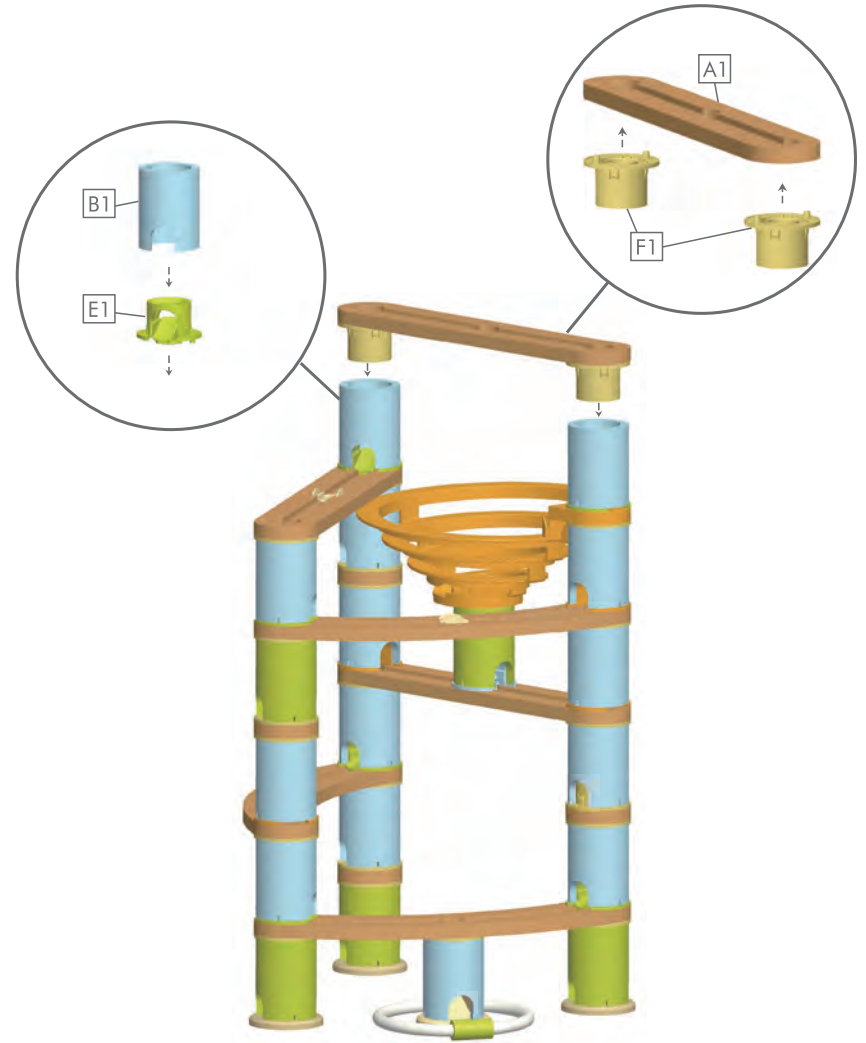

STEP 13

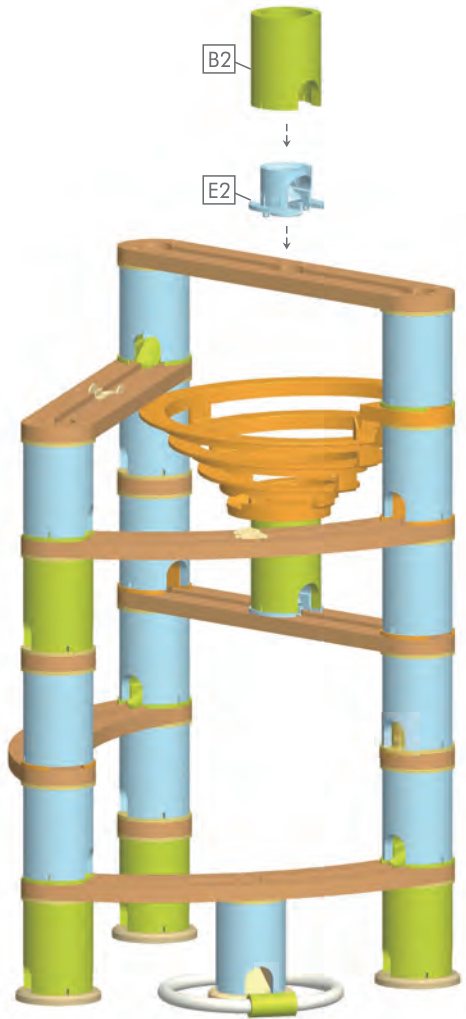

STEP 14

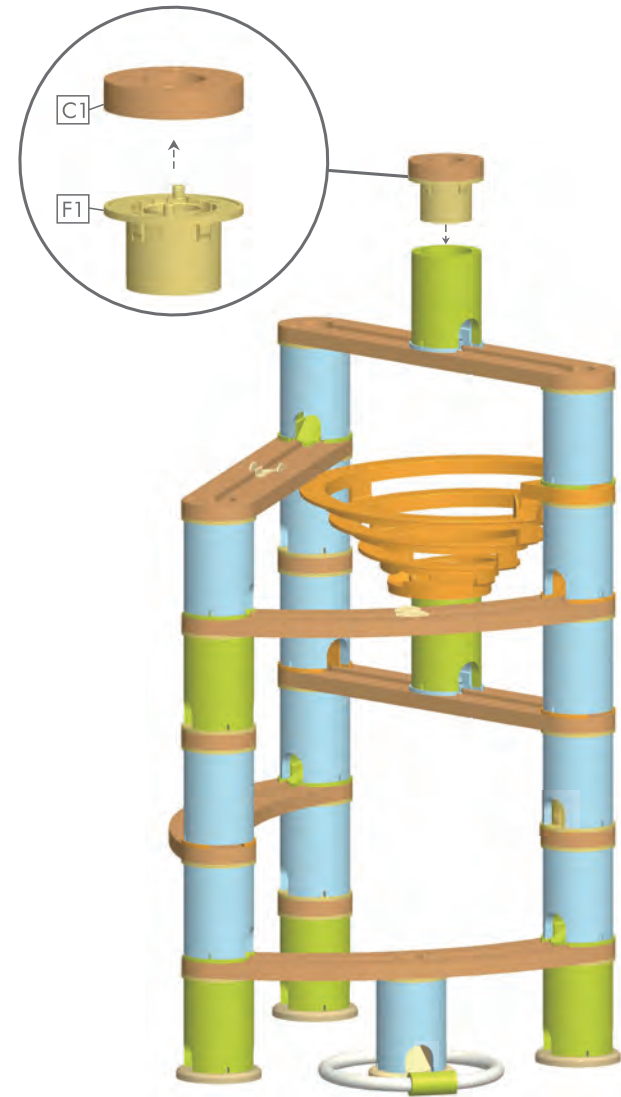

Advanced Pack
Erweitertes Paket
Pack avancé
Pack avanzado
Pacchetto avanzato
Middenpakket

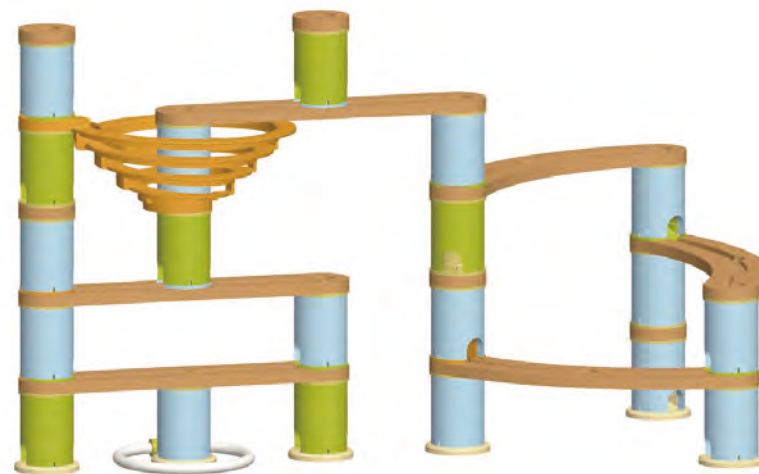
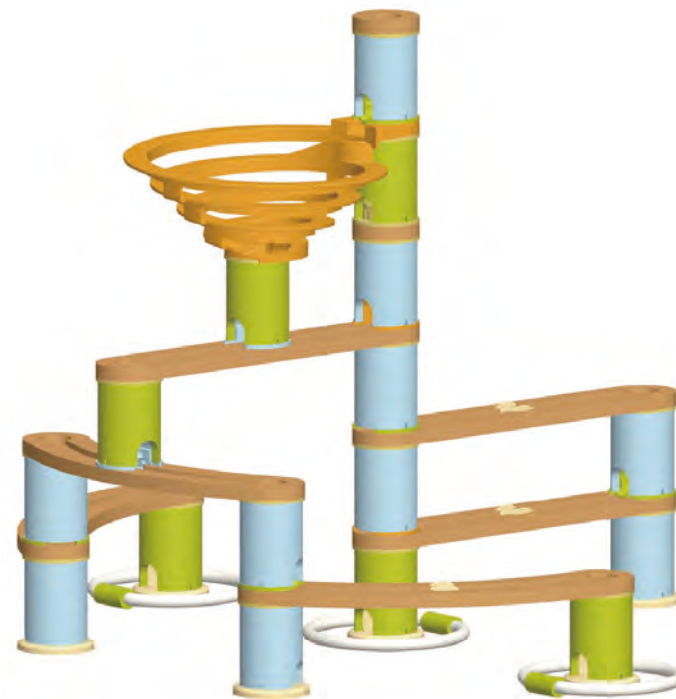
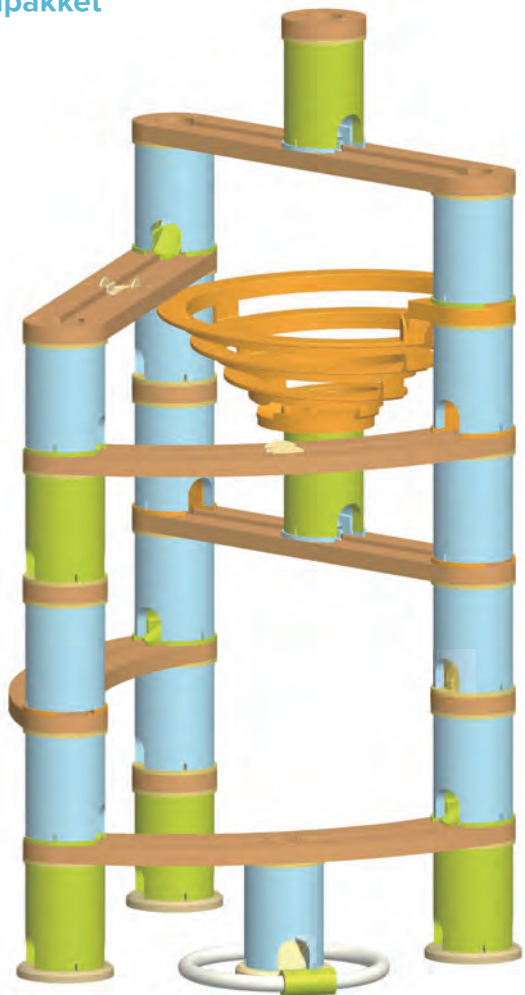

Jumbo Pack
Jumbo Packung
Pack XXL
Pack gigante
Pacchetto jumbo
Jumbopakket

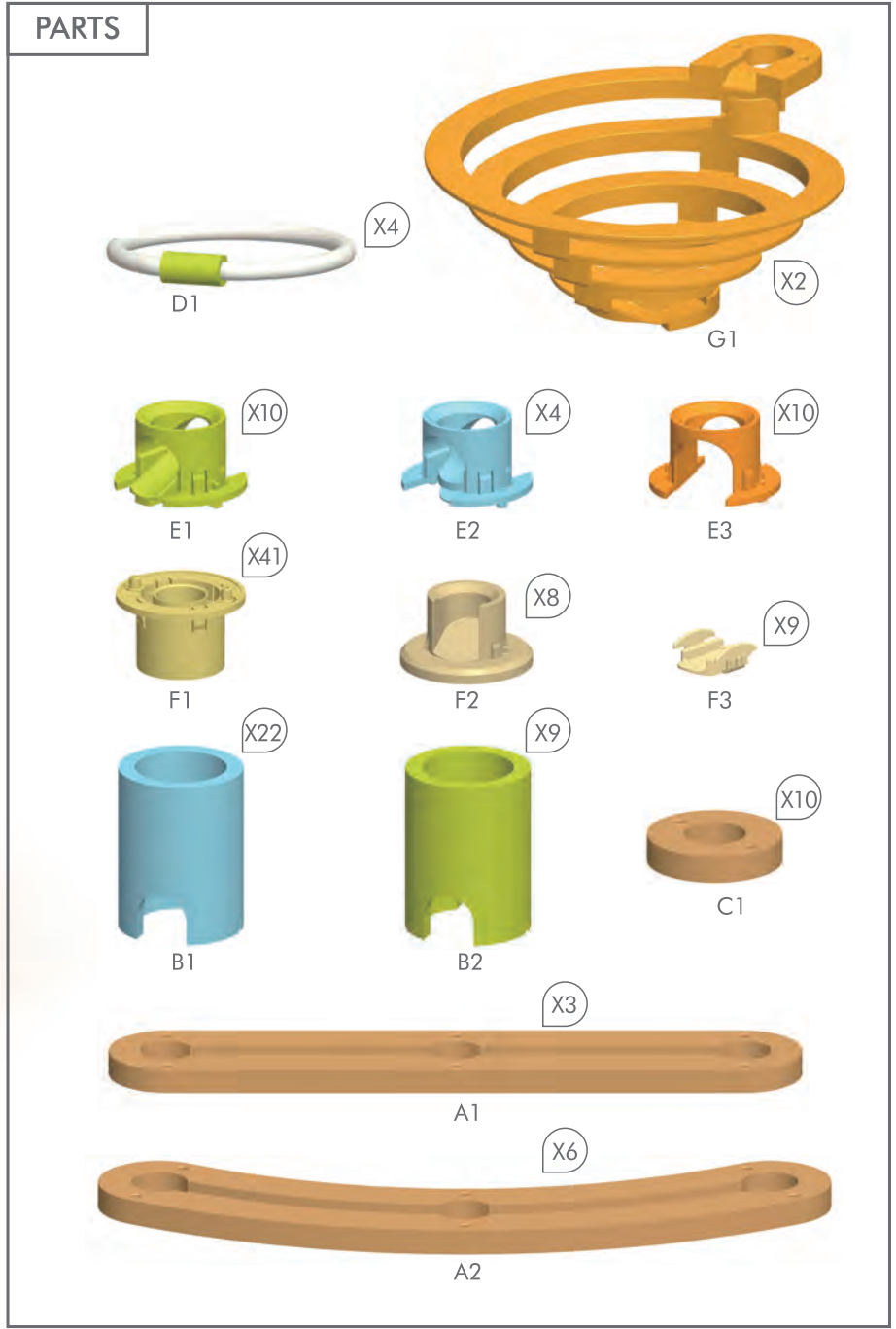

Assembly Instructions • Montageanleitung • Notice de montage
 Instrucciones de montaje • Istruzioni per il montaggio • Montage-instructies

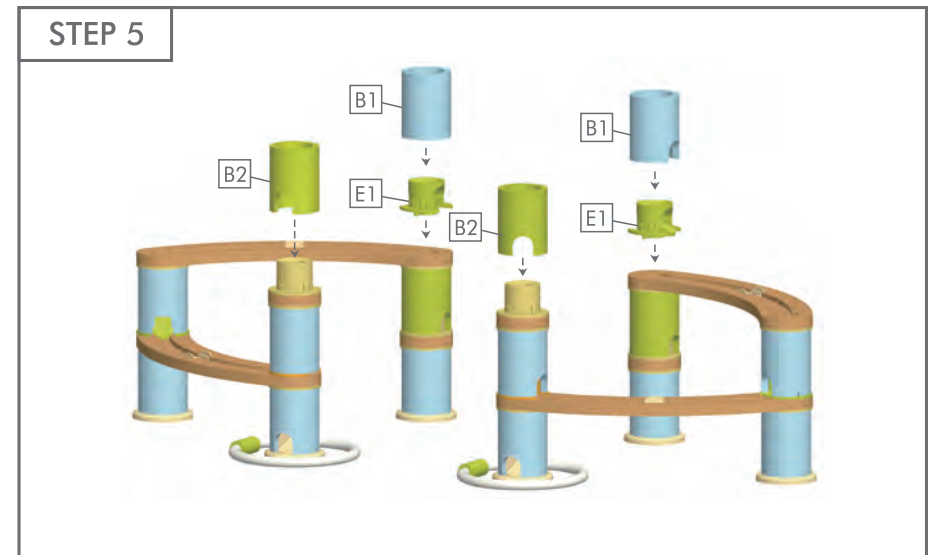
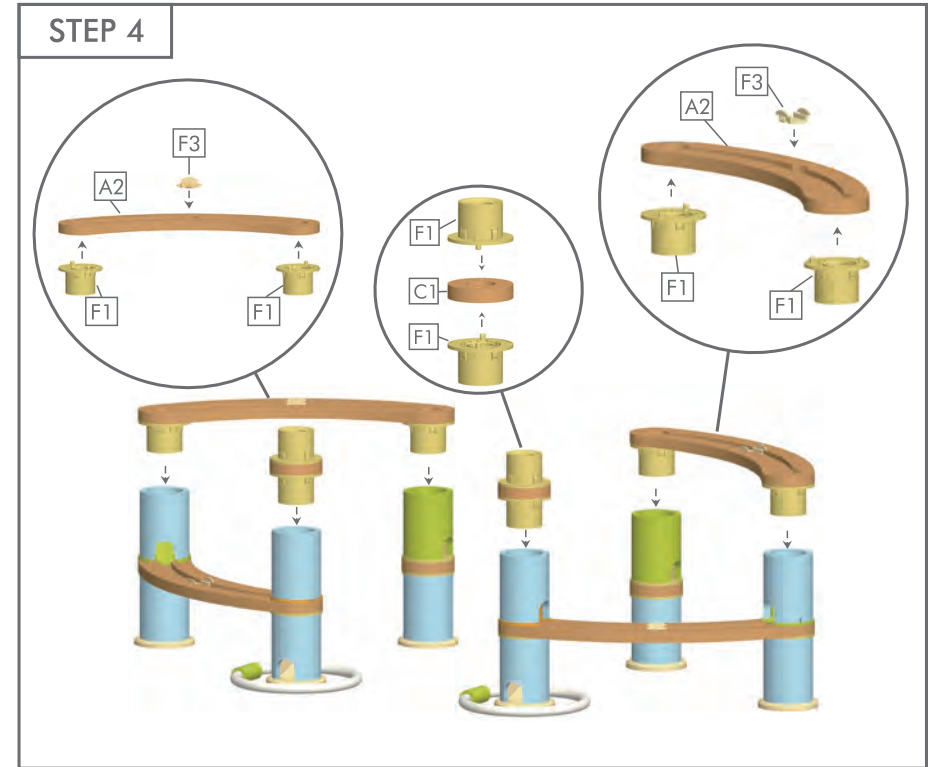
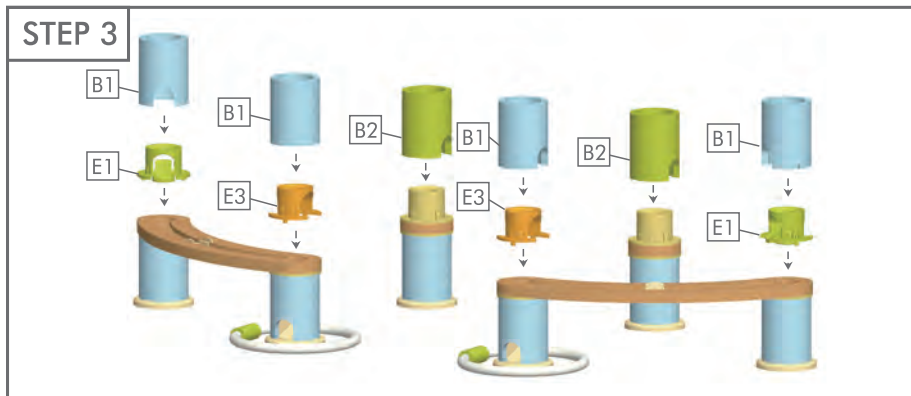
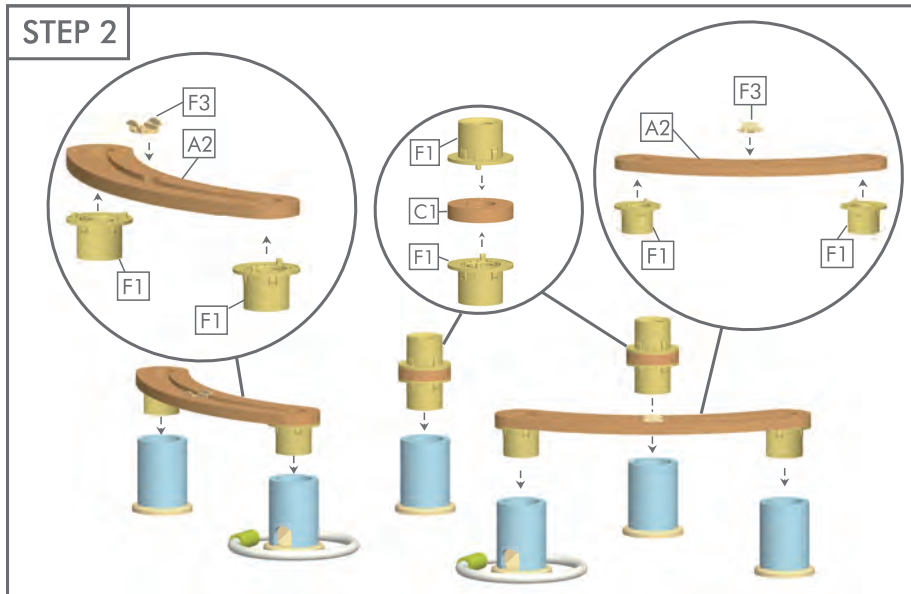
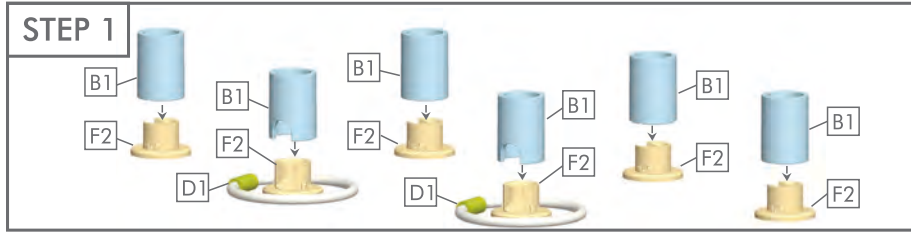

STEP 6

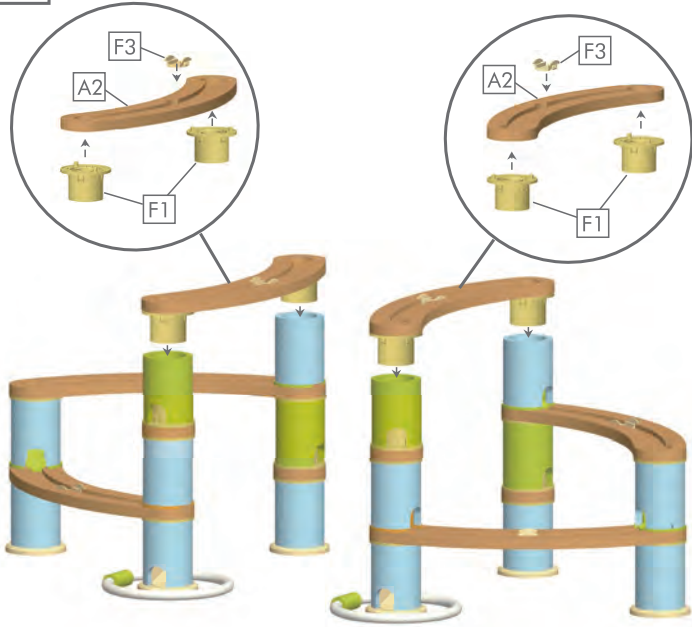

STEP 8

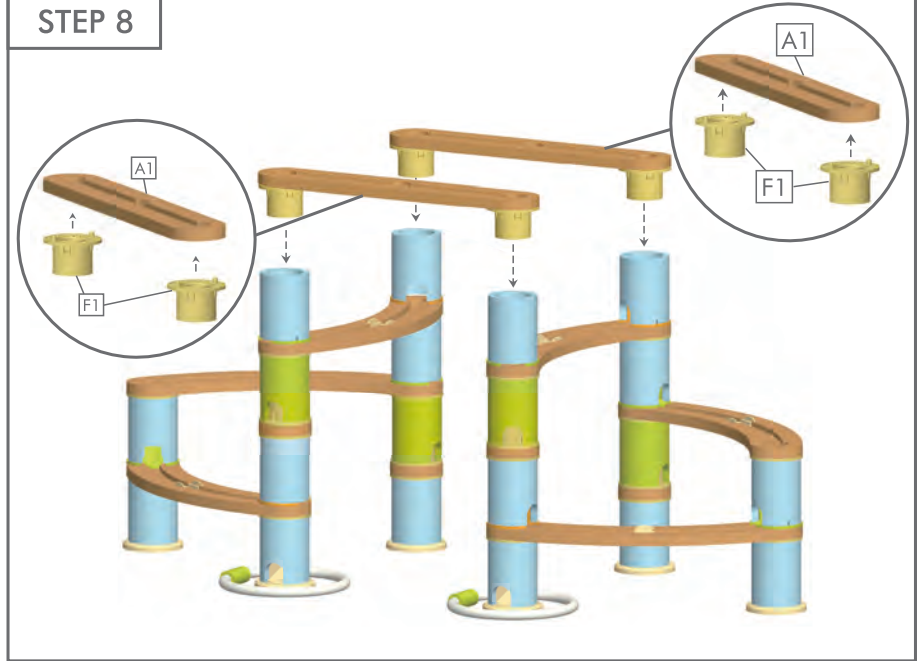

STEP 7

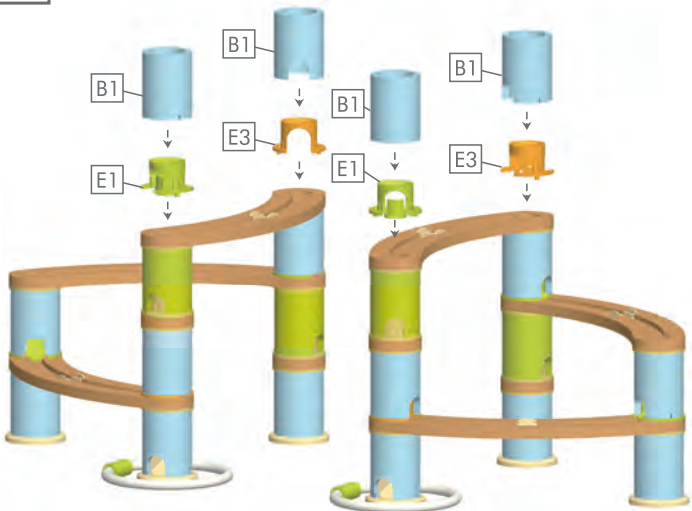

STEP 9

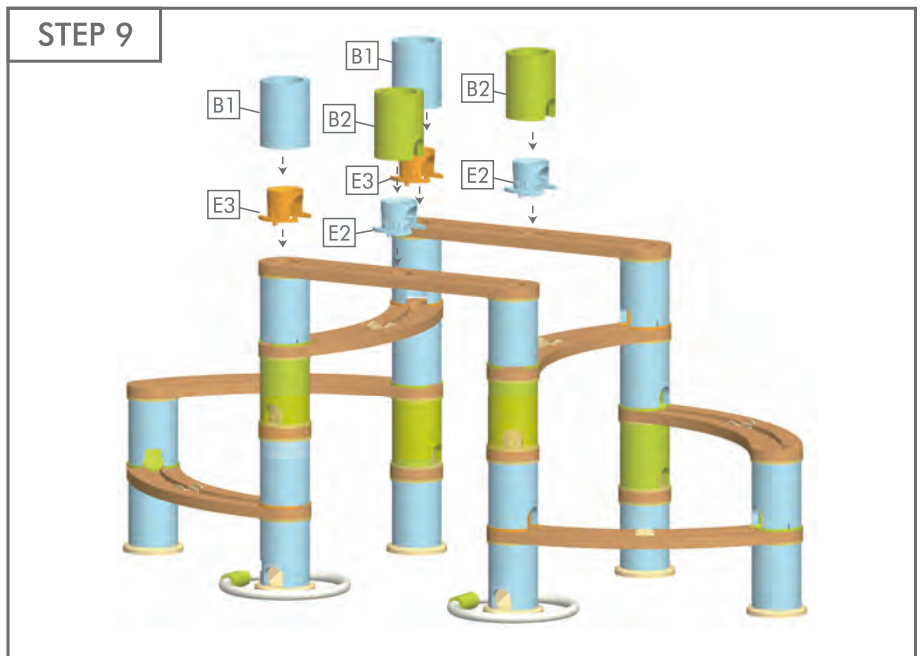

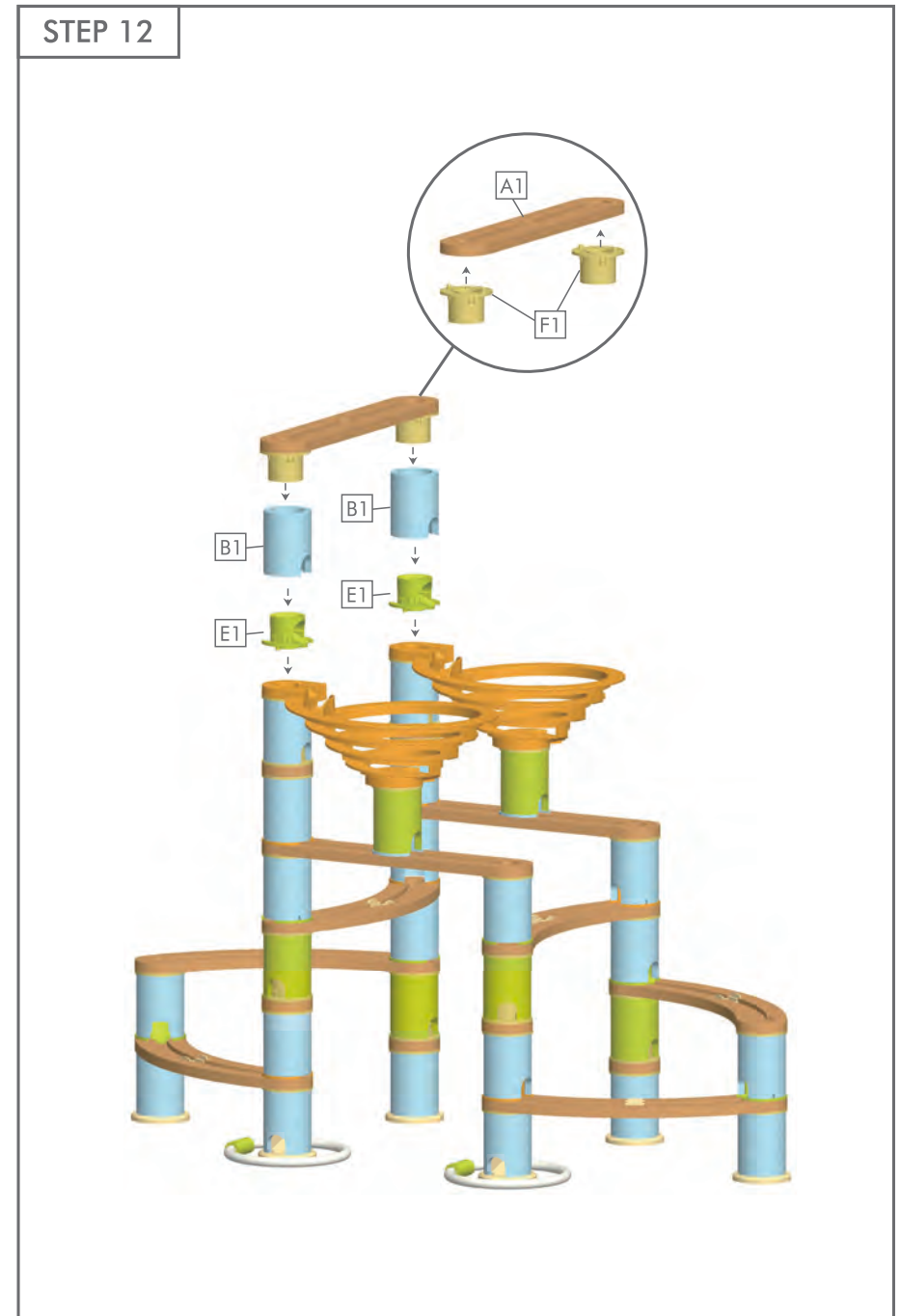
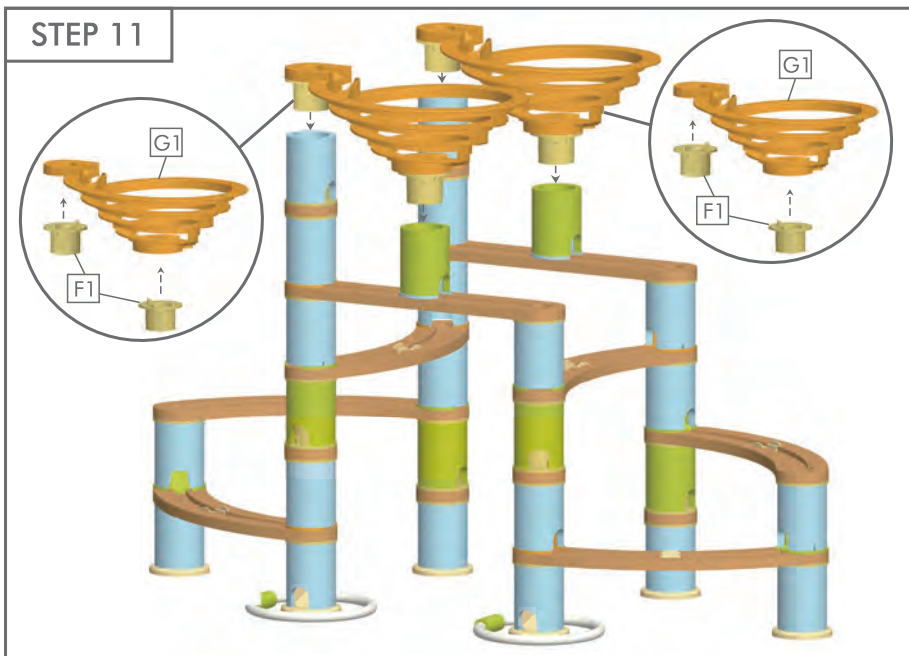
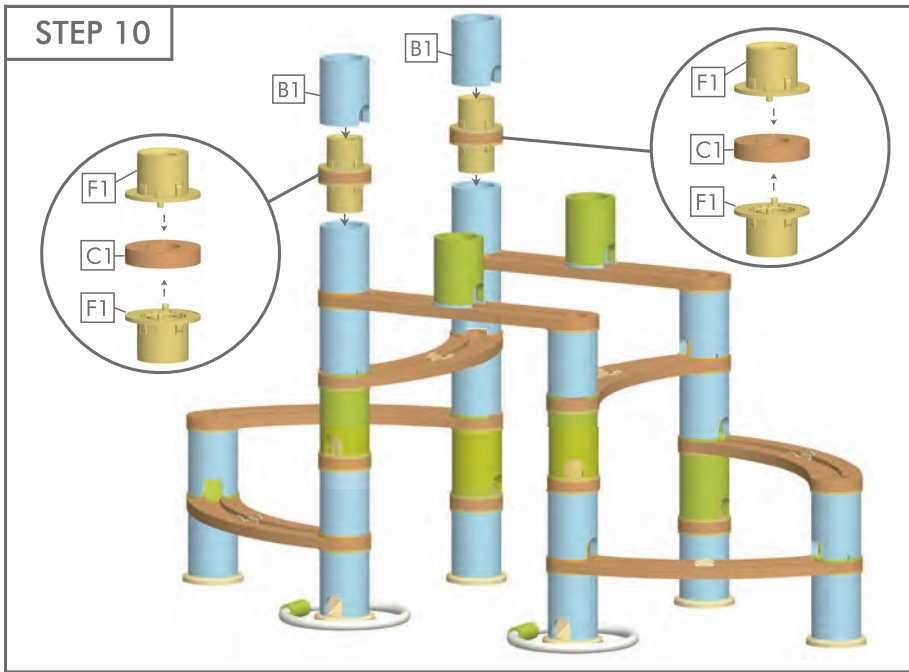

STEP 13

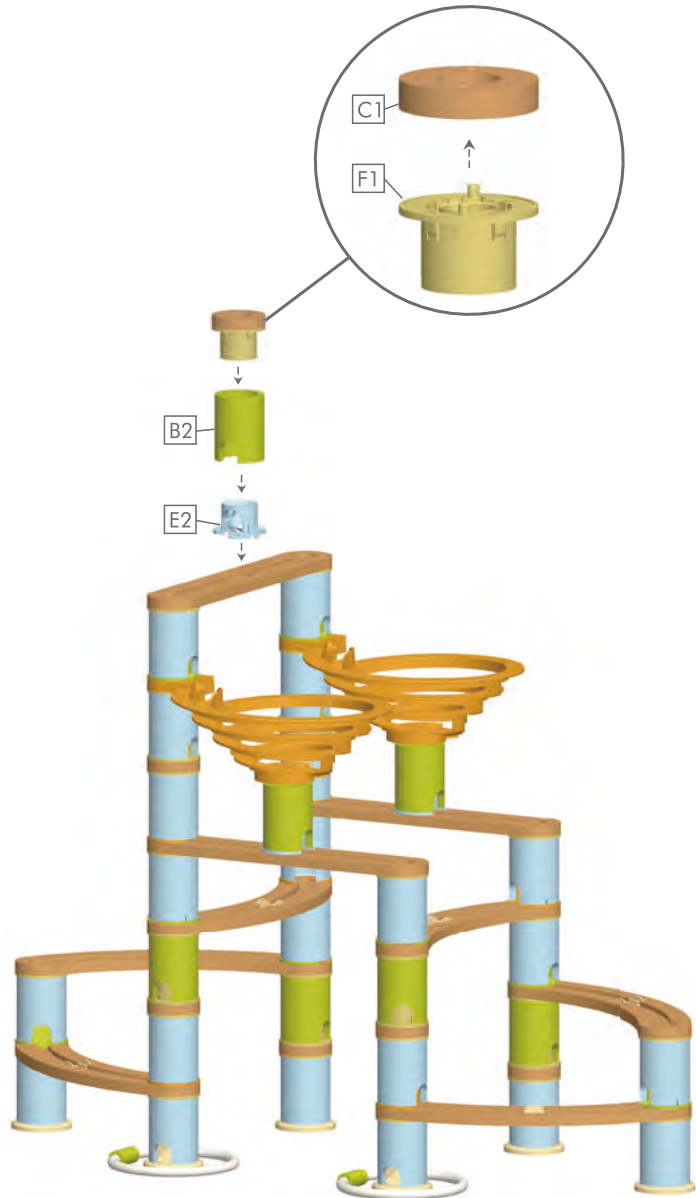

- Jumbo Pack
- Jumbo Packung
- Pack XXL
- Pack gigante
- Pacchetto jumbo
- Jumbopakket

