

ULTRASONIC CLEANER

GT-F5

USER MANUAL



Thank you for purchasing GT SONIC ultrasonic cleaner. Please take the time to read these operating instructions before use and retain them for future reference. Failure to follow these instructions may lead to serious personal injury and damage to property.

Content

01. Overview / Scope of Delivery	2
02. Safety Instructions	3-7
03. Introduction	8-9
04. Operation	9-10
05. Methods of Use	10-11
06. Care and Maintenance	11
07. Specifications	12

01. OVERVIEW/SCOPE OF DELIVERY

Note: Check that all accessories are include and undamaged.



02. SAFETY INSTRUCTIONS

Intended use

The device is designed for private home use only and must not be used for commercial purposes.

The device must only be used indoors.

Possible misuse

The device must only be used according to the purposes described in these instructions.



DANGER for children

//This device is not intended to use by individuals with restricted physical sensory or mental capacities or those with lack of experience or knowledge, include children, unless they are supervised by an individual who is responsible for their safety or have received training in operating the device .

//Cleaning and user maintenance shall not be carried out by children without supervision.

//Store the device and accessories where it is not reachable by children.

//Children must not play with packaging material.

//Do not allow children to play with bags.

//Danger of suffocation.



DANGER of electric shock as a result of moisture

//Do not use this device in the vicinity of bathtubs, showers, washbasins or other vessels containing water.

//Never put the device down in such a way that it could fall into water while still connected.

//Protect the device from moisture, dripping water or splash water.

//Never touch the device with the wet hands.

//The device ,the cable and the mains plug must not fall into water or other liquids.

//If the device has fallen into water,pull out the mains plug immediately, and only then remove the device from the water.Do not use the device again,but have it checked by a specialist.



DANGER of electric shock

//Do not operate the device if it or the cable shows visible signs of damage or if the device has been dropped.

//Only connect the mains plug to a properly installed socket, which is easily accessible and supplies voltage matching the rating plate. The socket must still be easily accessible after connection.

//Ensure that the cable not damaged by sharp edges or hot surfaces. Do not wrap the cable around the device (cable break danger!)

//Make sure the cable is not trapped or crushed.

//Always pull on the plug and never on the cable when removing the device.

//Remove the mains plug from the socket, when after each use, if a fault occurs, when you are not using the device, before cleaning the device and during thunderstorms.

//To avoid any risk, do not make any changes to the device or accessories.

//Do not replace the cable yourself either. Repairs must only be carried out by a specialised company.

WARNING! Risk of material damage

//Use the original accessories only.

//Never place the device on hot surfaces or near heat sources or open fire. Place the device on a dry and even surface.

//Do not place the device on a soft surface that might cover the openings.

//Do not operate the device when the tank is empty.

Dry running will damage the device.

//When filling the tank,always ensure that the “MAX” marking is not exceeded.

//Do not run the device for extended time or continuously .

//Do not use aggressive or abrasive cleaners.

//Do not hit the device.Be careful when moving the device.

//Do not expose the device to temperature below -10°C or above +40°C.



CAUTION!

//No liability is assumed for scratched or damaged object.

Objects to be cleaned(application examples):

//Personal Items:Glasses,Dentures,Tooth brushes,razor blades, baby items,etc.

//Jewelry:Necklaces,rings,earrings,bracelets,watch chains,coins,etc.

//Metal parts:Coins,medals,badges,valves ,etc.

CAUTION!

Loosely framed stones,glued ornaments on decorative items as well as loose items could be detached during the cleaning process.Ask your dentist particularly in case of dentures including veneers.

The following object are not suitable for ultrasonic cleaning:

//Genuine pearls,semi-precious stones, costume jewelry or soft stones such as pearls,turquoise,coral,emeralds,etc.

//Object that can easily be discoloured,waterlogged or damaged.

//Wooden items,leather items,fabric,materials with a sensitive/ already damaged surface,electric devices,polycarbonate lenses (thermoplastics),glasses equipped with coated plastic lenses(even the smallest damage to the surface layer may result in irreparable damages to the material) .

//Mobile phones,watches,glass frames or artworks made from tortoiseshell or abalone.

Cleaning detergent:

//Do not use flammable or explosive detergent.

//Special cleaning detergent should be used in case of difficult and/or stubborn dirt-such as grease,resinifications,rust,wax,pigments, etc.-that cannot be removed with water and all-purpose cleaner.

03. INTRODUCTION

The principle of ultrasonic cleaning

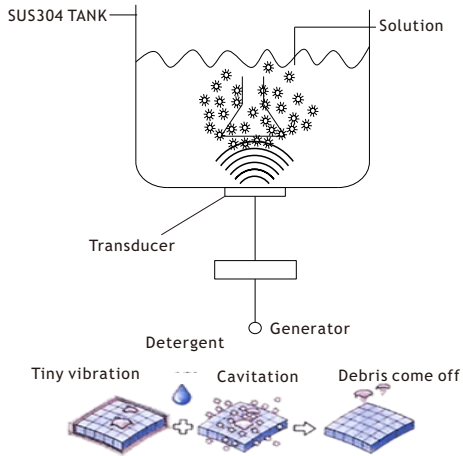

Ultrasonic cleaning is based on the cavitation effect caused by the vibration of high frequency ultrasonic waves in the liquid . Microscopic bubbles are formed. These implode causing the cavitation which create an intense scrubbing action on the surface of the item being cleaned. The bubbles are small enough to penetrate microscopic crevices, cleaning them thoroughly and consistently.

Ultrasonic cleaning is extremely effective in removing dirt and grime which would normally require tedious manual cleaning . It is used to clean a wide variety of instruments and mechanical parts such, returning them to almost “like new” condition without damage to delicate parts.

04. OPERATION

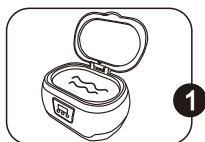

1)Open the lid and fill the stainless steel tank with water.

WARINING: Running device without water may damage device!

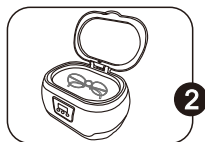

2)Put the objects in the water. The object should be completely immersed. Do not exceed “MAX” level.

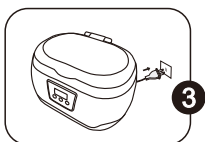

3)Close the lid, connect the power cord to an outlet. LED Display shows “180” as default time(Seconds). Press “SET” button to choose working time. 5 cycle time can be optional 180S, 280S, 280S, 480S, 90S.

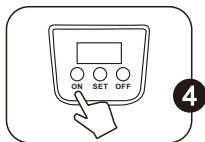

4)Press the “ON” button, to start default 180 seconds working time.

Note: While cleaning, a buzzing sound will be heard. This means the machine is working. Do not continuous working over 30 minutes.

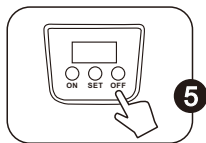

5) If you would like to stop cleaning during working, please press "OFF" button.

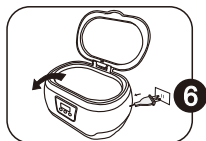

6) When cleaning is completed, unplug the power cord, open the lid, remove cleaned items. Then pour out the dirty water from tank, clean and wipe the tank dry and keep away from child.

Note: Do not soak the operation button during pour out the water.

05. METHODS OF USE



General cleaning

Use normal water for general cleaning. The object should be completely immersed. However, the water should not exceed the maximum fill level.

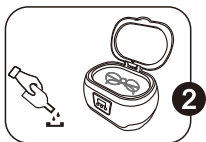

Thorough cleaning

In order to obtain better results, you may add a few drops of universal detergent. We recommend using commercial dishwashing detergent-preferably without an lipid-replenishing substances ("balm").

For professional cleaning purposes, special cleaning detergent can be used. Find out which concentrate is suitable for your objects to be cleaned and the type of contamination.

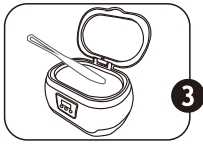

Partial cleaning

For the partial cleaning of bigger objects, use the device with its lid open.

Do not touch the liquid during operation!

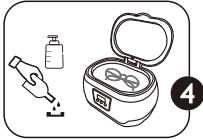

Ultra cleaning

When items require extensive cleaning, use "Thorough Cleaning" procedure first, replace water and repeat "Thorough Cleaning" process until items completely clean.

06. CARE AND MAINTENANCE

DANGER! Before cleaning the device, pull out the power plug. Never immerse the device, cable or power plug in water or another liquid for cleaning and care purpose.

WARNING!

Do not cleaning the ultrasonic cleaner with corrosive detergent or pointed object.

// Use a cloth to cleaning and dry the tank.

// Ensure that there is no residual water left in the tank in order to prevent limescale.

// Store the device in a cool and dry place.

// Keep the device out of children's reach.

// Check the joint of the power plug and cord.

// DO not impact, hit the device. Handle with care when moving the device.

07. Standard Specifications

Model	GT-F5
Ultrasonic Frequency	43 kHz
Tank Material	Stainless Steel SUS304
Tank Capacity	600ml
Timer	90S, 180S, 280S, 380S, 480S
Power Supply	AC100~120V, 60Hz or AC220~240V, 50Hz
Ultrasonic Power	35W
Tank Size	150x90x50(L*W*H)mm
Overall Size	206x145x133(L*W*H)mm
N.W.	895g
G.W.	1.20Kg



Guangdong GT Ultrasonic Co.,Ltd

Tel: +86-755-23356705

Fax: +86-755-29918628

E-mail: service@gtsonic.cn

Web: www.gtsonic.net

**Factory Add: GT SONIC Technology Park,
Meizhou City, Guangdong, China**