

80-20401-40

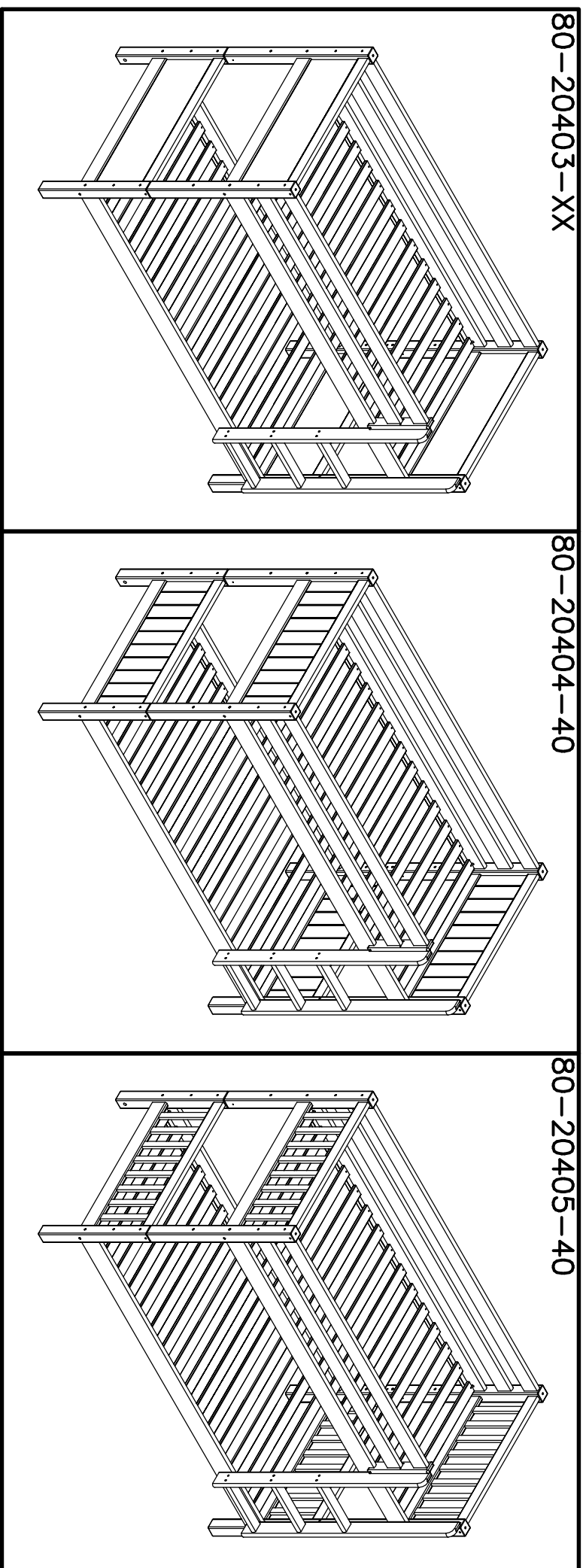

Before assembling this product, please ensure that all the components supplied comply with the list on this page. All Screw-type fittings can be tightened with this tool.

Avant de commencer l'assemblage, veuillez contrôler si tous les objets indiqués sont présents. Tous les vis peuvent être serrés par cet outil.

Bevor Sie mit dem Aufbau beginnen, kontrollieren Sie ob alle auf der Zeichnung angegebenen Teile vorhanden sind. Bitte verwenden Sie zur Montage einen Kreuzschraub-ziehler und den beiliegenden Innensechskantschlüssel.

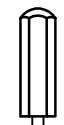

Ware-nr. Part no. Réf No	Stück. Qty. Qté.
Siehe Bild-nr. See picture no. Image no	Mass Dim. Dim.

12-02603182-40	3 stck/pcs.	12-02612641-40	2 stck/pcs.	12-02619676-40	2 stck/pcs.	12-06308655-40	2 stck/pcs.
----------------	-------------	----------------	-------------	----------------	-------------	----------------	-------------

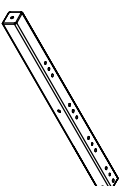
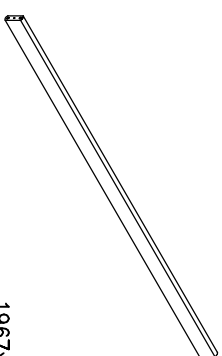
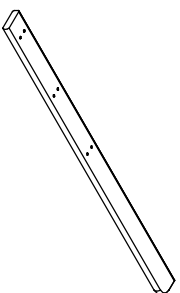
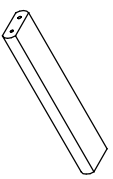

A 12-02603611-40	318x65x26 1 stck/pcs.	D 12-02615712-40	1264x89x26 2 stck/pcs.	F 1305-19672-40	1967x89x26 2 stck/pcs.	H 12-06308656-40	865x63x63 2 stck/pcs.
---------------------	--------------------------	---------------------	---------------------------	--------------------	---------------------------	---------------------	--------------------------

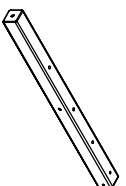
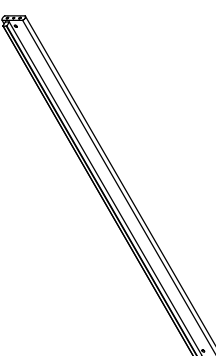
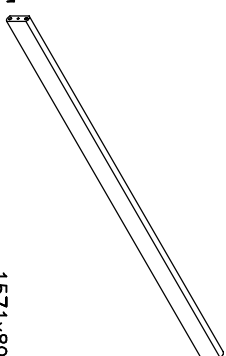
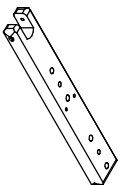

B 3922-08018	8 stck/pcs.	3930-10050	32 stck/pcs.	3909-70100	1571x89x26 10 stck/pcs.	3901-40030	40 stck/pcs.	3913-08110	865x63x63 8 stck/pcs.	3903-40025	2 stck/pcs.	3907-63022	2 stck/pcs.
-----------------	-------------	------------	--------------	------------	----------------------------	------------	--------------	------------	--------------------------	------------	-------------	------------	-------------

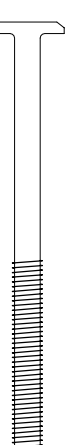
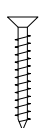
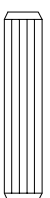

Z1 4007-014	M8/ø12x18 mm. 4 stck/pcs.	Z2 4008-021	ø10x50 mm. 2 stck/pcs.	Z3 3909-70060	ø7x100 mm. 14 stck/pcs.	Z4 3901-30020	ø4x30 mm. 4 stck/pcs.	Z5 3908-70050	4 stck/pcs.	Z6 3934-10080	M8x110 mm. 4 stck/pcs.	Z7 ø8 mm.	Z9 ø4x25 mm.	Z10 ø6,3x22 mm.
----------------	------------------------------	----------------	---------------------------	------------------	----------------------------	------------------	--------------------------	------------------	-------------	------------------	---------------------------	--------------	-----------------	--------------------

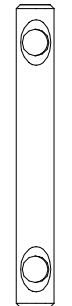
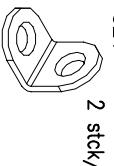
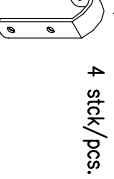

Z12 15,5x3 mm.	Z13 20x20x16x2 mm.	Z15 ø7x60 mm.	Z18 ø3x20 mm.	Z20 ø7x50 mm.	Z21 ø10x80 mm.
-------------------	-----------------------	------------------	------------------	------------------	-------------------

See assembly instruction in box no. 80-20101-40

Voir notice de montage dans la caisse no. 80-20101-40

Siehe Aufbauanleitung im karton no. 80-20101-40

Zie voor de montage-instructie pakketnr. 80-20101-40

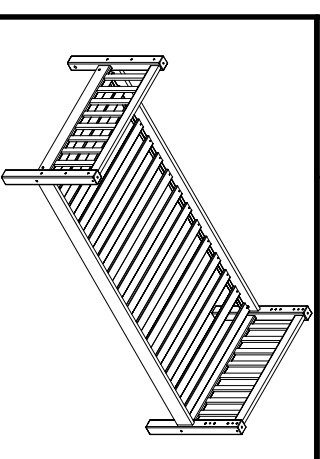
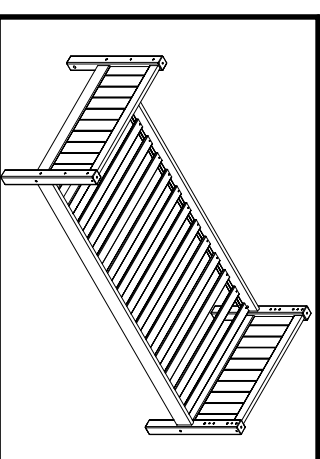
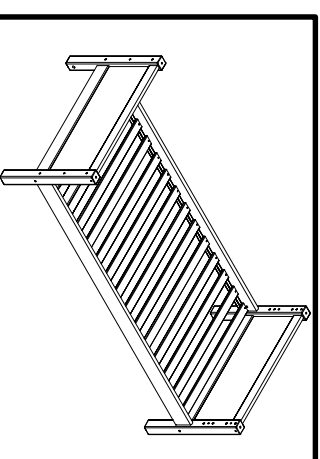

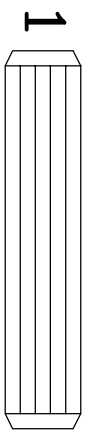

Z2 x24 pcs.

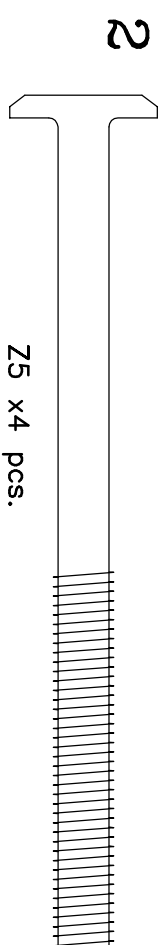
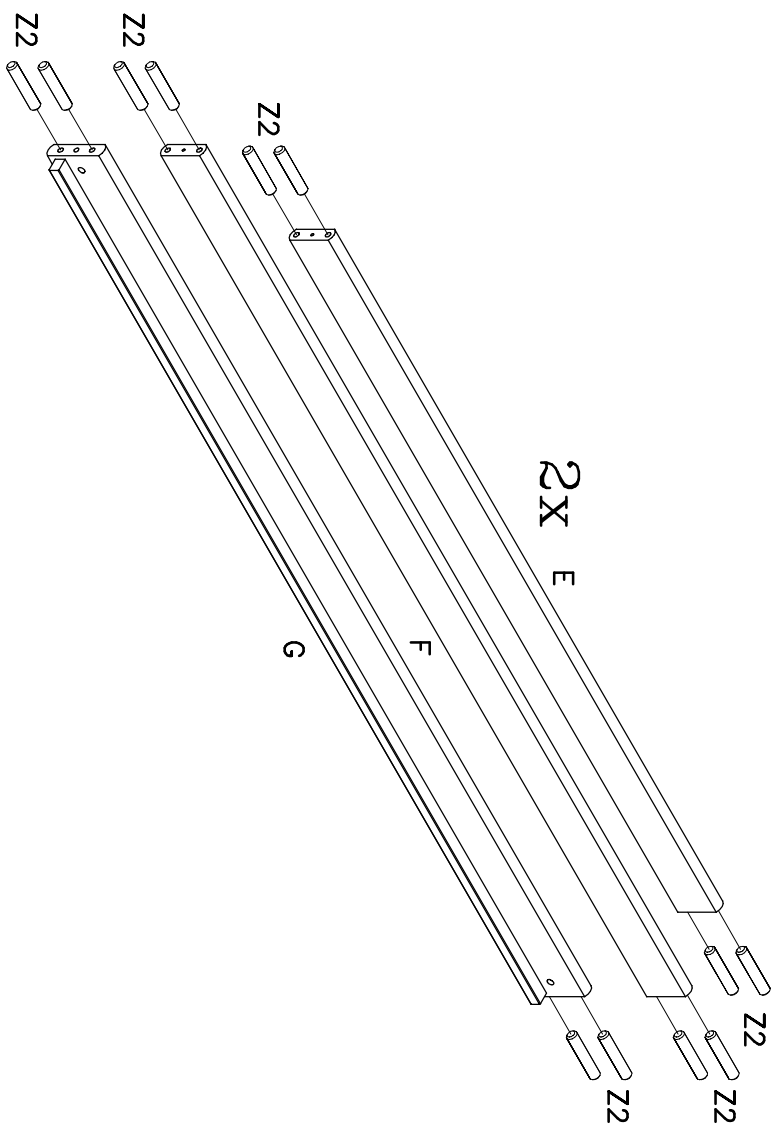

Z5 x4 pcs.

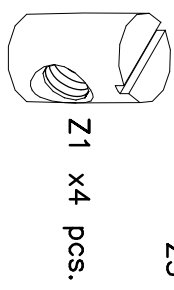

Z1 x4 pcs.

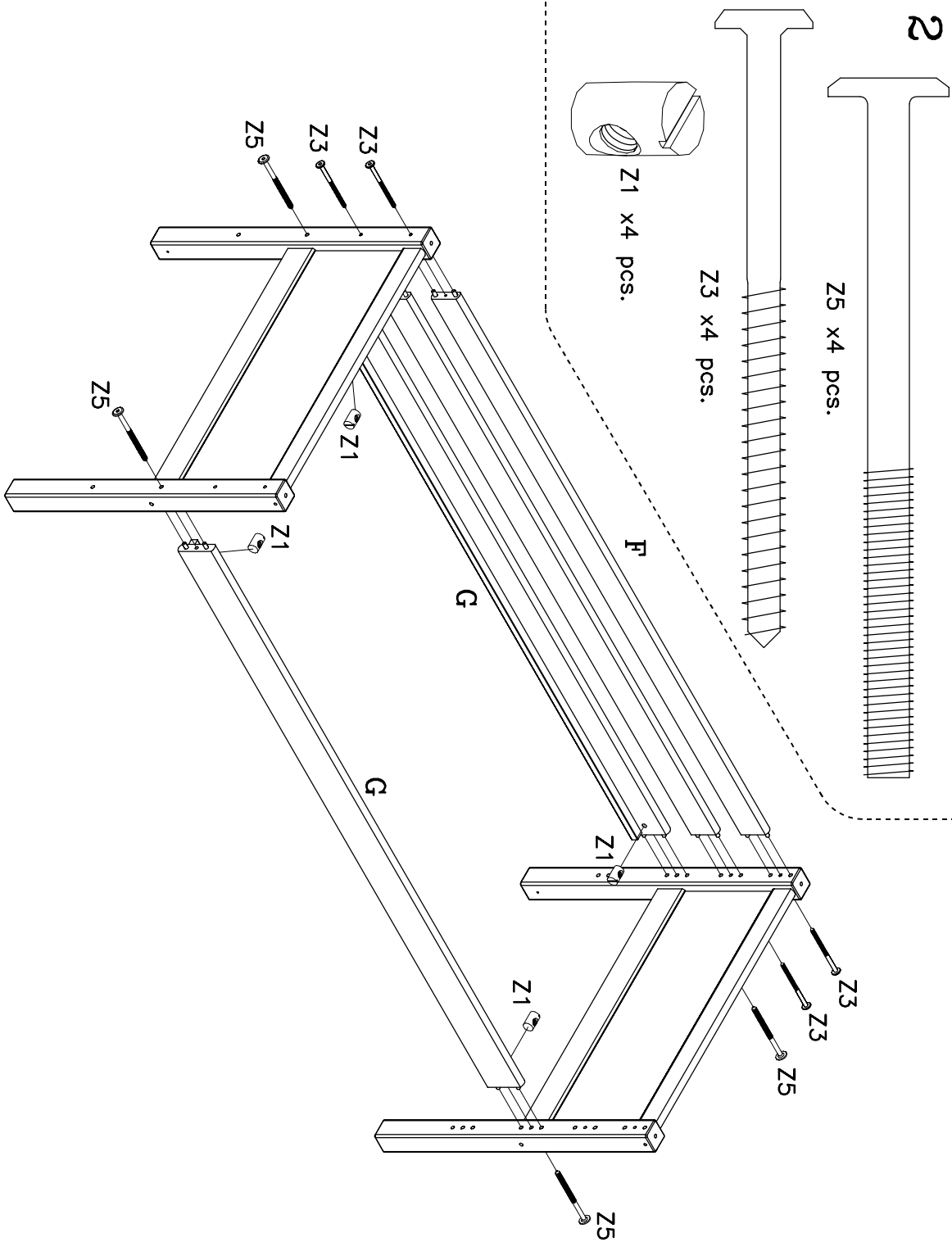

Z4 x6 pcs.



Z4 x24 pcs.

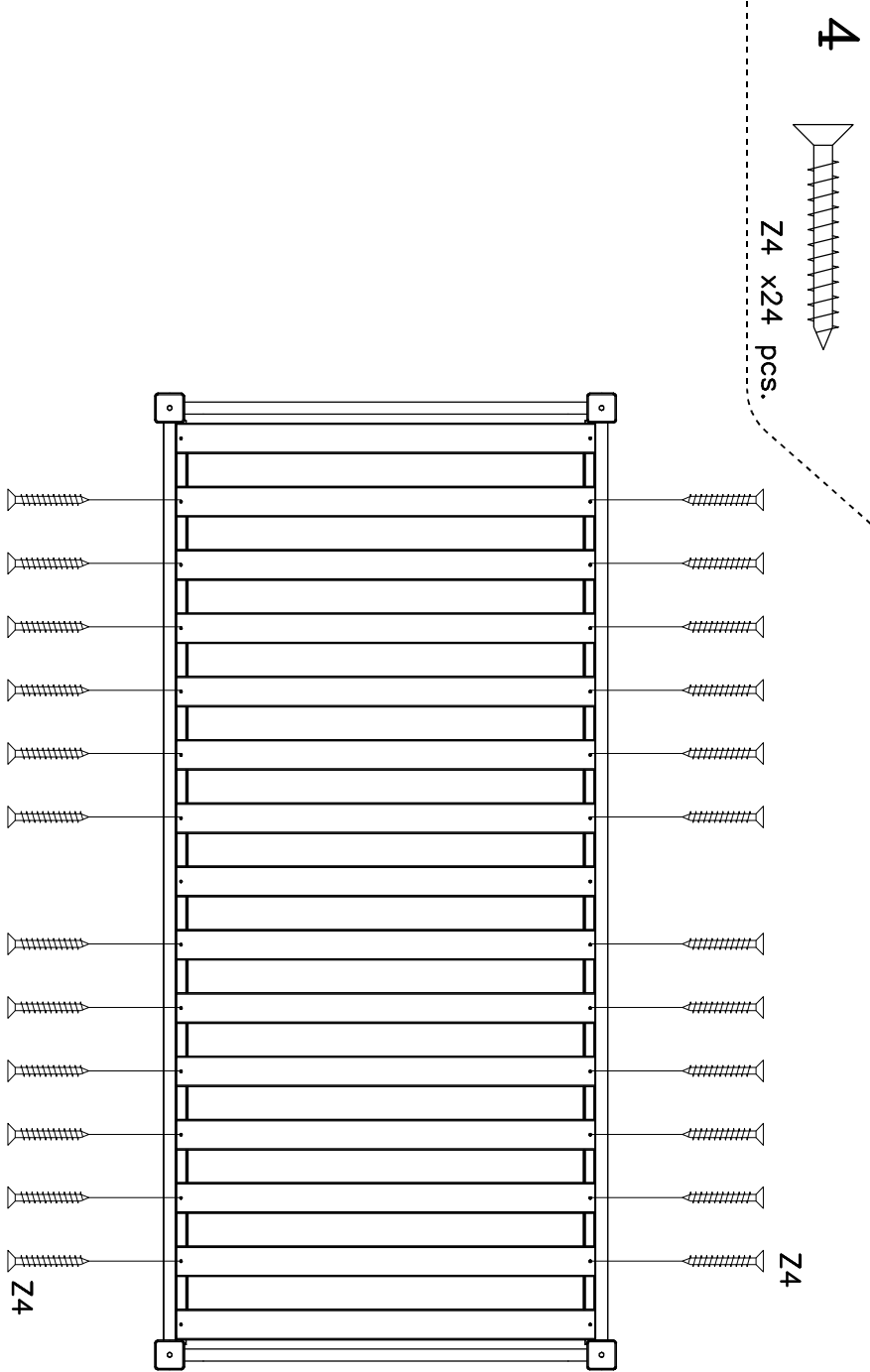
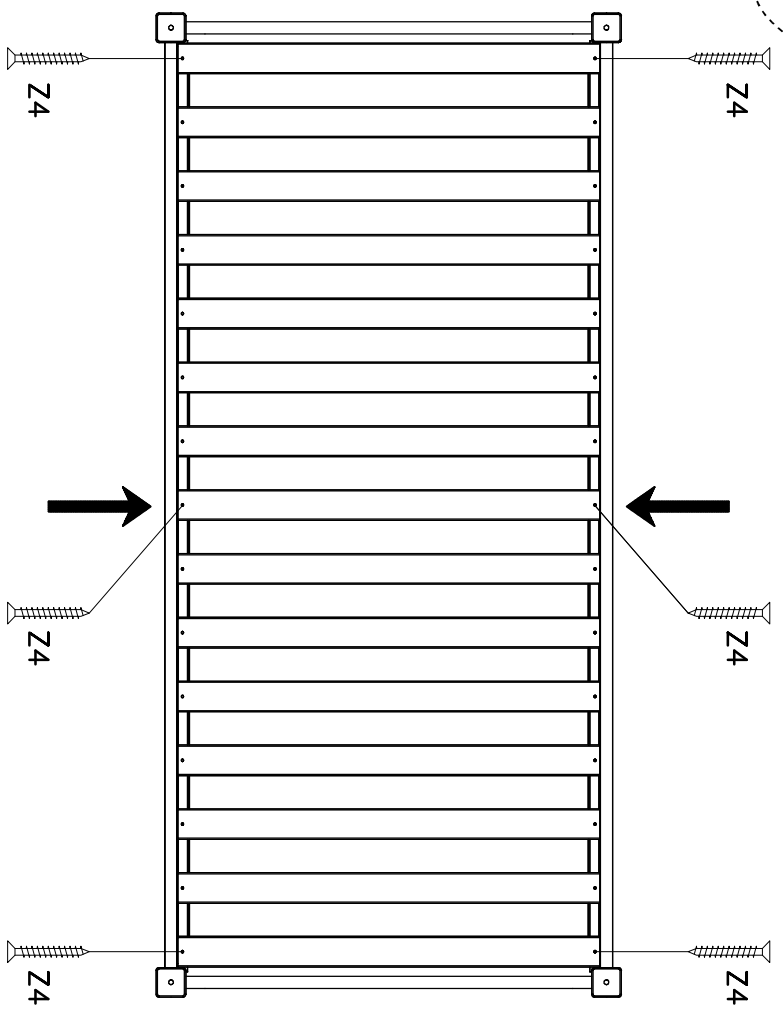

5

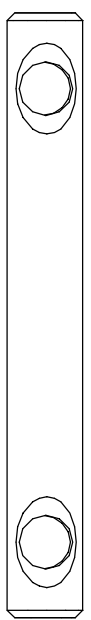

Z21 x4 pcs.

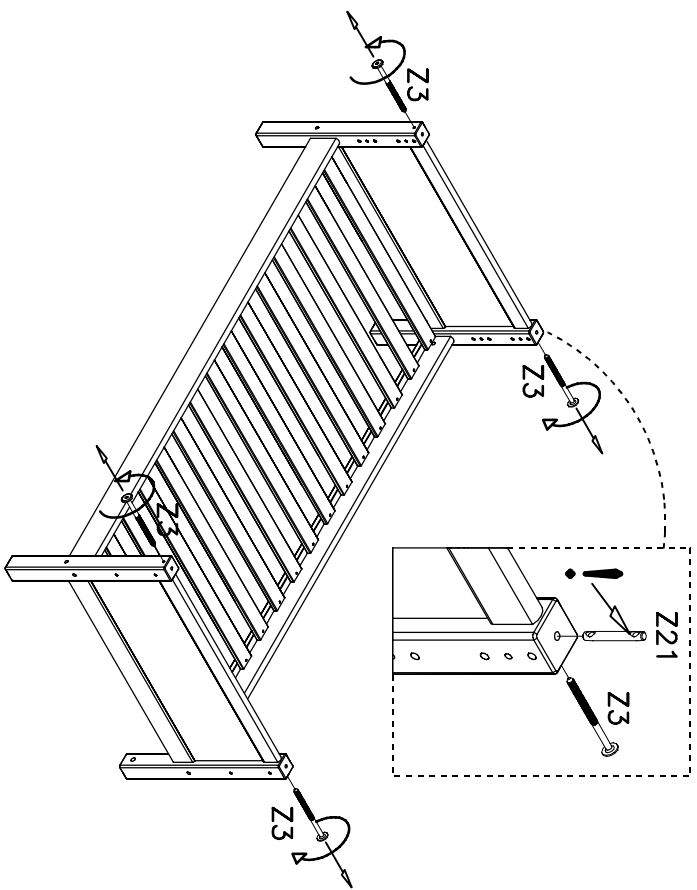

6



Z20 x4 pcs.

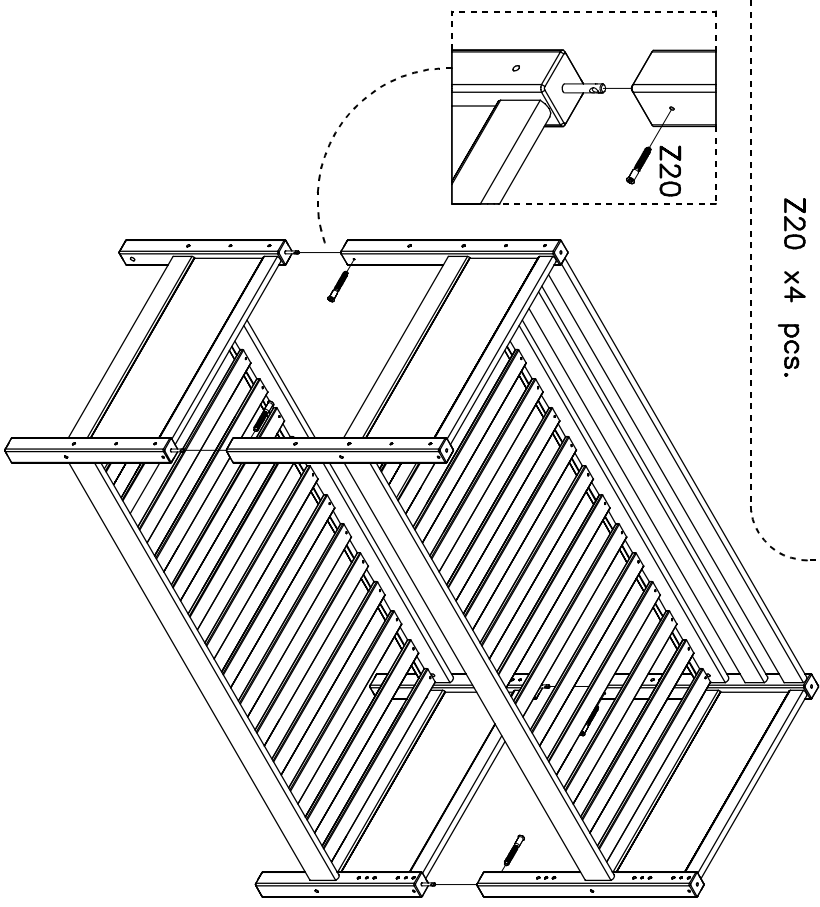

7

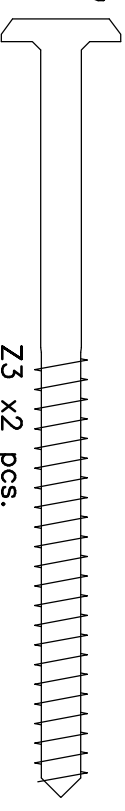

Z3 x2 pcs.

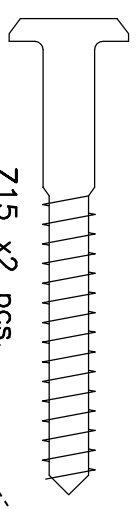

Z15 x2 pcs.

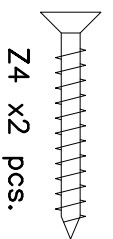

Z4 x2 pcs.

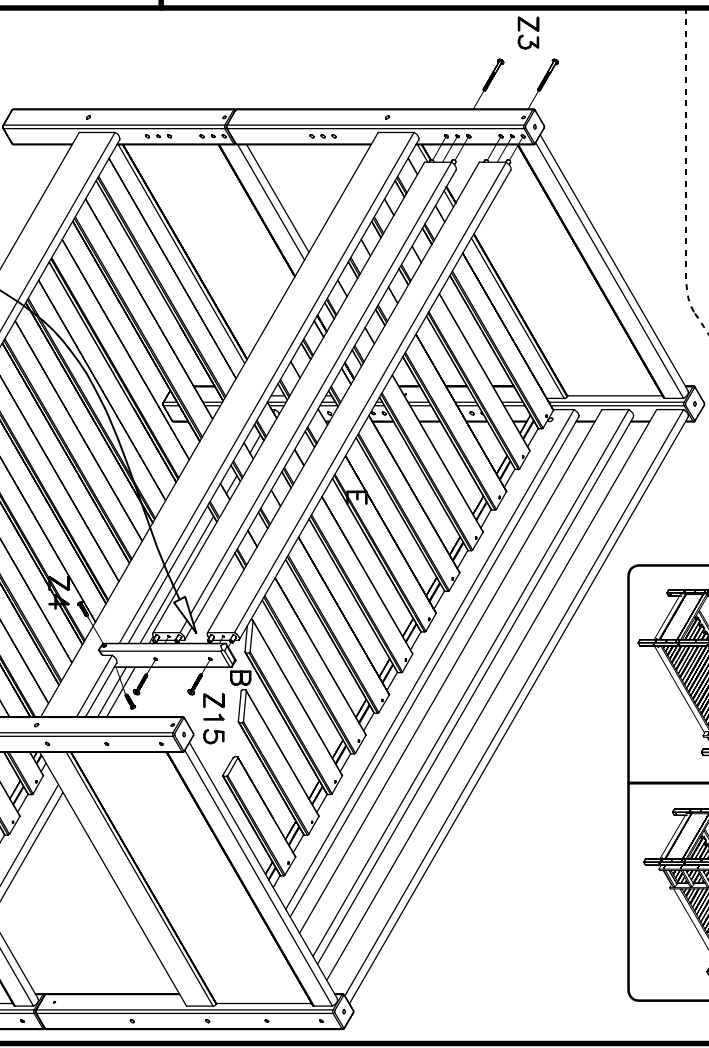
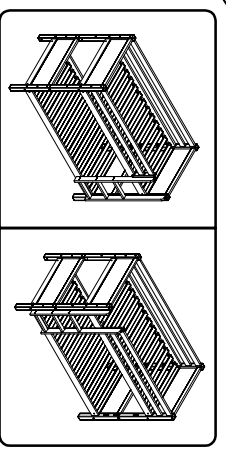

8

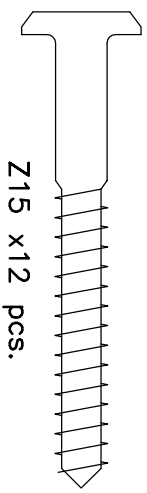

Z15 x12 pcs.

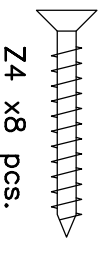

Z4 x8 pcs.

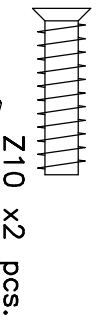

Z10 x2 pcs.

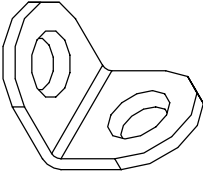

Z13 x2 pcs.

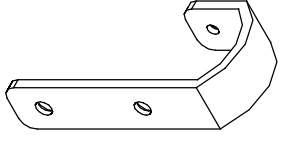

Z12 x4 pcs.

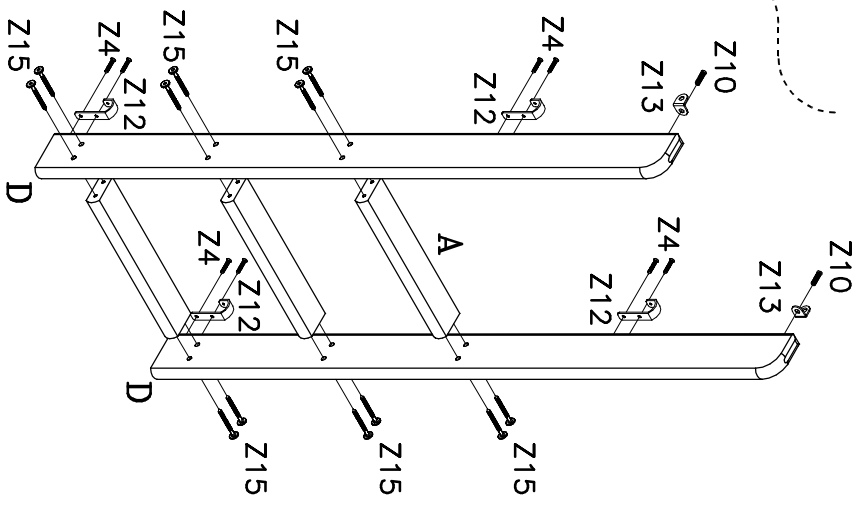

9

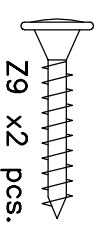

Z9 x2 pcs.

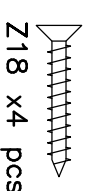

Z18 x4 pcs.

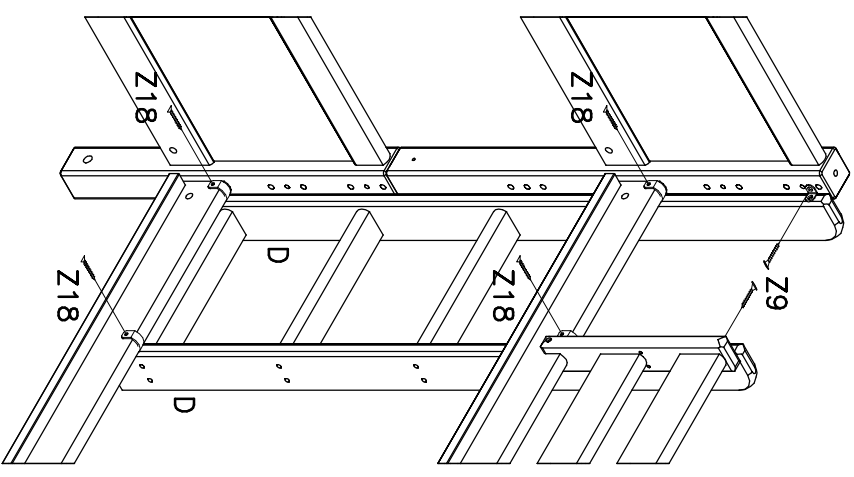

- DK: Max. madrashøjde
- D: Max. Höhe der Matratze
- GB: Max. height of mattress
- F: Hauteur max. du matelas
- I: Altezza max. materasso
- E: Altura del colchón máximo
- NL: Maximale matrashoogte
- CN: 最大床墊之厚度

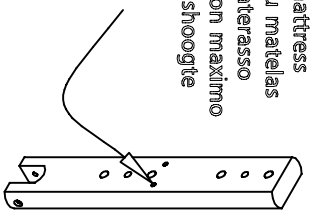

Bunk bed as 2 single beds.
Etagenbett als 2 Einzelbetten.
Comme 2 lits simple.
Stapelbed gemaakt in 2
eepersoonsbedden.

