

Video Doorbell V7 User Manual

1. The Basics

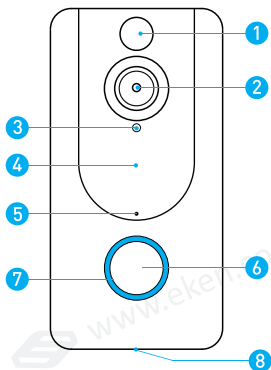

- 1. PIR Motion Sensor
- 2. Wide-angle Lens
- 3. Light Sensor
- 4. Hidden infrared LED

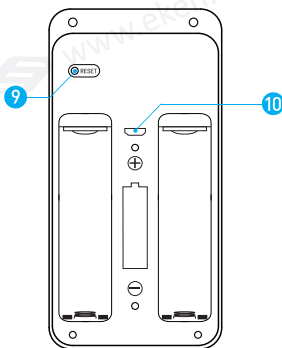

- 5. Microphone
- 6. Doorbell Button
- 7. LED Indicator
- 8. Speaker

Mounting Bracket

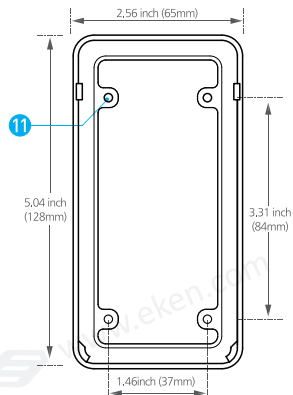

- 9. Reset Button
- 10. Micro USB Port (Battery Charging)
- 11. Mounting Screw Holes *4

In The Box

		
Video Doorbell V7	Mounting Bracket	5 Mounting Screws
		
2 Hardwire / Security Screws	5 Anchors	User Manual
		
Tape	2 Batteries (Optional)	Chime (Optional)

2. Battery

Charging Time: 14 hours using 1A USB charger (not included) (via the doorbell micro USB port)

Please **fully** charge the 18650 batteries before use. With normal use, batteries will last between 4 to 6 months or approximately 1,200 notification events.

Lots of events:

If your device is capturing an excessive number of events every day, you might need to recharge your battery sooner. Plus, the battery is also drained each time you use the Live View to look or speak through your doorbell. To prevent excessive events, you can adjust your motion settings to a lower sensitivity.

WARNING

Be sure to put 18650 batteries in the correct direction. Inserting batteries incorrectly will cause permanent damage.

3. Set up your video doorbell in the LiveHome APP

Micro USB Port For Battery Charging (DC5V)

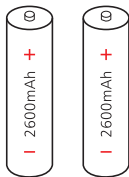

Rechargeable 18650 Battery

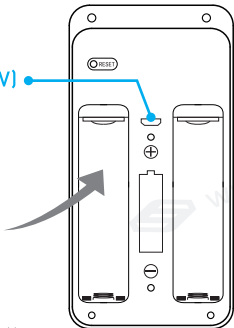

Step 1

Download the LiveHome app. The LiveHome app will walk you through setting up and remotely controlling your Doorbell. Search for "LiveHome" on the Apple app store or Google Play.



LiveHome



iOS



Android

Step 2

Open the battery cover and pull out the insulation tabs.

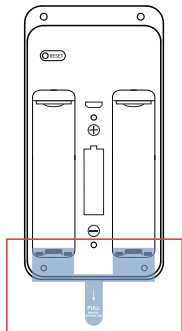

Step 3

Open the LiveHome app on your cellphone. Tap Log in/Sign up. Then tap Sign Up.

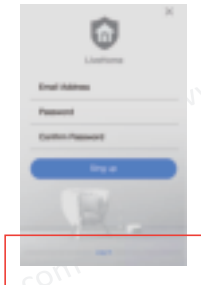

Step 4

Enter your email and password, then tap Sign up.

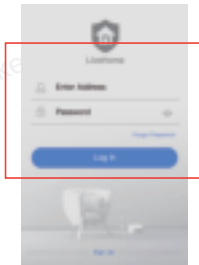

Step 5

You will receive an email with the confirmation code. Please enter the code and tap Confirm. If you want to get another code, tap Resend.



Step 6

Enter your email and password, then tap Login.

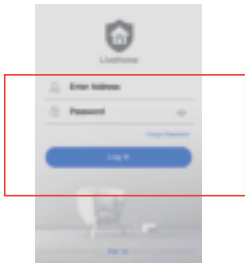

Step 7

Tap "+".



Step 8

Tap "Doorbell Scan" and select Video doorbell.



Step 9

Press and hold the doorbell button for 8 seconds until the doorbell light is flashing red.



Step10

Tap "Yes".



Step11

Name your doorbell. Find the name of your WiFi network and enter the WiFi password. Tap Next.



Step12

Scan the QR code using the doorbell camera. Keep devices 4 inch (10 cm) apart.



Step13

If pairing is successful, you will see a message as below.



5. Install Your Video Doorbell On The Wall

Mark 4 drill holes and use a bit to drill holes in your wall and insert the anchors. Secure your doorbell on the wall with 4 mounting screws and 1 security screw.

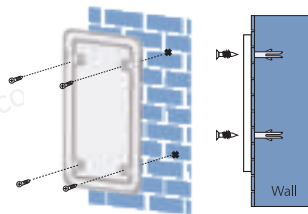

NOTICE:

Be sure to turn on push notifications on your phone.

1. Navigate to Settings -> Notifications -> ON
2. A list of apps that support push notifications will appear.
3. Tap the LiveHome and choose your options.

4. App Live View Interface

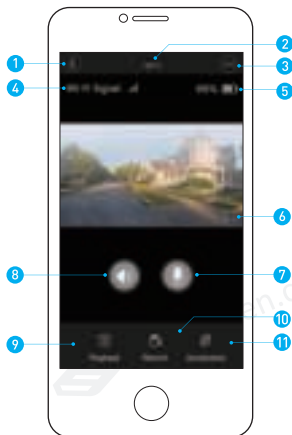

1. Back
2. Device
3. Settings
4. Wi-Fi Signal Strength
5. Battery
6. Landscape Mode
7. Talk to Visitors
8. Sound
9. Playback
10. Record
11. Screenshot

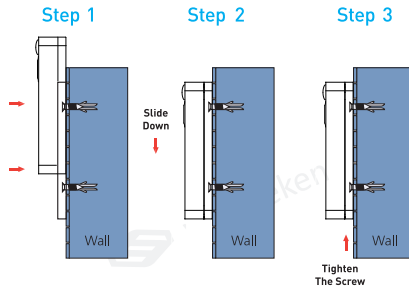

6. Troubleshooting

Q: How long do my videos stay in my account?

A: Your videos are stored in the Free Cloud for up to 7 days.

Q: How do I RESTART the doorbell?

A: Press and hold the RESET Button for 5 seconds.

Q: How do I SET UP the doorbell again?

A: Press and hold the Doorbell Button for 8 seconds. Then follow the in-app instructions to finish your Wi-Fi setup.

Q: How do I share the video doorbell with my family?

A: Open the LiveHome app.

- From the home page, tap the Share icon
- Tap Email share or QR code share

Email share:

The shared user will receive an email with a QR code.

Scan the QR code to download the LiveHome app. The shared user has to register an account (Be sure to use the same email address as before). Log in to the account and you'll see the shared doorbell.

QR code share:

- Open the LiveHome App on a new user's cellphone.
- From the home page, tap "+"
- Tap "Scan QR code", then scan the QR code generated before.
- You will see "Share successful", then tap "Confirm".

Q: How do I adjust PIR motion detection sensitivity?

A: 1. From the home page, tap the settings icon
2. Tap "motion".

PIR Motion Detection Sensitivity

- High: Records and notifies you about every motion. Shortest battery life.

- Medium: Records and notifies you about motion less often. Standard battery life.
- Low: Records and notifies you about motion even less often. Maximum battery life.

Q: How many users can view the video at the same time?

A: Up to 3 users may view the video feed, but only 1 user can use the direct intercom. Both iOS and Android are compatible.

Q: Is 5GHz WiFi supported?

A: No. Only 2.4GHz WiFi is supported.

Q: Why is my Wi-Fi signal poor on my doorbell?

A: Your doorbell maybe too far away from your wireless router or you may have some obstructions in between that reduce signal strength. You might try repositioning your router or getting a signal extender/repeater for your wireless router.

Wireless Chime (Optional)

Connect the video doorbell to the doorbell chime, and get instant alert in your home when someone rings the doorbell. Hear the doorbell chime when you are home, without checking your video doorbell app! The chime plugs into any wall outlet, you can place it anywhere in the home.

NOTICE:

The video doorbell is only compatible with our wireless chime, and not compatible with traditional doorbell chimes. The wireless chime is optional. If it is not installed, doorbell notifications will still go directly to the LiveHome app.

1. The Basics

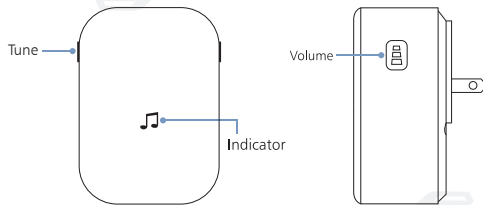

Step 2

Press the Tune button to cycle through 52 different tunes and select a tune.

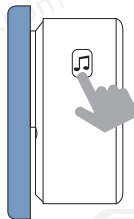

Step 3

Press and hold the volume button for 5 seconds until the blue indicator is ON.

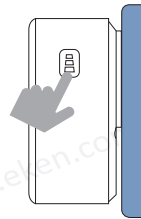

2. Getting Started

Set up your chime with the video doorbell

Step 1

Before the setup process, be sure your video doorbell has connected to your phone and plug in your chime.

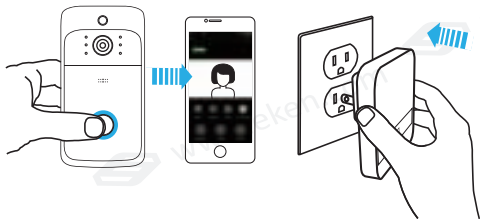

Step 4

Press the doorbell button.

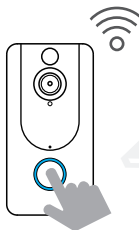

Step 5

Press the doorbell button again, the chime will automatically play the tune you selected.

