

Notice:

1. When you receive this product, make sure that all the necessary parts are available in the package.
2. Before placing your camera onto the tripod, check that all the twist locks are tightened to avoid accidental damage.
3. Please don't unscrew the twist lock too much, otherwise the tripod leg may fall out.
4. Don't exceed the maximum specified load capacity.
5. Avoid using at temperatures under -40°F or above 212°F.
6. Better not use in seawater. Please dry and clean the tripod after used in wet, sandy and dusty environments.
7. Please don't carry your camera together with the tripod when moving around.
8. Keep the tripod away from electric.
9. Please confirm the size with real products.

Contact Us:

✉ info@giftwebshop.com

Produced for Giftwebshop

TRIPOD USER'S MANUAL

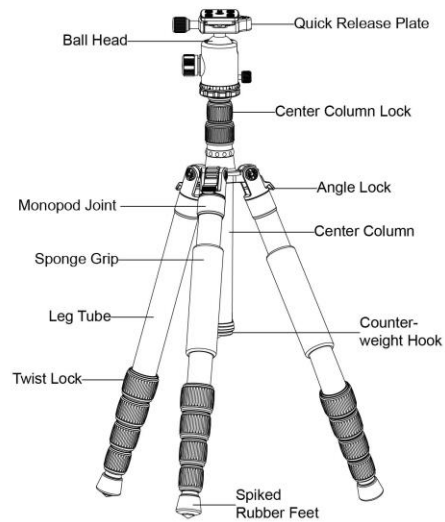

GWS® Tripod with Ball head

TRIPOD USER'S MANUAL

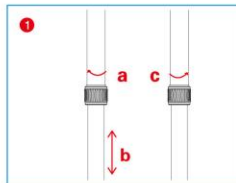

①. Tripod Leg Extension

- a. Rotate clockwise the twist lock on the tripod leg.
- b. Extend the leg to your desired length.
- c. Rotate anti-clockwise to tighten.

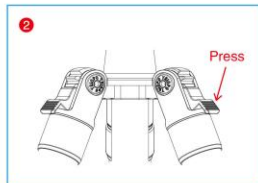

②. Angle Adjustment

- a. Press the button down and adjust it to your desired angle. Let go of the clip once found.
- b. Three different angles provide more versatility.

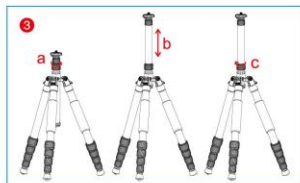

③. Center Column Height Control

- a. Rotate counter-clockwise the twist lock on the center column.
- b. Stretch the center column to the desired height.
- c. Rotate the twist-lock clockwise to fix the height.

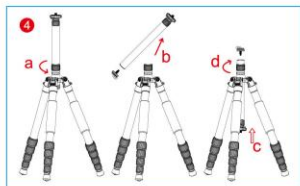

④. Invert the Center Column to Achieve Macro Photography

- a. Rotate counter-clockwise the twist lock of the center column.
- b. Take the center column out.
- c. Install the center column downward.
- d. Tighten the twist lock to fix the height.

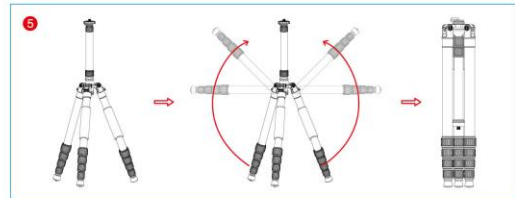

⑤. Folding the tripod 180°

- a. Press the angle-adjustment button to invert and fold back the tripod.

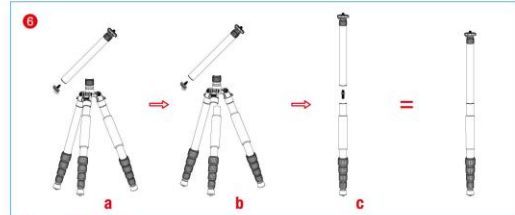

⑥. Monopod Conversion

- a. Unscrew the central-column hook out.
- b. Take the center-column out and unscrew the marked tripod leg.
- c. Screw the central column together with the detached tripod leg.

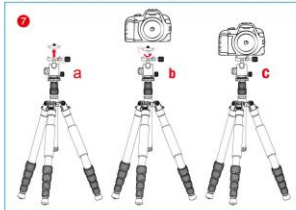

- ### ⑦. Mount your camera to the tripod
- a. Unscrew the quick release plate locking knob and take the plate off.
 - b. Screw the 1/4 thread by hand or use an Allen wrench.
 - c. Mount the quick release plate on the ball head together with the camera.