

Jabra®

# JABRA STEEL

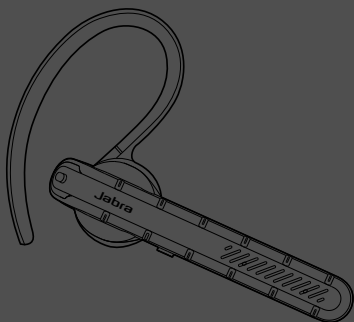

User Manual

[jabra.com/steel](http://jabra.com/steel)

A BRAND BY

 GN Netcom

---

© 2015 GN Netcom Inc. All rights reserved. Jabra® is a registered trademark of GN Netcom A/S. All other trademarks included herein are the property of their respective owners. The Bluetooth® word mark and logos are owned by the Bluetooth SIG, Inc. and any use of such marks by GN Netcom A/S is under license. (Design and specifications subject to change without notice).

---

MADE IN CHINA      FCC ID: BCE-OTE26  
MODELO: OTE26      IC: 2386C-OTE26



 **Bluetooth®**

---

**Declaration of Conformity** can be found on  
[www.jabra.com/CP/US/declarations-of-conformity](http://www.jabra.com/CP/US/declarations-of-conformity)

1. WELCOME .....	4
2. HEADSET OVERVIEW .....	5
3. HOW TO WEAR.....	6
3.1 CHANGE EARGELS	
3.2 ATTACHING THE EARHOOK	
3.3 USING THE WINDSOCK	
4. HOW TO CHARGE THE BATTERY .....	9
5. HOW TO CONNECT.....	10
5.1 CONNECT TO MOBILE DEVICE	
5.2 CONNECT TO MOBILE DEVICE (NFC)	
6. HOW TO USE .....	12
6.1 CALLS	
6.2 HEADSET VOICE CONTROLS	
6.3 HEADSET VOICE GUIDANCE	
6.4 PHONE VOICE COMMANDS (SIRI, GOOGLE NOW, CORTANA)	
6.5 MULTIPLE CALL HANDLING	
7. SOFTWARE .....	17
7.1 JABRA ASSIST	
8. SUPPORT .....	18
8.1 FAQ	
8.2 HOW TO CARE FOR YOUR HEADSET	
9. TECHNICAL SPECIFICATIONS .....	19

# 1. WELCOME

Thank you for using the Jabra Steel. We hope you will enjoy it!

## **JABRA STEEL FEATURES**

- Use the headset in wet or dusty environments
- Headset voice guidance
- Headset voice controls/commands\*
- Voice button for Siri/Google Now/Cortana\*
- Connect with NFC\*
- HD voice compatible
- Up to 6 hours talk time
- Power Nap for extended standby time
- Dual microphones for noise cancellation
- Wireless freedom - Up to 30m/98ft\*

\*Phone/network dependent

## 2. HEADSET OVERVIEW

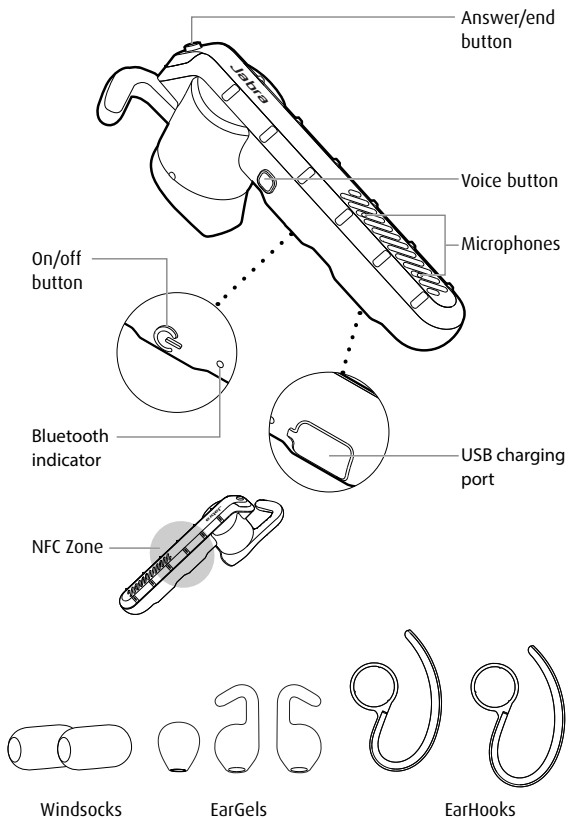

## 3. HOW TO WEAR

The headset can be worn with or without the EarHook, on the left or right ear. Additional EarHooks and EarGels are available in the pack.

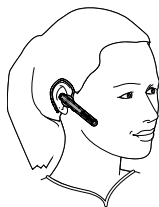
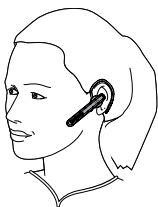

### 3.1 CHANGE EARGELS

---

Choose between different ergo-designed EarGels for optimal fit and comfort.

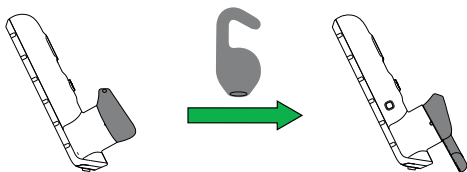

## 3.2 ATTACHING THE EARHOOK

---

The EarHook can be attached to the headset if the EarHook fit is preferred.

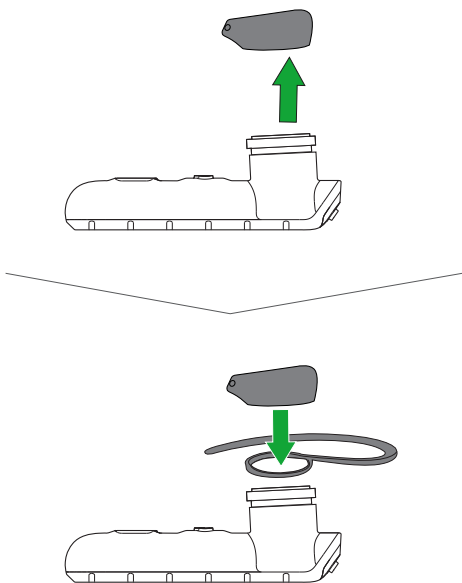

### 3.3 USING THE WINDSOCK

---

To significantly reduce wind noise, gently slide the windsock over the end of the headset, ensuring the microphones are fully covered.

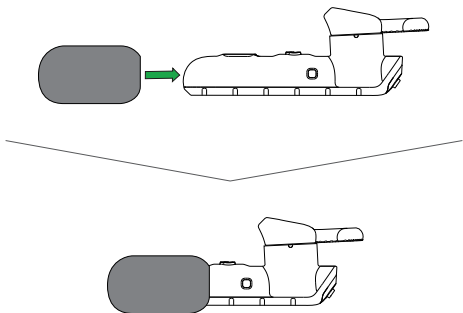



## 4. HOW TO CHARGE THE BATTERY

1. Pull back the charging cover on the headset to expose the USB charging port.
2. Connect the headset to a USB power supply using the supplied USB cable.

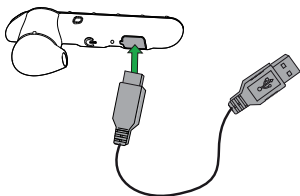

**NOTE:** For safety reasons, it is recommended not to use the headset while it is charging.

It takes approx. 2 hours to fully charge the headset.

# 5. HOW TO CONNECT

## 5.1 CONNECT TO MOBILE DEVICE

---

1. Turn the headset on.
2. Press and hold (3 secs) the **Answer/end** button until the Bluetooth indicator flashes blue.
3. Wear the headset and follow the voice-guided instructions.

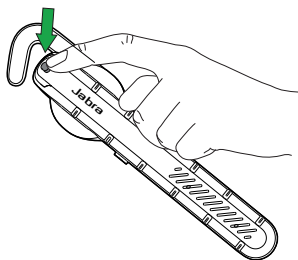

## 5.2 CONNECT TO MOBILE DEVICE (NFC)

---

1. Turn the headset on.
2. Slide the NFC zone of the headset against the NFC zone of the mobile device until a connection is confirmed.

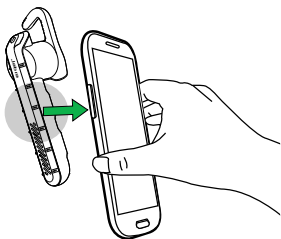

# 6. HOW TO USE

## 6.1 CALLS

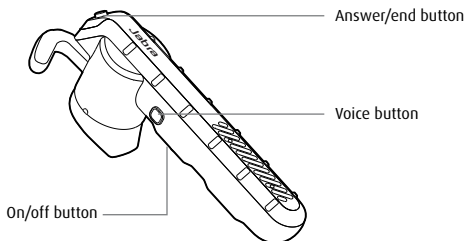

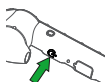
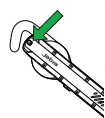
FUNCTION	ACTION
 On/Off	Press (3 secs) the <b>On/off</b> button
Answer/end call	Tap the <b>Answer/end</b> button, or say 'Answer'
 Reject call	Double-tap the <b>Answer/end</b> button, or say 'Ignore'
Redial last number	Double-tap the <b>Answer/end</b> button, when not on a call
Headset battery status	Tap the <b>Answer/end</b> button, when not on a call

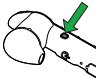
	Activate Siri/ Google Now/ Cortana (phone dependent)	Tap the <b>Voice</b> button, when not on a call
	Activate headset voice controls	Press and hold (1 sec) the <b>Voice</b> button, when not on a call. Say 'What can I say?' for a list of controls.
	Mute/unmute	Tap the <b>Voice</b> button, when on a call

## 6.2 HEADSET VOICE CONTROLS

Headset voice controls are commands you can speak to control the headset.

WHAT YOU CAN SAY	WHAT IT MEANS
Answer	Answer incoming call
Ignore	Reject incoming call
What can I say?	Hear a list of all voice controls
Pair new device	Connect to a new mobile device
Battery	Hear the headset battery level
Call back	Redial a missed call
Phone commands	Activate Siri/Google Now/Cortana
Redial	Redial the last number called

Voice controls are available in the following languages: English (US), Chinese (Mandarin), Japanese, German.

Language packs can be downloaded online. If the headset language is changed, please refer to that language's user manual for the correct voice controls.

## 6.3 HEADSET VOICE GUIDANCE

---

Headset voice guidance are voice announcements intended to guide you or give headset status updates (e.g. connection and battery status).

Voice guidance is available in the following languages: English (US), Chinese (Mandarin), Japanese, German.

Language packs can be downloaded online.

## 6.4 PHONE VOICE COMMANDS (SIRI, GOOGLE NOW, CORTANA)

---

Phone voice commands are spoken commands you can give to the headset to operate Siri, Google Now, or Cortana on your mobile phone. For more information on using Siri, Google Now, or Cortana, please refer to your phone's user manual.

---

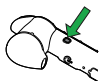

Activate Siri/Google  
Now/Cortana  
(phone dependent)

Tap the **Voice** button,  
when not on a call

---

## 6.5 MULTIPLE CALL HANDLING

---

The headset can accept and handle multiple calls simultaneously.

FUNCTION	ACTION
End current call and answer incoming call	Tap the <b>Answer/end</b> button
Switch between held call and active call	Press and hold (2 secs) the <b>Answer/end</b> button
Put current call on hold and answer incoming call	Press and hold (2 secs) the <b>Answer/end</b> button
Reject incoming call	Double-tap the <b>Answer/end</b> button

---

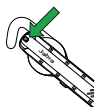



# 7. SOFTWARE

## 7.1 JABRA ASSIST

---

Jabra Assist is a smartphone app that enables GPS tracking of the headset, connection assistance, and headset battery status.

Android download - [Google Play](#)  
iOS download - [App Store](#)

# 8. SUPPORT

## 8.1 FAQ

---

View the comprehensive FAQ on [Jabra.com/steel](https://www.jabra.com/steel).

## 8.2 HOW TO CARE FOR YOUR HEADSET

---

- Always store the headset with the power off and safely protected.
- Avoid storage at extreme temperatures (above 70°C/158°F or below -10°C/14°F). This can shorten battery life and may affect headset operation.

## 9. TECHNICAL SPECIFICATIONS

JABRA STEEL	SPECIFICATION
Weight:	10g
Dimensions:	L 71.5 mm x W 15.4 mm x H 25.5 mm
Microphones:	Dual microphone technology
Speaker:	11 mm dynamic speaker
Operating range:	30 m/98 ft (phone dependent)
Bluetooth version:	4.1
Paired devices:	Up to 8, connected to two at the same time (MultiUse™)
Supported Bluetooth profiles:	A2DP(v1.2), Hands Free Profile (v1.6), Headset profile(v1.2), Phone book access profile (v1.0)
Talk time:	Up to 6 hours
Standby time:	Up to 10 days
Operating temperature:	-10°C to 55°C (14°F to 131°F)
Storage temperature:	-10° C to 70°C (14°F to 158°F)
Pairing passkey or PIN:	0000

