

SAFETY NOTE

- 1, This appliance can be used by children aged from 8 years and above and persons with reduced physical, sensory or mental capabilities or lack of experience and knowledge if they have been given supervision or instruction concerning use of the appliance in a safe way and understand the hazards involved.
- 2, Children shall not play with the appliance.
- 3, Cleaning and user maintenance shall not be made by children without supervision.
- 4, If the supply cord is damaged, it must be replaced by the manufacturer, its service agent or similarly qualified persons in order to avoid a hazard.
- 5, **WARNING:** the drive shall be disconnected from its power source during cleaning, maintenance and when replacing parts.
- 6, The instructions shall state that the A-weighted emission sound pressure level of the drive is equal to or less than 70 dB(A), e.g. by writing $LpA \leq 70 \text{ dB(A)}$.
- 7, The mass and the dimension of the driven part shall be compatible with the rated torque and rated operating time.
- 8, The type of driven part the drive is intended for.
- 9, **WARNING:** Important safety instructions. It is important for the safety of persons to follow these instructions. Save these instructions.
- 10, Do not allow children to play with fixed controls. Keep remote controls away from children.
- 11, Frequently examine the installation for imbalance and signs of wear or damage to cables and springs. Do not use if repair or adjustment is necessary.
- 12, Watch the moving shutter and keep people away until the shutter is completely closed.
- 13, **WARNING:** Important safety instructions. Follow all instructions, since incorrect installation can lead to severe injury.
- 14, Before installing the drive, remove any unnecessary cords and disable any equipment not needed for powered operation.









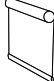

DM35(45,59)S , DM35(45)SD , DM45S/N

Instruction | A-05

Features

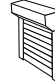
- Mechanical Limit
- Switch Control
- External Controller

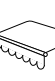
Fields of Application

Scope of application Motor model	 Roller Blinds	 Wooden Venetian Blinds	 Honeycomb Blinds	 Pleated Blinds	 Roller Shutter	 Projector Lift	 Awning	 Roller Door
DM35S	√	√	√	√				
DM35SD	√				√	√		
DM45S	√				√		√	
DM45S/N	√				√		√	
DM45SD	√				√	√		
DM59S							√	√

Specifications

Working Temperature: -20°C ~ +60°C

Rated Voltage: 230V/50Hz

Following data for reference

Model	Rated Torque (N.m)	Rated Speed (rpm)	Rated Power (W)
DM35S-10/17	10	17	121
DM35SD-10/17	10	17	121
DM45S-50/12	50	12	205
DM45S/N-50/12	50	12	191
DM45SD-20/15	20	15	145
DM59S-120/9	120	9	350

* For reference only.

Attention

Never drop, knock, drill or submerge the motor. Keep the power cable in right position as following. Important safety instructions to be read before installation. Incorrect installation can lead to serious injury and will void manufacturer's liability and warranty.

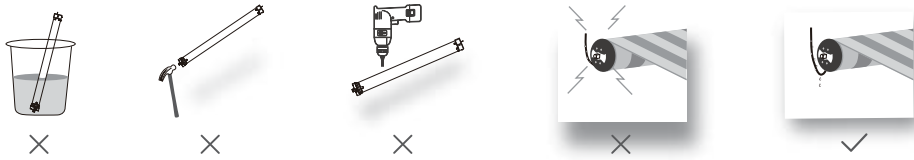

Wiring

Four wires: 230V/50Hz

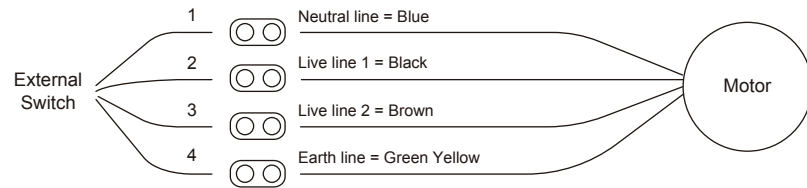

Motor Installation

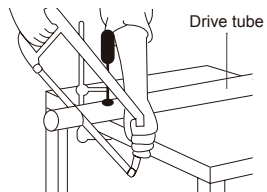

Step 1 Cut drive tube to required length.

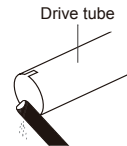

Step 2 Ensure tube edge is clean and burr-free.

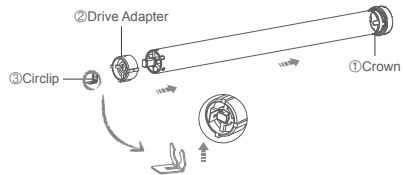

Step 3 Mount correct crown & drive adapter on the motor. Make sure drive adapter fits firmly and crown rotates freely.

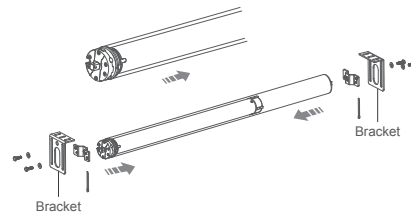

Step 4 Align the notches on the crown and drive adapter with the drive tube, slide and fit the motor into drive tube. Mount idler and bracket on both ends.

Caution

- Do not expose motor to humid, damp or extreme temperature conditions.
- Do not drill into motor.
- Do not cut the antenna and keep it clear from metal objects.
- Do not allow children to play with this device.
- If power cable or connector is damaged, do not use.
- Ensure correct crown and drive adaptor are used.
- Ensure power cable and aerial is clear and protected from moving parts.
- Cable routed through walls shall be properly isolated.
- Motor is to be mounted in horizontal position only.
- Before installation, remove unnecessary cords and disable equipment not needed for powered operation.
- Installation and programming to be performed by a qualified professional, use or modification outside the scope of this instruction may void warranty.

Common Controller



DC227
Wall receiver



DC1680
Wall receiver



DC50
External receiver



DC177E
Dry contact external receiver



DC866
Wall switch



DC2601
Glass panel switch



DC134
Waterproof four-way controller



DC509
Four-way controller

Upper and Lower Limits Setting

1 Set upper limit

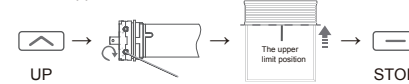

2 Set lower limit

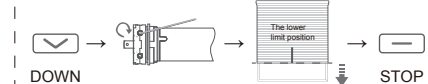

Press UP, motor runs upwards, when it is necessary to increase the upward distance, use a special adjustment lever to rotate the white worm toward the "+" direction, operate the motor to desired upper position, immediately stop rotating the white worm and press STOP once to set the upper limit successfully.

Press DOWN, motor runs downwards, when it is necessary to increase the downward distance, use a special adjustment lever to rotate the red worm toward the "+" direction, operate the motor to desired lower position, immediately stop rotating the red worm and press STOP once to set the lower limit successfully.

*If an external receiver is used, the emitter is used to control the motor operation. If an external switch is used, the switch is used to directly control the motor operation. When the motor is in the stop state, it is forbidden to rotate the white-red worm with the adjustment lever.

Quick Index

	Settings	Steps
1	Upper and Lower Limits Setting	Set upper limit Set lower limit
		Up → Stop Down → Stop

Troubleshooting

Issues	Possible causes	Solution
The motor has no response	Power Failure Or Incorrect Connection	Double check power and cable connections, follow wiring instructions.
The motor doesn't run or starts too slowly or make loud noise	Connections are incorrect.	Check connections
	Incorrect installation or overload	Check installation or overload
The motor stops during the going up or going down.	The motor has reached the lower limit	Adjust the new lower limit
	Running time exceeds 4 min	Consult the sales for more information