

**NOTICE:**  
For the need of technical improvement and system upgrade, information contained herein may be subject to change from time to time without prior notice

Copyright © 2008  
All Rights Reserved.  
Manual Edition 1.0 , July, 2008  
Printed in China

**Edifier**  
www.edifier.com  
EDIFIER INTERNATIONAL LIMITED  
Made in China

Products of Edifier will be customized for different applications. Pictures and illustrations shown on this manual may be slightly different from actual product. If any difference is found, the actual product prevails.

**Edifier**



English

**MI250** Multimedia Speaker

**User's Manual**

Please carefully read this manual before operating the system

**Important safety instructions**

1

Thank you for purchasing this Edifier product. For generations, Edifier tries to provide powered speaker products to satisfy the need of our end customers, even the most demanding ones. This product can add to your home entertainment, personal computer, and mini home theater great sound performance. Please read this manual carefully to obtain the best of this system.

**⚡** The lightning flash with arrowhead inside the triangle, is intended to alert the user to the presence of un-insulated dangerous voltage within the product's enclosure that may be of a sufficient magnitude to constitute a risk of electric shock to persons.

**⚠** **CAUTION**  
RISK OF ELECTRIC SHOCK  
READ MANUAL

To prevent the risk of electric shock, do not remove cover (or back). No user-serviceable Parts inside. Refer servicing to qualified Service personnel only.

**⚠** The exclamation point inside the triangle is intended to alert the user to the presence of important operating and maintenance (servicing) instructions in the literature accompanying the product.

**SAFETY INSTRUCTIONS**  
Please read all the instructions herein. Please retain this manual safely for future reference. Please heed all safety warnings. Please install in accordance with the manufacturer's instructions. Please adjust the volume control to a comfortable level to avoid damaging your hearing and the system.

- Do not expose this apparatus to rain or moisture.
- Do not use the speakers near water, and do not immerse them in any liquid or pour any liquid on them.
- Protect the power cord from being walked on or pinched particularly at plugs, convenience receptacles, and the point where they exit from the apparatus.
- For added protection during lightning storms, unplug the speakers from the electrical outlet and turn off the computer.
- Unplug this apparatus when unused for long periods of time.
- Place the speakers away from all heat sources, such as heaters, stoves, and direct sunlight.
- Do not block the openings in the speaker cabinets. Never push objects into speaker vents or slots. Prevent risk of fire or electric shock hazards, and provide sufficient space around the speakers for proper ventilation.
- Place the speakers in a stable location so that it will not fall causing damage to the speakers or bodily harm.
- Unplug the speakers from the computer and from the electrical outlet before cleaning them with a damp cloth.
- Servicing is required when the apparatus has been damaged in any way, such as the power-supply cord or plug is damaged, liquid has been spilled or objects have fallen into the apparatus, the apparatus has been exposed to rain or moisture, does not operate normally, or has been dropped. Refer all servicing to qualified service personnel only.
- Use the plug or the coupler inlet to disconnect with mains.

**Unpack the box**

2

- Box content
- 2 speakers (with cable)
  - User's manual



User's Manual Passive speaker Active speaker

**Illustrations and functional depict**

3

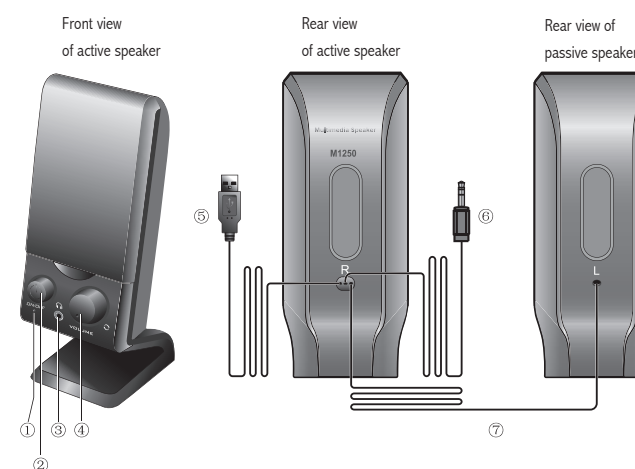

1. Power switch; press in for "ON", and out for "OFF"
2. Power indicator
3. Headphone jack
4. Master volume control
5. USB connector
6. 3.5mm connector for audio input
7. Audio connecting cable between speakers

**Operational guidance**

4

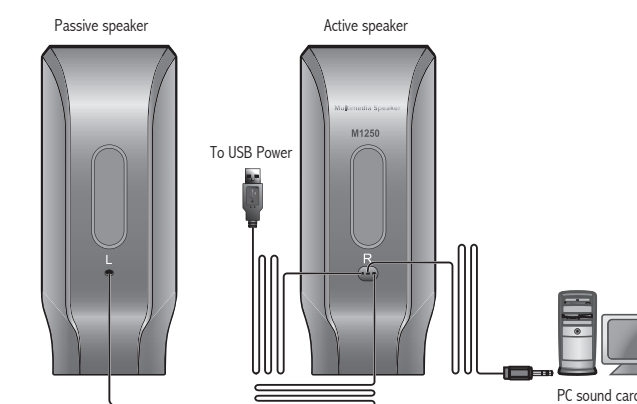

Operational guidance

1. Connect the powered speaker (R) to a PC Souncard using the 3.5mm plug (6) from the pre-wired connection cable. (Please refer to below diagram).
2. Connect the USB cable (5) to an available Computer USB output port
3. Turn the power ON with knob (1) and adjust the Volume (4) to a comfortable level.
4. Plug optional headphones into the built in headphone jack (3) for private listening.

**Specification**

5

Amplifier power output: ----- RMS 0.6W X 2  
Signal to noise ratio: ----- ≥80dBA  
Input socket: ----- 3.5mm Stereo Line-in  
Input impedance: ----- 10Kohm  
Input sensitivity: ----- 250mV±50mV  
Full-range unit: ----- Magnetically shielded, (50mm X 90mm), 4ohm  
Dimensions: ----- Powered speaker: 68(W) X 166(H) X 94(D)mm  
Passive speaker: 68(W) X 166(H) X 86(D)mm  
Weight: ----- About 0.55 Kg

Warnings:

1. Please do not feed powered signal from another amplifier into the input ports of this system!
2. Please adjust to a comfortable volume to avoid damaging your hearing and the system!
3. Dangerous voltage inside the subwoofer enclosure, please do not open the chassis. Refer to qualified personnel for servicing.
4. Please remove the power plug if the system is unused for long period of time.
5. Please do not expose the system in rain or moisture environment.
6. Please do not place vase or utensil full of liquid on the speaker.

**Troubleshooting**

6

- **Not all speakers function**  
Please first check if the speaker wires are connected securely; then check if the Line-in connectors are reversed; check also if the audio source is at fault.
  - **One satellite speaker does not function when playing CD from computer**  
This kind of phenomena is prone to happen on new computer systems that one satellite does not function when playing CD, but system works fine when playing WAV formatted files. This is mainly due to the fault connection of CD-ROM and sound card, that one channel of signal is shorted to the ground. Please refer to the manual of CD-ROM and sound card to adjust the wire connection.
  - **System does not work at all**
    1. Please check if power is connected, and if the wall outlet is switched on.
    2. Please check if the amplifier is still in STBY mode
    3. Please check if the master volume is turned to minimum
    4. Please check if the audio input cable is connected correctly
    5. Please check if there is signal from audio source
  - **Noise coming from speakers**  
Amplifier circuitry of this product generates little noise, while the background noise of some VCD/DVD player or computer sound card are too high. Please keep the system in active mode and remove the audio source, if no sound can be heard at 1 meter away from the system, then there is no problem with this product.
  - **Magnetic interference**  
This system is complete magnetically shielded, and can be placed near TV or monitor. But since magnet of the subwoofer driver is large, some magnetism leakage is inevitable when the system is too close to the monitor, and it is recommended to keep a 1 meter distance between the speaker system and monitor or TV set.
- ☎ **If you have any further questions or concerns regarding Edifier Products**  
Please visit our website at: www.edifier.com, or email Edifier Support for further assistance at: main@edifier.com. If you prefer, you may contact us by phone, Toll Free: 1-877-EDIFIER (334-3437).