

NITHO

DRIVE PRO[®] ONE

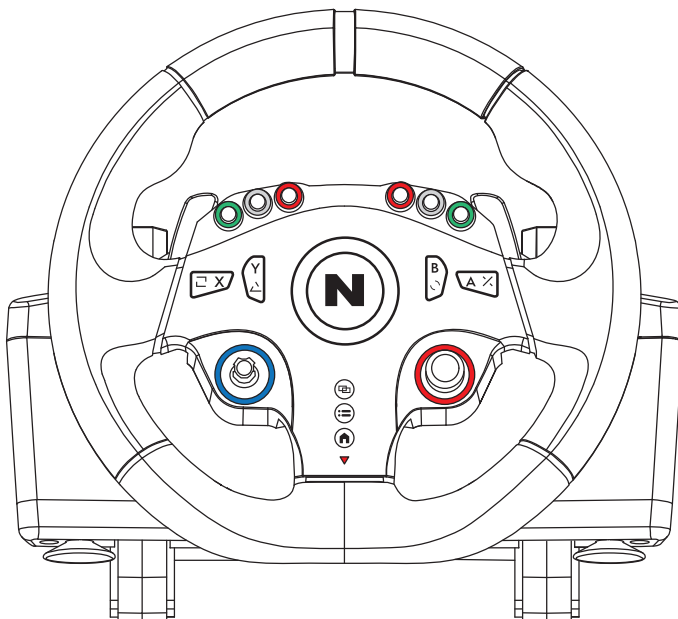

Quick start guide

Thank you for choosing NITHO **DRIVE PRO® ONE**

This start guide will help you through the racing wheel's basic setup for all platforms.

The setup has been developed and tested on every level of racing difficulty.

From the beginners to experienced drivers, NITHO **DRIVE PRO® ONE**

is greatly performing in all kinds of racing games as Gran Turismo, Rally, Formula 1, Formula Drift and allows you to win the podium.

BE THE **ONE** !

Main features

- DRIVE PRO™ ONE racing wheel performs in all main gaming platforms: PC, PS4®, PS3®, Xbox®One, Xbox®Series X/S and Nintendo® Switch®
- PC can be setup in both D-Input and X-Input modes
- Zero deadzone technology for PS4®, Xbox® (all versions) and PC D-Input
- 28 buttons designed for in-race comfort and quick actions
- D-pad stick allows a quicker menu selection and easy in-race control
- Analog stick can be setup as view control or as a D-pad
- Hardened metallic paddles increasing shifting feeling and providing higher race immersion
- Solid clamps can be fastened to any desk with 5.5 cm maximum thickness
- Removable and sturdy suction cups
- Analog and metal plated accelerator and brake pedals
- Separated sequential gear shifter ideal for rally and formula drift races

Play Hard!
With NITHO

Index

Page 1.....	Package content
Page 2.....	First setup
Page 3.....	Clamps installation
Page 4.....	LED compatibility indicator
Page 5.....	PlayStation®4 setup
Page 7.....	Xbox®One setup
Page 8.....	Xbox®Series X S setup
Page 10.....	PC D-input setup
Page 12.....	PC X-input setup
Page 14.....	Nintendo® Switch® setup
Page 16.....	PlayStation®3 setup

Package content

- (1) Racing wheel
- (2) Sequential gear shifter
- (3) Pedals set
- (4) Connection cable USB-A to USB Micro B (for PS4® or Xbox®One controller)
- (5) Connection cable USB-A to USB-C (Type C) (for Xbox®Series X/S controller)
- (6) Connection cable LAN to LAN (for gear shifter)

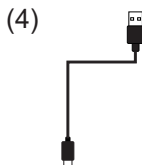
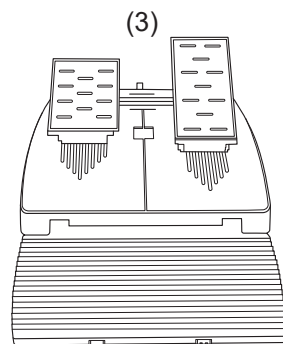
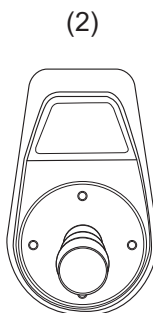
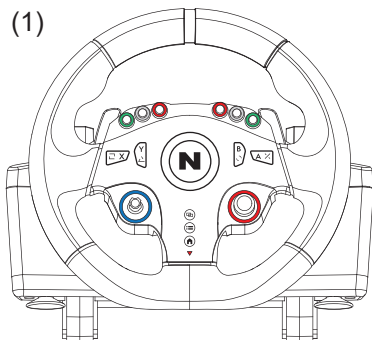

PS4® and Xbox®One

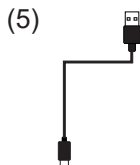

Xbox®Series X/S

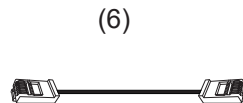

First setup

The following step is same for all the platforms:

- (1) Fasten the racing wheel to a steady desk or wheel stand
- (2) Connect the pedals to the wheel by the LAN port on the back side
- (3) Secure the gear shifter to a steady structure and use the provided detachable LAN cable to connect it to the dedicated port on the back of the wheel

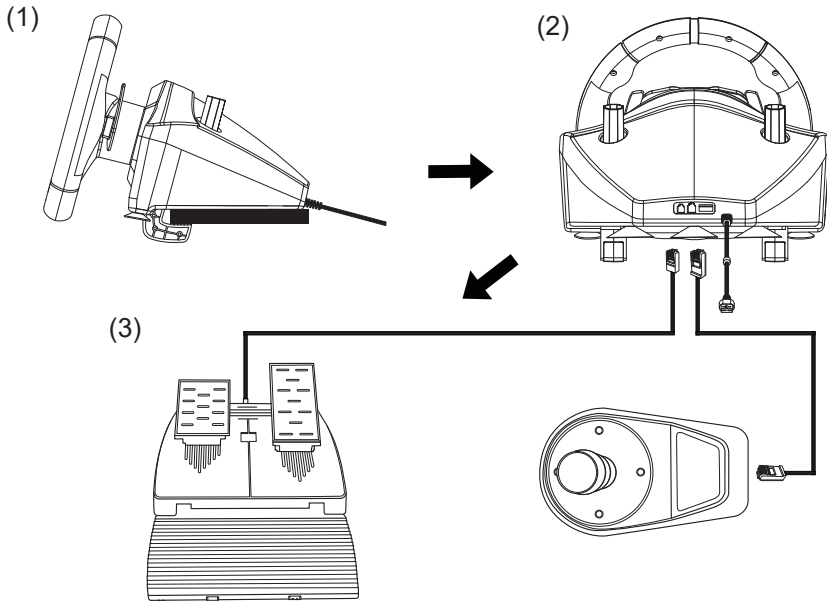

Clamps installation

- (1) 2x C-shape clamps
- (2) 2x Fastening bolts
- (3) 2x Removable extensions

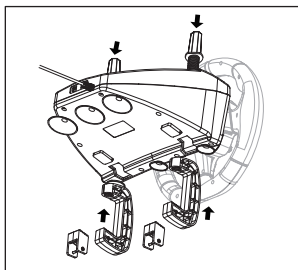
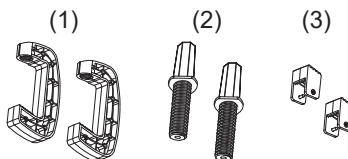

Step 1 - Insert the bolts from the top and the clamps from the bottom, then fasten them together.

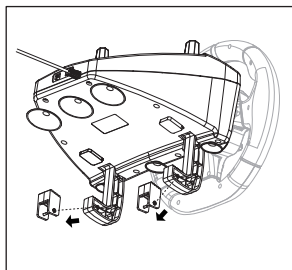

Step 2 - The extensions can be removed if the wheel is mounted on a thick desk.

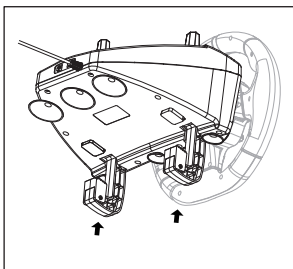

Step 3 - Fasten the clamps according to the thickness of the desk.

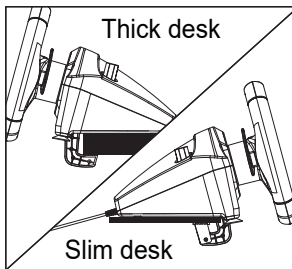

LED compatibility indicator

Different colours LED light indicates to which console the wheel is connected.



Blue - Indicates the connection with PlayStation®



Green - Indicates the connection with Xbox®



Purple - Indicates the connection with PC (D-Input)



Orange - Indicates the connection with PC (X-Input)



Red - Indicates the connection with Nintendo® Switch®

PlayStation®4 setup

- (1) After you have setted the wheel and gear shifter as indicated in page 2, connect the original SONY® controller to the wheel with the USB-A to USB Micro B cable, provided in the packaging.
- (2) Connect the wheel to the console's USB port and turn the console on.
- (3) The wheel's LED automatically switch on blue colour, then press the PS® button on the wheel.
- (4) At this point, the wheel is ready. Play the game and customize your in-game setup, following the “PS4® buttons layout” as displayed in page 6.

Note:

In case you lose the USB-A to USB Micro B cable, you can replace it with any similar cable available in the market, paying attention that it has DATA function.

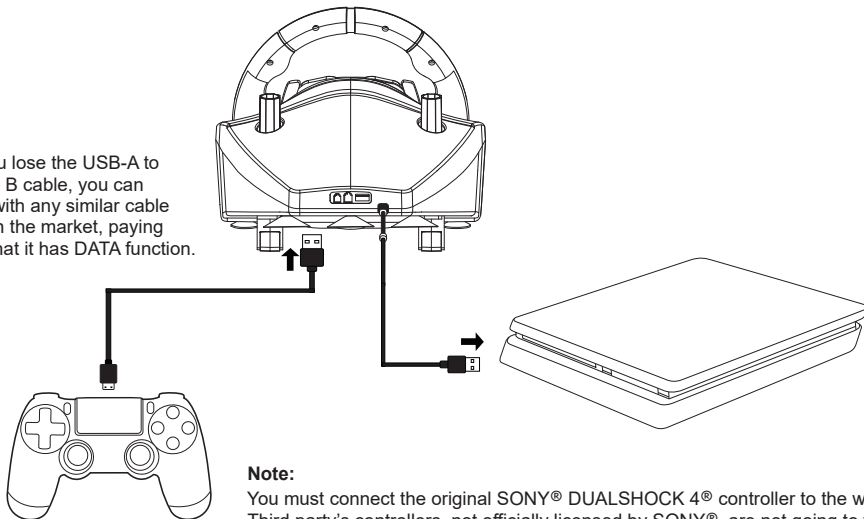

Note:

You must connect the original SONY® DUALSHOCK 4® controller to the wheel. Third party's controllers, not officially licensed by SONY®, are not going to work.

PS4® buttons layout

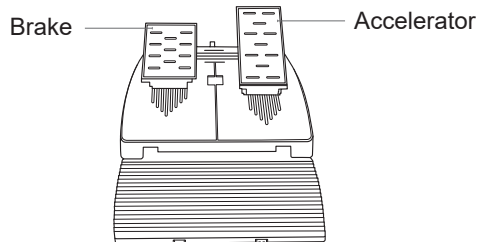
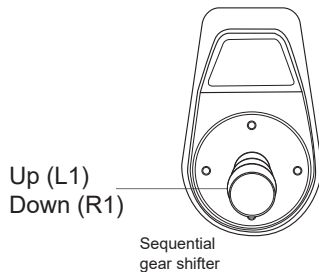
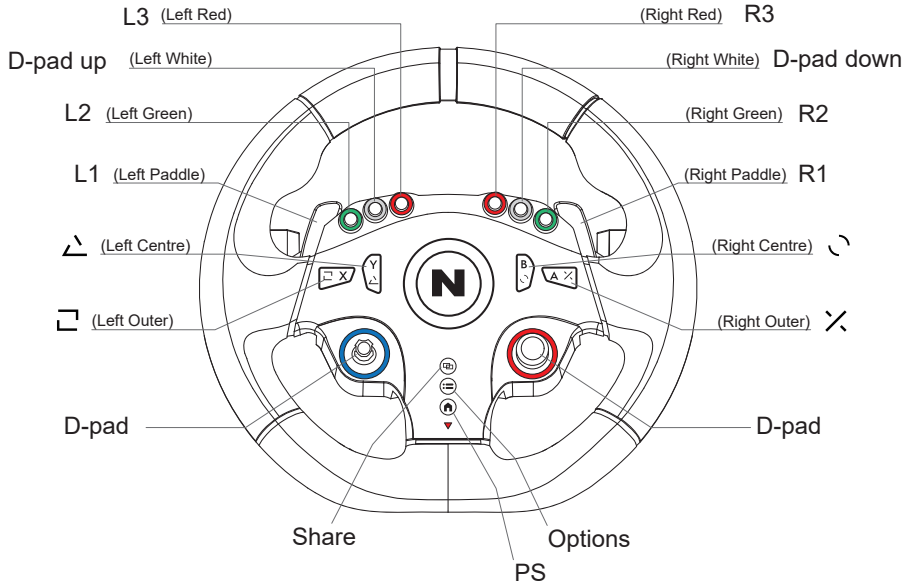

Xbox[®]One setup

- (1) After you have setted the wheel and gear shifter as indicated in page 2, connect the original Xbox[®] One controller to the wheel with the USB-A to USB Micro B cable, provided in the packaging.
- (2) Connect the wheel to the console's USB port and turn the console on.
- (3) The wheel's LED automatically switch on green colour, then press the Home button on the wheel.
- (4) At this point, the wheel is ready. Play the game and customize your in-game setup, following the “Xbox[®] One buttons layout” as displayed in page 9.

Note:

In case you lose the USB-A to USB Micro B cable, you can replace it with any similar cable available in the market, paying attention that it has DATA function.

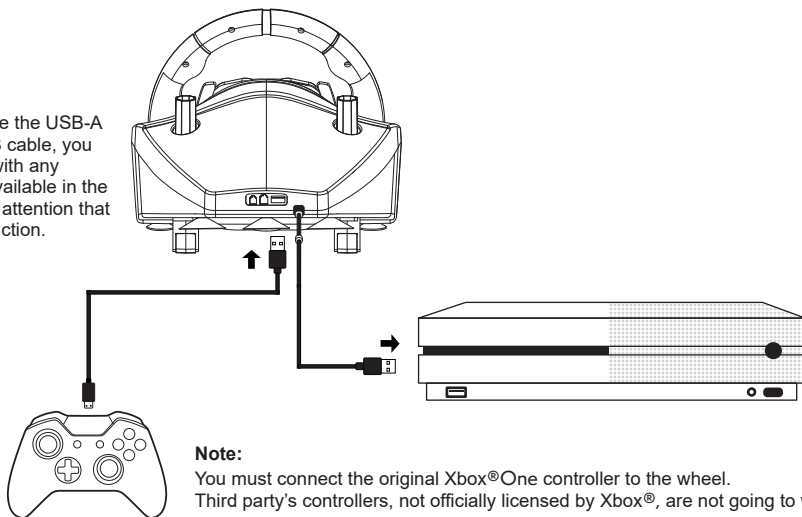

Note:

You must connect the original Xbox[®]One controller to the wheel. Third party's controllers, not officially licensed by Xbox[®], are not going to work.

Xbox®Series X|S setup

- (1) After you have setted the wheel and gear shifter as indicated in page 2, connect the original Xbox®Series X|S controller to the wheel with the USB-A to USB-C Type C cable, provided in the packaging.
- (2) Connect the wheel to the console's USB port and turn the console on.
- (3) The wheel's LED automatically switch on green colour, then press the Home button on the wheel.
- (4) At this point, the wheel is ready. Play the game and customize your in-game setup, following the “Xbox®Series X|S buttons layout” as displayed in page 9.

Note:

In case you lose the USB-A to USB Micro B cable, you can replace it with any similar cable available in the market, paying attention that it has DATA function.

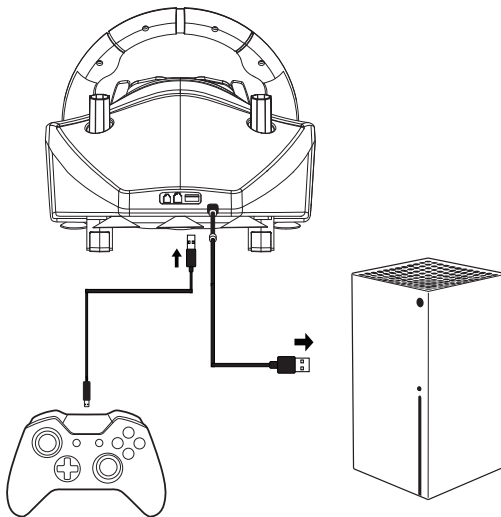

Note:

You must connect the original Xbox®Series X|S controller to the wheel. Third party's controllers, not officially licensed by Xbox®, are not going to work.

XBOX® One & XBOX® Series X|S buttons layout

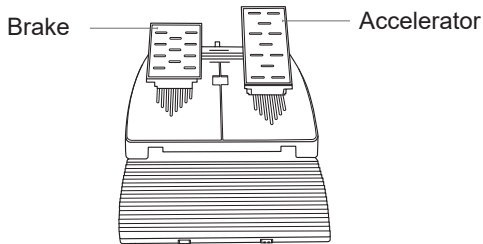
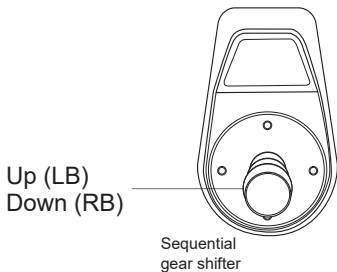
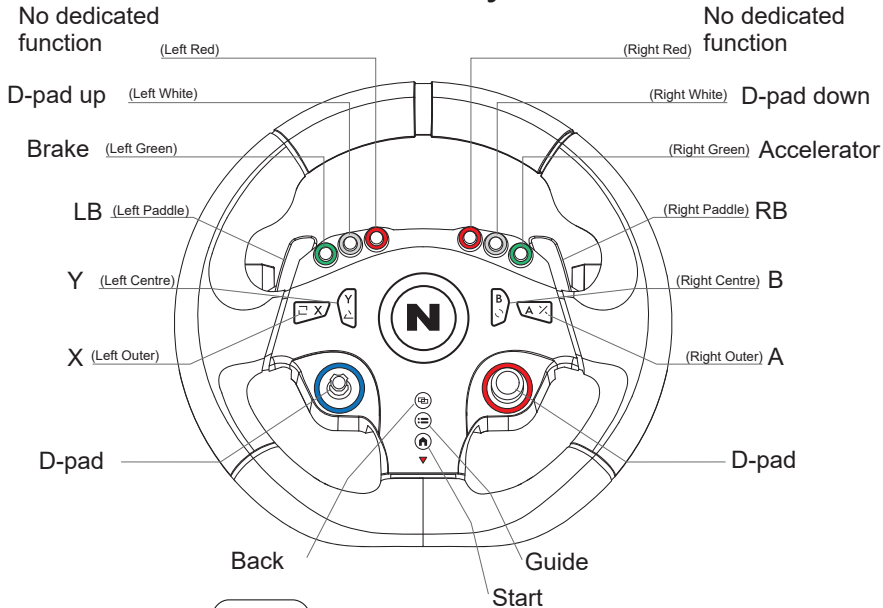

PC D-Input setup

- (1) After you have setted the wheel and gear shifter as indicated in page 2, connect the wheel to the PC's USB port.
- (2) The wheel's LED automatically switch on purple colour.
- (3) At this point, the wheel is ready. Play the game and customize your in-game setup, following the "PC D-Input buttons layout" as displayed in page 11.

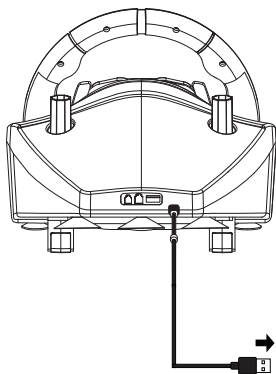

Note :

From D-Input is possible to switch to X-Input pressing the button 13 (Home) for few seconds until the LED light changes color to orange.

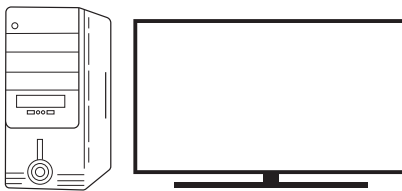

PC X-Input setup

- (1) After you have setted the wheel and gear shifter as indicated in page 2, connect the wheel to the PC's USB port.
- (2) The wheel's LED automatically switch on orange colour.
- (3) At this point, the wheel is ready. Play the game and customize your in-game setup, following the "PC X-Input buttons layout" as displayed in page 13.

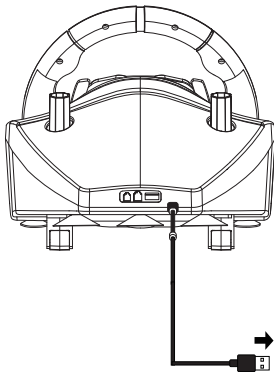

Note :

From X-Input is possible to switch to D-Input pressing the button 13 (Home) for few seconds until the LED light changes color to purple.

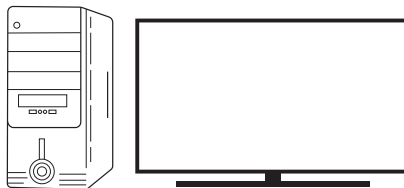

PC X-Input buttons layout

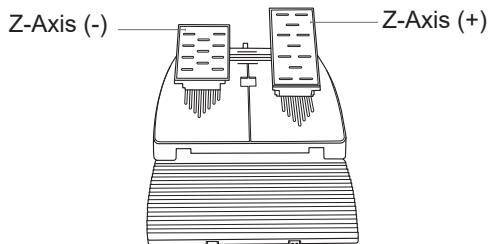
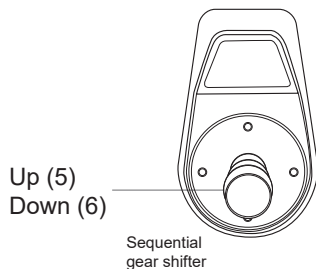
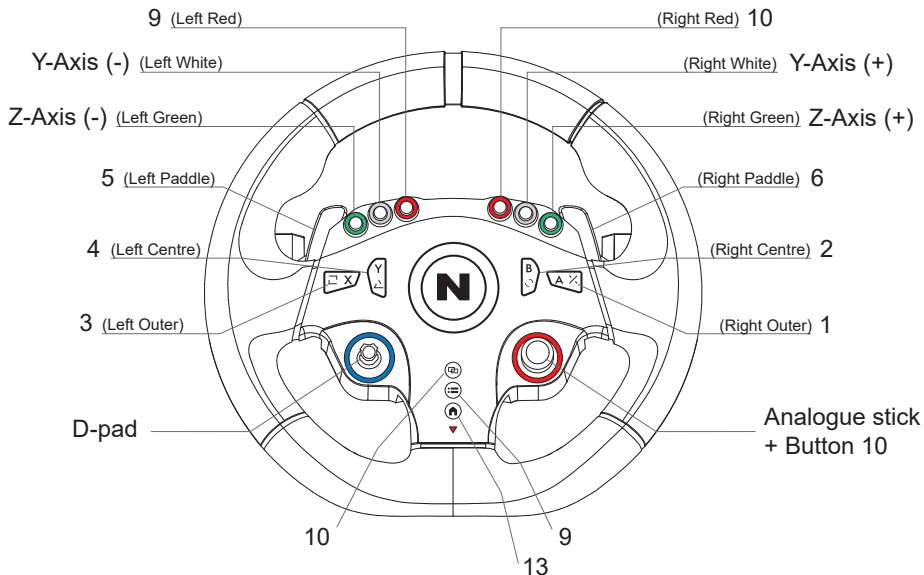

Nintendo® Switch® setup

- (1) After you have setted the wheel and gear shifter as indicated in page 2, connect the wheel to the Switch® Dock's USB port and turn the console on.
- (2) The wheel's LED automatically switch on red colour, then press the Home button on the wheel.
- (3) At this point, the wheel is ready. Play the game and customize your in-game setup, following the "Switch® buttons layout" as displayed in page 15.

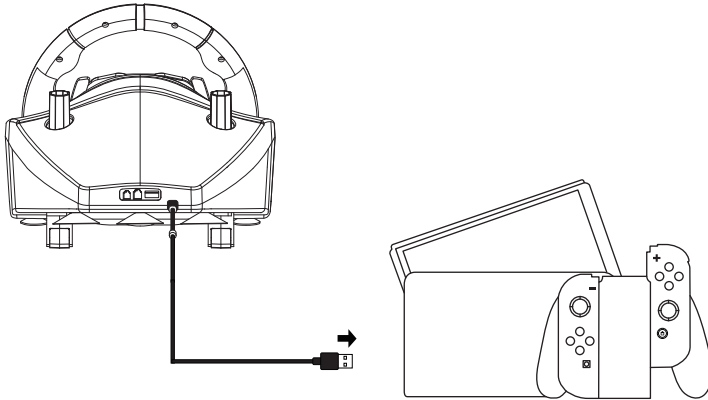

Nintendo® Switch® buttons layout

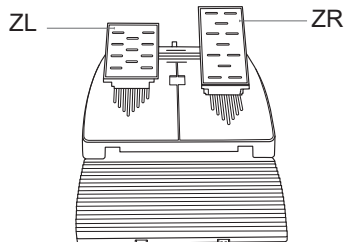
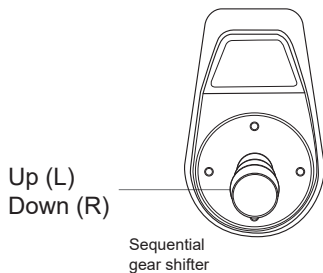
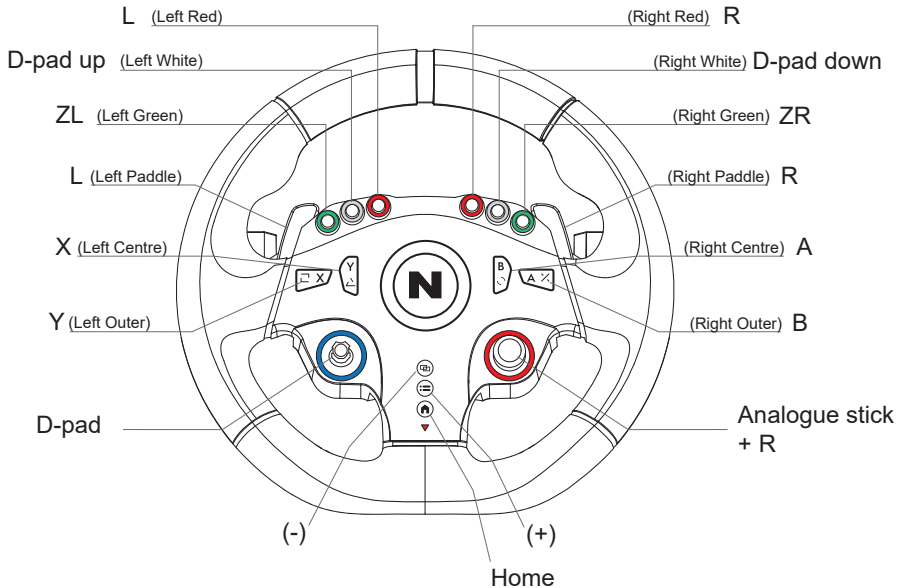

PlayStation®3 setup

- (1) After you have setted the wheel and gear shifter as indicated in page 2, connect the wheel to the PS3® USB port and turn the console on.
- (2) The wheel's LED automatically switch on blue colour, then press the Home button on the wheel.
- (3) At this point, the wheel is ready. Play the game and customize your in-game setup, following the “PS3® buttons layout” as displayed in page 17.

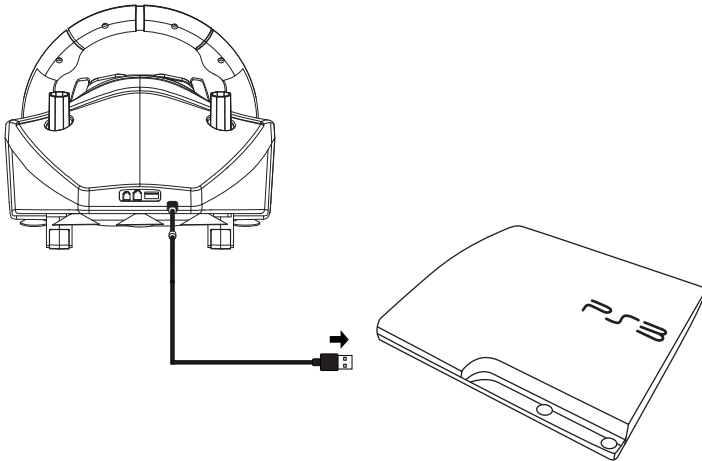

PS3® buttons layout

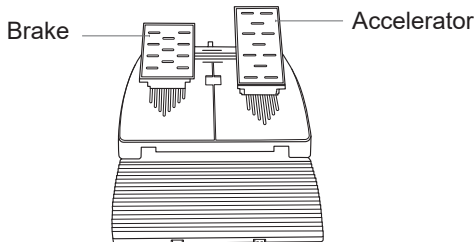
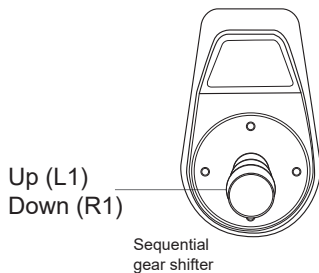
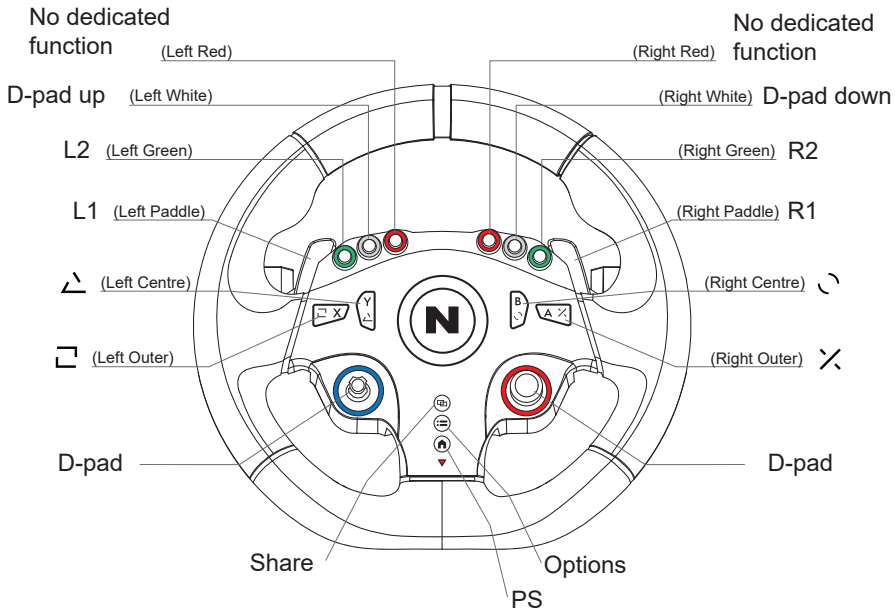

Sequential gear shifter

- Sequential gear shifter
- Adjustable table mounting

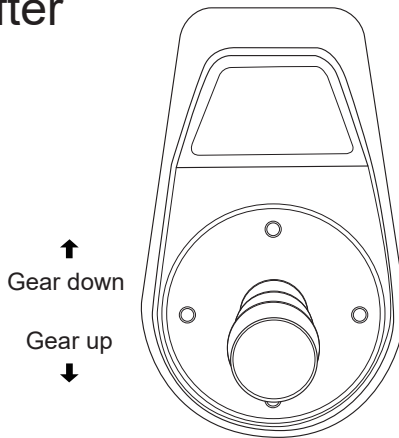

Pedal set

- Potentiometered (analog) pedals
- Metal plated
- Foldable footrest

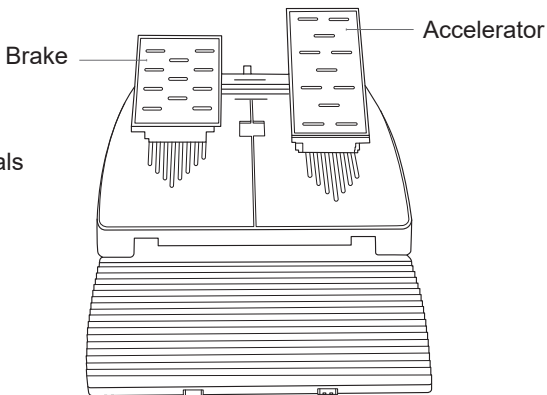

NiTHO

www.nitho.com

SERVICE & SUPPORT

For any question and support contact us on:
support@nitho.com
or visit www.nitho.com

All other copyrights, marks and trademarks are property of their respective owners.
This product is not designed, manufactured, sponsored or endorsed by Nintendo®
Co., Ltd., Sony® Computer Entertainment Inc. or Microsoft® Corporation.



SUPPORT@NITHO.COM



WWW.NITHO.COM



[NITHOGAMES](https://www.facebook.com/NITHOGAMES)



[NITHOGAMES](https://www.instagram.com/NITHOGAMES)