

# D4 Remote Control Manual

Copy and work for: fixed code/learning code remote control, some popular rolling code remote controls in China, Europe, North, South America and Australia in the follow table.

BFT MITTO2 MITTO4 (old version)	FAAC XT4 433RC	MotorLine MX4SP DSM
BENINCA TO GO WV	KEY TXB-42R	DEA MIO TR2
DOORHAN TX4	ATA PTX4	Peccinin TX3C
NICE FLORS	GBD AU1600	Centurion NOVA
NOVOFERM	Nice-Smilo	AN MOTOR AT-4
AAVAQ	ROSSI	FADINI JUBI
AT-4N	Codiplug NOV2	Codiplug UNIK



BENINCA ALLMATIC



DOORHAN TX4



KEY TXB-42R



GBD AU1600



NICE-5MILO



DEA



Alutech AT-4



FADINI JUBI



Novoferm



FAAC XT4 433



Motorline Mx4sp DSM



codipug NOVA



Codiplug UNIK



AT-4N



BFT MITTO2/MITTO4



NICE FLORS



ATA PTX-4



Rossi



Peccinin TX3C



Centurion NOVA

When copy above brands, you only need to make 1 button of them to be copied to D4, D4 will remember all the rest buttons of each model simultaneously, no need to copy the buttons one by one. (except Codiplug type)

## Compatible brands (China):

Zhongtian A, B	Superlift S60, S66	Hongmen (430, HM430)	JUGUANG (JGR202, JGR302, JGR303, JGR310, JGZ360B, JGR706, JGR713T, JGR716)
AAVAQ	Dweller	Omker (K373)	BISEN (T18, T19)
Dooya (DC250)	Doorman	Seaside (C600 New)	Hiland (T6520, T6522)
	AAVAQ		SuperLift (SF-650)



中天门业 中天B款



施普雷特 S60, S66



深圳红门 430, HM430



平和 学习码系列



锐码 全系列



迪威尔 (Dweller)



欧马克 K373系列



巨光系列



江西百盛 大力神系列, T18, T19



门人 (Doorman)



欧赛斯顿 535E



西塞德 C600新索玛



杭州海兰 (Hiland)

## Memory Clearance:

Press the button1 and the button2 at the same time, the LED flashes 3 times. Release button 2 (Keep pressing button 1), and press button 2 slowly for 3 times, LED flashes quickly, and all information is cleared.

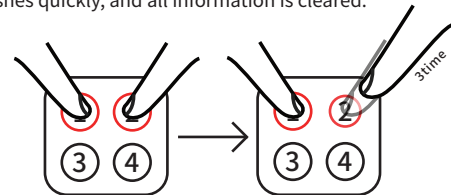

### One key copy:

(1) to copy the buttons one by one. (except Codiplug type)

(2) Copy face to face, press and hold the button of the original remote control, the LED of the copy remote control flashes 3 times and then stays on, which means that the code has been copied successfully.

(3) Other buttons are the same as the above button copy method.

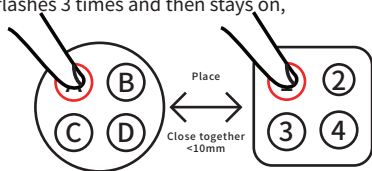

### Resume:

Press and hold both of the "3" and "4" button on the copy remote at the same time until the LED flashes rapidly, and the information of the last code is restored.

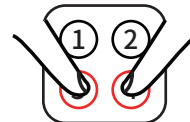

### Copy four keys together:

For most rolling code .

(1) Press and hold the first button of the copy remote control, after the LED flashes twice , short press the second button three times, the LED flashes three times. Enter the four-button continuous copy mode.

(2) copy face to face, press and hold the button of the original remote control, the LED of the copy remote control flashes 3 times, which means that the current code has been copied successfully.

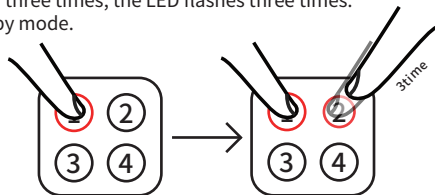

### Single Button Clearance Code:

Press the button1 and the button2 at the same time, the LED flashes 3 times. Release button 2 (Keep pressing button 1). Press the button that needs to be coded twice, wait for 2 seconds, the LED flashes continuously, clear the button information.

This function is not available while

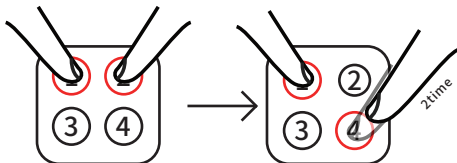

### Special BFT copy (MITT02/MITT04) method: for BFT only

(1) Hold the first button of the copy remote control, the LED flashes twice and press the second button once to enter the copy BFT brand remote control mode. (After the seed copy is successful, short press the second button twice again, the LED flashes 3 times, and enter the BFT continuous copy 4 button mode)

(2) Press the front two buttons of the BFT at the same time, the copy remote control LED flashes twice, and the seed copy is successful. Release the BFT brand remote control button, press any button of the BFT remote control, the copy remote control LED flashes 3 times and then stays on, which means that the code has been successfully copied.

### BFT seed sending:

Press the first button and the fourth button of the copy remote control at the same time, the copy remote control sends BFT seeds.

### CODIPLUG NOV2 & UNIK copy method:

(1) Copy 1st button and 2nd button : Keep holding the first top button (1st button) of D4 remote control, when LED flashes twice and goes out, then press the 2nd button twice, still holding 1st button and press any button of CODIPLUG, when LED of D4 flashes 3 times and stays on, it means D4 has copied CODIPLUG remote control well. Please note that at this moment the 2 buttons of CODIPLUG have been copied by this step.

(2) Copy 3rd button and 4th button: Keep holding the 3rd button of D4, when LED flashes twice and goes out, press the 4th button of D4 twice, still holding the 3rd button and press any button of a new CODIPLUG remote control, when LED of D4 flashes 3 times and stays on, it means D4 has copied this new CODIPLUG remote control completely.