

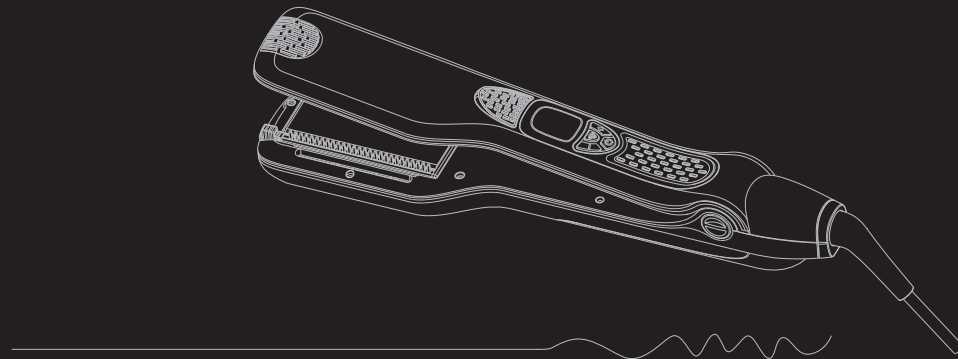



## USER MANUAL OF STEAM STRAIGHTENER



**THANK YOU FOR PURCHASING THE STEAM STRAIGHTENER,  
WHICH WILL CREATE A UNIQUE STRAIGHT HAIR EFFECT FOR YOU.**

- Unique steam water ion with a number of international patents brings you hair styling with zero damage.
- 5 gears of thermal control are available for you to select the most suitable temperature for your hair.
- The new tourmaline ceramic coating can release negative ions to penetrate into hair core and repair hair.
- The design of 4D floating-typed heating plate can ensure smooth hair pulling for you to create a perfect hairstyle easily.

## IMPORTANT SAFETY INSTRUCTIONS

- 1). This appliance can be used by children aged from 8 years and above and persons with reduced physical, sensory or mental capabilities or lack of experience and knowledge if they have been given supervision or instruction concerning use of the appliance in a safe way and understand the hazards involved. Children shall not play with the appliance. Cleaning and user maintenance shall not be made by children without supervision.
- 2). If the supply cord is damaged, it must be replaced by the manufacturer, its service agent or similarly qualified persons in order to avoid a hazard.
- 3).  **WARNING:** Do not use this appliance near bathtubs, showers, basins or other vessels containing water.
- 4). Always unplug this appliance immediately after using.
- 5). Use this appliance only for its intended use as described in this manual. Do not use attachments not recommended by the manufacturer.

## IMPORTANT SAFETY INSTRUCTIONS

- 6). Never operate this appliance if it has a damaged cord or plug, if it is not working properly, or if it has been dropped, damaged, or dropped into water. Return the appliance to a service center for examination and repair. If the supply cord is damaged, it must be replaced by the manufacturer, its service agent or similarly qualified persons in order to avoid a hazard.
- 7). Keep the cord away from heated surfaces. Do not wrap the cord around the appliance.
- 8). Never drop or insert any object into any opening or hose.
- 9). Do not use an extension cord with this appliance.
- 10). Do not direct hot air toward eyes or other heat sensitive areas.
- 11). Attachments may be hot during use. Allow them to cool before handling.
- 12). Do not place appliance on any surface while it is operating.
- 13). Do not operate with a voltage converter.

- **IMPORTANT SAFETY INSTRUCTIONS** 01
- **SATEFY WARNING** 03-05
- **PRODUCT STRUCTURE** 06-07
- **BEFORE USE** 08
- **HOW TO USE** 09-11
- **CLEANING AND MAINTENANCE** 12
- **COMMON QUESTIONS** 13
- **WARRANTY** 14

## **SERVICING OF DOUBLE-INSULATED APPLIANCES**

In a double-insulated appliance, two systems of insulation are provided in stead of grounding.

No grounding means is provided on a double-insulated appliance, nor should a means for grounding be added to the appliance. Servicing a double-insulated appliance requires extreme care and knowledge of the system, and should be done only by qualified service personnel.

Replacement parts for a double-insulated appliance must be identical to the parts they replace.

A double-insulated appliance is marked with the words “DOUBLE INSULATION” or “DOUBLE INSULATED”. The symbol (square within a square)  may also be marked on the appliance.

# SATEFY WARNING

IN ORDER TO PREVENT THE DAMAGE TO YOU, OTHERS AND PROPERTY,  
PLEASE BE SURE TO COMPLY WITH THE FOLLOWING ITEMS:



## WARNING

Bellow warnings remind you that it is likely to cause serious injury or death to the people.

PLEASE OBSERVE THE FOLLOWING ICON CONTENTS:



The icon tips (attention), concrete prohibited matters will be displayed by  the painting of graphic.



The icon tips (Prohibit operation), concrete prohibited matters will be displayed by  the painting of graphic.



The icon tips (Enforcement), concrete prohibited matters will be displayed by  the painting of graphic.



## WARNING

**NO DEMOUNTING!**



Do not place it in the damp and rainy environment, so as not to cause electric shock, fire, fault, deformation.



**DAMP BANNED!**

Keep out of reach of children.



**BAN!**

# SATEFY WARNING



## WARNING

Do not damage the power cord or power plug, to avoid electric shock, short circuit and fire.

**BAN!**



When it is not in use, please take the plug out of the socket.

**TAKE OUT THE PLUG!**



When in use, please insert the power plug.



Pls use the stated ac power of the product.

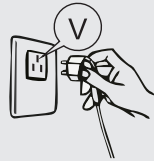

Do not place it in the damp and rainy environment, so as not to cause electric shock, fire, fault, deformation.

**WET HAND BANNED!**



After each use, the residual water inside the water storage tank must be cleared before it is inserted into the body.

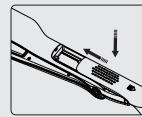

# PRODUCT STRUCTURE

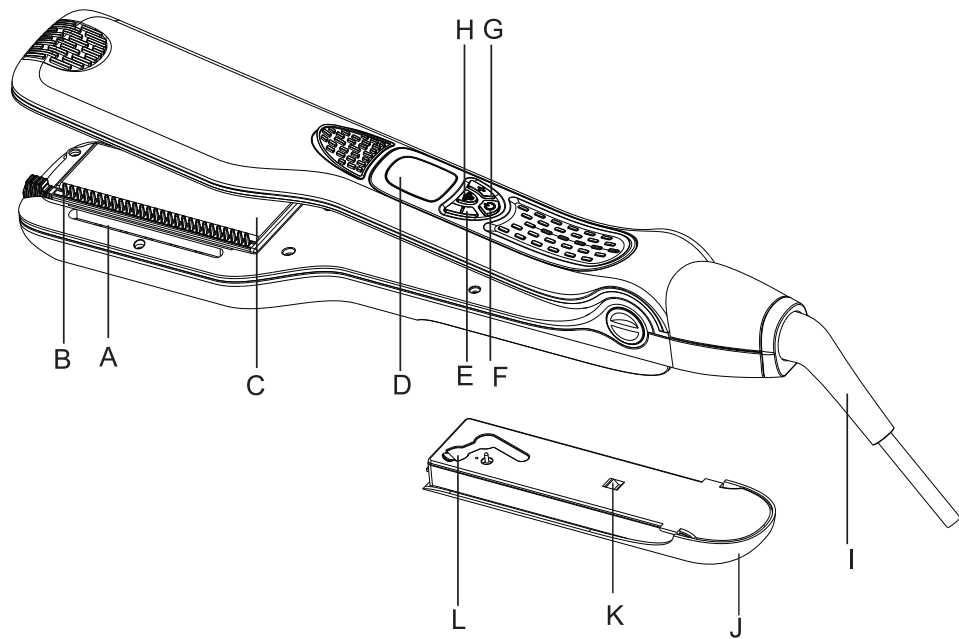

# PRODUCT STRUCTURE

- A. Steam outlet
- B. Hair comb
- C. Protection comb
- D. Intelligent display
- E. Reduce Temperature[-]
- F. Switch ON/OFF
- G. Increase temperature [+]
- H. Steam switch
- I. 360 degree rotatable power cord
- J. Water tank
- K. Tank's card slot
- L. Water filling nozzle

## PRODUCT SPECIFICATIONS

Model	FP-269	Product weight	0.68 Kg(tank included)
Voltage power	AC100 - 240V 50-60Hz	Storage tank capacity	40ml
Rate power	250W	Steam generating capacity	5g/min
Product size	318x55x54MM	Water replenishing bottle	40ml
Country of origin	CHINA		

1. Press and hold the water storage tank, and take it down as shown below (demount the water storage tank as shown below)
2. Open the PVC cover of the water storage tank and fill the tank with water, which should be pure water containing fewer minerals.

**(Do not fill the water tank with lotion, cosmetics, incense oil, solid and other matters that will cause damage to the product)**

(the water tank and the water bottle should be filled with water as shown below)

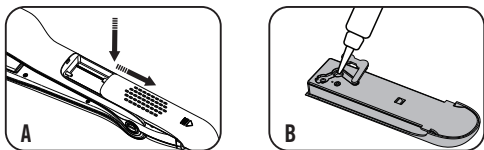

3. Remount the water tank.

Verify the direction of the tank, and horizontally push the tank into the card slot of the tank until you hear the sound of snapping. Please be sure the water tank has been properly mounted without any looseness.

**(Be sure that the water tank's card slot is dry without water. Be sure that the tank is dry without water when inserted back into the apparatus (the figure comparing the device with a dry tank and the device with a wet tank))**

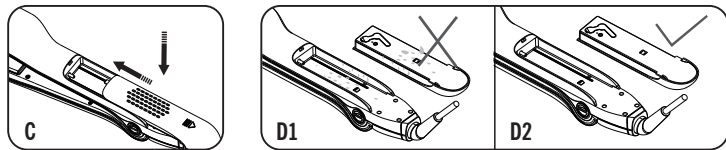

**Important notice:** Every time after filling pure water and starting up for use, fold the hair straightener until steams emit from the steam outlet, which will take about 10 seconds.

## INITIAL USE

- (1) connect to the power supply Press and hold the on/off key to start the hair straightener, and the LCD screen will start automatically.
- (2) Select the appropriate temperature for your hair.  
The default turn-on temperature when it is plugged in for the first time is 190 DEG C; the default turn-on again temperature without cutting off the power supply is the temperature applied last time.

## HOW TO USE

1. When plugged into power, the steam hair straightener displays "OFF", and the buzzer beeps once, indicating that it is connected to the power supply.

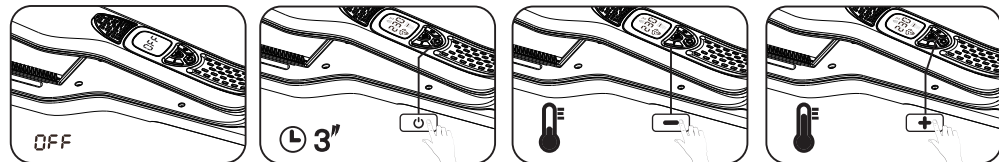

2. Press and hold the on-off key "⏻" for 3 seconds to start preheating the steam straightener.  
When the temperature reaches the set temperature, the buzzer beeps twice. (Steam symbol. When the heat bar is flashing, it indicates the temperature is rising, when the heat bar is always on, it indicates that the temperature reaches the set temperature)



3. 5 seconds after you finish setting the temperature, the safe lock "🔒" will automatically lock (a lock symbol will appear on the screen). This model can prevent you from pressing the key to change the set temperature with no intention.



4. If you want to change the temperature of the steam straightener, you must unlock first. Press and hold any key for 3 seconds, the lock symbol on the screen will disappear so that you can change the temperature.



5. According to your hair quality, select an appropriate temperature model 150°C, 170°C, 190°C, 210°C, 230°C as shown below.

150°C	170°C	190°C	210°C	230°C
For damaged hair	For soft hair	For medium hair	For rough hair	For super hard hair

6. For initial use, please fold the steam straightener until steams emit from the steam outlet, which takes about 10 seconds.  
7. While using the steam straightener for hair styling, clamp the hair and move it slowly from the root to the tip, then the steam ions from the straightener will be sprayed evenly onto the hair to offer extra moisture to the hair. It must be used as shown in the figure

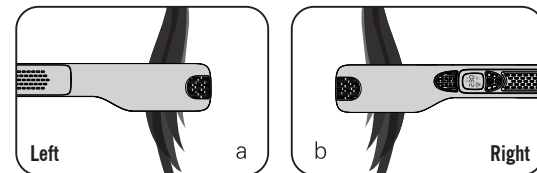

8. Hair care products can be used together for a better effect.  
9. When it is not used for 20 minutes, the steam straightener will automatically enter the power-saving mode and the lower the temperature to 150°C. When the hair straightener is folded, it will rapidly rise to the set temperature. When it is not used for one hour, it will automatically shut down.

10. As the steam straightener still has afterheat after power off. Please store it 10 minutes later when it is cool

**In order to keep the apparatus clean, please clean it after every use.**

1. Switch off and unplug the power cord, and leave it there for more than 10 minutes until the apparatus is cool.
2. Use the cloth to clean the residue on the straightener.
3. Demount the water storage tank, and remove the water in the tank.
4. Use a dry towel to wipe off the water on the surface of the steam hair straightener to keep it dry.
5. You can demount the comb and clean it with detergents, and remount the hair straightener when the comb is dry (demount and mount the comb as shown above)

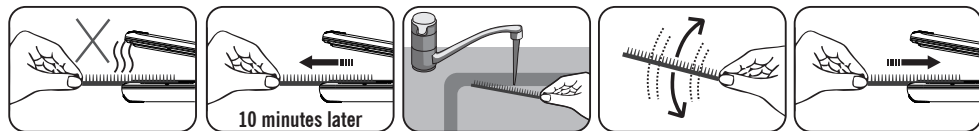

6. If it is not used for a long time, please fully dry the apparatus, demount the water storage tank, and remove the residual water in the water storage tank and store it after fully dried.
7. Please keep it far away from fire or direct sunlight, out of bathroom and other humid places. Please keep it in a cool ventilated dry place.
8. Please keep it out of reach of children.

## Problems that may be encountered in use

Fault	Reason	Handling method
Power off and no display on the screen	The power cord is unplugged	Re-plug the power cord
The screen displays ERR	Abnormal	Send it to a designated maintenance center
The steam symbol keeps flashing	The heating element of the steam box is abnormal	Send it to a designated maintenance center maintenance
The temperature rising symbol keeps flashing	The heating element of the heating plate is abnormal	Send it to a designated maintenance center maintenance
No steam from the hair straightener	No water or low water level in the water	Supplement pure water
	The water storage tank is not mounted in	Reinsert the water tank
	The water pipe from the pump to the steam	Fold the straightener for about 10 seconds
	Steam may not be seen when the environmental humidity is high	Not abnormality of the straightener
The amount of steam is changed	Affected by the wind	Not abnormality of the straightener
A squeaking sound when the hair is being pulled	The working sound of pump	Not abnormality of the straightener
A gargling sound when the hair is being pulled	The sound given out when the steams are generated (the boiling sound)	Not abnormality of the straightener
The shell is hot	Normal use will also cause the apparatus to	Not abnormality of the straightener



## Environmental responsibility



Some parts of the hair straightener can be recycled.

1. To enjoy the warranty service, you must provide a valid proof of purchase.
2. The warranty service does not include any damage due to improper use, negligence, failure to comply with the use instructions of the steam straightener, failure to use the voltage or current specified by the product, or repair by yourself or an unauthorized party.
3. The maintenance service excludes repair or replacement of normal wear and consumables, as well as the following:
  - (1) using inappropriate water;
  - (2) any fault caused by a special additive not provided by our company in the injected water;
  - (3) damage due to excessive voltage or frequency error;
  - (4) accidents such as fire, flood and electric shock;
  - (5) damage caused by unauthorized modification, improper use or neglect;