

NIMBUS 2.0 DIFFUSER

TIME TO RELAX!

Wow! This Nimbus Aroma Diffuser really grabs your attention. With her alluring, slightly vase-like shape she will conquer the world (and your home)! Besides that, it looks fantastic in your living room as decoration.

In the box you will find:

1. Diffuser
2. Measuring cup
3. Adapter

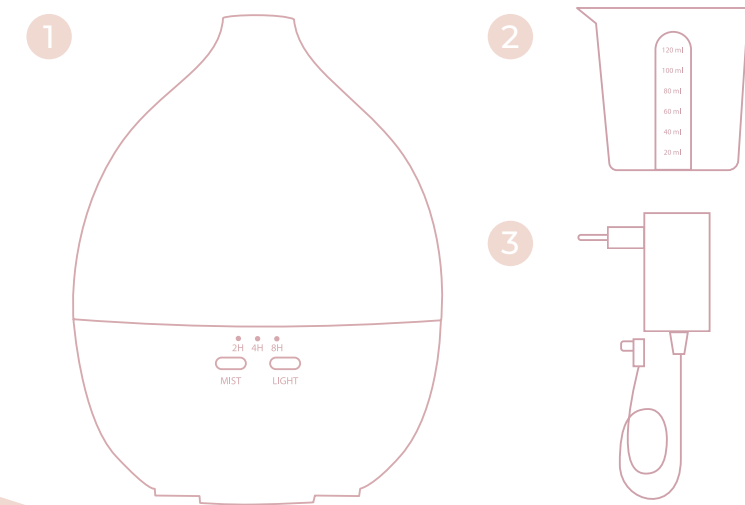

- Your Smellacloud diffuser can make you feel better with a simple press of a button! Improve your night rest, reduce stress and get into a better mood with our 100% natural essential oils.
- Smellacloud fills your room with a lovely scent within just a few minutes.
- Use one or more Smellacloud essential oils so you can switch up the scent whenever you feel like it.
- Every Smellacloud has a built-in LED-light and a timer. It also works as a humidifier.
- We strongly advice you only use Smellacloud essential oils because these contain 100% natural ingredients. Our oils are safe to use and won't damage your diffuser, so it's covered under warranty.

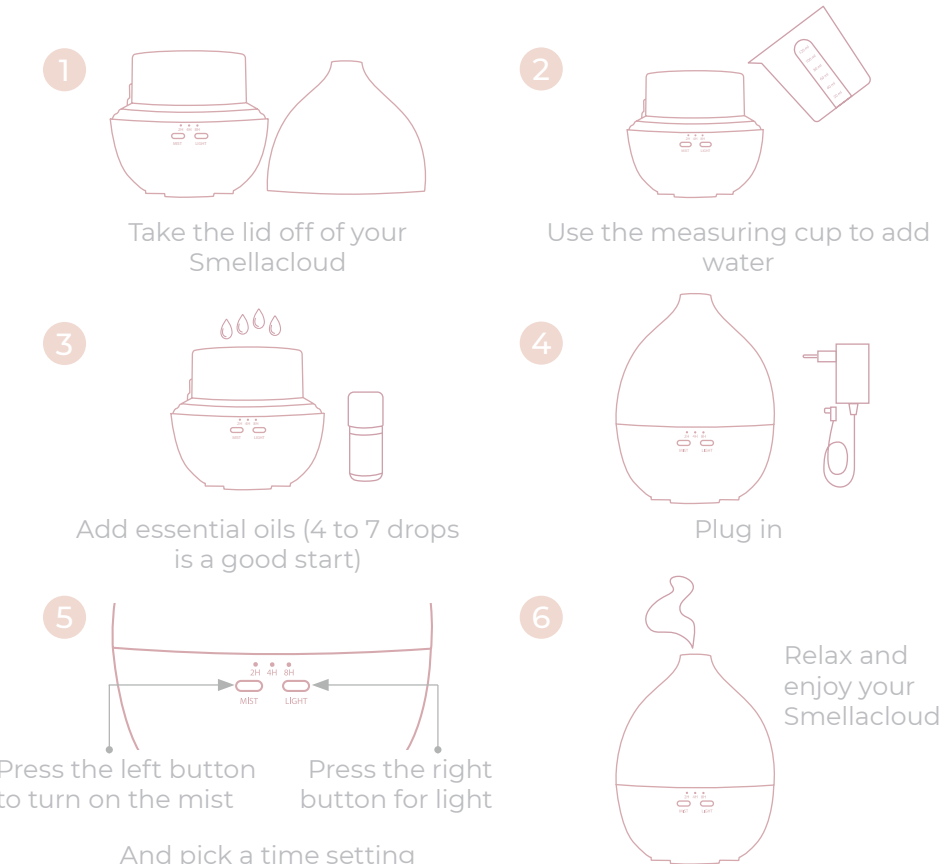

Specifications

- Height: 19cm
- Width: 15cm
- Water capacity: 200ml
- Material: pp5 (BPA-free)
- Wattage: 24v
- Max operation time: ±8 hours
- Max room size: 35m²
- Timer: 2 hours, 4 hours or 8 hours (3min interval)
- Light: LED
- Type: ultrasonic diffuser
- Turns off automatically
- Needs to be plugged in (comes with 1,5 m cord)

How does it work?

You'll find two buttons on the front of the Nimbus 2.0 diffuser. The left button works the mist. By pressing it multiple times you rotate between the different timer settings: 2 hours, 4 hours and 8 hours. The 8 hours setting works on a 3 minute interval, so the mist goes on and off automatically every 3 minutes for 8 hours. The mist and the light can be used separately, you can use one of the other (or both) whenever you please. When used together, the light will turn off when the timer (or water) runs out, for environmentally conscious purposes.

In the water tank you'll find an indication of the maximum water level. In the Nimbus 2.0 diffuser this is a little yellow cap. Always make sure the water stays under this indication, to prevent any issues.



SMELLA CLOUD

Feel good, smell good & be happy!

Olympisch Stadion 24-281076 DE,
Amsterdam The Netherlands

Any questions?
T: +31 (0) 851 302 699
info@smellacloud.com

How to care for your diffuser

- Place your Smellacloud on a flat surface, plug it in and take the lid off.
- Use the provided measuring cup to add water. Don't pour directly from the tap and don't overfill.
- Add water first, then your essential oils.
- Properly close the lid.
- Turn on your Smellacloud by pressing the MIST-button.
- Press the LIGHT-button to turn on the light.
- Do not remove the lid when the Smellacloud is turned on.
- When pouring water out, make sure the air outlet is pointing up.
- Clean your Smellacloud regularly with lukewarm water and a soft cloth or cotton pad.
- Never walk around with a Smellacloud filled with water.



The benefits of a Smellacloud

Are you suffering from a dry or aching throat, blocked nose, dry skin, headaches or sensitive eyes? Do you know that cold feeling, even though the heating is on? Are you experiencing dry air in your home or workspace?

You can eliminate all these complaints by introducing a Smellacloud into your life! It's a humidifier, an aroma diffuser and a mood light, all in one! By filling it with water and adding a few drops of essential oil, you will not only humidify the room, you'll also spread a pleasant fragrance. This eliminates all of the issues mentioned earlier. Additional to the fact that an aroma diffuser is beneficial to your own health, it's also great for your plants!

Every room in your house is suitable for a Smellacloud. From the bedroom to the living room. Even the nursery! In the entrance hall to make sure guests are welcomed into your home properly, or in the bathroom to eliminate unwanted smells. Add one to your home office or study room to improve your focus and concentration, or create a calming atmosphere in your baby room.

