

Multi-Light RMS

Mounting Instructions for Radion XR30 and XR15 LED Models

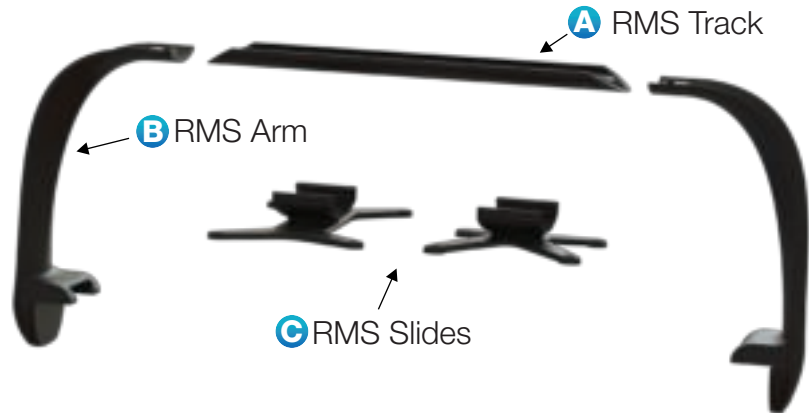

Build your Multi-Light RMS setup by choosing the **A** + **B** + **C** components that fit your tank

Components		Part Number	Track Length	Aquarium Length
 <p>A Track</p>		XR703-0205	20.5 in (52.1 cm)	18.5 - 28.5 in (47 - 72.4 cm)
		XR703-0305	30.5 in (77.5 cm)	28.5 - 38.5 in (72.4 - 97.8 cm)
		XR703-0405	40.5 in (102.9 cm)	38.5 - 48.5 in (97.8 - 123.2 cm)
		XR703-0505	50.5 in (128.3 cm)	48.5 - 58.5 in (123.2 - 148.6 cm)
		XR703-0605	60.5 in (153.7 cm)	58.5 - 68.5 in (148.6 - 174 cm)
		XR703-0705	70.5 in (179.1 cm)	68.5 - 78.5 in (174 - 199.4 cm)
		XR703-0805	80.5 in (204.5 cm)	78.5 - 88.5 in (199.4 - 224.8 cm)
		XR703-0905	90.5 in (229.9 cm)	88.5 - 98.5 in (224.8 - 250.2 cm)
 <p>B Arm</p>		2 RMS Arms P/N: XR710		
 <p>C Slide</p>		RMS XR30 Slide P/N: XR707		
		RMS XR15 Slide P/N: XR706		

Assembly of the Multi-Light RMS

NOTE: EcoTech Marine recommends two people install this product. It is recommended that steps 1 through 4 are completed away from your tank.

- 1 Guide the slides onto the track, spaced evenly or in desired positions.

*Track ends may be sharp, use caution when handling.

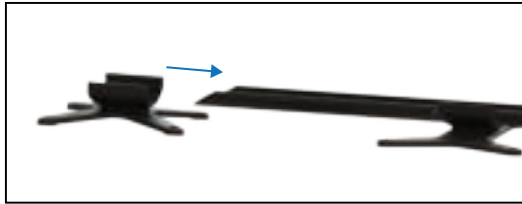

- 2 For ease of installation on rimmed, rimless and Euro-braced tanks, un-install the clamp chop/spacer/adjustment screw from the arm. This can be re-installed after the RMS is positioned on top of the tank for additional support and stability. Attach protective gasket to edge clamp.

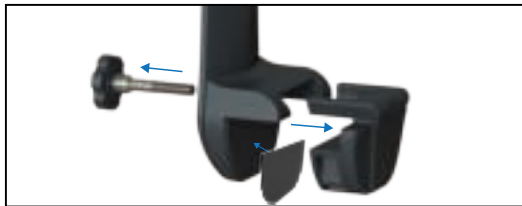

- 3 Attach the Radion to the slide using the four provided corner screws. Do not over tighten!



- 4 Align the locknut and slide the arms onto each end of the track, keeping the distance between the edge clamps equal to the length of your tank.

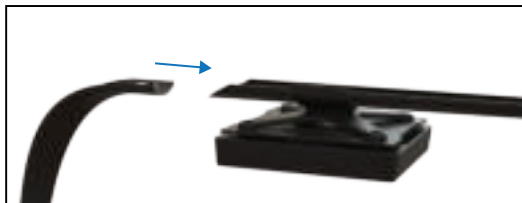

- 5 Lift the RMS assembly onto the tank by resting the edge clamps on the edge of the tank.

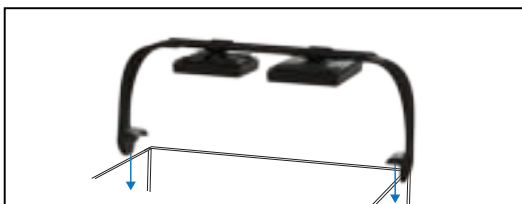

- 6 Tighten locking nuts with supplied allen key to secure the track to the arm.



- 7 Adjust slides to the desired positions if necessary.

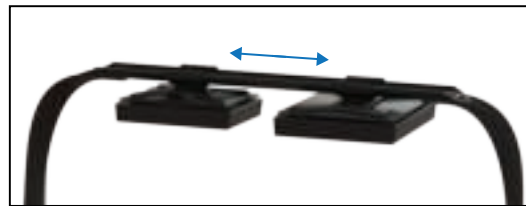

- 8 Route the power cables down the channel in the upper track. Slide cable clips on channel edge to secure cable in channel.

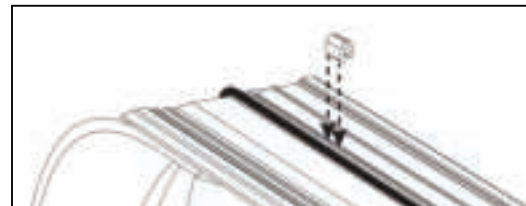

- 9 The clamp chop is optional for non-Euro-braced tanks but it can be used to provide additional stability and support.

NOTE: The optional screw cover can be trimmed down to fit the length of the exposed screw after installing on the tank.



- i Make sure that all you have the correct components from group A, B and C before beginning. Contact EcoTech Marine service at 1-800-785-0338 ext.2 with any questions, or comments.

EcoTech Marine, LLC. (ECOTECH) shall warrant the mounting system and parts for 30 days from the date of purchase against manufacturing defects and workmanship only. This warranty is non-transferable and valid for the original purchaser only. Use of materials not supplied or approved by ECOTECH will void your warranty. Use of the mounting system in a manner other than described in the instruction manual will void your warranty. Use this product at your own risk. ECOTECH shall not be liable and shall not reimburse any party for any damage occurring from the intended or unintended use of this product, said damage includes but is not limited to: death of livestock, damage to aquarium glass, damage to equipment, damage to aquarium stands, personal injury of persons using or around the equipment.