

# Pendant Light installation instructions

## attention

1. before install this lamp please read this instructions.
2. this lamp use between AC 100V to 265V 50/60HZ
3. when install please make sure cut off the power first.
4. please do not change the connection of this lamp.

## installation

1. remove the lamp cover and put the base on the ceiling and mark the screw hole.
2. drill the holes on the ceiling and put the expansion stopper in the hole.
3. put the lamp on it and fix the screw.
4. connect the cable to the lamp
5. put the cover on the lamp

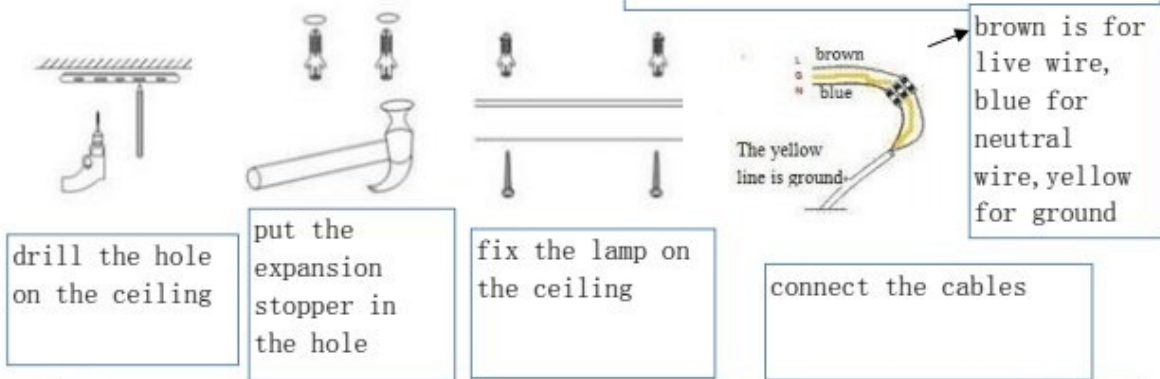

Do not cover the product with insulated material or other material.

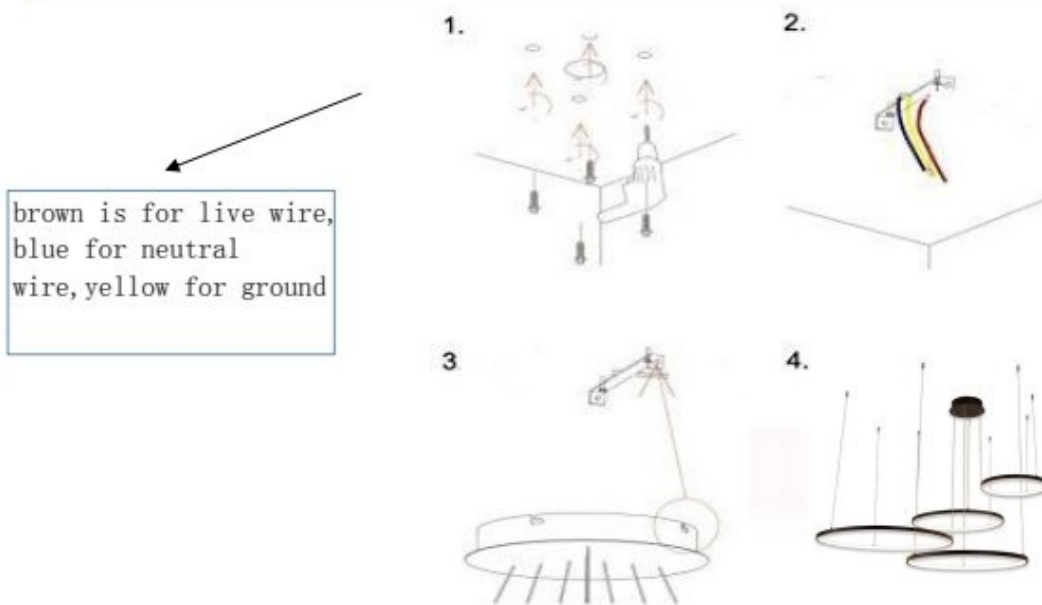

1. read the instructions first, 2. indoor use only, 3. cut off power before install, 4. can not on flammable