

## CUTTER CLEANING AND MAINTENANCE

### BLADE ALIGNMENT

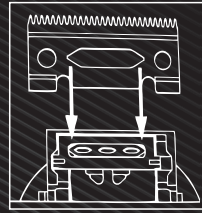
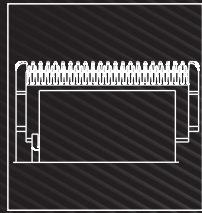

- Your clippers were carefully examined to ensure that the blades were oiled and aligned before leaving our factory.
- Blades must be realigned if they have been removed for cleaning or replacement
- To realign the blades, simply match the upper and bottom blades teeth up, point for point. (End of top blade teeth should be approximately 0.5-1.0mm back from bottom blade. Compare your clipper blades with the sketch)
- If blade alignment is incorrect, add a few drops of oil to the blade, turn clipper on for a few moments, turn off and unplug. Loosen screws slightly and adjust. Tighten screws after blade is aligned

### CUTTER MAINTENANCE

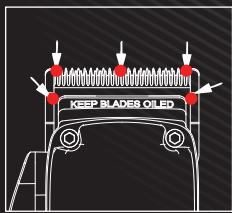

- To maintain your clipper in peak condition, the blades should be oiled every few haircuts.
- To oil it properly, the unit should be held so the blades are in a downward position. With the clipper blade running, dispense 2-3 drops of oil across the top blade.

## NOTE

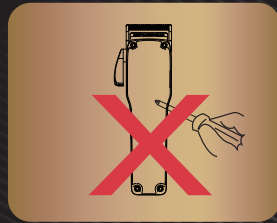

- Please do not disassemble the product.
- Water must not be used to wash the clipper, keep away from the dampness while operating.

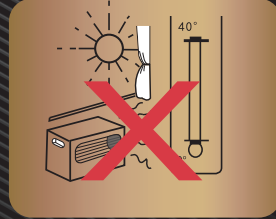
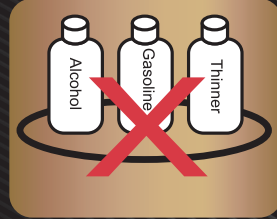

- Only use a little wet cloth or neutral liquid soap to clean the product.
- Never charge the product above 40°C heat source or below 0°C environment.

**\*Slight heating during the operating or charging is normal case**  
**\*After the battery life expires, take off and throw the battery in safe manner into the designated recycling site. Never dump it randomly.**

## WARRANTY CARD

Product Name	Rechargeable Clipper for the Professional	Warranty Period
Product Model		Within one year since the purchase date
Purchase Date	From: (M/D/Y)	To: (M/D/Y)

Customer	Add.	Name
		Tel.
Retailer	Add.	Name
	Name	Tel.

### PRODUCT ASSURANCES

- This product has been manufactured through the precise quality management and inspection process.
- In case of any failure during the normal operating, customer may send to the retailer or maintenance center for free-of-charge maintenance.
- Free service shall not be provided in either case below:
  - Any damage caused by the maintenance and transformation that is not recognized by the manufacturer.
  - Any damage caused by mistake, inadvertent use or accident.
  - Any damage caused by natural disaster and abnormal voltage.
  - Any damage caused by non-compliance with the notes as stated in this operating manual.
- This Warranty Card shall be the only proof of warranty, while the product maintenance against invoice shall not be allowed



# PRECISION HAIRCLIPPER INSTRUCTIONS



CE RoHS

## COMPONENTS

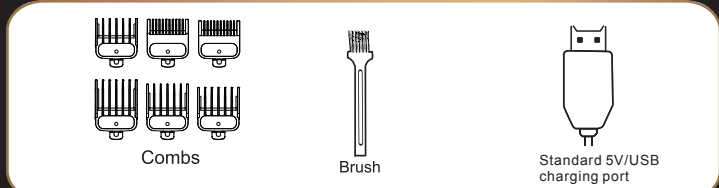
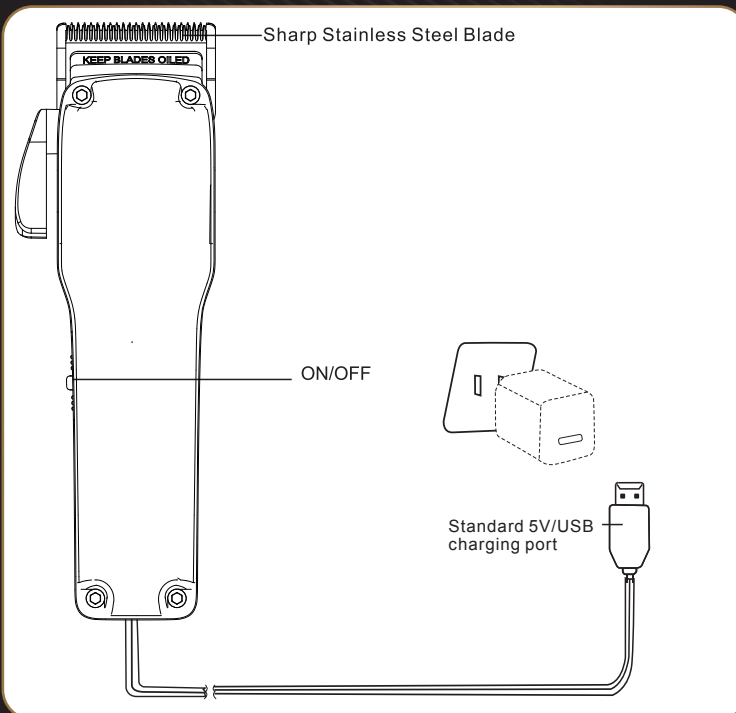

## PARAMETERS

Professional Hair Clipper	Motor	Operating voltage: 3V
		Carbon brush motor
	Battery	2500 mAh Li-ion battery
		Charging time: about 3 hours
	Operating time with full charge: about 3 hours	
Charge	USB connect with adapter 5V 1000mA	
	Power: 5W	

## USE THE RECHARGEABLE MODE

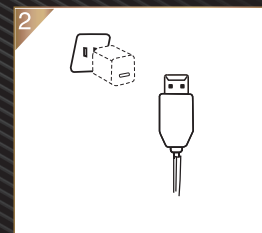
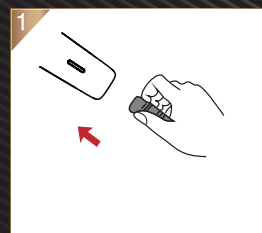

- Insert the charger into the tail of clipper, connect to the power to start charging
- Cord and cordless are available

## FIXED-LENGTH FUNCTION

A: Use of Limit Comb: Cropped hair and Feature: (1,5,3,4,5,6,10,13) six lengths adjustment, control the hair length

- To determine the length of haircut
- To select the appropriate limit comb

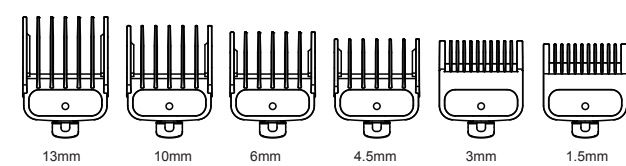

Mount the limit comb:

- Align the limit comb with the blade edge
  - Slightly forward push to mount it.
- Disassemble the limit comb:  
Just pull hard the limit comb

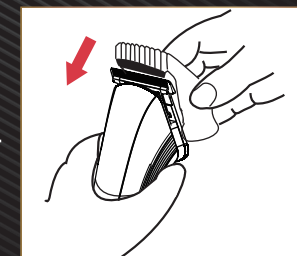

## BLADE REMOVAL & INSTALLATION

### BLADE REMOVAL

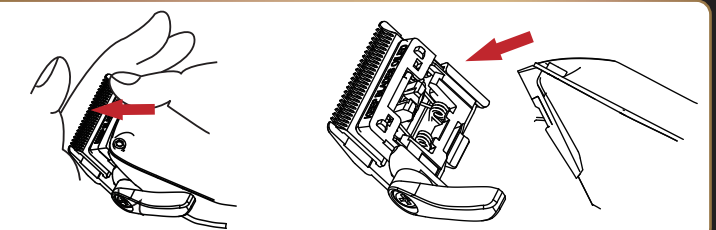

- Like the picture, press down the moving blade with the thumb and then remove the blade.
- Please hold with the other hand to avoid the blade falling off.

### BLADE INSTALLATION

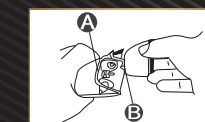

- Direct the blade (B) at the hair clipper's slot (A) and plug in



- Push the blade down until it clicks