

80.00 mm

130.00 mm

E-Reader E603 Quick Guide

1. Read me first

Please read following safety instructions before use.

1.1 Waste Disposal

- Please DO NOT dispose this final product as normal trash, the assembled parts are designed for recycling and reuse, please follow the related disposal regulation at your region.
- Please DO NOT place or store this final product close to the fire source, it may cause explosion accident.

1.2 Handling, Maintenance and Safety

- Please DO NOT place heavy objects on your E603 E-reader; failure to do so may result damage to the display panel.
- Touch panel surface easily have scratch damage, please operate with care, and avoid contact damage with other object.
- Touch screen with your finger on display, DO NOT use of sharp or metallic objects may cause scratch and damage.
- Please use the standard USB-C cable to charge the device, failure to do so may cause damage to it.
- Before cleaning the equipment, the power must be cut off. Please DO NOT use alcohol, liquid or spray type of detergent to clean the equipment.
- Please wipe the surface of the appliance with a soft cloth with water or non-alkaline cleaners, or gently wipe the display with a soft lint-free cloth.
- Use a soft cloth to remove dust from the display, touch screen surface has a special protective coating, will prevent dust from sticking to it; without using a soft cloth, and may cause damage to the protective coating.

- Please DO NOT disassemble the equipment. For your safety concern, only qualified serviceman can open the equipment.
- The using temperature is 0-40°C, please use this E-reader in this range.

2. Topjoy E603 E-reader Structure Illustrations

Please find the below E603 E-reader product illustration pictures to learn more about the product. These pictures include front, back, top, bottom side faces. All the key hardware features are identified as listed.

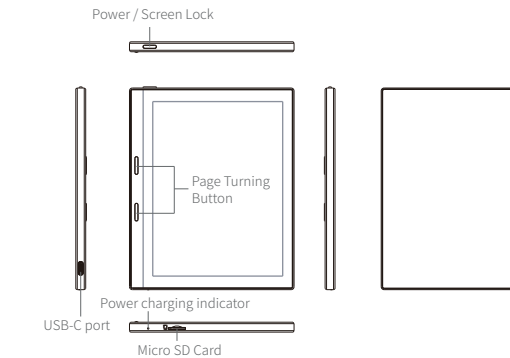

| | |
|------------------|--|
| Power | <ul style="list-style-type: none"> Long press to turn on and off the device Press to lock and unlock the screen Long press 10s to force restart |
| USB-C port | <ul style="list-style-type: none"> Connect the PC and device by using data cable to transmit data or charge the epaper reader Support OTG |
| Indicator | <ul style="list-style-type: none"> Battery charge indicator |
| Extended Storage | <ul style="list-style-type: none"> Micro SD Card |
| Button | <ul style="list-style-type: none"> Page up and down button |

3. Topjoy E603 E-reader and Accessories list inside the case

| | |
|-----------------|------------|
| E-reader | x1 |
| USB-C cable | x1 |
| User manual | x1 |
| Protective case | (optional) |

4. Start using

4.1 Home

Home interface directly go to bookshelf interface.

Press Home or Books to enter bookshelf interface, all the book covers are showed here. Click on books cover to enter reading, while you can also search, sort, multi select and create new folders for books.

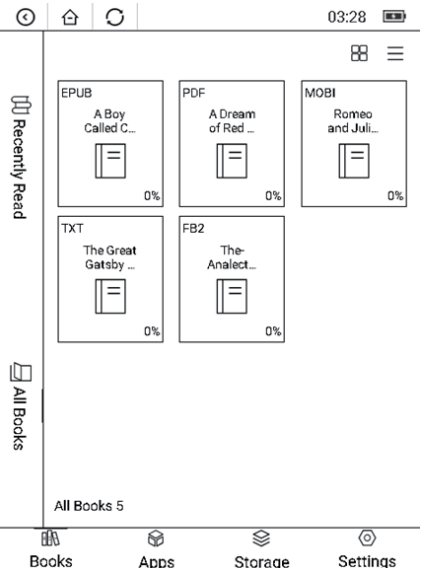

4.2 Apps

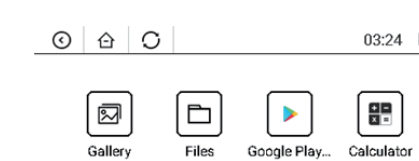

All Apps 4



All Books 5



4.3 Settings

You can check the equipment model and version in the settings, and set other parameters.



- Network & Internet
- Connected devices
- App info
- Power
- Storage
- System settings



4.4 E603 Specification

| | |
|------------------|------------------------------------|
| Mode | |
| Dimensions | 138.5 x 113 x 6.8mm |
| Screen | 5.83" |
| CPU | Quad-core Cortex-A7 |
| GPU | Mali-400 MP2 |
| Resolution | 648*480 |
| PPI | 138PPI |
| RAM | 1GB |
| Internal Storage | 32GB |
| Extended Storage | Micro SD Card |
| Touch Screen | Capacitive touch |
| WiFi | 802.11 b/g/n 2.4G |
| Battery | 3.8V 1300mah |
| Standby time | 4 days |
| Material | Plastic + Metal |
| Weight | 160g |
| OS | Android 8.1 |
| I/O Interface | USB Type C (Charging + data + OTG) |
| File Formats | PDF, EPUB, TXT, FB2, MOBI etc. |
| Page flip | 360 degrees |

5. Basic Trouble Shooting

5.1 The device displays an error message for the network or service

If you are in area where the signal is weak or the reception is poor, may not receive signal well. Please move to another area and try again. Error messages may occur repeatedly as you move.

5.2 The device is unable to POWER ON successfully

When the battery is fully discharged, the unit will not be turned on. Fully charge the battery before turning on the unit.

5.3 Touch the screen to respond slowly or unresponsive

- If you install a screen saver or buy accessories on the touch screen, the touch screen may not function properly.
- If you wear gloves when touching the touch screen, your fingers are not clean, or you touch the screen with a sharp object or fingertip, the touch screen may fail.
- Touch screen may fail in wet conditions.
- Restart your device to clear any temporary software errors.
- Confirm that your device's software has been updated to the latest version.

5.4 Equipment crashes or a serious heating issue

Try the following solutions, if the problem is still not solved, please contact the designated after-sales service center.

5.4.1 Reboot the device

If the device occurs, you may need to close the application or turn the device off and power it on again.

5.4.2 Force restart

If the unit fails to respond, press and hold the power key for more than 10 seconds to restart the device.

5.4.3 RESET

If the above party does not resolve the issue, perform a factory-reset operation.

Settings → System settings → Reset options → Erase all data → RESET DEVICE.

Please remember to back up all the important material stored in the unit before performing the reset set-up operation.

5.5 The network is often interrupted

5.5.1 Wi-Fi signal weak

- The e-Reader may be out of range. Move it closer to an access point or another wireless LAN device associated with it.
- Check your surroundings for interference, such as microwave ovens, wireless phones, and mobile tablets should stay away from objects that cause interference.

5.6 Battery Status Icon is empty

Battery Level is low; please charge the battery right away.

5.7 The battery is not charging properly

- Please make sure the battery charger is connected correctly.

5.8 Battery runs out faster than at the start of purchase

- When the device or battery is exposed to extremely cold or extremely hot temperatures, the effective charge may decrease.
- Battery is a consumer and will be less effective over time.

5.9 Data stored on the device has been lost

Please ensure that you have fully backed up all the data stored on the device regularly. We are not held liable for the permanent loss, damage, or misuse of your data.

Warranty Card

Product Name : _____

Model: _____

Buying Date: _____

User Name: _____

User Phone: _____

Warranty Description:

During 1 year warranty, we will provide free repair service if the fault is caused by the quality issue of device under normal use.

This card is warranty certificate, please keep it well.

Warranty Clauses

- User can find 1 User Manual and 1 warranty card after they buy it. Please fill in the warranty card to keep as a Warranty Certificate.
- During 1 year from the buying date, users who hold the warranty card can enjoy free repair service if quality issue occurs when the device is used normally.
- Below situations no included in warranty range:
 - There is no signature or stamp of sales unit
 - Contrived or irresistible factors lead to damage
 - Device normal wear
- If the faults are caused by contrived or irresistible factors, we will charge certain spare part cost for repairing.
- Please request warranty from local agent or seller when the device occur faults, please write Detailed address, name, phone no. and fault description.