

Please read the users's instrucion carefully before use.



HIGHSPOT

Model NO.:MS208

MINI CLOTHING STEAMER

USER MANUAL

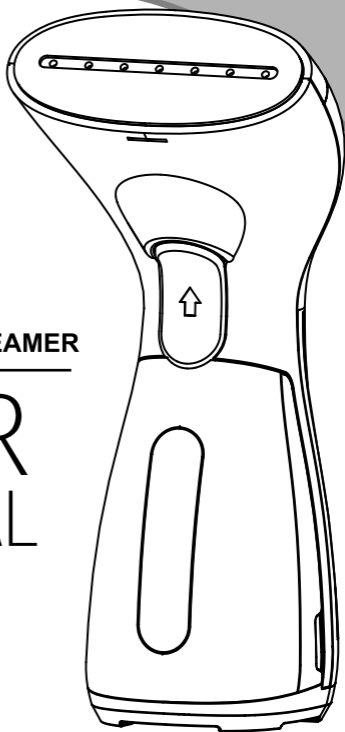

Thank you for purchasing the **Highspot** mini clothing steamer. Please read this instruction carefully before your first use of this product.

IMPORTANT SAFE GUARDS

1. Please check your electricity supply is 220-240V before using the garment steamer.
2. Use this unit only as described in this manual. Other uses not recommended may cause burns or electric shock.
3. This unit is not a toy. Close supervision is required when using the unit near children, pets and plants.
4. Steam produced by the unit is hot. Care must be taken to avoid burns or other injuries. Never point steam nozzle at people or pets.
5. To protect against electrical shock, do not immerse unit, plug or cord in water, or spray with liquids.
6. Do not leave the unit unattended while it is in operation.
7. Always allow the unit to cool completely before refilling water, cleaning or storing.
8. Always disconnect the unit from electrical outlet when filling or disposing water as well as the reservoir is empty or the unit not being used.
9. No detergent or chemicals can be added into the reservoir or it will cause damage. Only water is allowed to use.
10. To disconnect, grasp the plug and pull it from the wall outlet. Never drag the cord.
11. Steam nozzle and accessory become hot during use. To avoid injuries, do not touch nozzle while using this unit. Do not attempt to remove accessory while unit is emitting steam.
12. After refilling, close the sealing cap and do not overfill the reservoir above 120ML.
13. When the water in reservoir is run out, the pump is still working and this is normal, please switch off the unit and disconnect from power outlet. .
14. To reduce the risk of contact with hot water emitting from steam vents, hold the unit away from people or pets.
15. This product is not intended to use by persons (including children) with weak physical condition, slow reaction, mental retardation, lack of experience and common sense, unless they are under supervision or instruction by the person who is responsible for their safety.

NOTE :

To avoid danger of electric shock, unplug the unit from outlet when not in use and before cleaning. If the supply cord is damaged, stop to use immediately and bring the unit to our service centre for repair.

PARTS DIAGRAM

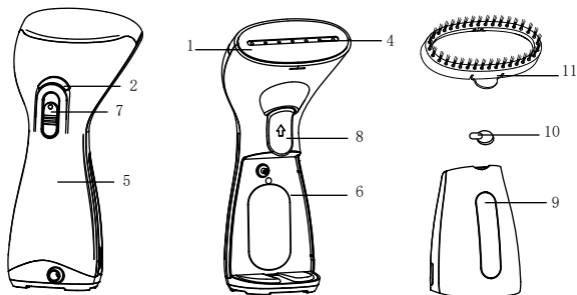

1	Nozzle Plate	7	On / Off Switch
2	Power Indicator Light	8	Reservoir Release Knob
3	Cool-touch Housing	9	Removable Reservoir
4	Steam Nozzle	10	Silicone Sealing Cap
5	Decoration strip	11	Brush Attachment
6	Built-in pump		

A. Refilling Water

1. Remove the Reservoir by pulling release knob (Fig. 1)
2. Pull the Silicone Sealing Cap out and fill with water(Fig. 2)
3. Replace the reservoir by fixing the reservoir to the steamer(Fig.3) till hearing “ click” sound.
4. Switch on the unit and wait for 22-25 seconds, the steam emits (Fig 4)
5. When garment steaming is finished, you must switch off the unit.

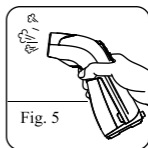
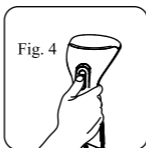
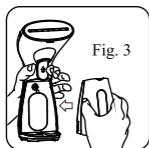
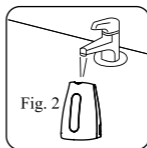

B. Steaming Garment (refer to STEAMING TIPS section)

CAUTION :

1. Before use, first check the voltage at home is matched with the unit at 220-240V .
2. When water is run out in Reservoir, the Pump is still operating, and this is normal. Then the unit must be switched off or it may cause damage or accident.

NOTE :

1. Only water can be refilled and no chemicals or detergent is allowed to add in the Reservoir
2. Always be sure that Steam Nozzle is pointed to garment but not to anybody or pets.
3. The maximum water level of the Reservoir is 120 ml.

BRUSH ATTACHMENT

The unit comes with a practical accessory –Brush Attachment to undust the suit and overcoat while steaming. Observe the following steps to install the accessory to the Steam Nozzle.

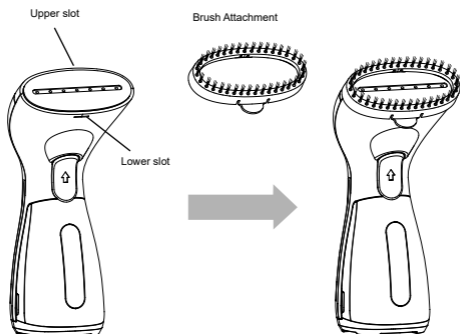

(Fig. 8.)

1. Make sure the unit is turned off and no steam emitted from the Steam Nozzle.
2. Line up the Fabric Brush into upper & lower slots of the steam nozzle plate as shown in (Fig. 8).
3. Check whether the Brush Attachment is properly installed before start the steaming jobs.

CAUTION :

Do not install the Brush Attachment on the Nozzle Plate while steam emitting.

Steaming Linens & Fabrics

Make sure the Reservoir has already been filled and that the accessory is properly installed before starting to use the steamer.

(A) Vertical Steaming

1. Hang the clothes on a hanger properly.
2. Direct the Steam Nozzle towards the garment from the top to bottom part.
3. Repeat the vertical steaming motion back and forth until smoothing out the wrinkles (Fig9).
4. IMPORTANT: Pull the tail of the clothes slightly tight with your free hand to make the steaming effectively.



(B) Steaming Ironing

1. Place the clothes or pants on a flat and heat resistant surface
2. Direct the Steam Nozzle plate closely on the garment and move back & forth motion.
3. Repeat this motion until the wrinkles is smoothed out (Fig.10).
4. IMPORTANT: Slightly press & pull the garment against the direction of the steam ironing motion.

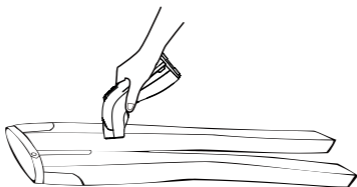

STORAGE

1. Unplug the power cord.
2. Allow the unit to cool completely.
3. Empty the reservoir.
4. Store the unit in a cool & dry location and away from children's access.

TROUBLE SHOOTING

Problem	Possible Reasons	Solution
Unit fails to heat up	<ul style="list-style-type: none">- Unit is not plugged in- Power Switch is not activated	<ul style="list-style-type: none">- Plug into outlet with proper voltage- Switch on to heat up. If not work, bring it to Service Center
Power light is on , but fails to steam	<ul style="list-style-type: none">- The Reservoir is empty- The unit is broken	<ul style="list-style-type: none">- Refill water (refer to Operating Instruction)- Bring to Service Center for repair
When the machine is operating some slight sound & vibration observed	<ul style="list-style-type: none">- This steamer operates with Pump-system design, sound is vibration is thus observed- The steamer is operating without water, large sound is observed	<ul style="list-style-type: none">- This is normal as resulted from the working pump- Please switch off the machine refill water and switch on the unit

SPECIFICATIONS

Voltage	: 220-240V 50/60Hz
Wattage	: 800-950W
Capacity	: 120 ml of water



HighSPOT

Model NO.:MS208