



# BLACKOUT

## floor lamp

### SPECIFICATION

Rated voltage and frequency: 220-240 V ~ 50 Hz

Rated power: E 27, Max.40W

Attention: read the manual carefully before installing the lamp

### WARNING

1. Just for indoor use.
2. Ensure that the electrical supply complies with the type stated on rating label.
3. Used lighting source shall be of suitable model and wattage
4. Avoid touching the shade and bulb when the lamp is working
5. Please cut off power and let the bulb and shade cool down before replacing the bulb and adjust the light direction
6. Please use dry cloth to clean the lamp.
7. The external flexible cable or cord of this luminaire cannot be replaced; if the cord is damaged, the luminaire shall be destroyed.

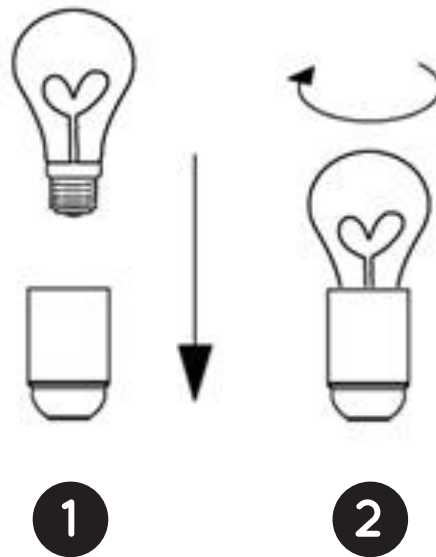

1

2