

## IMPORTANT INFORMATION

- Before beginning, cover the play area to protect from possible water damage.
- An adult must be present when children are playing with water.
- Your doll will change color.
- Do not place the doll in extremely hot water.
- Do not place the doll's fashion in water.
- Keep the doll's hair out of water. If hair gets wet, air dry only.
- Do not store the dolls in direct sunlight for extended periods of time.
- Exposure to sunlight may deactivate color change feature.
- Squeeze out all water from the bottle and dry after each use.
- Thoroughly dry the doll on a towel in a well-ventilated area after use and before storing.
- Air dry only. Do not place in the dryer or subject to excessive heat.
- Doll only fits on stand with shoes on.



www.LOLsurprise.com

©2020 MGA Entertainment, Inc.

L.O.L. SURPRISE!™ and L.O.L. SURPRISE! J.K.™ are trademarks of MGA in the U.S. and other countries. All logos, names, characters, likenesses, images, slogans, and packaging appearance are the property of MGA.

MGA Entertainment, Inc.

9220 Winnetka Ave.

Chatsworth, CA 91311 U.S.A.

(800) 222-4685

MGA Entertainment UK Ltd. **MGA Entertainment (Netherlands) B.V.**

50 Presley Way, Crownhill

Milton Keynes, MK8 0ES

Bucks, UK

+ 0800 521 558

Baronie 68-70, 2404XG

Alphen a/d Rijn, The Netherlands

Tel: +31 (0) 172 758038

E-mail: klantenservice@mgae.com

Imported by MGA Entertainment Australia Pty Ltd

Suite 2.02, 32 Delhi Road, Macquarie Park NSW 2113

1300 059 676

The preferred method of contact for Customer Service is through our e-mail contact form at [www.mgae.com](http://www.mgae.com)

Printed in China

0320-0 -E/INT

Please keep this manual as it contains important information. Illustrations are for reference only. Styles may vary from actual contents.



♥ **BABY STEPS** ♥



AGES 3+  
ADULT SUPERVISION REQUIRED  
570745

**WARNING:**  
**CHOKING HAZARD**-Small parts.  
Not for children under 3 years.

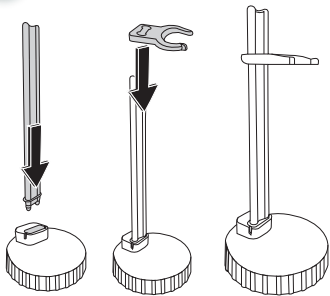
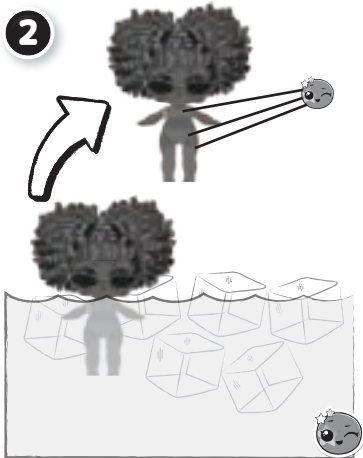
**1****1****2****3****2**

## COLOR CHANGE

- Color change will start at approximately 59°F (15°C), but best results occur if the ice water is chilled to approximately 32°F (0°C) or colder.
- Only certain dolls change color.
- Color change will only work on certain parts of the doll's body or accessories. Not all included accessories change color.
- If color change does not work properly or quickly, the temperature of the doll's body may be too close to the temperature of the water.
- Color change temperatures may vary according to weather conditions.
- The color-change effect of the doll's body has a lengthy, but limited lifespan.