

Air Fryer

User Manual

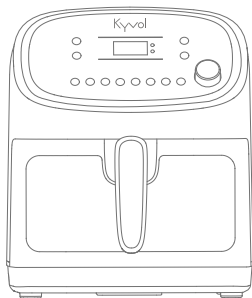

AF60

CONTENTS

IMPORTANT SAFETY INSTRUCTIONS	01
PACKING LIST	02
PRODUCT OVERVIEW	03
AIR FRYER	03
CRISPER PLATE	03
CONTROL PANEL	04
GETTING STARTED	04
USING YOUR AIR FRYER	05
POWER ON/OFF	05
PRESET PROGRAMS	05
Preheat	05
Other Preset Programs	06

TEMPERATURE SETTING	07
TIME SETTING	07
START/PAUSE COOKING	08
OVERHEAT PROTECTION	09
COOKING TIPS	10
MAINTENANCE AND CARE	11
EXTERIOR	12
FRYER BASKET AND CRISPER PLATE	12
STUBBORN FOOD RESIDUE	12
SPECIFICATIONS	13
TROUBLESHOOTING GUIDE	13

IMPORTANT SAFETY INSTRUCTIONS

READ THESE INSTRUCTIONS BEFORE USING THIS AIR FRYER.

IT IS INTENDED FOR HOUSEHOLD USE ONLY.

- The air fryer is intended for countertop use only.
- DO NOT use an extension cord. The short power cord is made to reduce the risk of children grabbing the cord or people tripping over a long cord.
- DO NOT touch the hot surfaces or hot food when the air fryer gets hot during or after cooking. Use with extra caution to avoid burns or injury.
- Make sure the air fryer is placed on a level, clean and dry surface. Never place the air fryer near the countertop edge during operation.
- Always provide adequate space above and on all sides of the air fryer for air circulation.
- Keep the air fryer away from persons (including children) with reduced physical, sensory or mental capabilities.
- Children should be supervised to ensure that they do not play with the air fryer.
- Choking hazard: remove and discard the protective materials fitted on the air fryer and its accessories.
- Never place the air fryer near gas or electric burner, or in a heated oven. Doing so may cause damage or injury.
- Electric shock: DO NOT immerse the power cord or the air fryer in water or other liquid. Doing so may cause damage or injury.
- Inspect the air fryer and the power cord regularly. DO NOT use if there is damage to the power cord or plug.
- The air fryer is for household use only. DO NOT use outdoors.
- DO NOT overfill the basket. Overfilling may cause damage or injury.

- DO NOT cover the air intake or the air outlet when the air fryer is operating. Doing so will prevent even cooking and cause damage or overheating.
- DO NOT use the air fryer for deep-frying with oil.
- Use with extra caution when moving the air fryer containing hot oil or other hot liquids.
- Always unplug the air fryer and let it cool before cleaning and storing.
- DO NOT clean the air fryer with abrasive cleaners, steel wool or scouring pads.
- If any black smoke emits from the air fryer, unplug the air fryer immediately and wait until the smoke stops emitting, then draw out the basket.
- Kyvol will accept no liability or responsibility for fires, explosions or electrical shocks caused by improper operation, dismantling the air fryer or by not adhering to the above safety instructions.

PACKING LIST

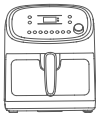

Kyvol Air Fryer AF60



Nonstick Crisper Plate



Recipe Book



User Manual

PRODUCT OVERVIEW

AIR FRYER

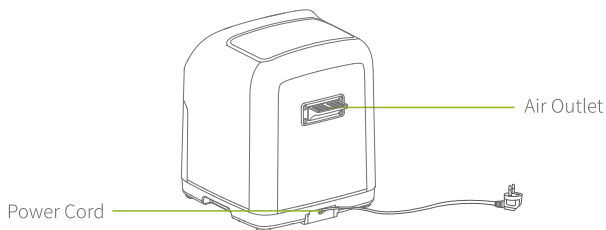
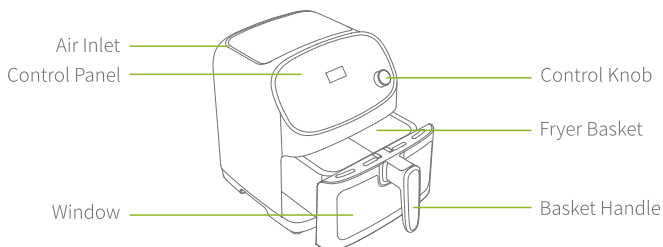

CRISPER PLATE



CONTROL PANEL

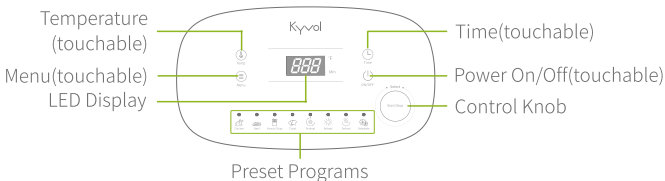

GETTING STARTED

- 1 Remove all the packaging materials, stickers and labels from the air fryer.
- 2 Draw out the **Fryer Basket**; wash the **Fryer Basket** and the **Crisper Plate** in warm, soapy water or in a dishwasher, then rinse and dry thoroughly.
- 3 Place the air fryer on a stable, level and heat-resistant surface. Keep it away from places that can be damaged by steam.

Note:

Leave at least 10cm of space behind and above the air fryer. Leave enough room for removing the basket.

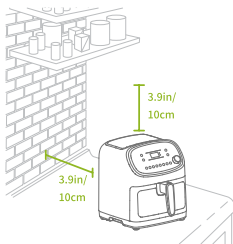



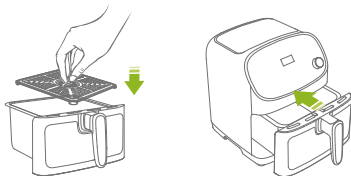

- 4 Place the **Crisper Plate** into the **Fryer Basket**, then push back the **Fryer Basket** into the air fryer.



USING YOUR AIR FRYER

POWER ON/OFF

Plug in the air fryer and tap  to power on the fryer. The , , ,  icons on the **Control Panel** will light up.

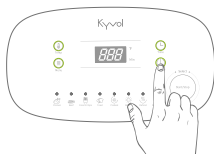

PRESET PROGRAMS

Preheat

IMPORTANT:

For the first use, we recommend preheating for 10 minutes to remove the strange odor. For daily use, we recommend preheating for 5-10 minutes before placing the food inside of the fryer. Press **Menu** on the **Control Panel** to enable the default preset program **Preheat**. The default preheat temperature is 400°F, and the default preheat time is 5 minutes.

Other Preset Programs

- 1 Rotate the **Control Knob** to select your desired program from other 7 preset programs: **Chicken, Beef, French Chips, Toast, Reheat, Defrost** and **Dehydrate**. The corresponding program indicator will light up.
- 2 Refer to the following chart for the cooking temperature and time of the 7 preset programs.

Preset	Default Temperature	Default Time
Chicken	400°F	35MIN
Beef	400°F	20MIN
French Chips	360°F	18MIN
Toast	340°F	10MIN
Reheat	340°F	5MIN
Defrost	100°F	30MIN
Dehydrate	160°F	360MIN

- 3 After selecting the preset program, you may also customize the time and temperature according to your needs. Check out our **Recipe Book** for more reference.

TEMPERATURE SETTING

- 1 Tap  on the panel to start setting the temperature for cooking.



- 2 Rotate the **Control Knob** clockwise to increase the temperature.
Rotate the **Control Knob** counterclockwise to decrease the temperature.



Tip:

The maximum temperature is 400°F. The temperature will be increased or decreased by 5°F for every rotation.

TIME SETTING

- 1 Tap  on the panel to start setting the time for cooking.



- 2 Rotate the **Control Knob** clockwise to increase the time.
 Rotate the **Control Knob** counterclockwise to decrease the time.



Tip:

The maximum cooking time is 360 minutes (for dehydrating) or 60 minutes (for other programs). The time will be increased or decreased by 1 minute for every rotation.

START/PAUSE COOKING

After selecting a preset program and setting the time & temperature, press the **Control Knob** to start cooking.



Press the **Control Knob** on the **Control Panel**, or simply draw out the fryer basket to pause cooking at any time during cooking.

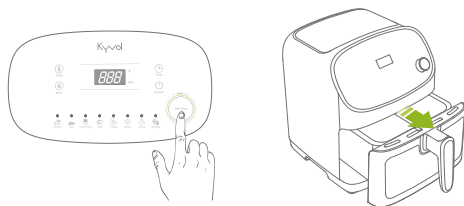

To resume cooking, push the basket back into place.

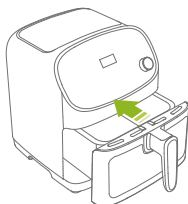

OVERHEAT PROTECTION

When the temperature of the air fryer reaches 428°F, the thermal protector inside the air fryer will automatically power off and the fryer will stop working. Please contact our after-sales service in time.

COOKING TIPS

- 1 Ensure that the height of the food does not exceed the height of the fryer basket.

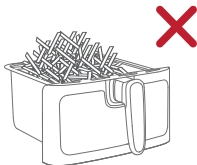

- 2 Do not put paper or plastic containers that are not heat-resistant into the air fryer.

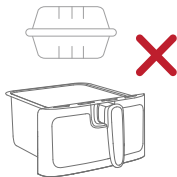

- 3 It is recommended to check the food through the window during the cooking process and pull out the basket to shake the food if necessary.



- 4 For more tips and directions, check out the **Recipe Book** we elaborately prepared for you!

MAINTENANCE AND CARE

Important:

- 1 Before cleaning, unplug your air fryer and wait until it cools completely. You may draw out the fryer basket for faster cooling.

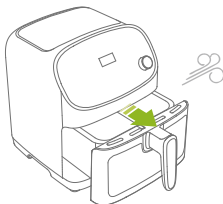

- 2 Do not immerse the whole air fryer in water or any other liquid.

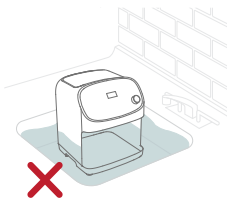

- 3 After cleaning, always remember to dry all the parts, especially the heating coil.

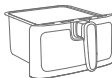

EXTERIOR

Use a clean and damp cloth to wipe the exterior of the air fryer.

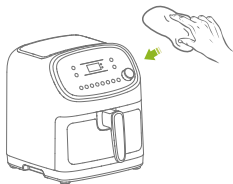

FRYER BASKET AND CRISPER PLATE

Dishwasher safe. Do not use metal utensils or abrasive cleaning materials to clean the nonstick coating.

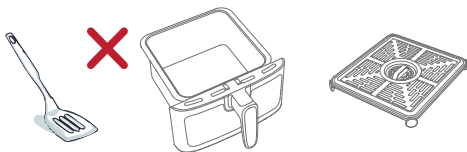

STUBBORN FOOD RESIDUE

Clean the food residue stuck on the basket and the plate by soaking in warm and soapy water.

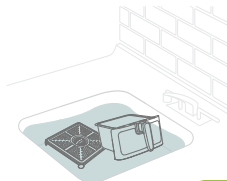

SPECIFICATIONS

Model	AF60
Dimensions	284mm × 371mm × 337mm
Capacity	6.0L
Input	120V, 60HZ
Rated Power	1050W
Net Weight	5.6kg

TROUBLESHOOTING GUIDE

Q1. The air fryer will not turn on.

- *Check if you have plugged in the air fryer.
- *Push the basket securely into the air fryer.

Q2. The LED Display does not show anything.

- *Check if you have plugged in the air fryer.
- *Check if you have powered on the air fryer.
- *Check if the LED display screen is broken.

Q3. Food is not completely cooked.

- *Check if you have put too much food on the **Crisper Plate**. The foods will be undercooked if the basket is overfilled.
- *Increase the cooking temperature or time.

Q4. The Fryer Basket cannot be pushed into the fryer securely.

- *Check if you have put too much food on the **Crisper Plate**. Make sure the height of the food does not exceed the height of the fryer.
- *Check if the edges of the air fryer are deformed. Contact us to deal with such issues.

Q5. White smoke comes out of the air fryer.

- *Cooking high-fat food will cause fat to drip to the bottom of the basket, which is normal. To avoid excess smoke while cooking, pour out fat drippings after every cooking and clean the air fry according to the instructions.

Q6. The LED Display shows E1.

- *There is open circuit of the temperature sensor. Contact us to deal with such issue.

Q7. The LED Display shows E2.

- *There is short circuit of the temperature sensor. Contact us to deal with such issue.

Q8. The LED Display shows E3.

- *The air fryer overheated. Draw out the air fryer and wait until it cools down. Contact us if issue like this occurs again.

CAUTION



The symbol indicates AC voltage



RECYCLING

This product bears the selective sorting symbol for Waste electrical and electronic equipment (WEEE). This means that this product must be handled pursuant to European directive 2012/19/EU in order to be recycled or dismantled to minimize its impact on the environment. User has the choice to give his product to a competent recycling organization or to the retailer when he buys a new electrical or electronic equipment.

This product can be used across EU member states.

EU Compliance Statement: Shenzhen VanTop Technology & Innovation Co., Ltd. hereby declares that this device is in compliance with the essential requirements and other relevant provisions of the Directive 2014/30/EU and 2014/35/EU.



CUSTOMER SUPPORT

North America : support@kyvol.com

United Kingdom : support.uk@kyvol.com



[@kyvolglobal](https://www.facebook.com/kyvolglobal)



www.kyvol.com



[@kyvol_global](https://www.instagram.com/kyvol_global)