

# Saramonic

Sound.Remarkable. 

Full-Duplex Wireless Intercom Headset System

全双工无线对讲耳机系统

## WiTalk WT5D

User Manual  
用户手册



## Statement

Please read this manual carefully before use and operate and store in strict accordance with the instructions provided. Please retain for future reference.

For any issues that cannot be resolved with the user manual, please refer to your retailer for help or contact us at: [info@saramonic.com](mailto:info@saramonic.com).

## Introduction

WiTalk WT5D is a full-duplex wireless intercom headset system that offers two-way communication at a range of up to 400m. It includes a Master headset and four Remote headsets, allowing up to 5 people to communicate simultaneously. Thanks to its hands-free design, WiTalk WT5D is ideal for applications where teams need full use of their hands, such as filmmaking, sports events, production crew communication, etc.

## Packing List

Dual-Ear Master Headset×1  
Dual-Ear Remote Headset×4  
12V/2.5A DC Adapter×1  
(CN, EU, USA Adapter Plugs included)  
Ten-Port Charger×1  
Rechargeable Battery×5

### Dual-Ear Master Headset



- ① Microphone
- ② Status indicator
- ③ Power button
- ④ Volume control (+/- button)
- ⑤ MIC/MUTE button
- ⑥ Release button
- ⑦ Battery compartment
- ⑧ USB-C charging port
- ⑨ Charging indicator

## Dual-Ear Remote Headset



- ① Microphone
- ② Status indicator
- ③ Power button
- ④ Volume control (+/- button)
- ⑤ MIC/MUTE button
- ⑥ Release button
- ⑦ Battery compartment
- ⑧ USB-C charging port
- ⑨ Charging indicator

## Ten-Port Charger

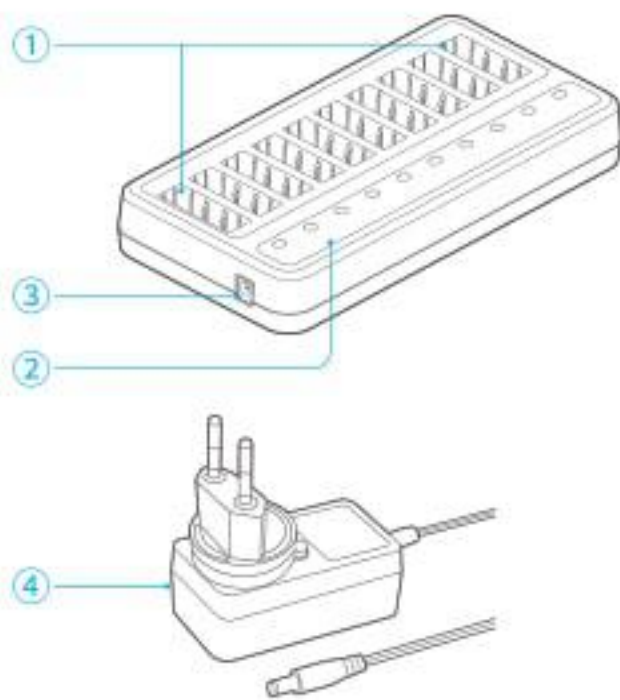

- ① Charging ports
- ② Charging indicators
- ③ DC jack
- ④ 12V/2.5A DC adapter

## Operation Guide

### How to Wear

1. Put on the headset and adjust to a comfortable size and position.

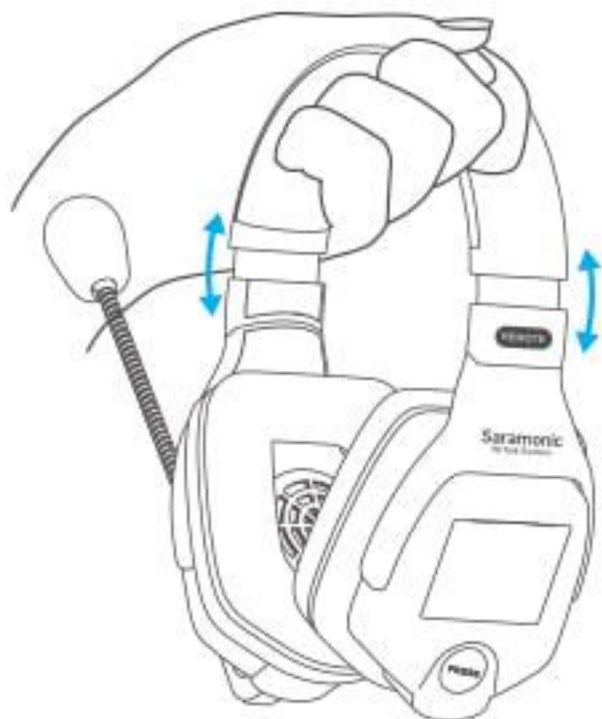

2. Adjust the boom and position the microphone capsule at about 2 cm in front of your mouth for optimum audio.

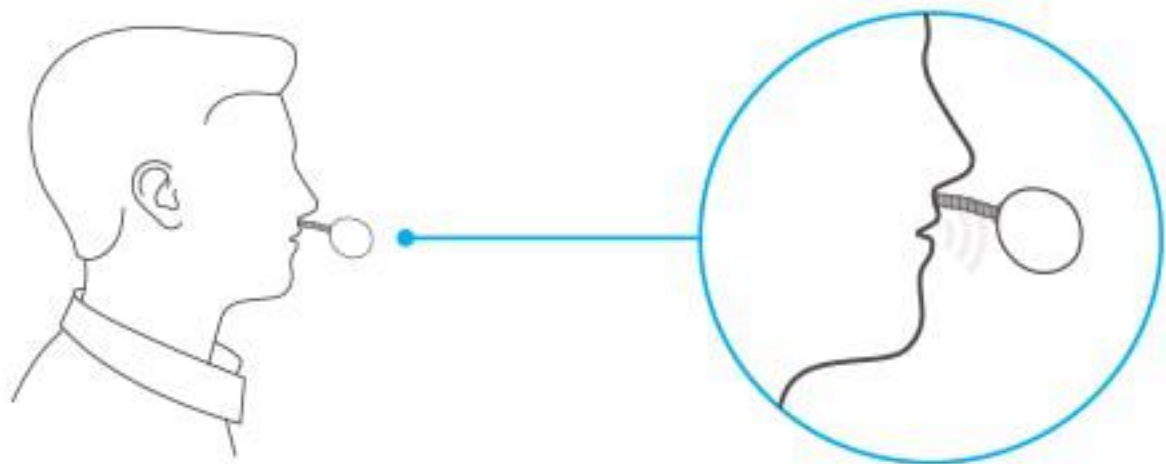

## Power ON/OFF

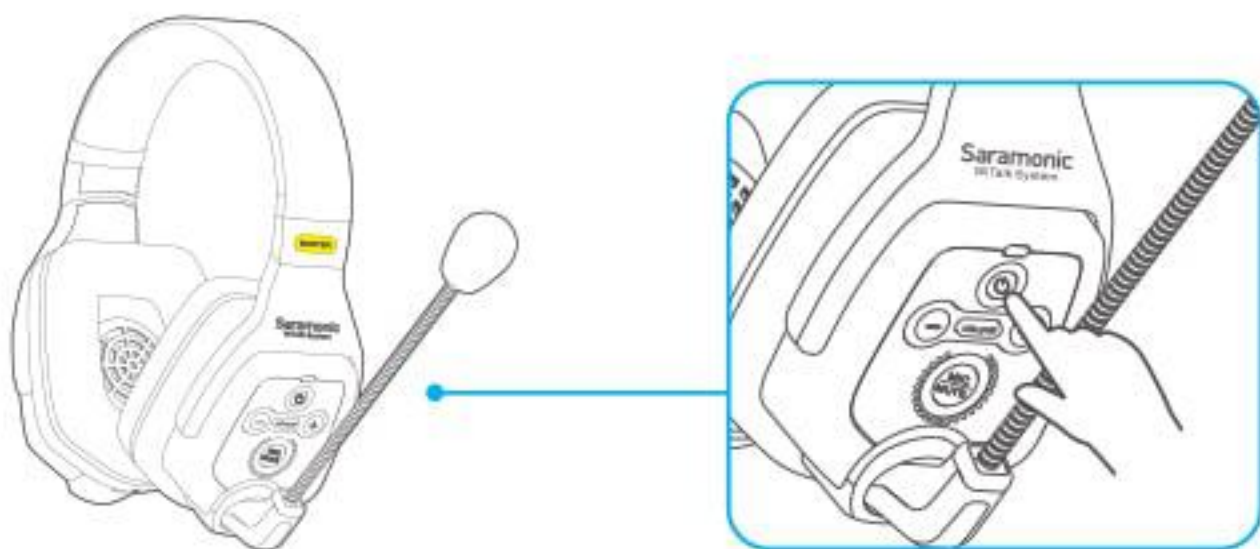

Press and hold the power button to turn on/off the Master/Remote headset.



## Pairing

Before leaving factory, the WiTalk WT5D system is pre-paired. Therefore, the connection will be established once they are powered on. If they are disconnected, please follow below steps:

1. Make sure that the Master headset and four Remote headsets are powered off.
2. Press and hold the "+" button and the power button of Master headset simultaneously until indicator flashes blue rapidly. Then, press and hold the "+" button and the power button of Remote headset simultaneously to enter pairing mode.

**Note: Each Master headset can have a maximum of 4 Remote headsets paired.**

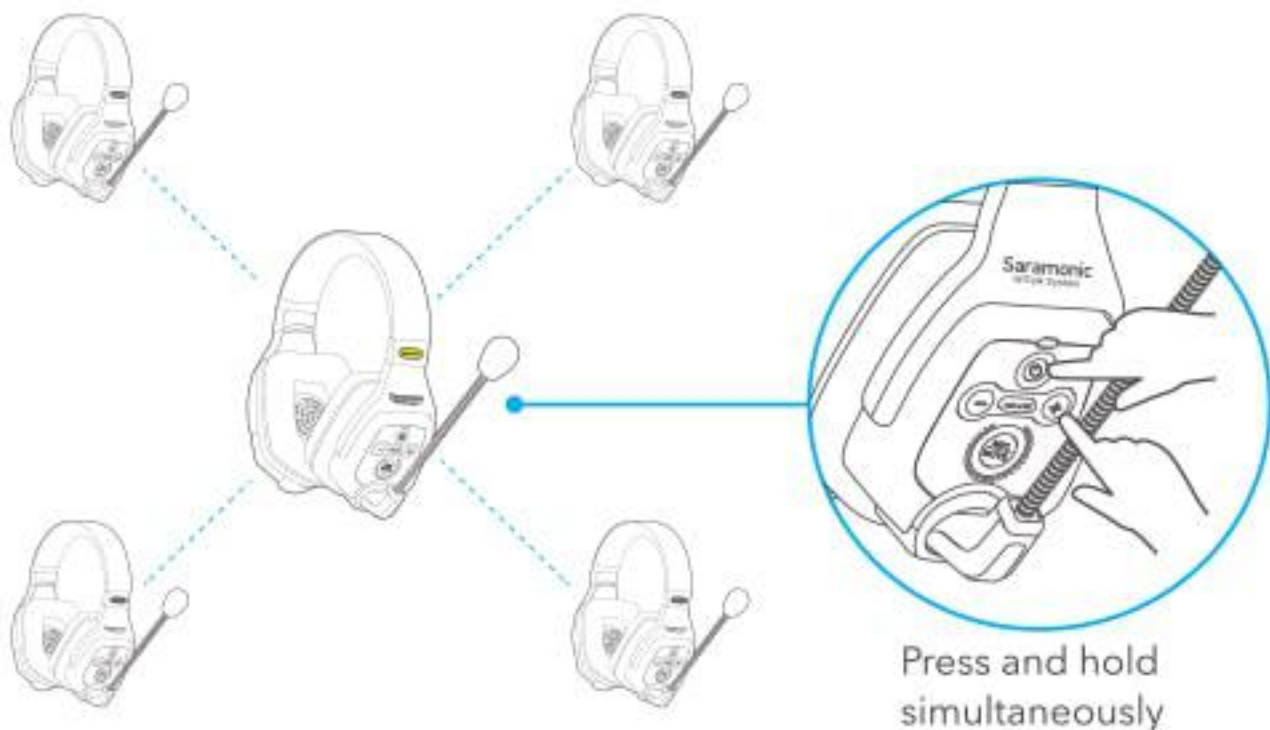



3. When indicators of Remote headsets turn slow flashing in blue light, press the power button of Master headset, the Master and the Remote headsets will be successfully paired within 10s, and all the indicators will turn solid blue.

Mode	Status indicator
Unpaired	Slowly flashing blue light
Pairing	Quickly flashing blue light
Paired Successfully	Solid blue light

**Note:**

1. When successfully paired with four Remote headsets, the indicator of Master headset will flash red, blue and purple, indicating that the maximum number of pairings has been reached.
2. After successfully paired with four Remote headsets, the Master headset cannot enter pairing mode by pressing power button and "+" button simultaneously. The indicator will blink red light. If you want to re-enable pairing mode, please clear the Master headset first.

## Mute Function

Boom can swivel over the top 270 degrees. Thus, headset can be worn on both sides.

You can mute/unmute the microphone in the following two ways:



② Press the MIC/MUTE button to mute/unmute the microphone.

Mode	Status indicator
Mute ON	Flashing red light
Mute OFF	Solid blue light



## Volume Control

Press the “-” button to decrease headphone volume.

Press the “+” button to increase headphone volume.

## Clearing the Master Headset

When pairing with a repaired or replaced unit, the Master headset needs to be cleared before a Remote headset can be paired. Follow the steps below to clear the Master headset:

1. Make sure the Master headset is powered OFF.
2. Press and hold the power button and the “-” button until indicator flashes red and blue alternately. When the indicator turns off, the Master headset is cleared.

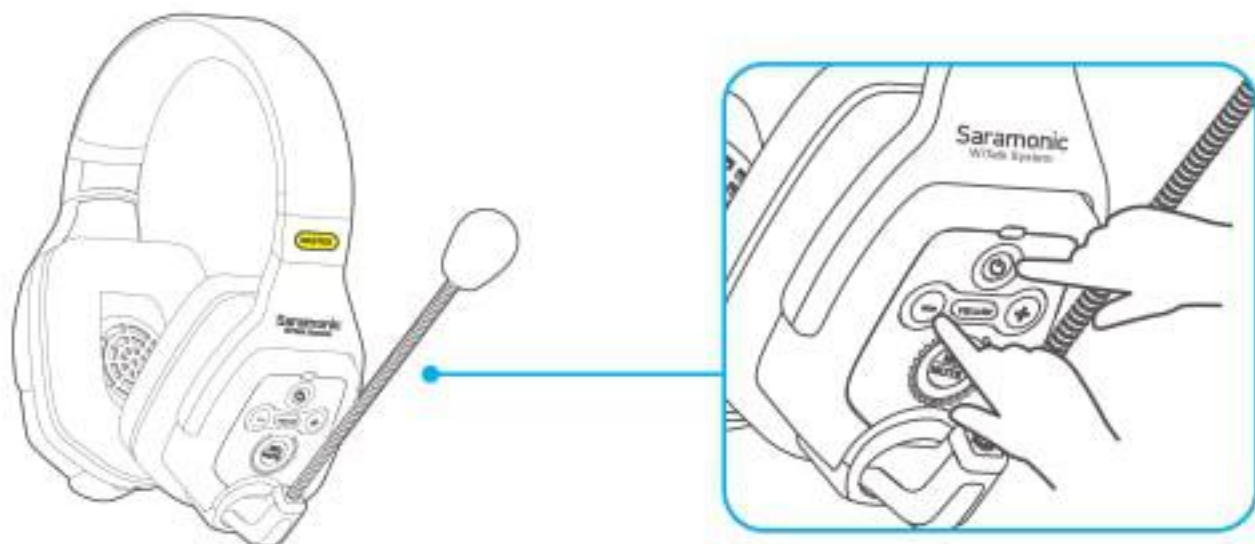

## Battery Charging

Please recharge the device when battery is low.

Mode	Status indicator
Low Battery	Solid red light

1. Charge the battery via the charger.

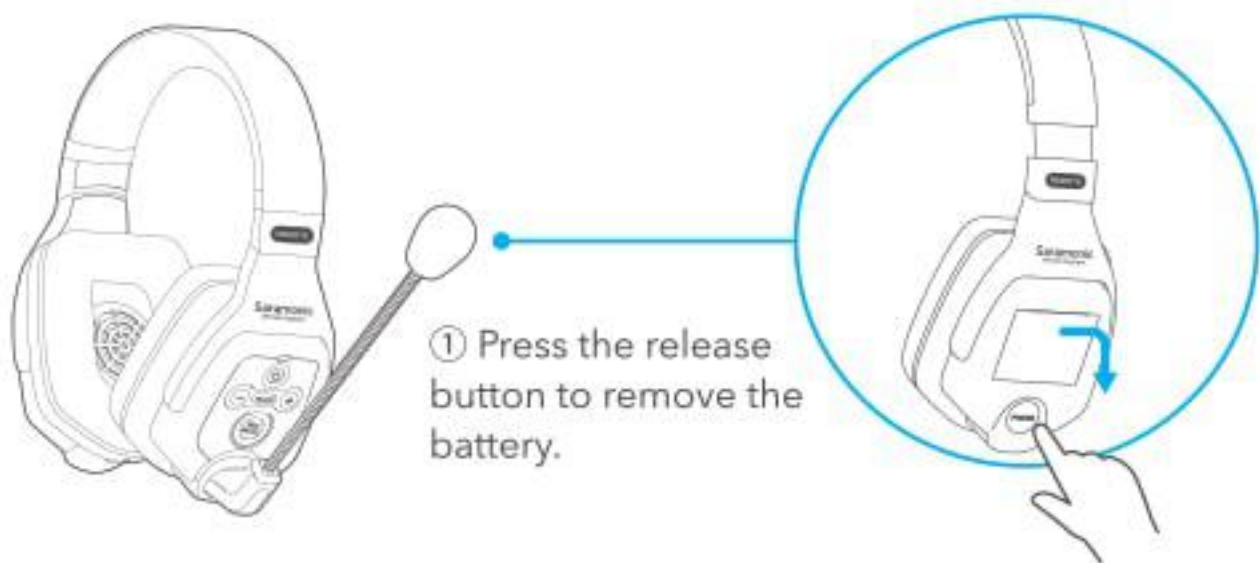

② Insert the battery and make sure the contacts are properly aligned.

Mode	Charging Indicator (Charger)
Charging	Solid red light
Fully Charged	Solid blue light

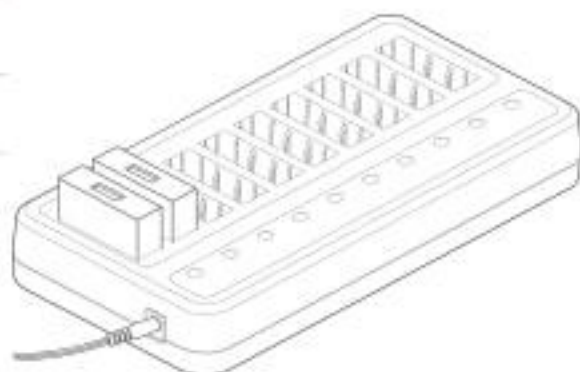

## 2. Charge the battery via a USB-C charging cable:

Mode	Charging Indicator (Headset)
Charging	Solid red light
Fully Charged	Solid blue light

Note: USB-C charging cable not included

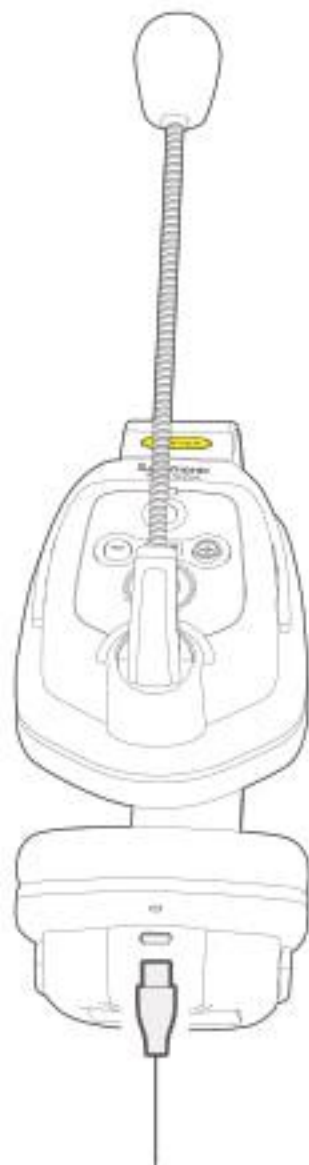

## Specifications

### Dual-Ear Master Headset

Duplex mode	Full-Duplex (FDX)
Modulation	GFSK
Carrier frequencies	1787MHz-1928MHz
Microphone type	Condenser microphone
Operating range	Up to 1312ft (400m) without obstacles
Frequency response	300Hz-5KHz
RF output power	<24dBm
Power consumption	<0.5W
SNR	65dB and more
Distortion	<1%
Power requirements	Li-ion Battery 3.7V/1200mAh or USB-C DC 5V
Battery life	Approx. 10 hours(with 2 Remotes), 5 hours(with 4 Remotes)
Weight	Approx. 360g(12.7oz)
Dimensions	175.1x203.1x85.8mm
Operating temperature	-10°C to 50°C
Storage temperature	-20°C to +55°C



## Dual-Ear Remote Headset

Duplex mode	Full-Duplex (FDX)
Modulation	GFSK
Carrier frequencies	1787MHz-1928MHz
Microphone type	Condenser microphone
Operating range	Up to 1312ft (400m) without obstacles
Frequency response	300Hz-5KHz
RF output power	<24dBm
Power consumption	<0.5W
SNR	65dB and more
Distortion	<1%
Power requirements	Li-ion Battery 3.7V/1200mAh or USB-C DC 5V
Battery life	Approx. 18 hours
Weight	Approx. 360g(12.7oz)
Dimensions	175.1x203.1x85.8mm
Operating temperature	-10°C to 50°C
Storage temperature	-20°C to +55°C





Scan the QR code and follow us!  
扫描微信关注枫笛公众号

---

**Shenzhen Jiayz Photo Industrial., Ltd**  
深圳市长丰影像器材有限公司

A16 Building, Intelligent Terminal Industrial Park of Silicon Valley  
Power, Guanlan, Longhua District, Shenzhen, China  
深圳市龙华区观澜街道大富工业区硅谷动力智能终端产业园 A16 栋



400-613-1096



[www.saramonic.com](http://www.saramonic.com)



[info@saramonic.com](mailto:info@saramonic.com)