

KENWOOD

KTC-500DAB





Safety

 Before you use your KTC-500DAB, read the following safety instructions.

1. Follow the operating instructions provided and take note of any warnings.
2. If you do not follow the operating instructions provided, it may compromise the safety of your product and this may invalidate the warranty.
3. Only use the supplied 12V power adapter with your product.
4. Do not install your product in a way that may interfere with the safe operation of the vehicle, or affect the deployment of air bags or other safety items. Do not install cables and wires near the steering wheel.
5. Do not place your product on or near sources of your vehicle's heat or ventilation.
6. Do not use your product in a way that may cause careless driving or improper control of your vehicle.
7. Keep your product dry and only clean with a dry cloth.
8. Do not expose your product to naked flames.
9. Use batteries of the type listed in this user manual, and fit batteries correctly. Dispose of batteries in an environmentally friendly manner. Do not expose batteries to excessive heat or naked flames.
10. Keep batteries away from children. If the battery compartment does not close securely, do not use the product and keep it away from children. If you think someone has swallowed a battery or placed a battery inside their body, seek medical attention immediately.
11. Do not use your product in extremely hot or cold temperature.
12. If you need to connect your product to the rear of your vehicle's head unit, remove any power before you start to install your product. When you have safely installed your product, you can reconnect the power. See your vehicle's owner's manual for more information.
13. Do not use the product if it is damaged.
14. Product repairs should only be carried out by authorised personnel.
15. Remove the 12V power adapter from the vehicle's power socket when you replace the battery of the vehicle.

Symbols on the product and in the user manual

 Potentially serious risk to your personal safety. To avoid possible injury or death, obey all safety notices with this symbol.

 Caution. Read the user manual before use.

 12V DC power supply.

1A USB socket rated at 1 amp maximum.

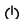
 Where to switch on or off the product, or put it in standby.

Contents

Safety			
Contents			
Overview			
What's in the box			
Controls			
Display icons			
Getting started			
Installing your KTC-500DAB			
Where to install your KTC-500DAB			
Connecting the microphone to the antenna			
Positioning the antenna			
Positioning the microphone			
Connecting the antenna			
Installing the wireless controller			
Switching your KTC-500DAB on for the first time			
Switching your KTC-500DAB on and off			
Digital radio			
Listening to digital radio			
Presets			
	1	Bluetooth	14
	2	Pairing your KTC-500DAB with a mobile device	14
	3	Listening to audio stored on your mobile device	14
	3	Making and receiving calls on your KTC-500DAB	15
	4	Using your mobile device's personal assistant	15
	5	Settings	16
	6	Changing between auxiliary connection and FM transmission	16
	6	Setting your KTC-500DAB to enter standby automatically	16
	7	Radio settings	16
	8	Display settings	17
	8	Updating the software	18
	9	Troubleshooting	19
	10		
	11		
	12		
	12		
	13		
	13		
	13		

Overview

What's in the box

Before you get started, check you have everything below.

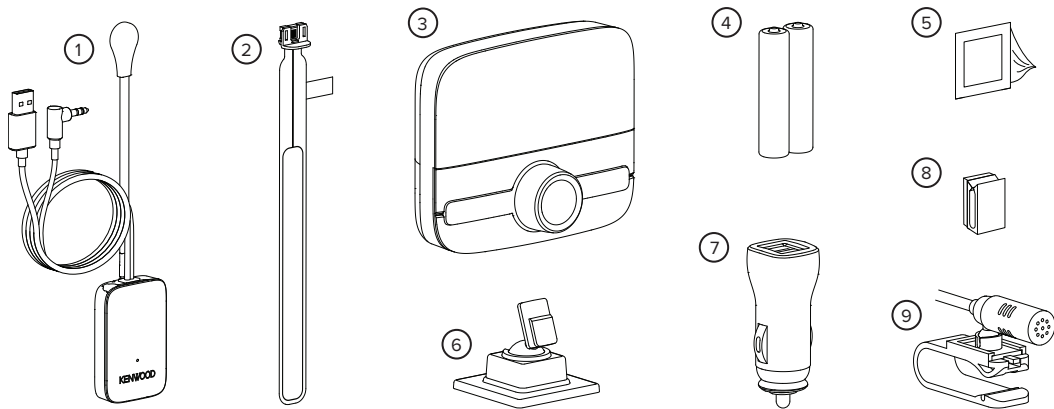

- 1 Antenna, with magnetic grounding tail attached
- 2 DAB film aerial
- 3 Wireless controller
- 4 Two AAA batteries
- 5 Cleaning cloth

- 6 Wireless controller bracket
- 7 12V power adapter (dual USB port)
- 8 Self-adhesive cable clips
- 9 Microphone

Controls

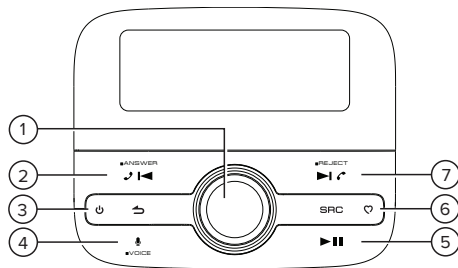

- 1 Select** Turn to browse radio stations, songs and menu options. Press to select.
- 2 Previous / Call** Press to skip to the previous song or preset, or answer an incoming call.
- 3 Power / Back** Press to switch your KTC-500DAB on. Press and hold to put your KTC-500DAB in standby. Press to go back to the previous screen or cancel an action.
- 4 Personal assistant** Press and hold to use the personal assistant on your mobile device.
- 5 Play** Press to play or pause songs over Bluetooth, or mute the radio.
- 6 Source / Presets** Press to open the main menu. Press and hold to view your presets.
- 7 Next / End call** Press to skip to the next song or preset, or reject an incoming call.

Display icons

The icons below appear on the screen of the wireless controller.

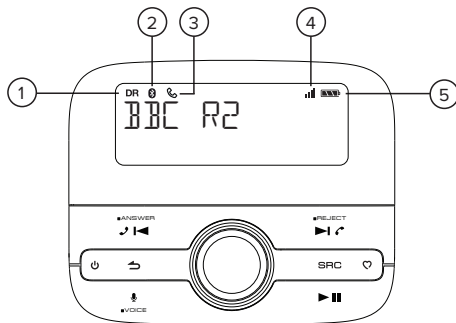

- | | |
|-----------------------------|---|
| 1 Digital radio mode | 4 Signal strength of connected mobile device |
| 2 Bluetooth mode | 5 Battery level of connected mobile device |
| 3 In a call | |

Getting started

Installing your KTC-500DAB

Before you can start using your KTC-500DAB, you need to do the following:

1. Connect the microphone to the antenna.
2. Position the antenna in your vehicle.
3. Position the microphone in your vehicle.
4. Connect the antenna to your vehicle's audio system, either with an auxiliary cable or by FM radio.
5. Install the wireless controller.
6. Switch your KTC-500DAB on for the first time.

Vehicle requirements

- Fitted audio system with auxiliary (3.5mm) port or FM receiver.
- Standard 12V negative earth power supply. Your KTC-500DAB is not suitable for use with a 24V power supply.

Getting the best DAB signal

As with FM radio, DAB signal coverage changes depending on your location. As you use the KTC-500DAB in your vehicle, you may travel through areas where DAB signal coverage is poor.

To help get the best DAB signal when coverage is poor or there is a weak signal:

- Follow the installation instructions carefully.
- Ensure the magnetic grounding tail is attached to the antenna.
- Use the supplied 12V power adapter, as other third-party adapters can cause interference.
- Switch off other devices in your vehicle that aren't in use. Devices such as satellite navigation systems and dashboard cameras can cause interference.

Where to install your KTC-500DAB



It's important to install your KTC-500DAB in a safe location in your vehicle. Do not fit any components in locations that may interfere with safe operation of the vehicle, or affect the deployment of air bags or other safety products. Keep cables and wires away from the steering wheel.

Where to install the antenna

We recommend you install the antenna for your KTC-500DAB in the top corner of the windscreen, on the passenger's side of your vehicle.

Install the antenna so that it is not within the swept area of the windscreen. Make sure the antenna and wireless controller do not obstruct the view of the driver.

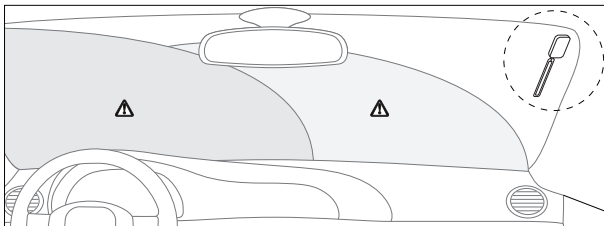

If you have a heated windscreen in your vehicle, or the windscreen contains metallic UV filters, it can cause interference for the DAB signal. Install the antenna on a part of the windscreen that does not contain heating elements or UV filters.

i For more information on where to safely and legally install your KTC-500DAB in your vehicle, contact your local transport office.

Connecting the microphone to the antenna

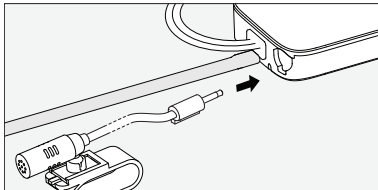

1. Insert the microphone connector into the socket at the top of the antenna, until it clicks into place.
Note: Push the microphone cable in firmly, to ensure it's fully inserted.
2. To keep the microphone cable out of the way while you position the antenna, temporarily clip the microphone so that it's near the driver's position. For example, clip the microphone to the driver's sun visor.

Positioning the antenna

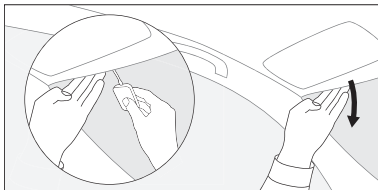

1. Choose a position for the antenna, so that it's as high as possible on the windscreen and at least 4cm from the side of the screen.
⚠ Make sure the antenna does not obstruct the view of the driver.
2. Gently pull down the front of the roof liner in your vehicle, until there is a small gap.
3. Push the magnetic grounding tail through the gap, with the silver-coloured magnet facing upwards. Make sure the magnet touches your vehicle's metal bodywork.
4. Clean the chosen area of the windscreen with a cleaning cloth and wait for it to dry.
5. Unpeel the backing from the antenna and stick the antenna onto your windscreen.

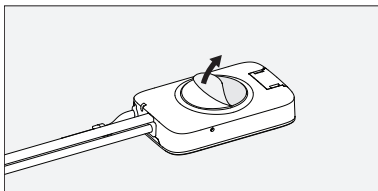

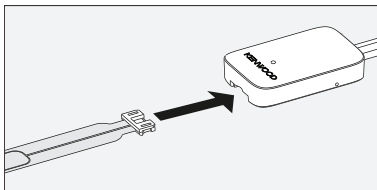

6. Insert the DAB film aerial into the slot in the antenna.
7. Gently unpeel the backing from the DAB film aerial and stick the aerial onto your windscreen. Take care not to fold or twist the aerial.

Positioning the microphone

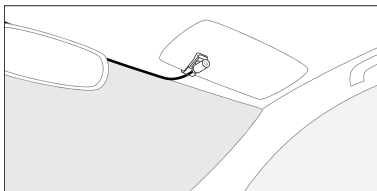

1. If possible, tuck the cable into the roof lining, keeping the microphone near the driver's position. Alternatively, use self-adhesive clips to fix the microphone cable along the top of your windscreen.
2. Clip the microphone to a suitable location, such as the roof lining or the driver's sun visor.

Connecting the antenna

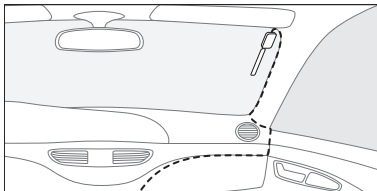

1. Place the antenna cable so that it follows a path to your vehicle's power socket.
2. If possible, tuck the cable behind the trim down the side of your windscreen. Alternatively, secure the cable to your windscreen and dashboard with self-adhesive clips.

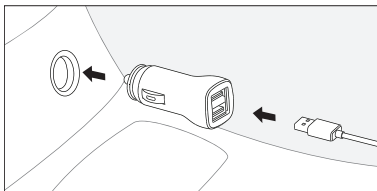

3. Gently pull the auxiliary cable from the USB power cable to separate them.
4. Insert the USB power cable into the supplied 12V power adapter, then insert the power adapter into your vehicle's power socket.

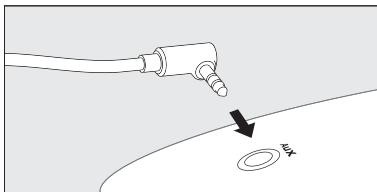

5. If you're connecting your KTC-500DAB with an auxiliary cable, insert the cable into your vehicle's auxiliary socket. If you're connecting your KTC-500DAB by FM radio, you can store the auxiliary cable so it's out of the way.
i We recommend you connect your KTC-500DAB with an auxiliary cable to get the best audio quality.

Installing the wireless controller

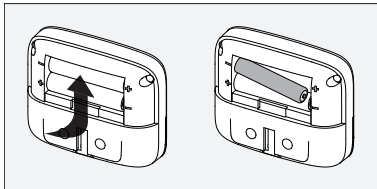

1. Slide the back cover off of the wireless controller and insert the batteries, then replace the cover.
2. Choose an area on your vehicle's dashboard where you want to install the wireless controller. Clean the surface with a cleaning cloth and wait for it to dry.

⚠ Make sure the wireless controller does not obstruct the view of the driver.

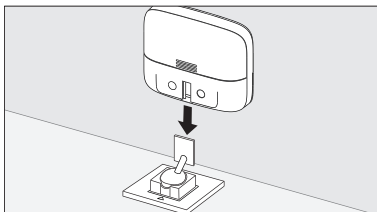

3. Peel off the backing from the wireless controller bracket and gently stick it onto your dashboard. Gently press the bracket to ensure it's attached securely.
4. Slide the wireless controller onto the bracket, until it clicks into place.

Switching your KTC-500DAB on for the first time



After you've installed your KTC-500DAB, switch it on to finish setting it up.

1. Turn on your vehicle's ignition to make sure the antenna is switched on. After a few seconds, the wireless controller automatically connects to the antenna. If not, see page 19.
2. Turn the Select dial to change the display language, then press the Select dial to choose it.
3. Turn and press the Select dial to choose how to connect your KTC-500DAB to your vehicle.
 - If you've connected your KTC-500DAB with an auxiliary cable, choose 'LINE OUT'.
 - If you're connecting your KTC-500DAB by FM radio, choose 'FM TRANSMIT' and then choose an FM frequency. Ensure a radio station isn't using the frequency you choose.

i Tune your vehicle's audio system to the same FM frequency as your KTC-500DAB. To easily find the FM frequency in the future, save it as a preset on your vehicle's audio system.

After you've chosen how to connect your KTC-500DAB, it starts tuning to digital radio stations. When the autotune is complete, you can start listening to digital radio.

Switching your KTC-500DAB on and off

- To switch on your KTC-500DAB, press .
- To put your KTC-500DAB in standby and use less power, press and hold .

Note: By default, the antenna automatically enters standby after 4 hours, and the screen on the wireless controller dims after 15 seconds. Read more about the display brightness on page 18.

Digital radio



Listening to digital radio

1. Press **SRC**.
2. Press the Select dial to choose 'DIG. RADIO'.
3. To change to another radio station, turn and press the Select dial.





Presets

You can save up to 20 of your favourite digital radio stations in the presets list.

Storing a radio station as a preset

1. When listening to a radio station, press and hold .
2. Turn the Select dial to choose a preset number. You can overwrite previous radio stations.
3. Press and hold  to save the current radio station to the preset number.

Listening to a preset

1. When listening to digital radio, press and hold .
2. Turn and press the Select dial to choose the preset you want to listen to.
 To skip to the previous or next preset, press  or .

Bluetooth

Pairing your KTC-500DAB with a mobile device

You can use Bluetooth to wirelessly connect to a mobile device. You can then stream music from your mobile device and make hands-free calls.

1. Switch on Bluetooth on your mobile device.
2. Press **SRC** on the wireless controller for your KTC-500DAB.
3. Turn and press the Select dial to choose 'SETTINGS' > 'BLUETOOTH' > 'PAIR'.
4. On your mobile device, choose your KTC-500DAB from the list of Bluetooth devices and connect to it.

After you've paired a mobile device with your KTC-500DAB, your KTC-500DAB automatically connects to it when it's nearby.

i To forget a paired mobile device on your KTC-500DAB, press **SRC**. Then choose 'SETTINGS' > 'BLUETOOTH' > 'FORGET'.

Listening to audio stored on your mobile device

If you connect your KTC-500DAB to a mobile device using Bluetooth, you can play music that is stored on your mobile device.

1. Press **SRC**.
2. Turn and press the Select dial to choose 'BT MUSIC'.
3. Turn and press the Select dial to choose a song to play.
4. To skip to the previous or next song, press **◀** or **▶**. To play and pause the current song, press **▶ ||**.

Note: If you see 'BROWSE NOT AVAILABLE', your mobile device or the current app does not support browsing.

If you see '+', the item is a folder that contains audio files. Press the Select dial to open the folder.

Making and receiving calls on your KTC-500DAB



You can make hands-free calls on your KTC-500DAB, using Bluetooth to connect to your mobile device. If the volume or microphone aren't working, see page 20.

Calling a contact

1. Press **SRC**.
2. Turn and press the Select dial to choose 'PHONEBOOK' > 'CONTACTS'.
3. Turn the Select dial to find a contact in your contacts list.
4. To call the contact, press the Select dial.
5. To end the call, press .



i To view your call history on your KTC-500DAB, press **SRC**. Then choose 'PHONEBOOK' and view your dialled, received or missed calls.

Answering or rejecting a call

- To answer an incoming call, press . To end the call, press .
- To reject an incoming call, press .

Using your mobile device's personal assistant

If you connect your KTC-500DAB to a mobile device using Bluetooth, you can use it to access your device's personal assistant.

1. Press and hold .
2. When prompted, ask a question to your mobile device's personal assistant.
 - i** To cancel your mobile device's personal assistant, press  or .

Settings

Changing between auxiliary connection and FM transmission

You can choose how your KTC-500DAB is connected to your vehicle's audio system.

1. Press **SRC**.
2. Turn and press the Select dial to choose 'SETTINGS' > 'AUDIO OUT'.
3. Turn and press the Select dial to choose how to connect your KTC-500DAB to your vehicle.
 - If you've connected your KTC-500DAB with an auxiliary cable, choose 'LINE OUT'. Then turn and press the Select dial to choose a gain setting of 'LOW' or 'NORMAL'. If the audio sounds distorted, choose 'LOW'.
 - If you're connecting your KTC-500DAB over FM radio, choose 'FM TRANSMIT' and then choose an FM frequency. Ensure a radio station isn't using the frequency you choose.

Setting your KTC-500DAB to enter standby automatically

By default, your KTC-500DAB enters standby after 4 hours, but you can change the delay.

1. Press **SRC**.
2. Turn and press the Select dial to choose 'SETTINGS' > 'AUTO STANDBY'.
3. Turn and press the Select dial to choose a delay between 1 and 8 hours.

Radio settings

Performing an autotune

If you can't find any digital radio stations, try retuning your KTC-500DAB.

- To perform an autotune, press and hold the Select dial when you are in digital radio mode.

Listening to alternative stations when the signal is weak

If the current radio station has a weak signal, your KTC-500DAB automatically tries to find a stronger signal. If your KTC-500DAB can't find a stronger signal for the current radio station, it can automatically tune to a similar radio station when supported by the broadcaster.

1. Press **SRC**.
2. Turn and press the Select dial to choose 'SETTINGS' > 'DIG. RADIO' > 'ALT STATION'.
3. Turn and press the Select dial to choose 'ON' or 'OFF'.

Switching traffic announcements on and off

You can set your KTC-500DAB to automatically play traffic announcements when you are listening to digital radio. When your KTC-500DAB plays traffic announcements, it displays 'TRAFFIC'.

1. Press **SRC**.
2. Turn and press the Select dial to choose 'SETTINGS' > 'DIG. RADIO' > 'TRAFFIC MSG'.
3. Turn and press the Select dial to choose 'ON' or 'OFF'.

i To cancel a traffic announcement when it plays, press .

Display settings

Changing the language

1. Press **SRC**.
2. Turn and press the Select dial to choose 'SETTINGS' > 'DISPLAY' > 'LANGUAGE'.
3. Turn and press the Select dial to choose a language.

Changing the information displayed on the screen

Your KTC-500DAB can display the name of the radio station you are listening to, or the quality and signal strength of the station.

1. Press **SRC**.
2. Turn and press the Select dial to choose 'SETTINGS' > 'DISPLAY' > 'INFO'.
3. Turn and press the Select dial to choose a setting.
 - To display the names of radio stations, choose 'STATION'.
 - To display the quality and signal strength of radio stations, choose 'QUALITY'.

Changing the screen brightness







A light sensor on the wireless controller automatically sets the screen brightness, but you can manually change it.

1. Press **SRC**.
2. Turn and press the Select dial to choose 'SETTINGS' > 'DISPLAY' > 'BRIGHTNESS' > 'MANUAL'.
3. Turn and press the Select dial to choose a brightness level.
 - i** By default, the screen on the wireless controller automatically dims after 15 seconds. To change the length of time before the screen dims, choose 'SETTINGS' > 'DISPLAY' > 'TIMEOUT'.

Updating the software

We may provide software updates to improve your KTC-500DAB. To find out more about updating the software on your KTC-500DAB, visit kenwood.com/cs/ce/.

Troubleshooting

Problem	Possible cause	Solution
The wireless controller displays 'ANTENNA CONNECTING' or 'CHECK POWER TO ANTENNA'.	The antenna isn't connected to the power supply, or the controller isn't paired correctly with the antenna.	Remove the power adapter from the 12V socket, then insert it. If the antenna has power, the antenna's status light lights up for 5 seconds and the controller connects to the antenna within 30 seconds. Note: If you can't access the power adapter, perform a power reset*. If this doesn't solve the problem, pair the controller with the antenna: <ol style="list-style-type: none">1. Use a paperclip to press the reset button on the antenna. The status light on the antenna flashes slowly.2. Place the controller within 50cm of the antenna, then press and hold ,  and  together. If the controller does not connect to the antenna within 30 seconds, repeat steps 1 and 2.
The status light on the antenna is constantly lit.	Your KTC-500DAB is in update mode.	If you are updating the software, finish the update. If not, remove the power adapter from the 12V socket, then insert it. If the antenna has power, the status light on the antenna lights up for 5 seconds and the controller connects to the antenna within 30 seconds. Note: If you can't access the power adapter, perform a power reset*.
The status light on the antenna is flashing.	The controller has lost connection with the antenna.	To pair the controller with the antenna: <ol style="list-style-type: none">1. Use a paperclip to press the reset button on the antenna. The status light on the antenna flashes slowly.2. Place the controller within 50cm of the antenna, then press and hold ,  and  together. If the controller does not connect to the antenna within 30 seconds, repeat steps 1 and 2.

I can't hear any sound.	Your KTC-500DAB is not connected to your vehicle.	Ensure the auxiliary cable is firmly connected to your vehicle's audio system, or ensure you are tuned to the correct FM frequency.
	Your vehicle's audio system is not in the correct input source.	Change the input source on your vehicle's audio system to FM radio or auxiliary input.
	In Bluetooth mode, your KTC-500DAB is not connected to your mobile device.	Switch on Bluetooth on your mobile device. If required, pair your KTC-500DAB with your mobile device again. Read more on page 14.
	The volume is too low on your vehicle or connected mobile device.	Turn up the volume on your vehicle and on the connected mobile device.
Sound is distorted when my KTC-500DAB is connected with an auxiliary cable.	The gain setting isn't correct.	Set the gain setting to 'LOW' or change to FM transmission. Read more on page 16.
When I make hands-free calls, the other person can't hear me.	The microphone is not fully connected.	Use the instructions on page 8 to ensure the microphone is fully connected.
	The microphone is too far away from you.	Move the microphone as close to you as possible.
My KTC-500DAB keeps losing digital radio signal.	You are travelling through areas with weak DAB signal.	Check DAB coverage in your area.
	Your KTC-500DAB is not installed correctly.	Check the installation instructions on page 6.
	Something is causing interference.	<ul style="list-style-type: none"> Switch off satellite navigation systems, dashboard cameras or other devices to see if the signal improves. Use the supplied 12V power adapter, as other adapters can cause interference.
My KTC-500DAB keeps switching off by itself.	Auto standby mode is switched on.	If this is happening too often, change the auto standby setting. Read more on page 16.

I can't connect my KTC-500DAB to a compatible mobile device.	Bluetooth is switched off on your mobile device.	Check that your mobile device is Bluetooth compatible and Bluetooth is switched on.
	Another Bluetooth device is connected to your KTC-500DAB.	Switch off Bluetooth on the other device.
	Your KTC-500DAB isn't paired correctly with your mobile device.	Pair your KTC-500DAB with your mobile device again. Read more on page 14.
The wireless controller is unresponsive or the screen is blank.	The batteries in the controller are dead.	Replace the batteries in the controller.
	The software has stopped working.	Remove and then reinsert the batteries in the controller.

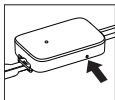

* To perform a power reset, use a paperclip to press and hold the reset button on the antenna for 10 seconds.

Correct disposal of this product



Disposal of old electrical and electronic equipment and batteries (applicable for countries that have adopted separate waste collection systems)

Products and batteries with the symbols shown on the left cannot be disposed of as household waste. Old electrical and electronic equipment and batteries should be recycled at a facility capable of handling these items and their waste byproducts. Contact your local authority for details in locating a recycle facility nearest to you. Proper recycling and waste disposal will help conserve resources whilst preventing detrimental effects on our health and the environment.

Note: The sign "Pb" below the symbol for batteries indicates that this battery contains lead.

Approvals

CE CE marked. Hereby, Kenwood declares that this Band II LPD device is in compliance with the essential requirements and other provisions of the R&TTE Directive 1999/5/EC or RED 2014/53/EU from 12th June 2017. Compliant with UNECE Regulation 10 (E-Mark) and EN 62479: 2010. You can view the Declaration of Conformity at <http://www.pure.com/about/rtte-doc>.

Specifications

Radio	Digital (DAB/DAB+)
Frequency ranges	Band III 174 - 240 Mhz
FM transmit range	87.6 - 107.9 MHz
Display	Backlit LCD with 2-line text display and custom icons
Receiver power supply	DC 12V 
Wireless controller power	2 x AAA batteries
Bluetooth	HFP (Hands Free Profile), A2DP (Advanced Audio Distribution Profile), AVRCP (Audio Video Remote Control Profile), OPP (Object Push Profile), PBAP (Phone Book Access Profile)
Temperature range	Operational temperature: -20°C to +60°C Storage temperature: -40°C to +85°C

Powered by
PURE

KENWOOD

www.kenwood.com

EU Representative:
JVCKENWOOD NEDERLAND B.V.
Amsterdamseweg 37
1422 AC UITHOORN
The Netherlands