

30407



1



2

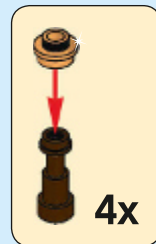
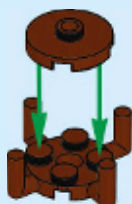

3



4

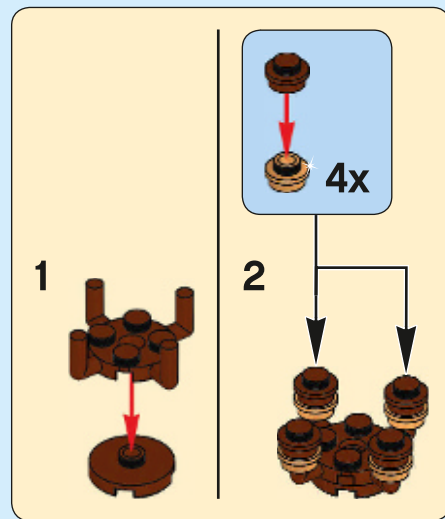

5



6



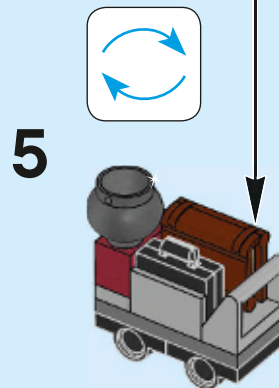
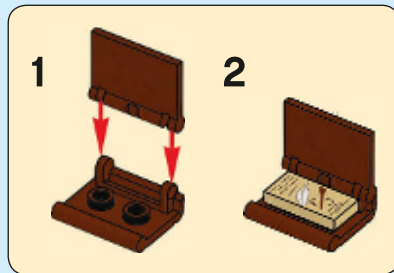
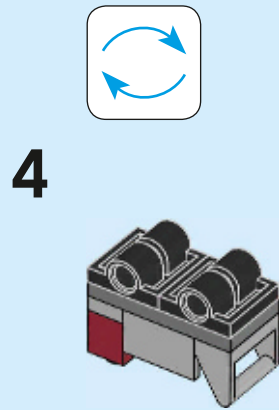
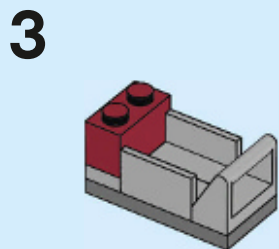
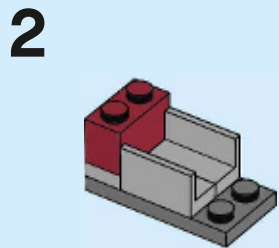
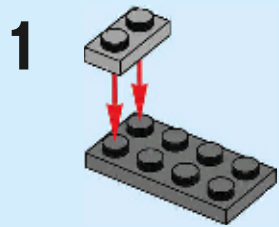

LEGO and the LEGO logo are trademarks of the LEGO Group. ©2018 The LEGO Group.
Anglia is a trademark owned and licensed by Ford Motor Company.
HARRY POTTER, FANTASTIC BEASTS characters, names and related indicia are © & ™ Warner Bros. Entertainment Inc. WB SHIELD: © & ™ WBEL. WIZARDING WORLD trademark and logo © & ™ Warner Bros. Entertainment Inc. Publishing Rights © JKR. (s18) 6248784