

5. How to Use

3. Press and hold the power switch for 3 seconds until the appliance work and then loosen your finger.

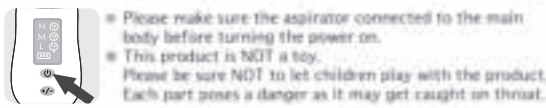

4. Press the suction adjustment button to adjust to the appropriate suction.
For children unable to use the device by themselves, please use the product with proper suction while the child is lying or being held comfortably.

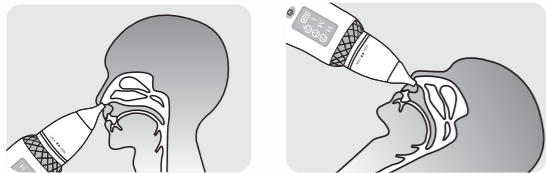

- Please do NOT press the device too deep into the nose. Do NOT press the tip of the device too hard against the nasal wall.
- Do NOT apply the device to mouth or eye. This aspirator is a device designed to relieve nasal congestion. Do NOT use the device for any other purpose than specified.
- Remaining foreign substance should be removed with the tweezers for infant. Be sure to use the tweezers for infant with the tweezers-tip. Tweezers tip protects the nasal mucous membrane and prevents deep insertion into the nose.
- When using the tweezers for infant, be sure to use with the tweezers-tip. Tweezers pose a potential danger for injury without its tip on.

5. Turn the power off by pressing the power switch after completing its use.



6. Storage & Maintenance

1. Disassemble the aspirator by separating the aspirator from the main body after the use.
2. Discard the foreign substance collected in the suction container.

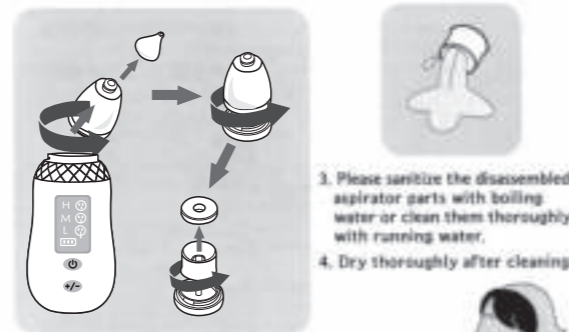

3. Please sanitize the disassembled aspirator parts with boiling water or clean them thoroughly with running water.
4. Dry thoroughly after cleaning.

• Please be sure to avoid the parts from touching the hot inner surface of the pot when boiling them with water.

5. Wipe the main body with soft cloth or clean it with water-soaked cloth if necessary.

- Please do NOT put the main body into water or other solutions. Nasal discharge with low viscosity might flow backward at times. Upon such occasion, please clean the surrounding area of the aspiration hole of the main body by using cotton swab.
- The main body is not waterproof, be sure to avoid the overflow of the suction container, please pour out first when it is almost full and then continue to suck. If overflowing nasal discharge was inhaled into the main body, it will cause short circuit or motor damaged.

- **Storage & Maintenance after the use of the product**
 - (1) Please avoid using or storing the product where fluid may come in contact with the product.
 - (2) Upon storage, please avoid the place with high humidity, temperature, sunlight or bad ventilation or air and place the product at the place without shock or vibration.
 - (3) Upon mechanical failure, please ask customer service center without disassembling the product.
 - (4) Please check the parts of the device on regular basis.



7. Checklist upon Mechanical Failure

Problem	Cause	Solution
When suction is too weak or not working	The aspirator is with low battery.	Check the charging indicator.
	Assembly is inappropriately conducted.	Check the assembly of the aspirator. (See Page 4)
	The connection between aspirator and main body is unstable.	Check the connection between aspirator and the main body.

Product Specifications

Name of Product	Electric Nasal & Ear Aspirator
Rated Voltage	5V 1000mA
Weight	165g(Main body)
Packing Unit	1set
Purpose of the Use	A device used to absorb nasal, ear secretion and mucus by utilizing external vacuum pressure.



Electric Nasal & Ear Aspirator

Safe for Newborns and Infants



Vancocon will wipe away all the worries and stress from you and your baby.
• Vancocon effectively cleans and absorbs nasal secretion from the deepest part of a nose without any stimulus.

1. Lay down or hold your baby safely.
2. Put the silicone tip all the way into your baby's nose and turn on the power.

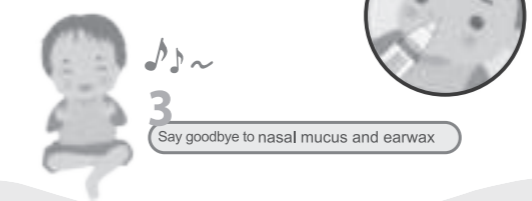

3. Say goodbye to nasal mucus and earwax.



Electric Nasal & Ear Aspirator

Safe for Newborns and Infants

Soft silicone tipped infant tweezers for effective removal of nasal discharge earwax



Mucus aspiration
Specially designed with suitable suction pressure for newborns and infants.



Note: 3 Seconds Pressing Start



Thank you for choosing our products. It is more convenient and safer if you read the user's manual before using the product.

- 1. Table of Contents 2
- 2. Cautions for Safety 3
- 3. Name of Each Part 4
- 4. Preparation prior to use 5
- 5. How to Use 6-7
- 6. Storage & Maintenance 8
- 7. What to Check upon Mechanical Failure 9

- Please be sure to read the user's manual before use for proper usage of the product.
- This product is approved for medical device.



Cautions for Safety

- Please comply with "Safety Warnings" in case of fire caused by power supply while using or storing by the proper and safe use of the product.
- "Safety Warning" are composed with "Warning" and "Caution" where the definition of "Warning" and "Caution" is as follows:

- Warning** Potential hazardous situation where critical injury or death may occur if not avoided.
 - Caution** Potential hazardous situation where slight injury may occur if not avoided.
- If you find any of the following items, please stop using the product immediately and contact your local distributor or the manufacturer for more information.
- A. Warning**
 - Do not use the device with the following conditions:
 - 1. The device is damaged or the power cord is broken.
 - 2. The device is used in a wet environment.
 - 3. The device is used near water.
 - 4. The device is used near heat sources.
 - 5. The device is used near flammable materials.
 - 6. The device is used near children.
 - 7. The device is used near pets.
 - 8. The device is used near electrical outlets.
 - 9. The device is used near power lines.
 - 10. The device is used near fire.
 - 11. The device is used near smoke.
 - 12. The device is used near dust.
 - 13. The device is used near oil.
 - 14. The device is used near grease.
 - 15. The device is used near acid.
 - 16. The device is used near alkali.
 - 17. The device is used near salt.
 - 18. The device is used near sugar.
 - 19. The device is used near honey.
 - 20. The device is used near jam.
 - 21. The device is used near jam.
 - 22. The device is used near jam.
 - 23. The device is used near jam.
 - 24. The device is used near jam.
 - 25. The device is used near jam.
 - 26. The device is used near jam.
 - 27. The device is used near jam.
 - 28. The device is used near jam.
 - 29. The device is used near jam.
 - 30. The device is used near jam.
 - 31. The device is used near jam.
 - 32. The device is used near jam.
 - 33. The device is used near jam.
 - 34. The device is used near jam.
 - 35. The device is used near jam.
 - 36. The device is used near jam.
 - 37. The device is used near jam.
 - 38. The device is used near jam.
 - 39. The device is used near jam.
 - 40. The device is used near jam.
 - 41. The device is used near jam.
 - 42. The device is used near jam.
 - 43. The device is used near jam.
 - 44. The device is used near jam.
 - 45. The device is used near jam.
 - 46. The device is used near jam.
 - 47. The device is used near jam.
 - 48. The device is used near jam.
 - 49. The device is used near jam.
 - 50. The device is used near jam.
 - B. Caution**
 - Do not use the device with the following conditions:
 - 1. The device is used near children.
 - 2. The device is used near pets.
 - 3. The device is used near electrical outlets.
 - 4. The device is used near power lines.
 - 5. The device is used near fire.
 - 6. The device is used near smoke.
 - 7. The device is used near dust.
 - 8. The device is used near oil.
 - 9. The device is used near grease.
 - 10. The device is used near acid.
 - 11. The device is used near alkali.
 - 12. The device is used near salt.
 - 13. The device is used near sugar.
 - 14. The device is used near honey.
 - 15. The device is used near jam.
 - 16. The device is used near jam.
 - 17. The device is used near jam.
 - 18. The device is used near jam.
 - 19. The device is used near jam.
 - 20. The device is used near jam.
 - 21. The device is used near jam.
 - 22. The device is used near jam.
 - 23. The device is used near jam.
 - 24. The device is used near jam.
 - 25. The device is used near jam.
 - 26. The device is used near jam.
 - 27. The device is used near jam.
 - 28. The device is used near jam.
 - 29. The device is used near jam.
 - 30. The device is used near jam.
 - 31. The device is used near jam.
 - 32. The device is used near jam.
 - 33. The device is used near jam.
 - 34. The device is used near jam.
 - 35. The device is used near jam.
 - 36. The device is used near jam.
 - 37. The device is used near jam.
 - 38. The device is used near jam.
 - 39. The device is used near jam.
 - 40. The device is used near jam.
 - 41. The device is used near jam.
 - 42. The device is used near jam.
 - 43. The device is used near jam.
 - 44. The device is used near jam.
 - 45. The device is used near jam.
 - 46. The device is used near jam.
 - 47. The device is used near jam.
 - 48. The device is used near jam.
 - 49. The device is used near jam.
 - 50. The device is used near jam.

3. Name of Each Parts

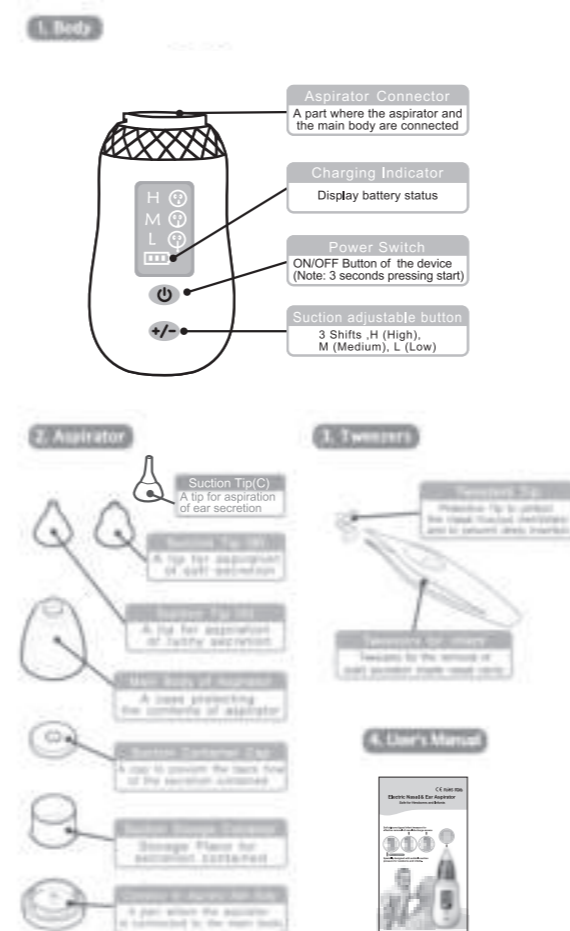

4. Preparation prior to use

1. Please check the following before carefully taking the product out of the box.
 - Please check thoroughly for any damage to the product.
 - Please check if there is any missing part.
 - Please contact the place of purchase or sales agency if any damages or missing parts are discovered.
2. Charge the appliance fully before you use it for the first time.
 - To charge the appliance, insert the samII plug into the socket on the back of the appliance, and connect the other end of the USB cable to the power adapter.(Charging head is not included)
 - The appliance is charging when the battery condition is moving. Charging takes up to 3 hours.
 - The appliance is fully charged when the charging indicator light stopped twinkling, operating time is up to 60 minutes.

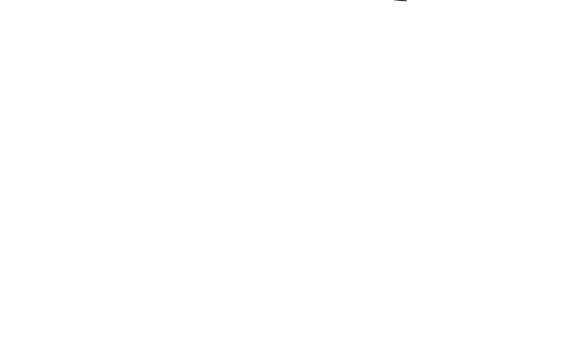
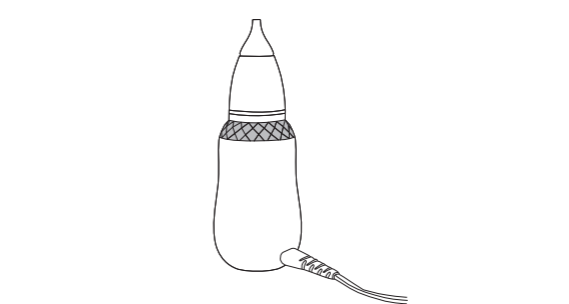

5. How to Use

1. How to assemble the aspirator:
 - (1) Place the suction container cap upon the suction container.
 - (2) Put the suction container into the connector on the main body of the aspirator. Turn to the direction of the arrow.
 - (3) Put and twist the aspirator main body for a firm fixation.
 - (4) Put the suction tip into the main body of the aspirator.
 2. Put aspirator into the main body.
 - Place a fully assembled aspirator into the connector on the main body of aspirator with the groove aligned.
 - Turn to the direction of the arrow.
- Please select suction tip is appropriate for the size and shape of child's nose. At the same time, congestion condition of the child should also be considered.
 - Suction Tip (A): A tip for aspiration of runny secretion.
 - Suction Tip (B): A tip for aspiration of soft secretion.
 - Suction Tip (C): A tip for aspiration of ear secretion.

