

# manduca®

my baby carrier /  
mon porte-bébé

# first

EN Instructions for use

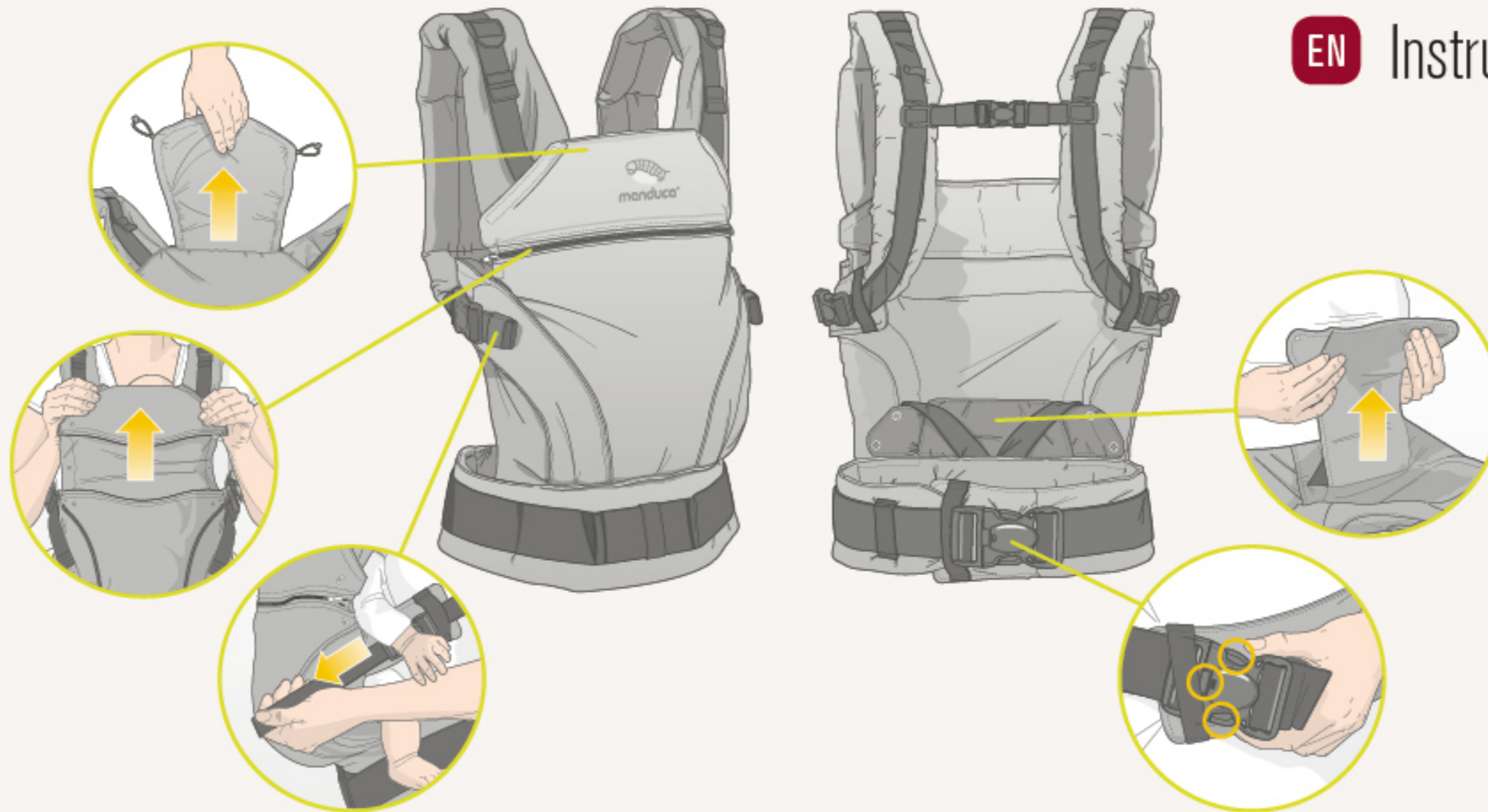

# IMPORTANT! KEEP FOR FUTURE REFERENCE

Please read these instructions carefully before using the sling for the first time!

## WARNING

**WARNING** Constantly monitor your child and ensure the mouth and nose are unobstructed.

**WARNING** For pre-term, low birthweight babies and children with medical conditions, seek advice from a health professional before using this product.

**WARNING** Ensure your child's chin is not resting on its chest as its breathing may be restricted which could lead to suffocation.

**WARNING** To prevent hazards from falling ensure that your child is securely positioned in the sling.

Be aware of hazards in the domestic environment e.g. heat sources, spilling of hot drinks.

Only use the sling for one child.

The sling has been designed such that your child should always be looking in your direction.

Your movement and the child's movement may affect your balance.

Take care when bending and leaning forward or sideways.

The sling is not suitable for use during sporting activities e.g. running, cycling, swimming and skiing.

Please be aware of the increased risk of your child falling out of the sling as it becomes more active.

## STORAGE AND CARE

Keep the sling away from children when it is not in use.

Inspect the sling regularly for any signs of wear and damage.

Please fasten all buckles before washing and during storage.

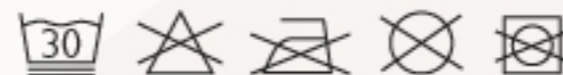

Use mild detergent.

# manduca<sup>®</sup> my baby carrier / mon porte-bébé first



4

Headrest



5

The first steps



8

Infant seat



10

Front position



18

Hip carry



22

Back position

# Headrest





## The first steps

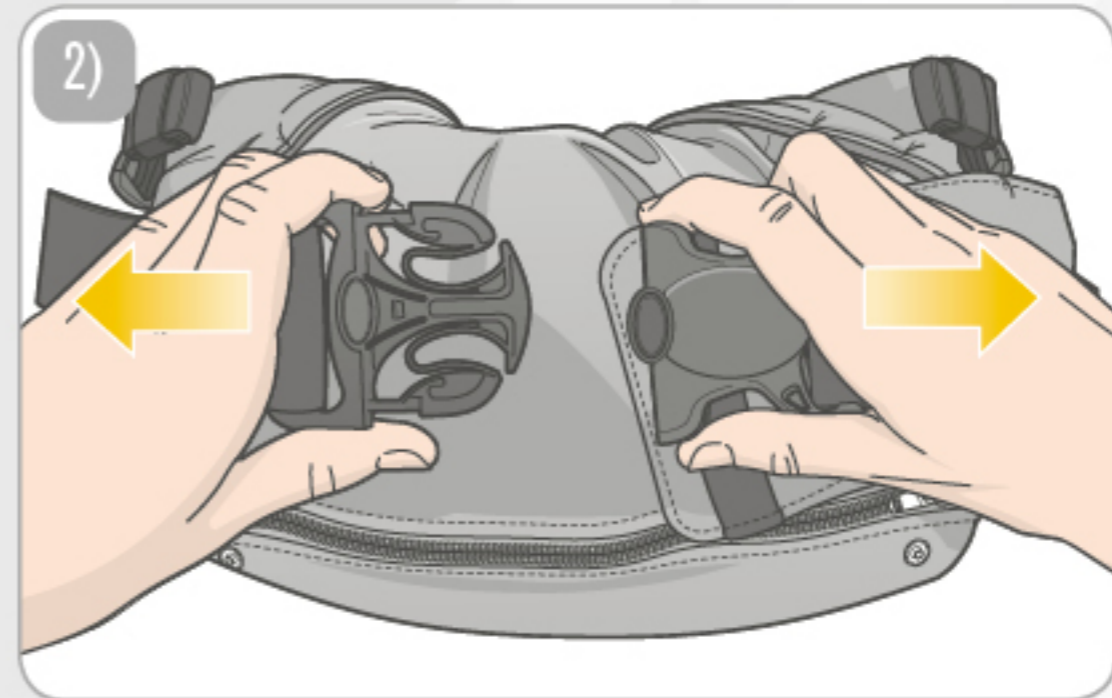
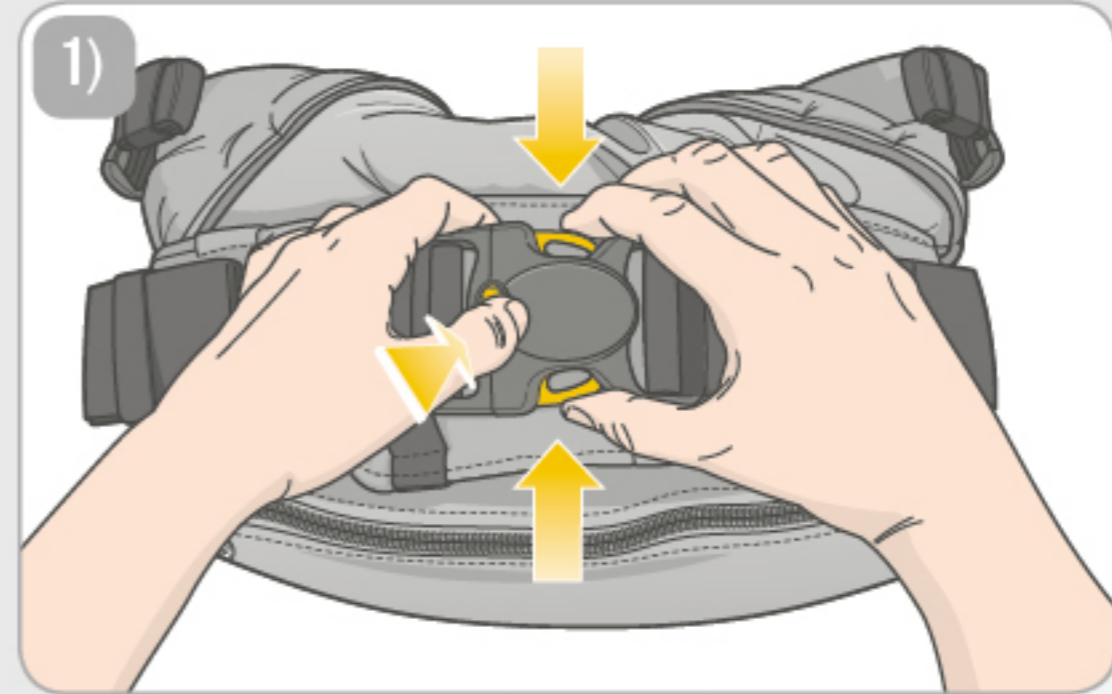
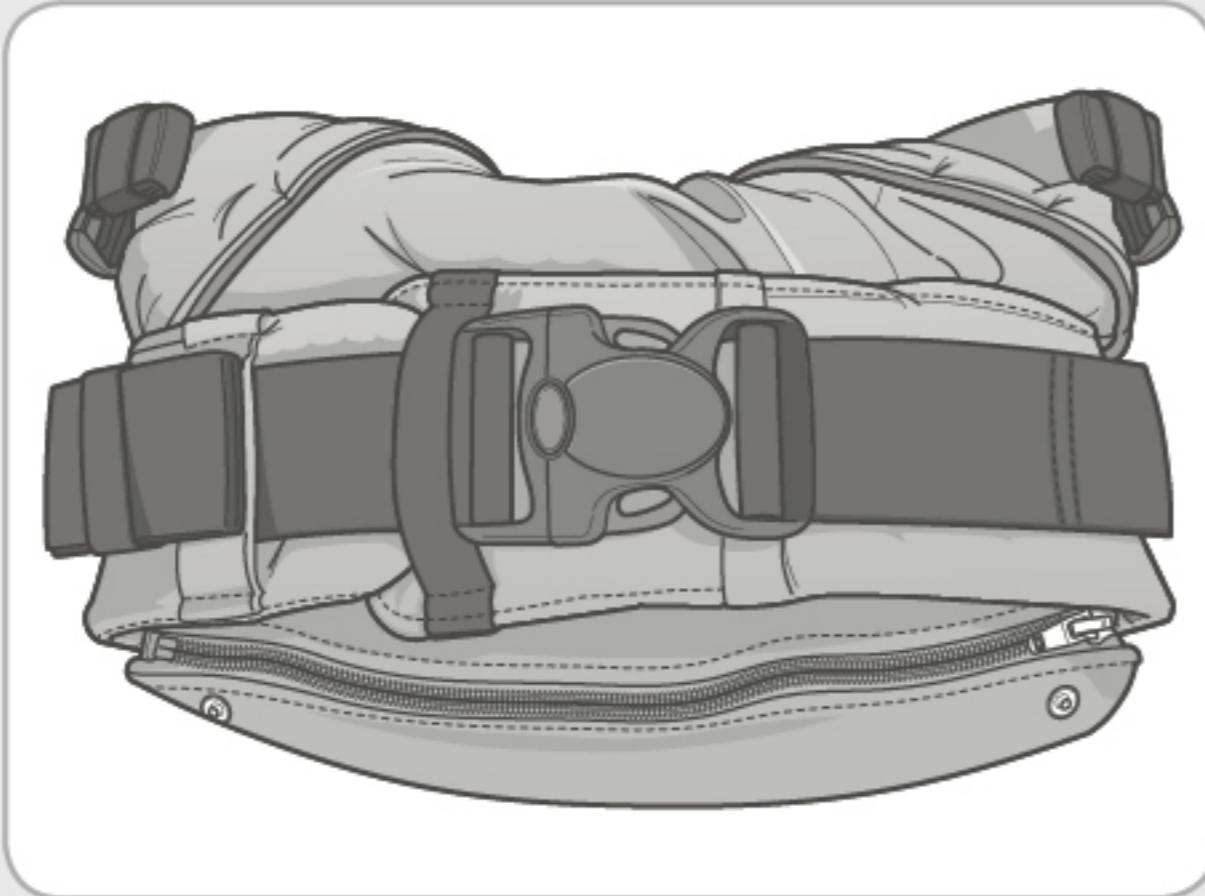

3)

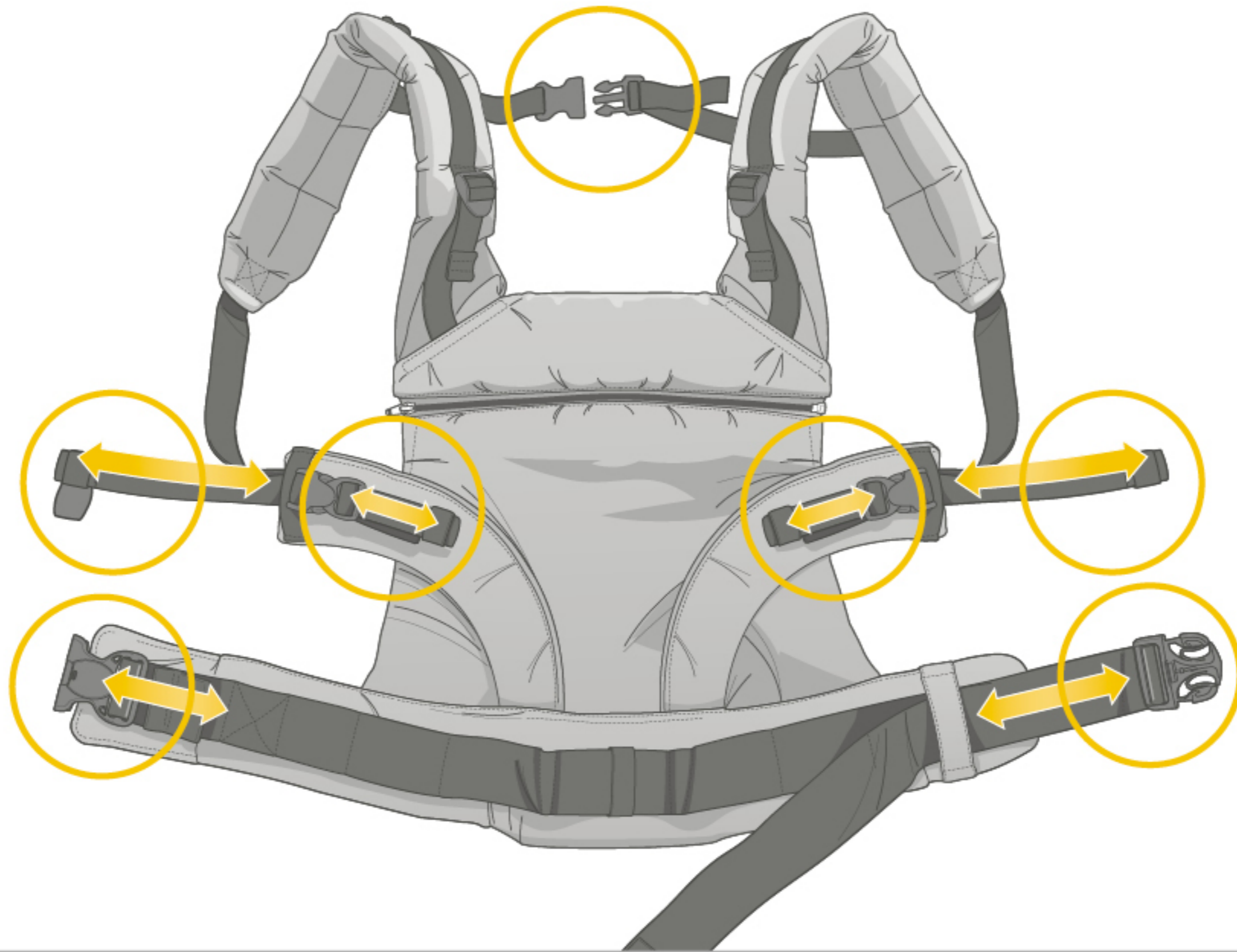

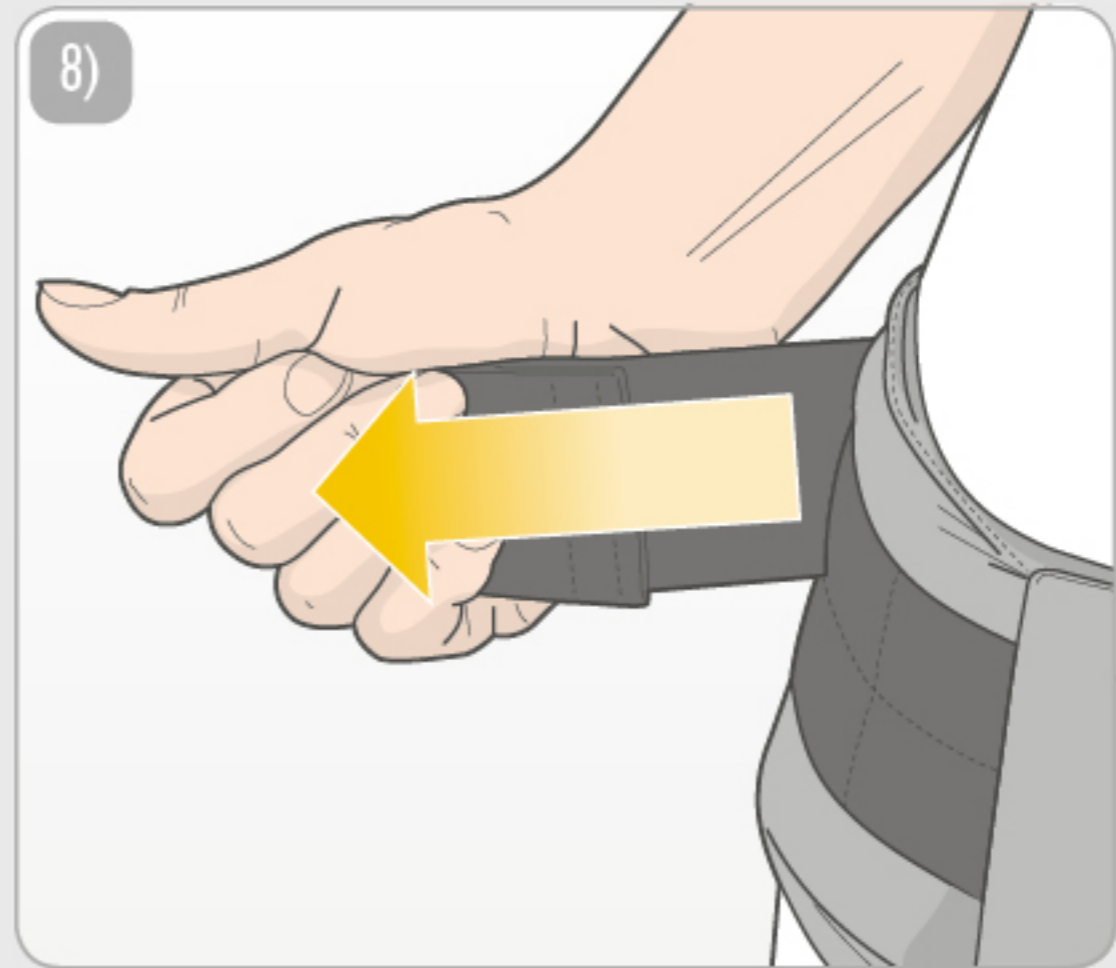
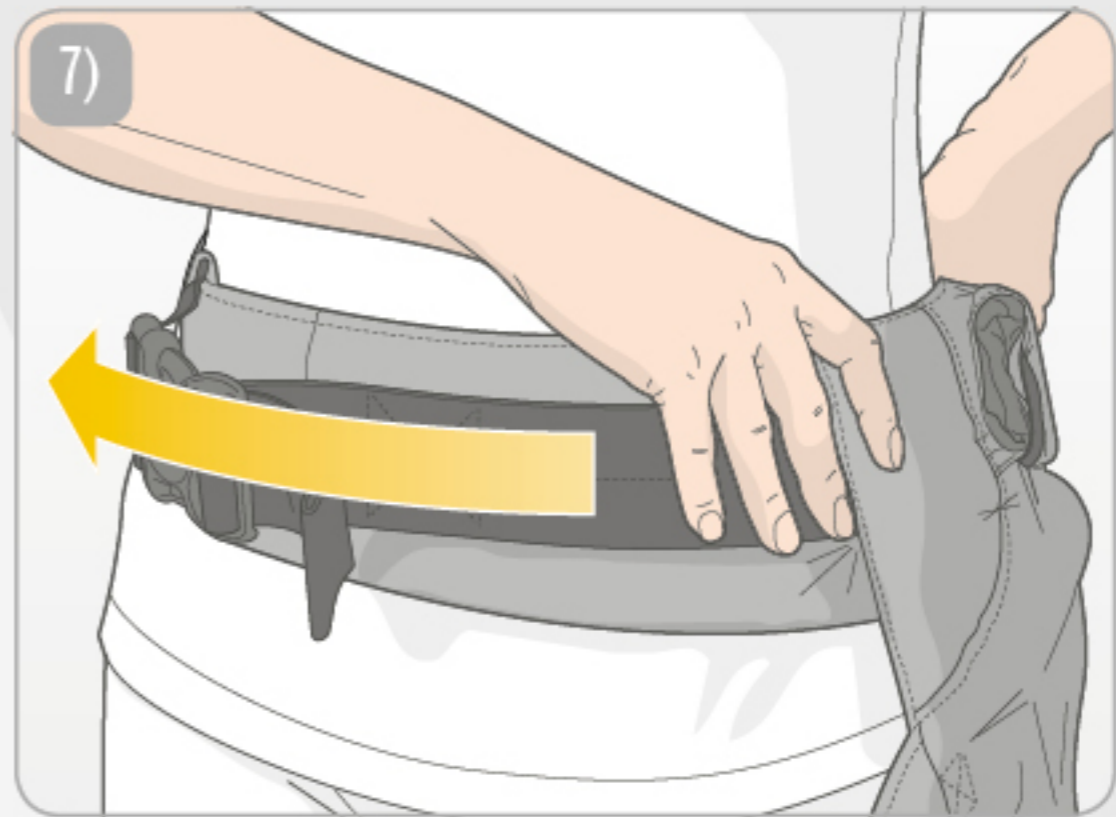
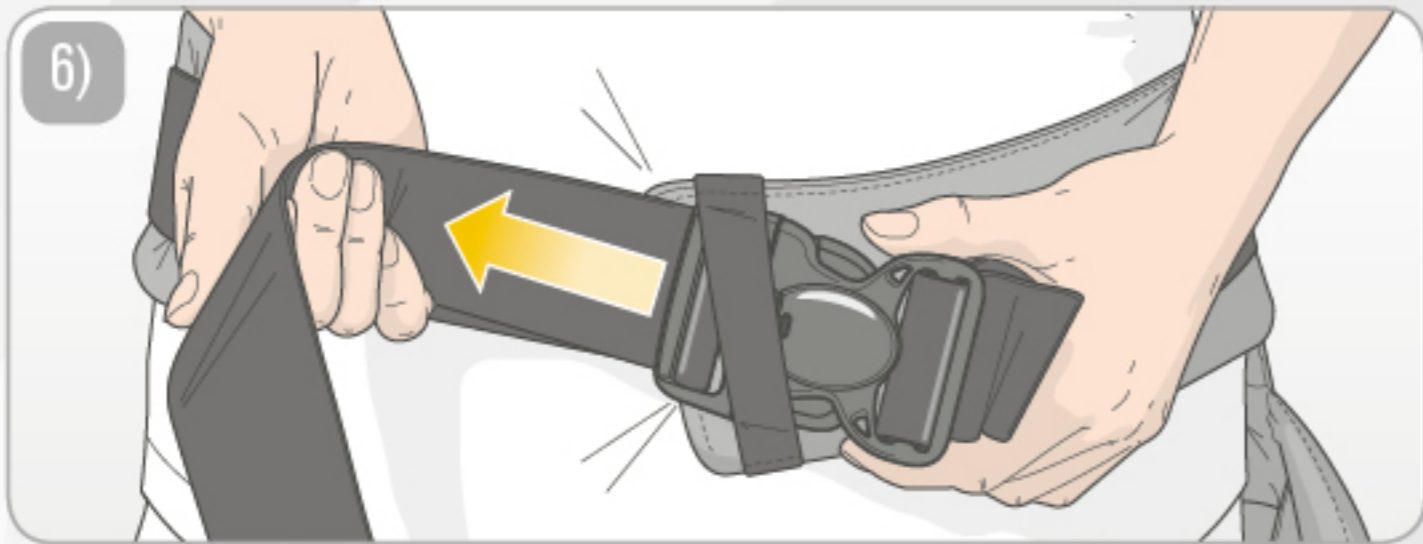
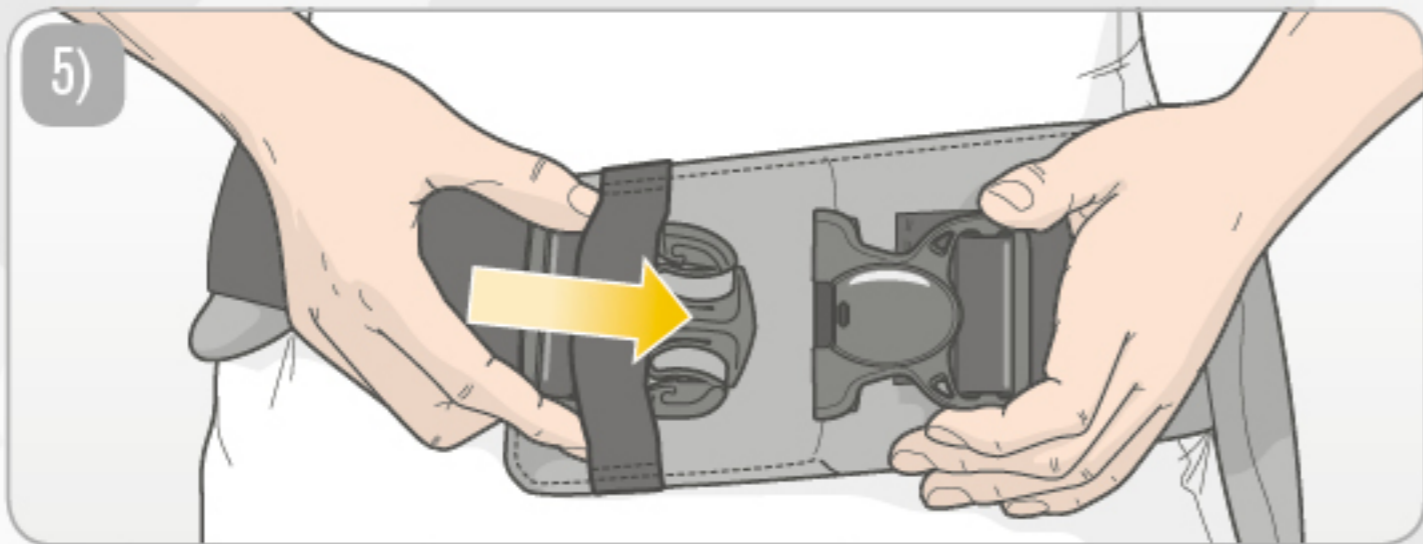
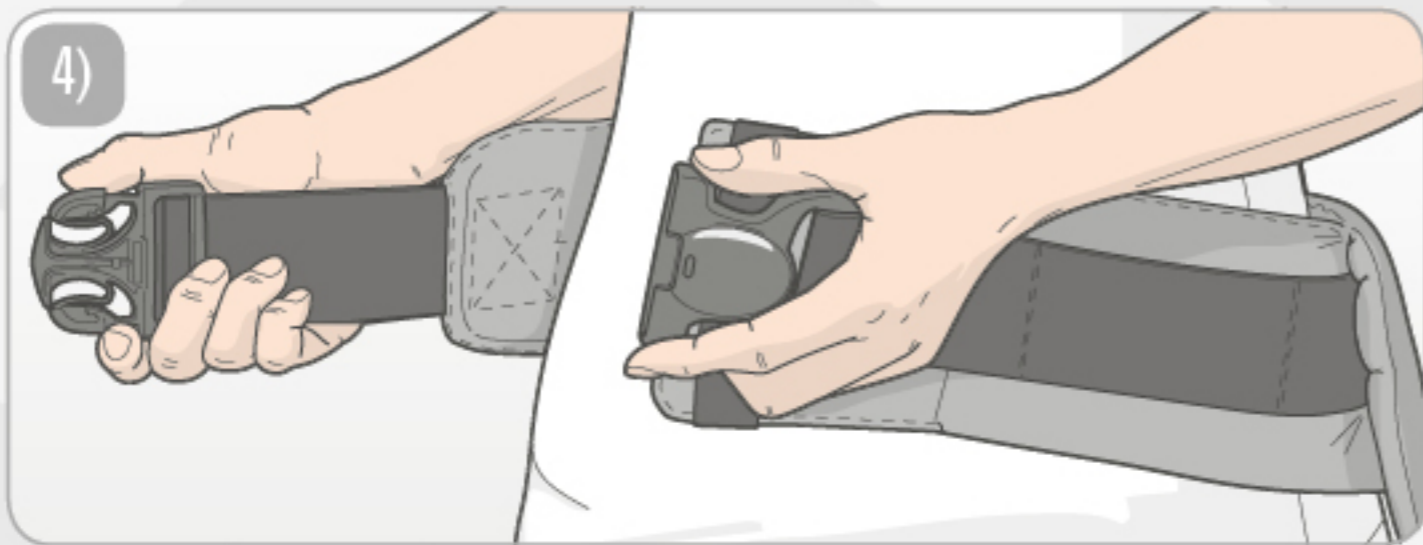



<3 mo.



# Infant seat





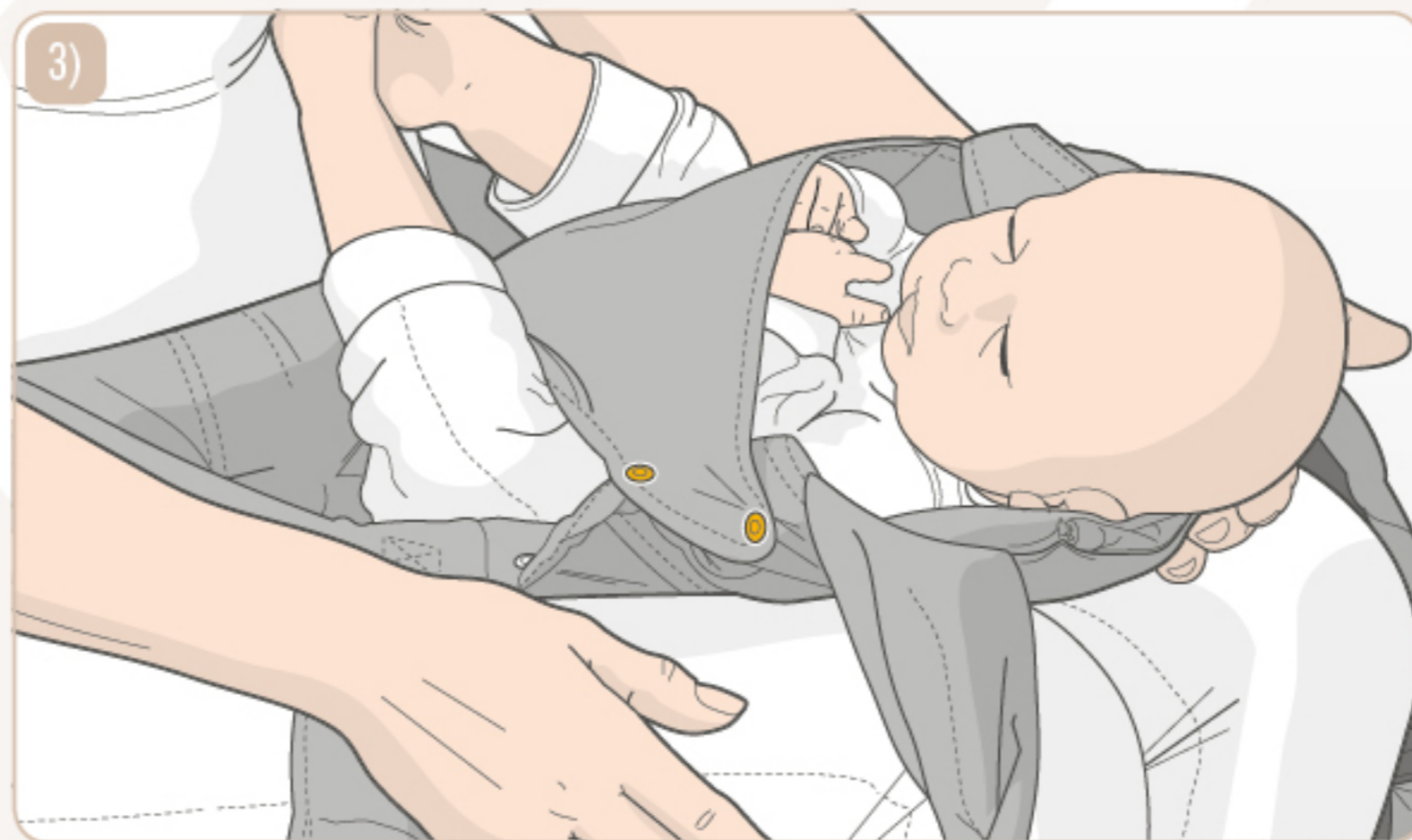
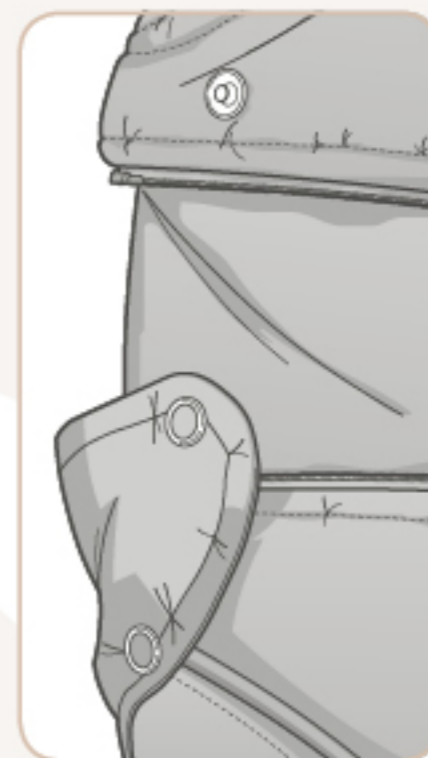
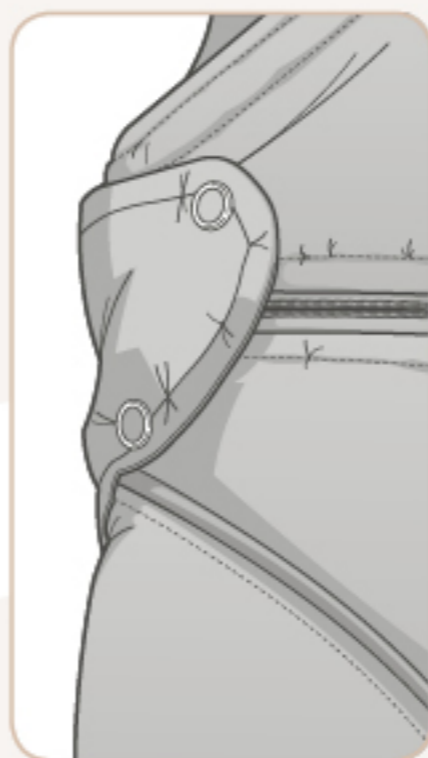
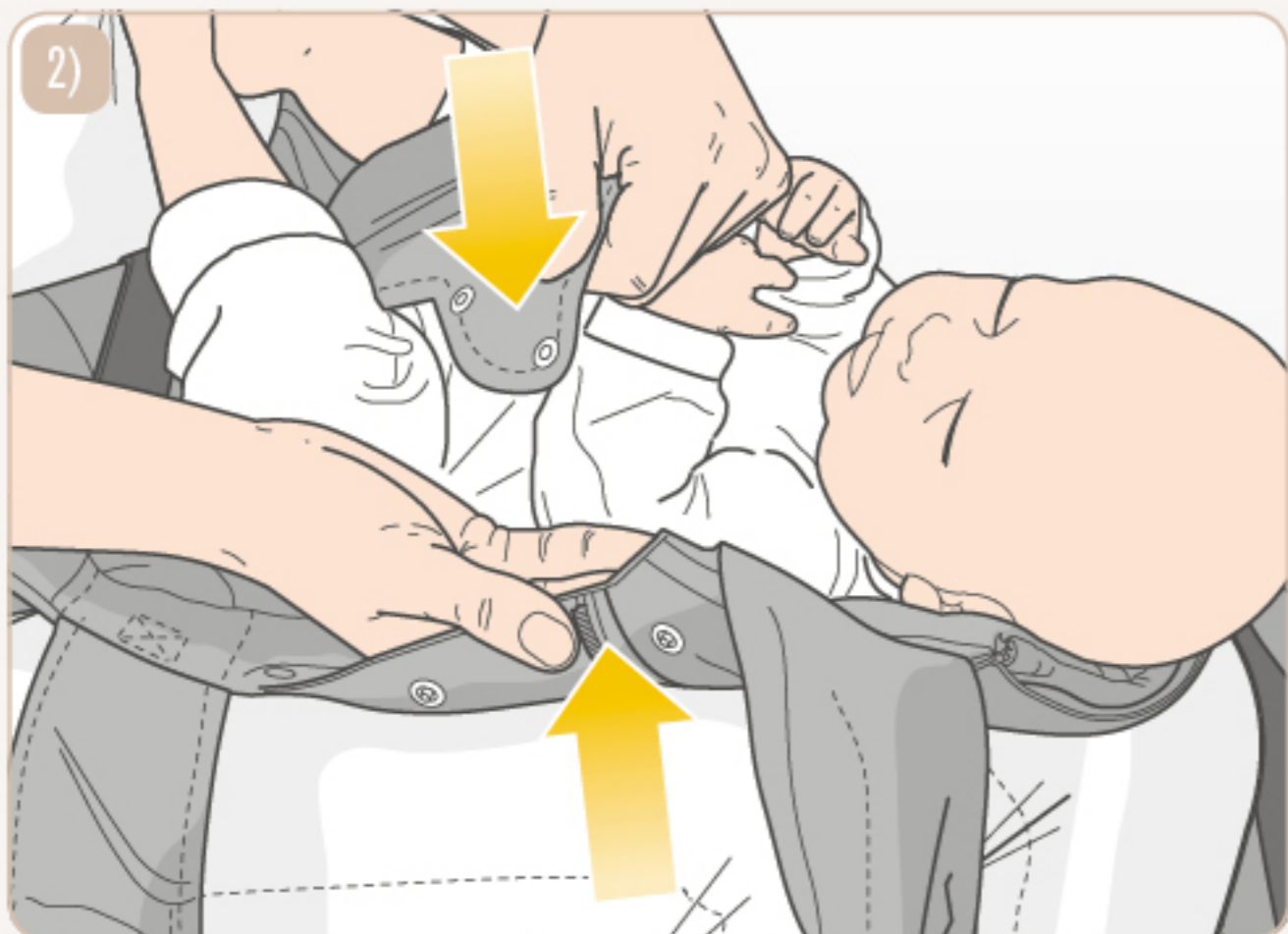



## Front position





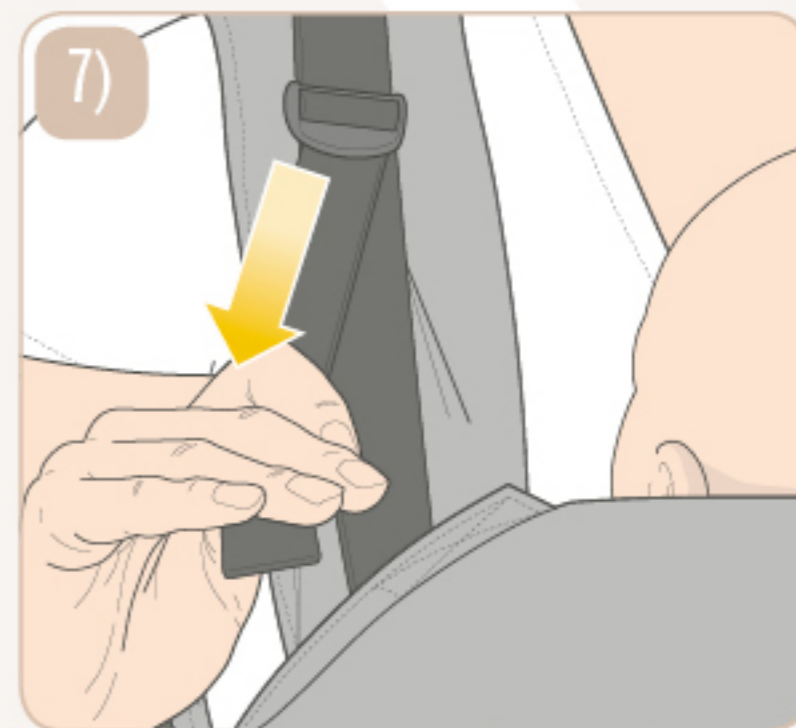
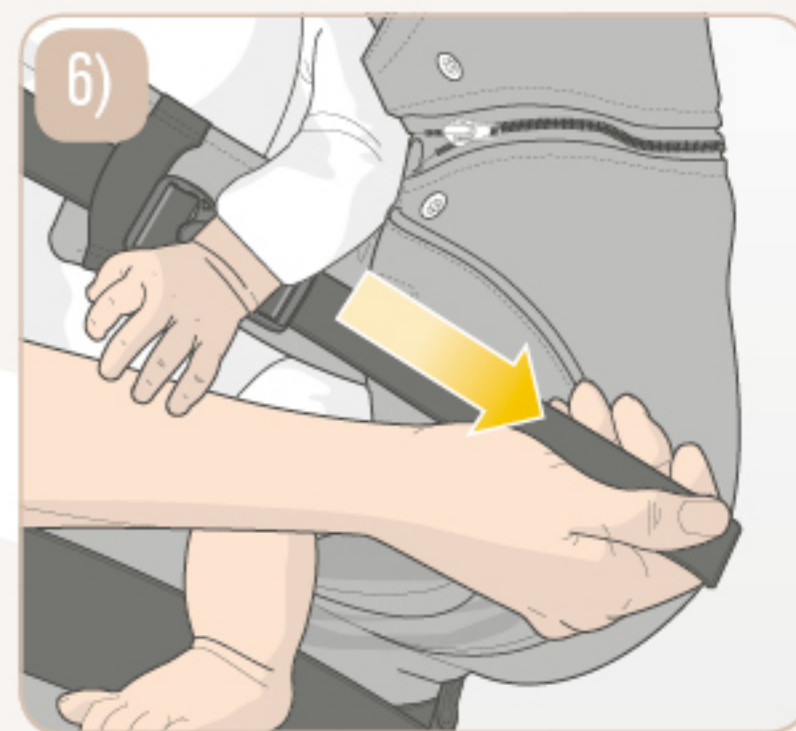
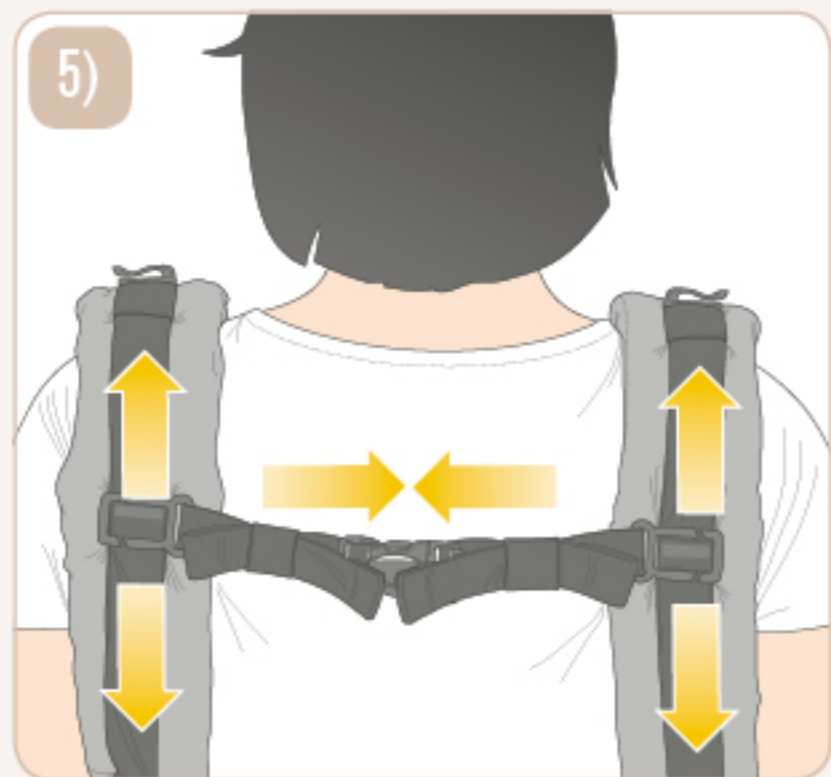

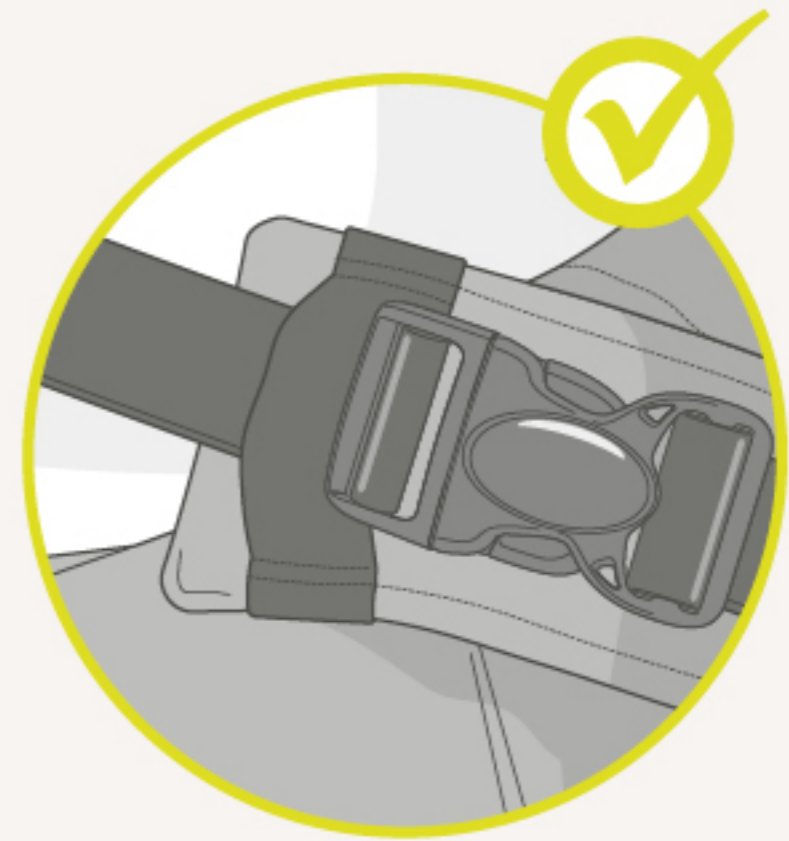
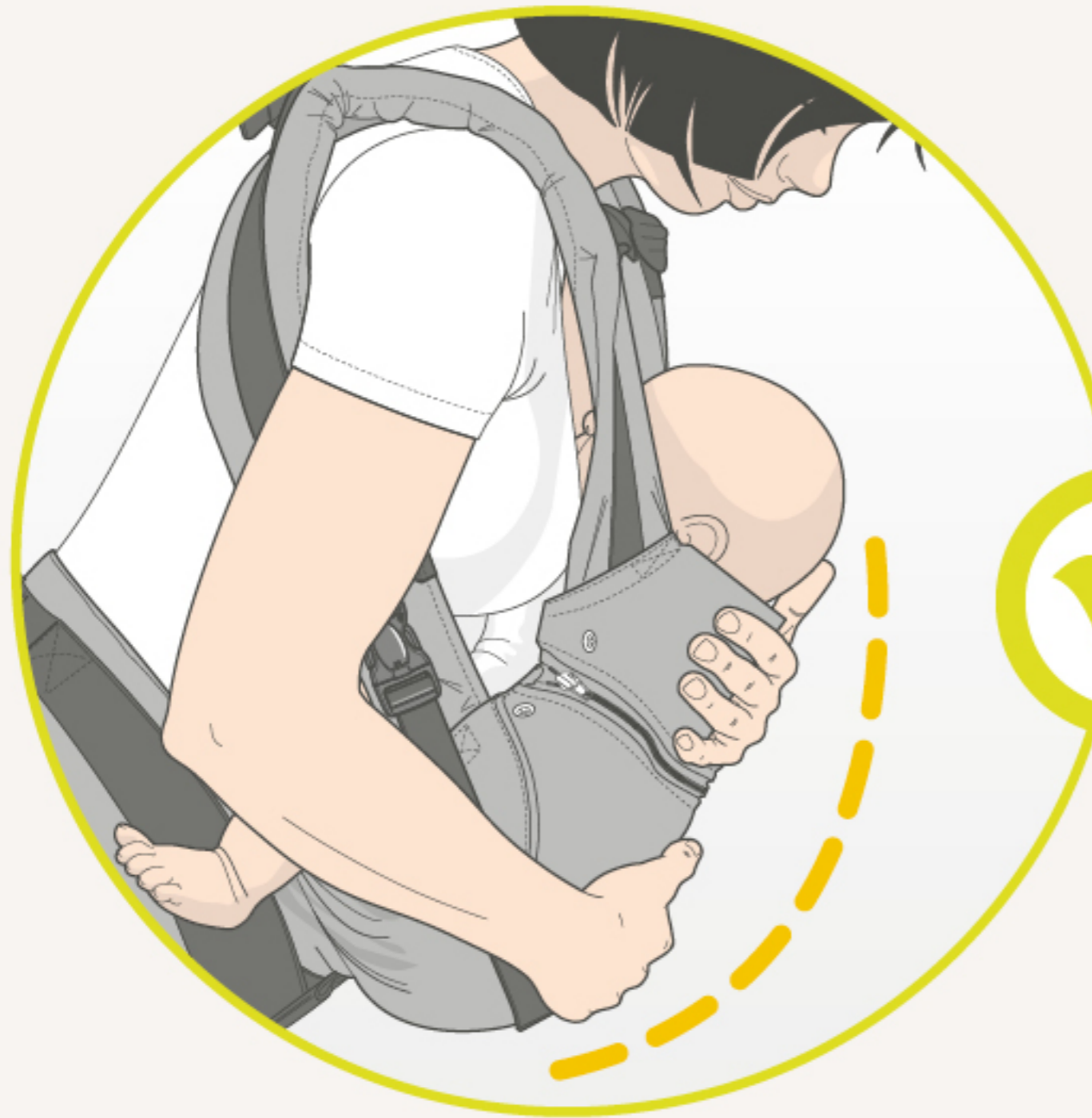



## Front position

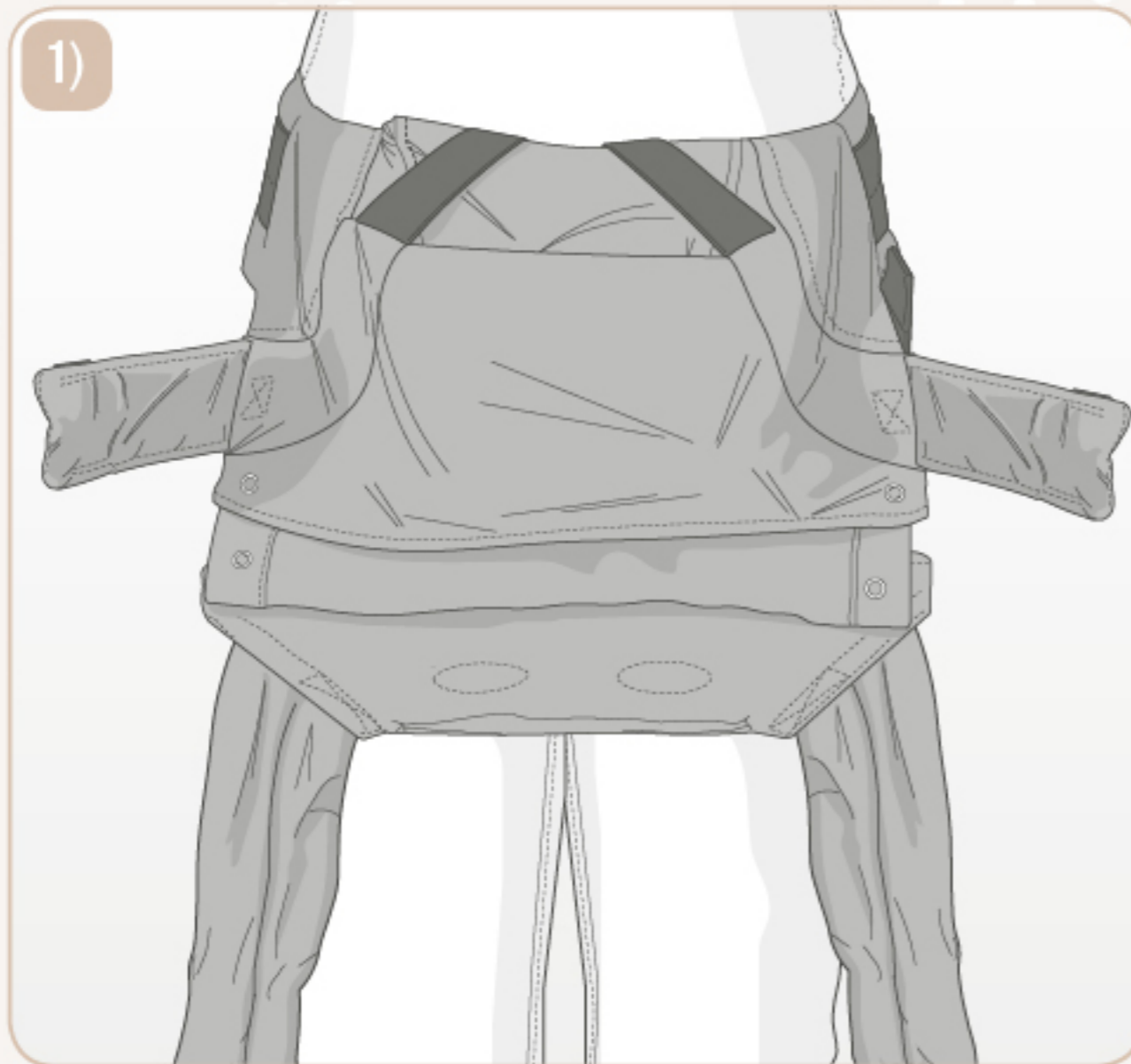

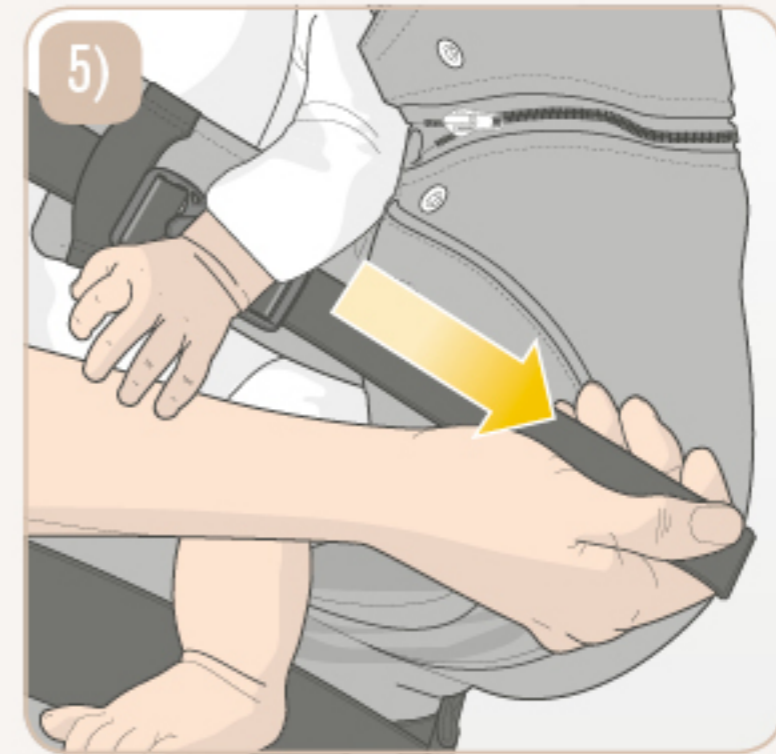
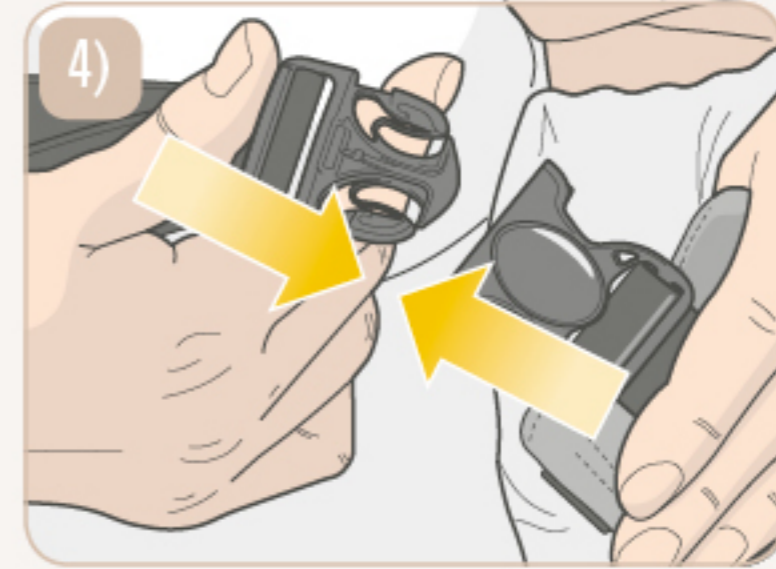
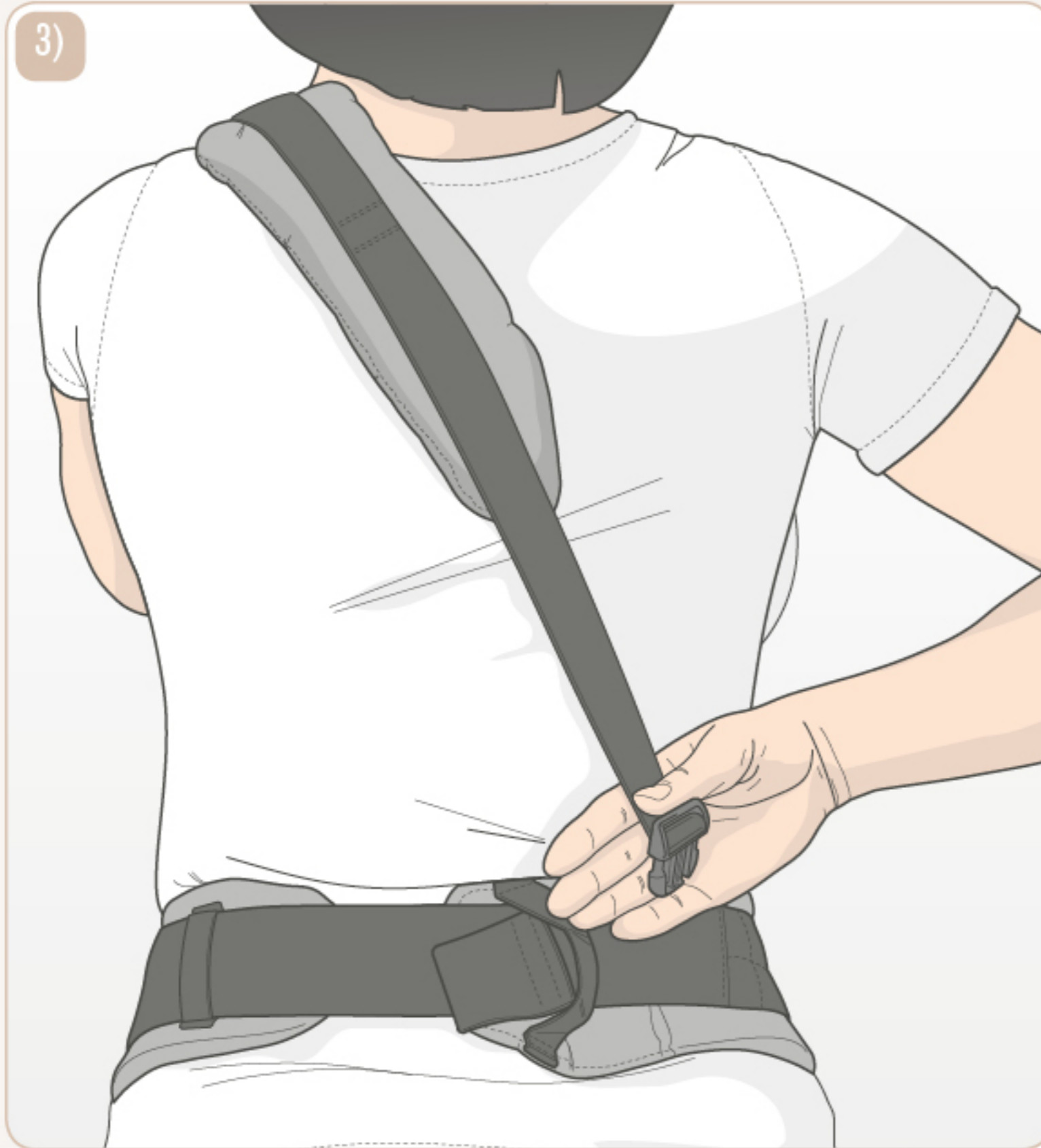

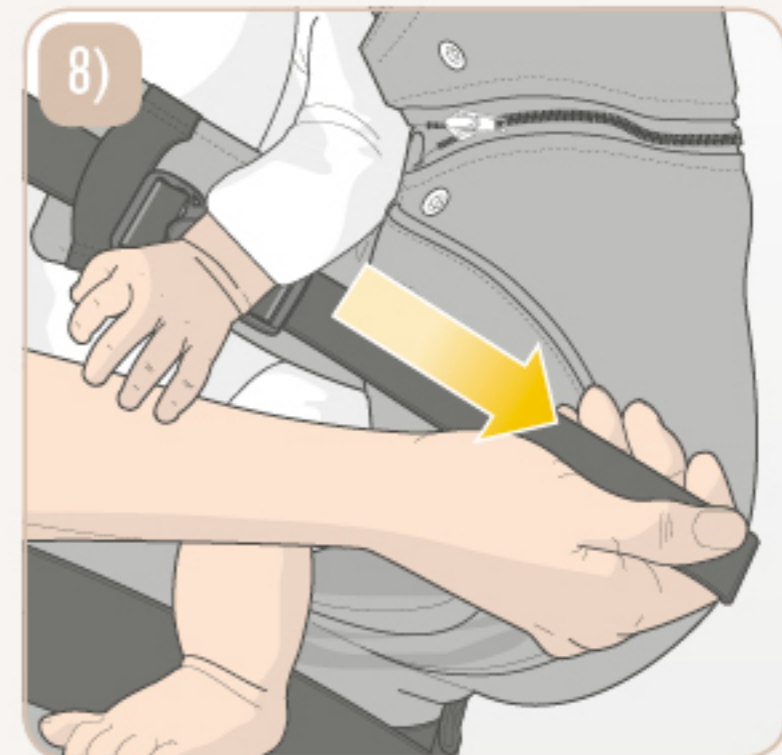
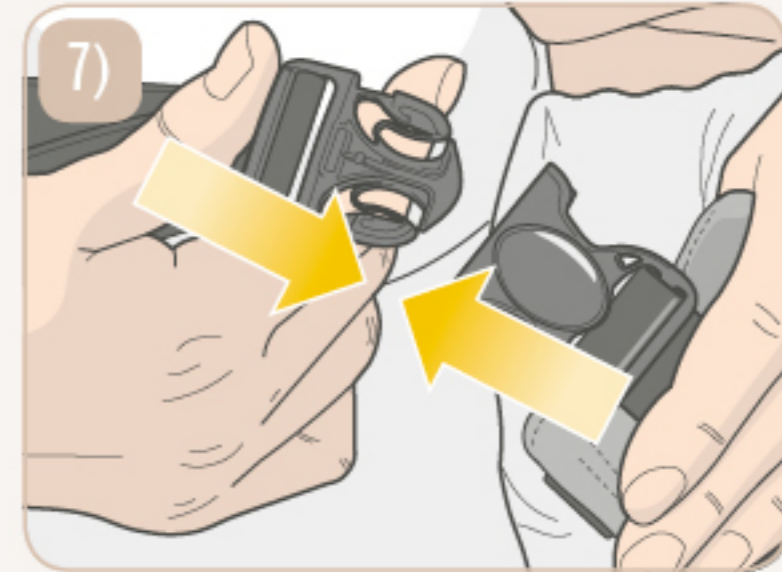
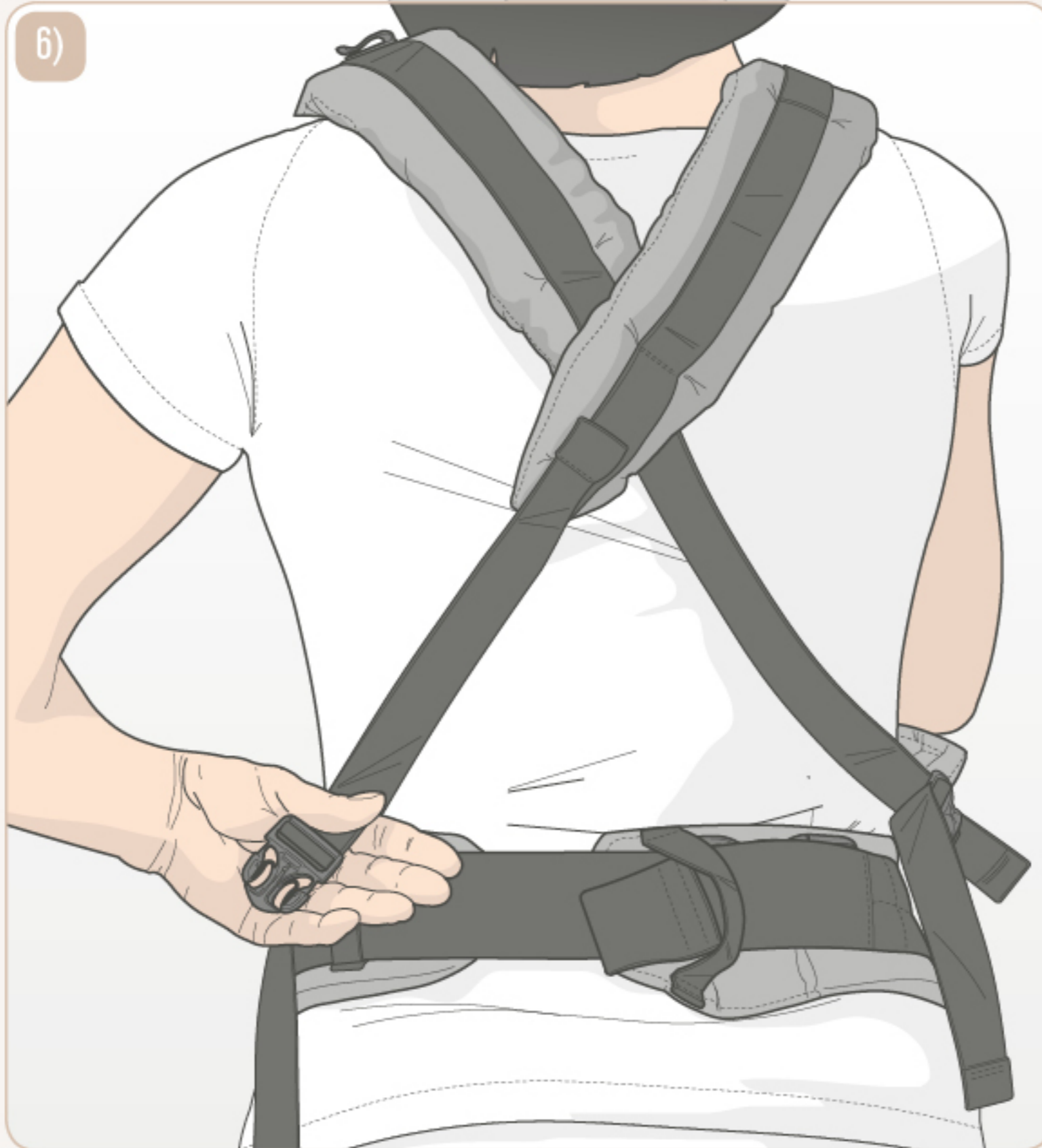



# manduca®

my baby carrier /  
mon porte-bébé

# first

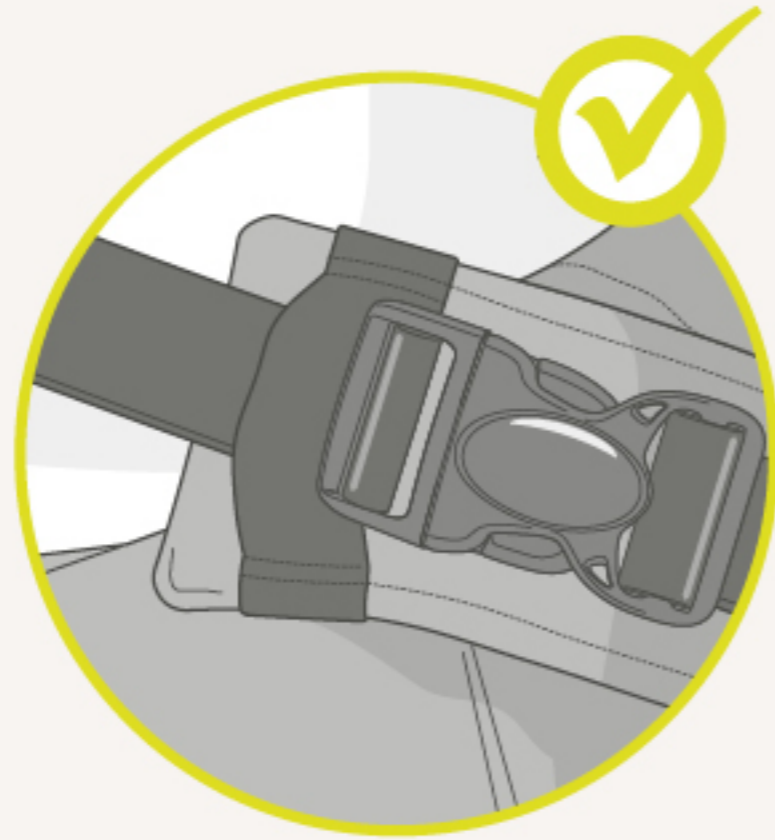



>3 mo. Hip carry

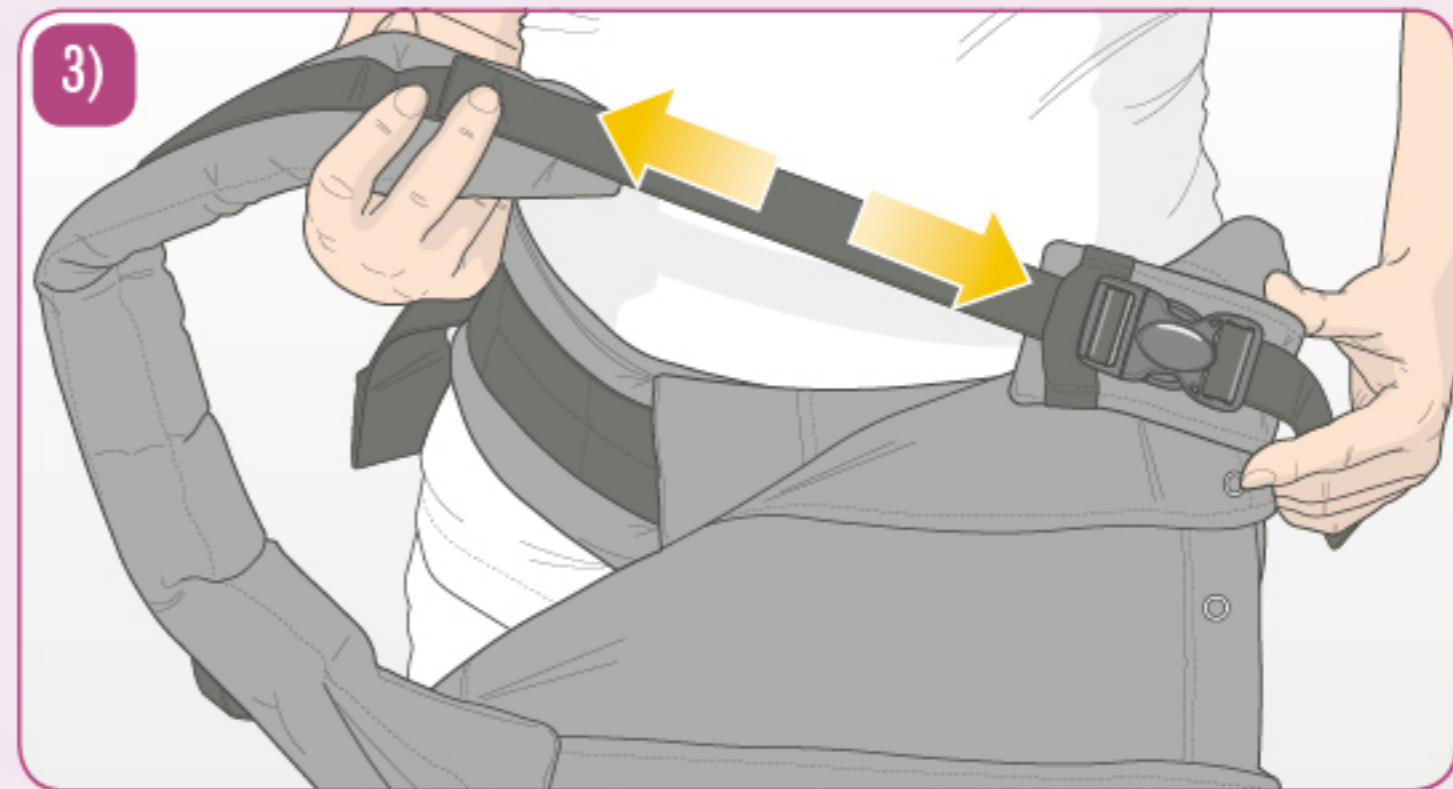
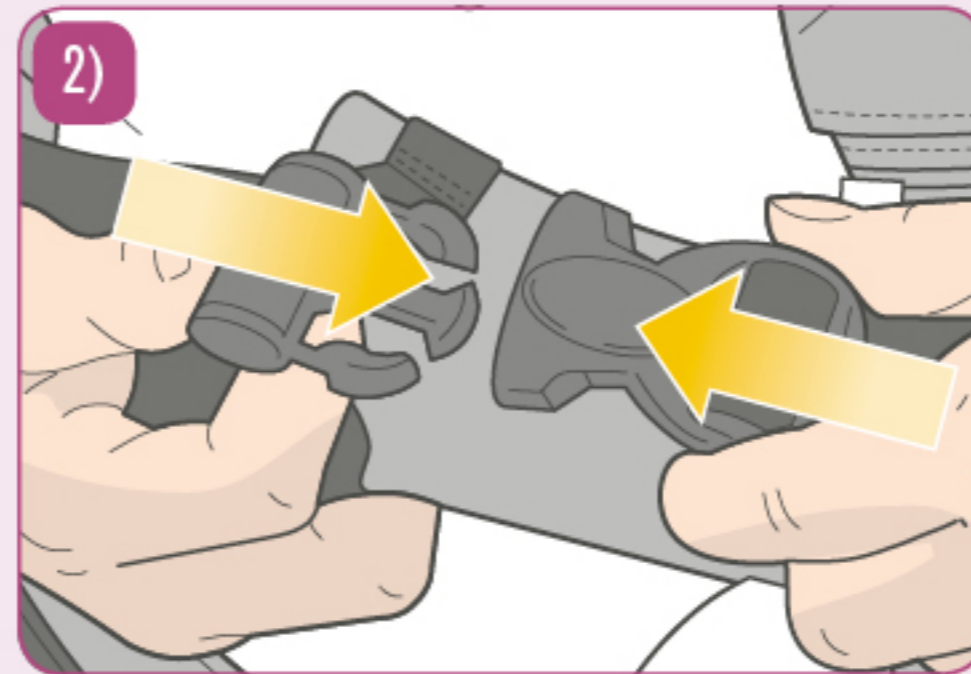
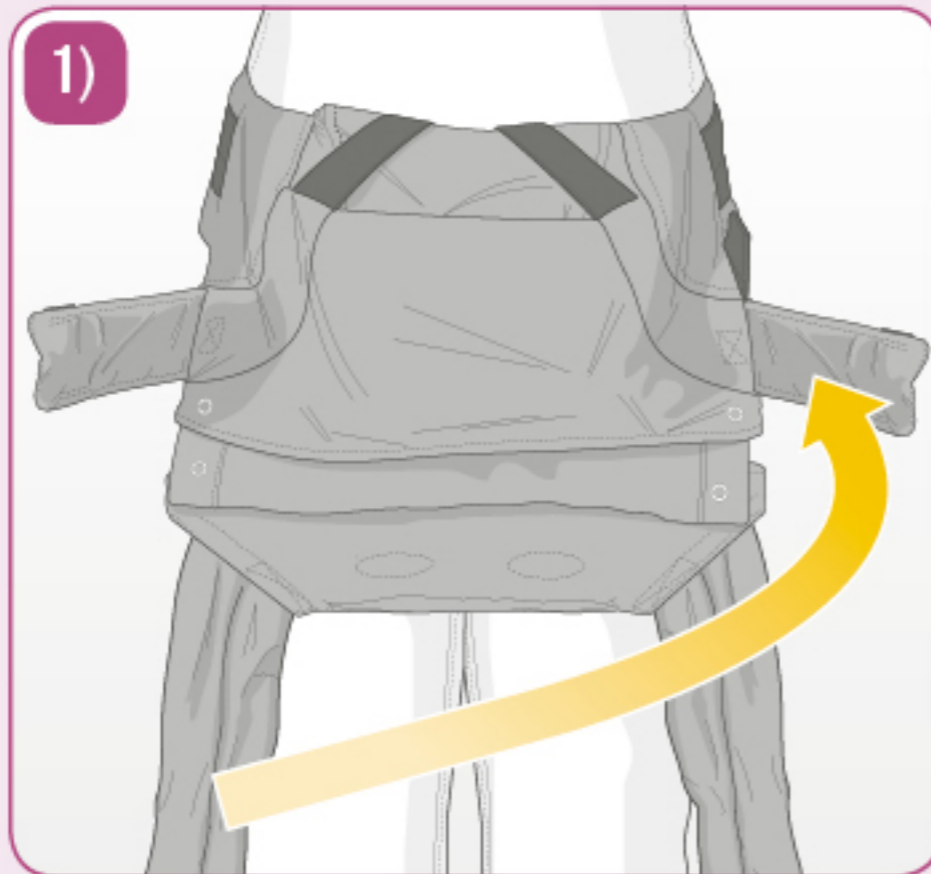

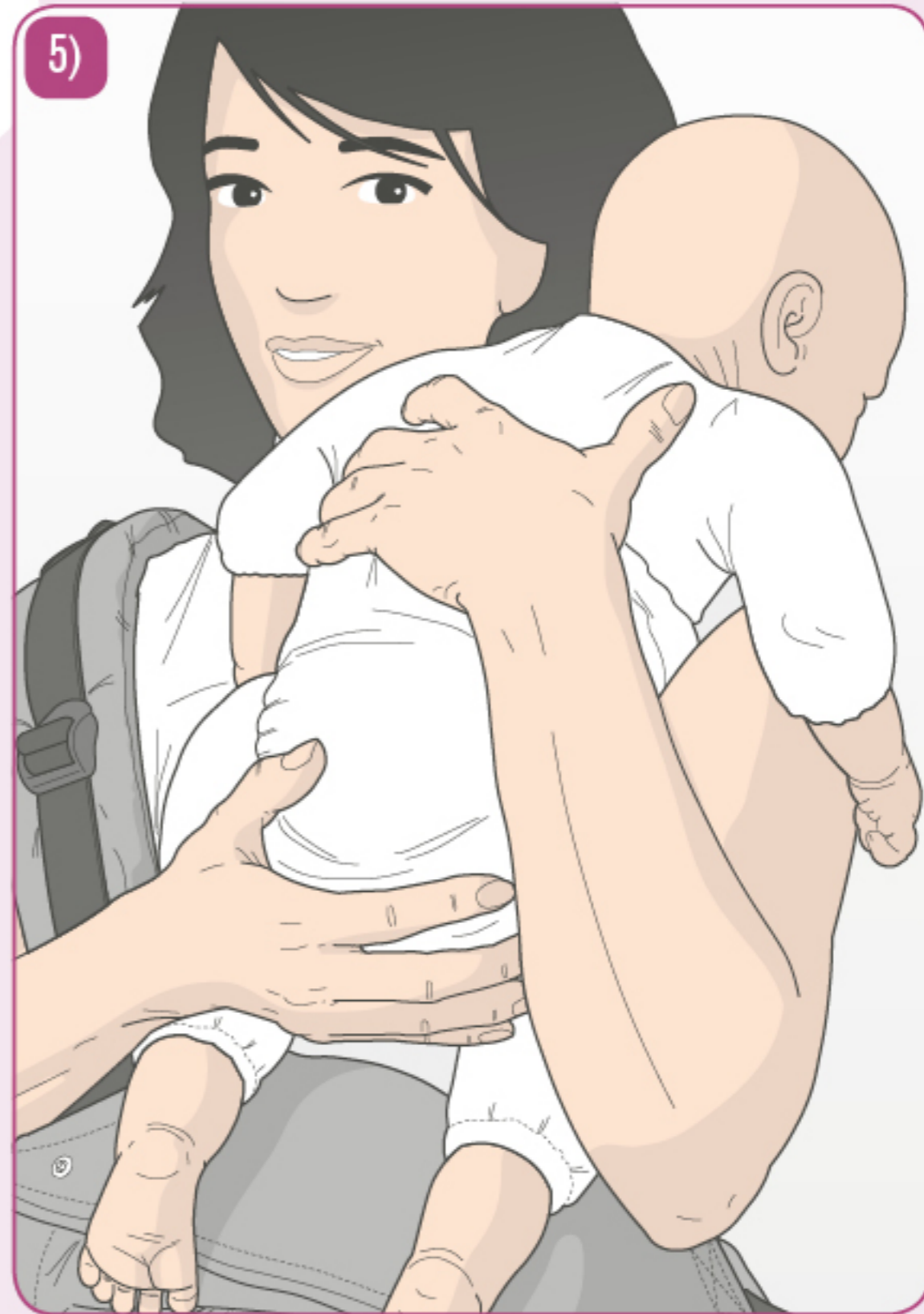

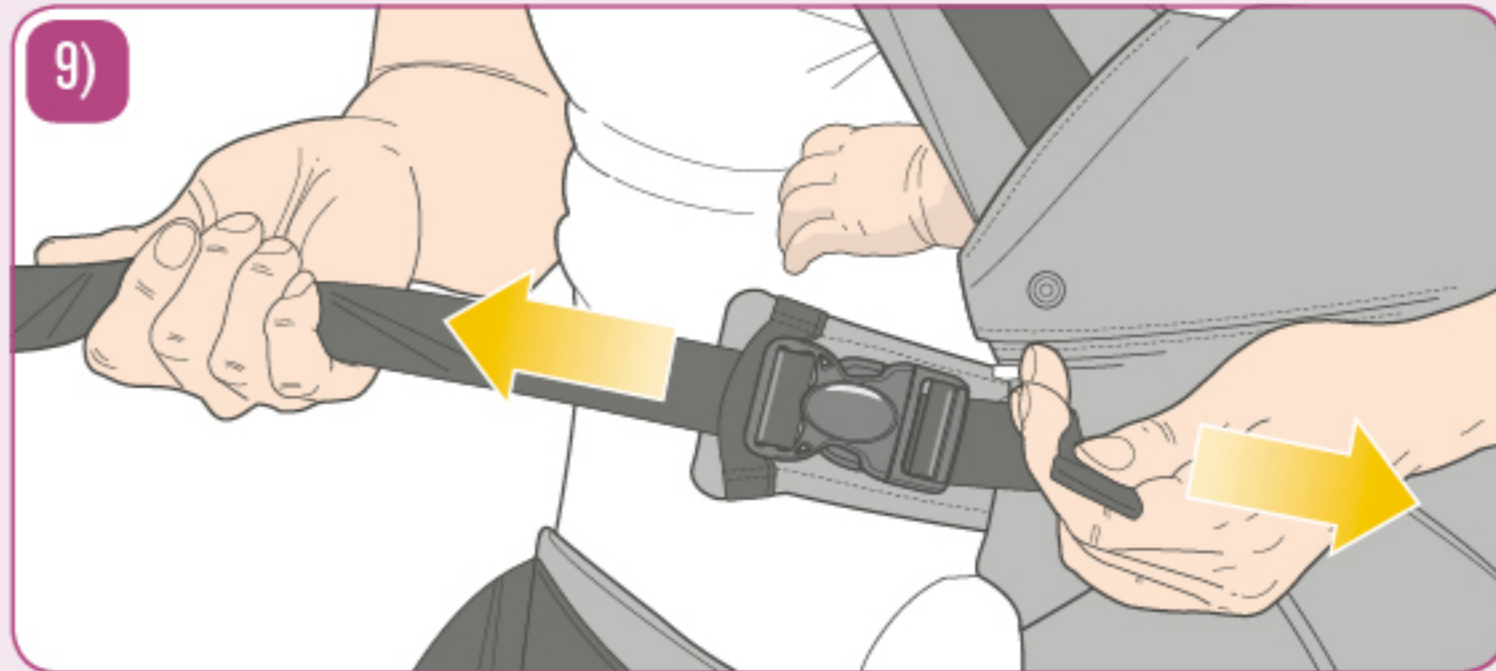
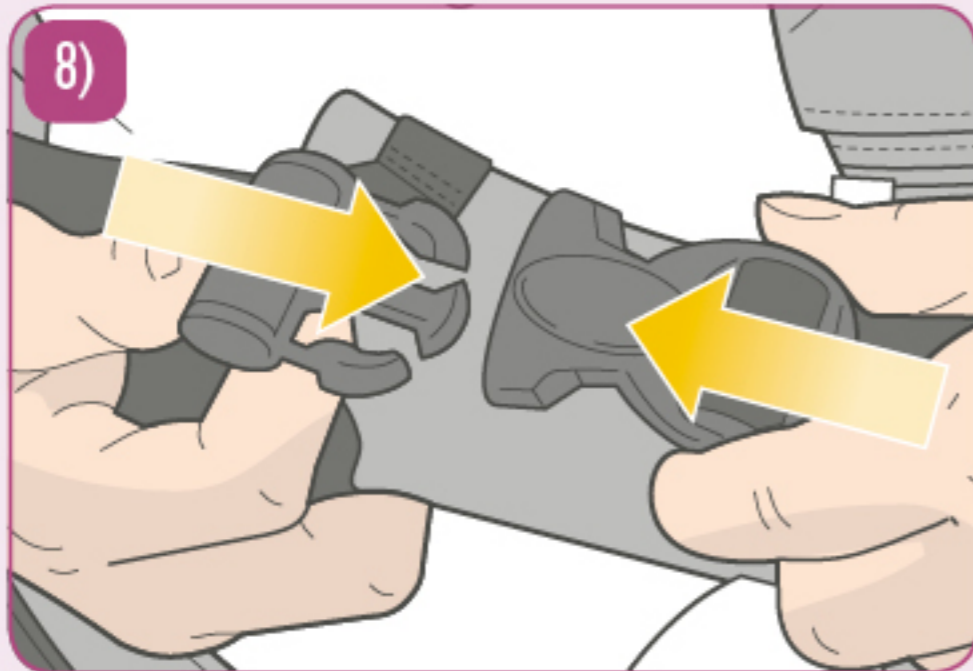
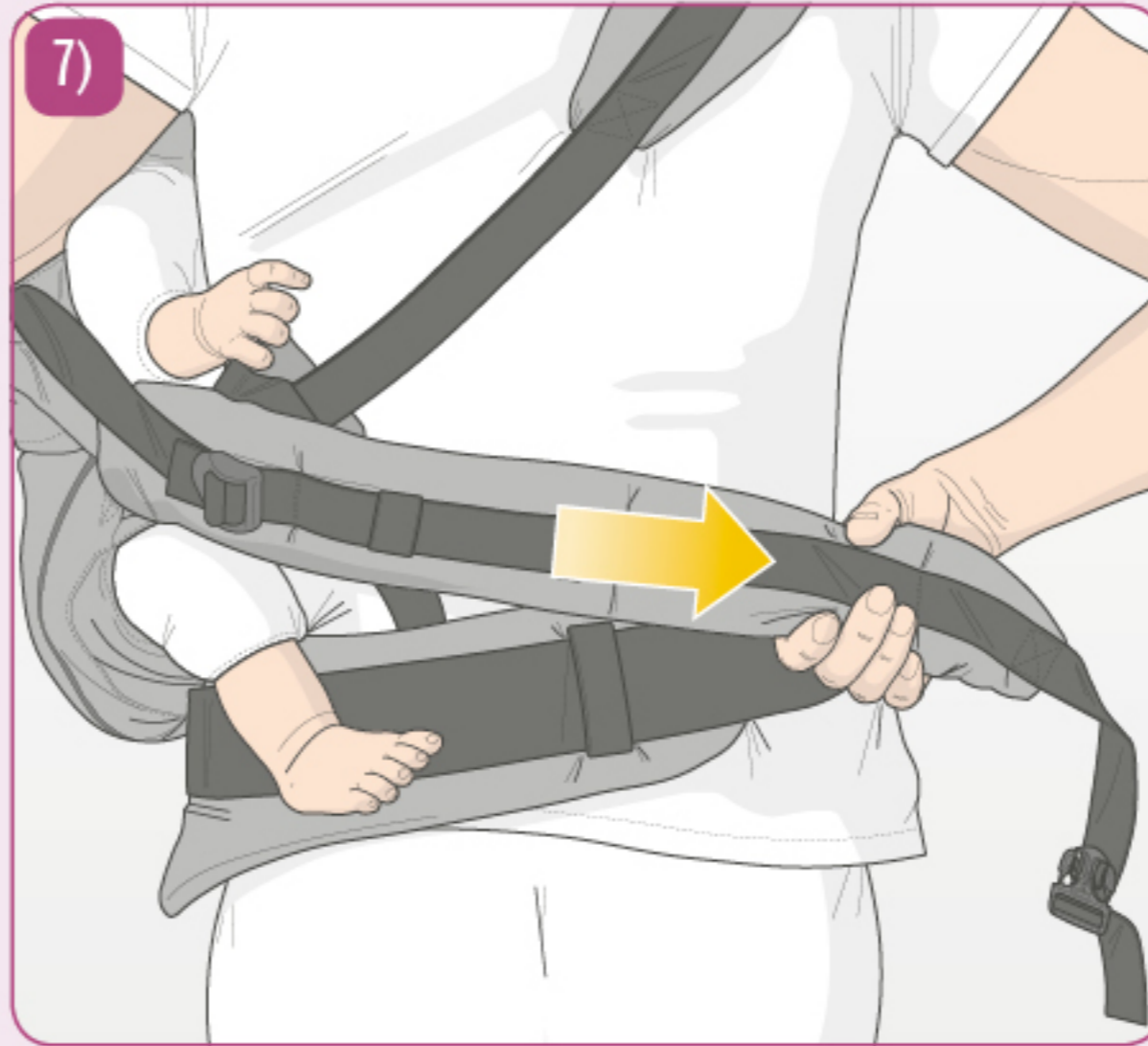

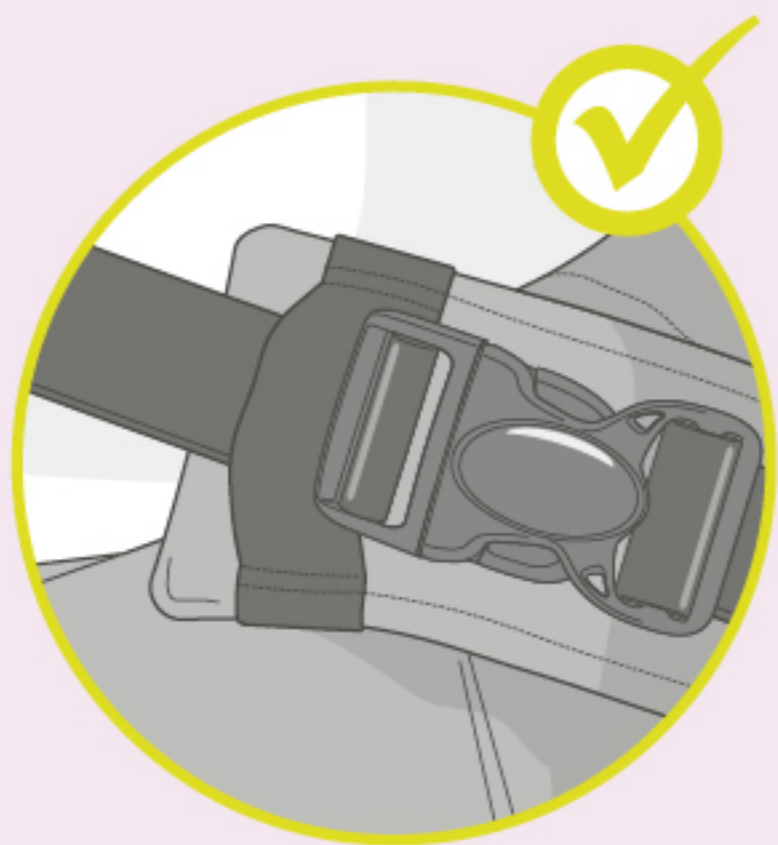



>3 mo. Back position

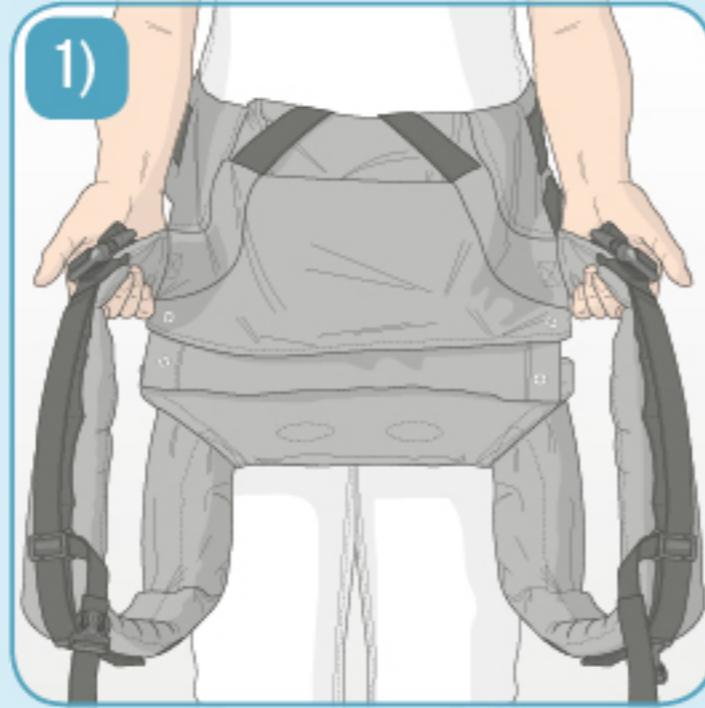

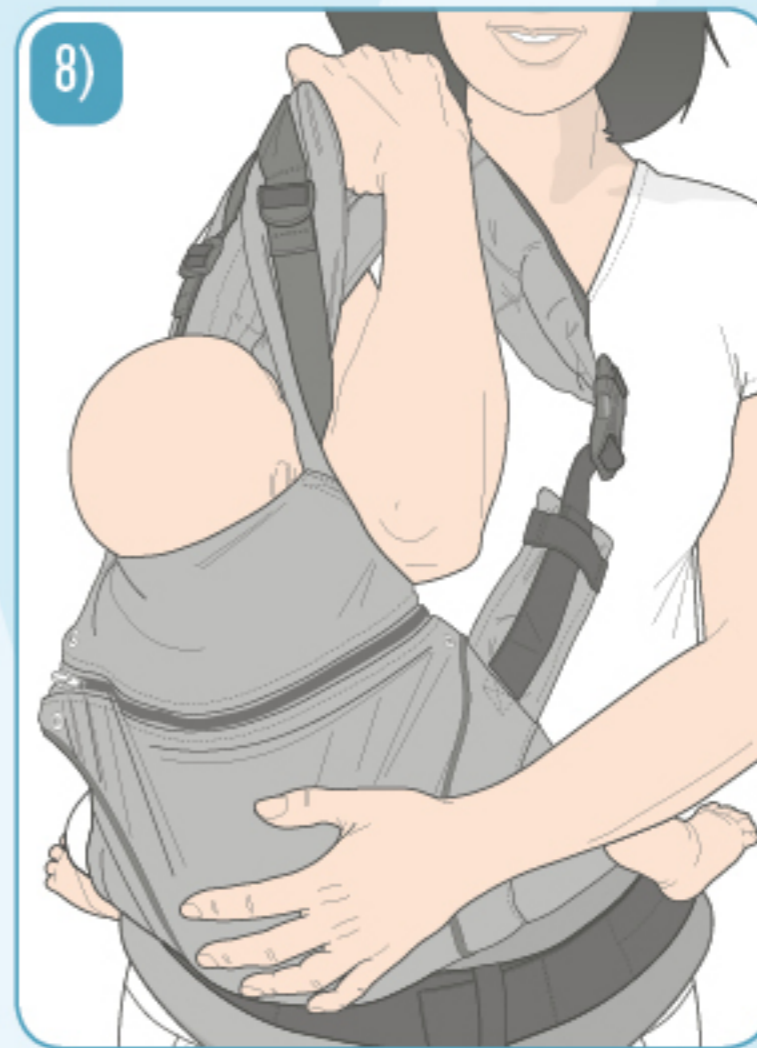
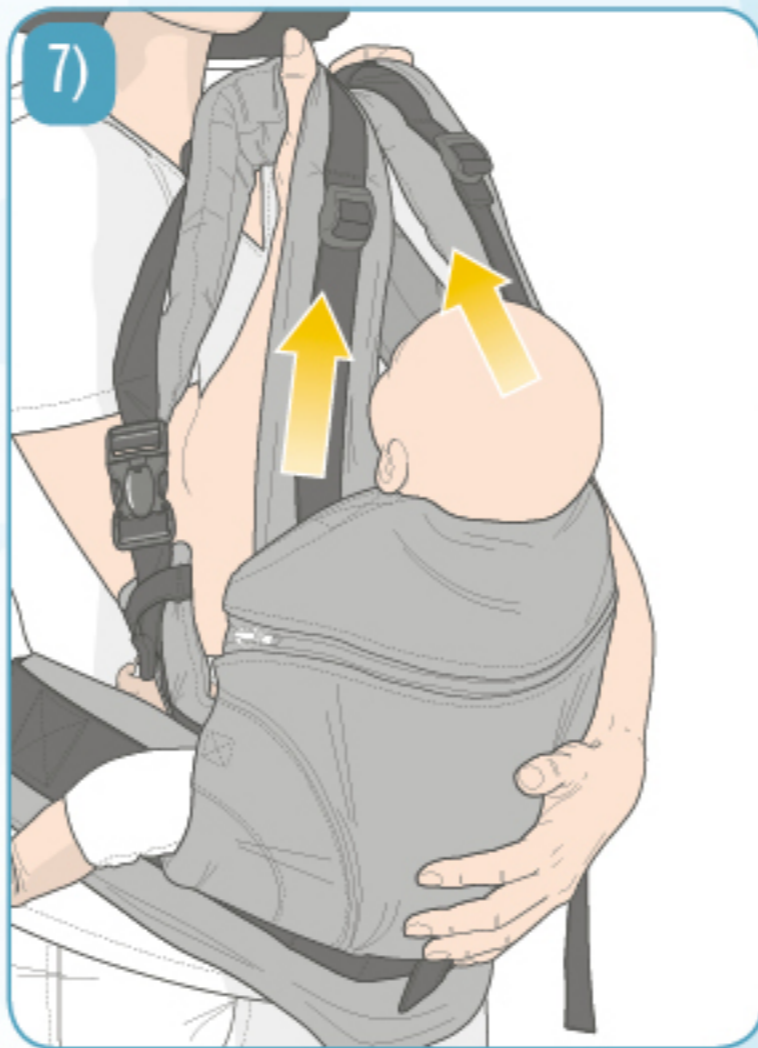

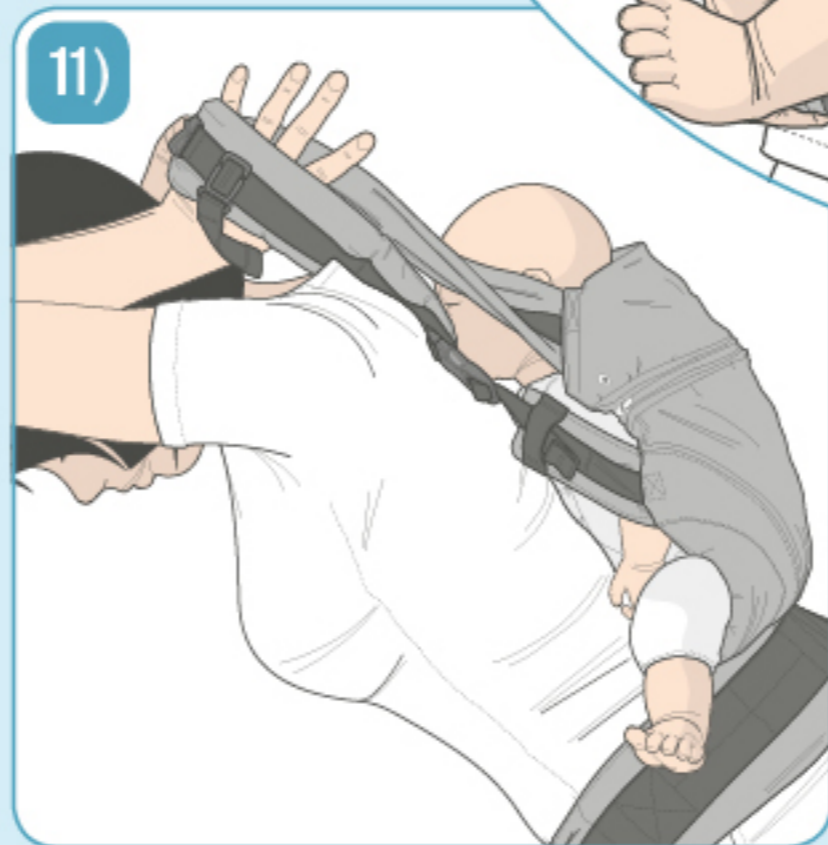
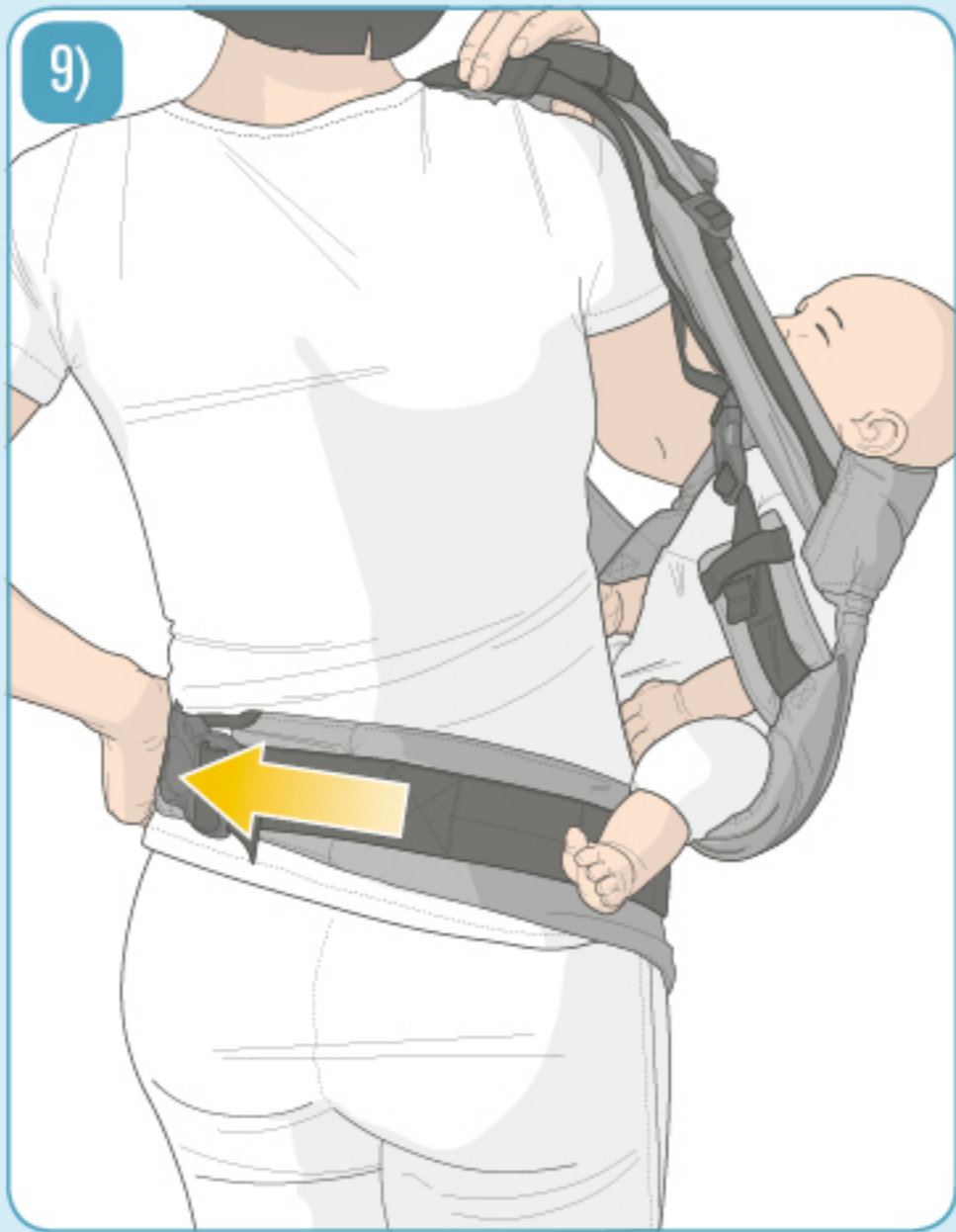



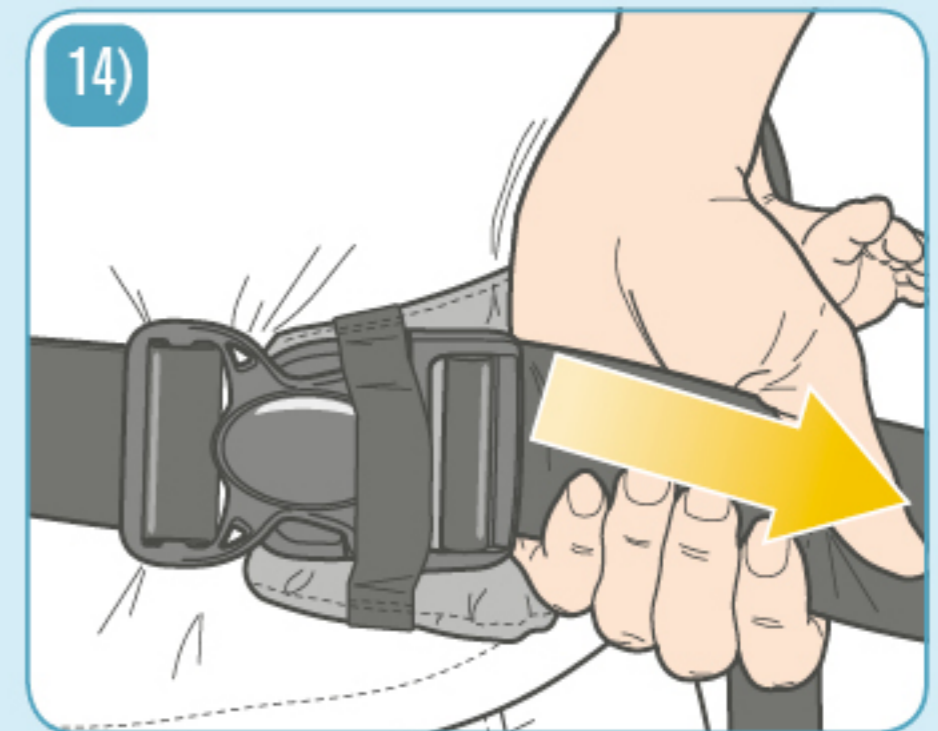
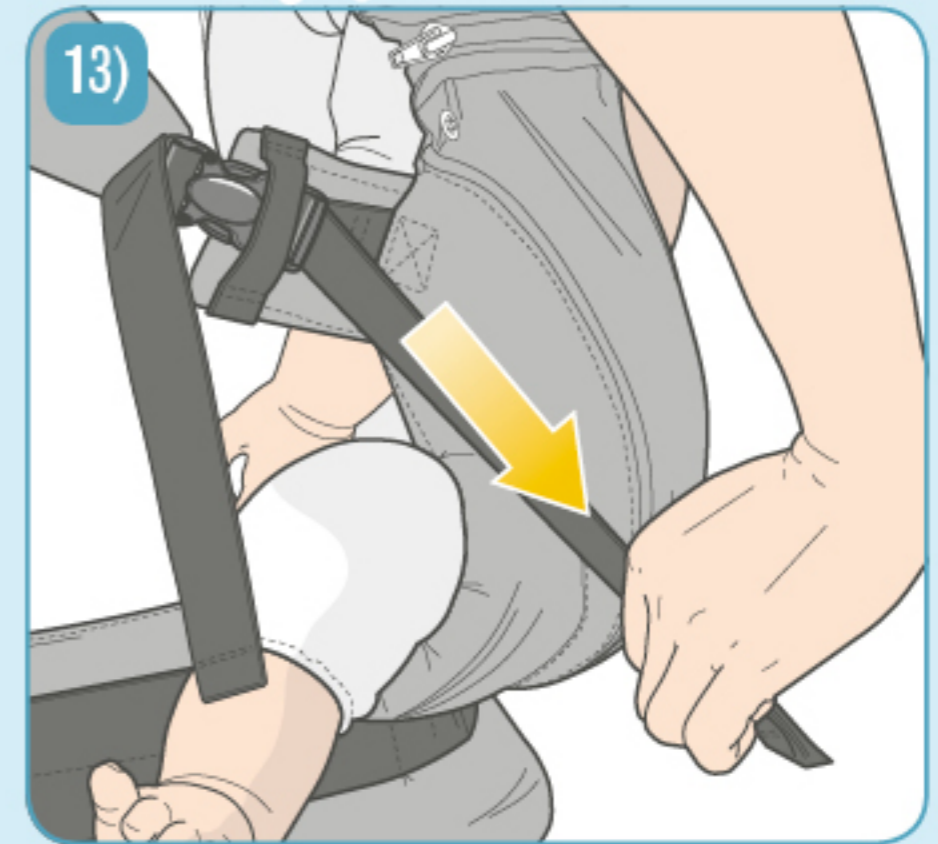
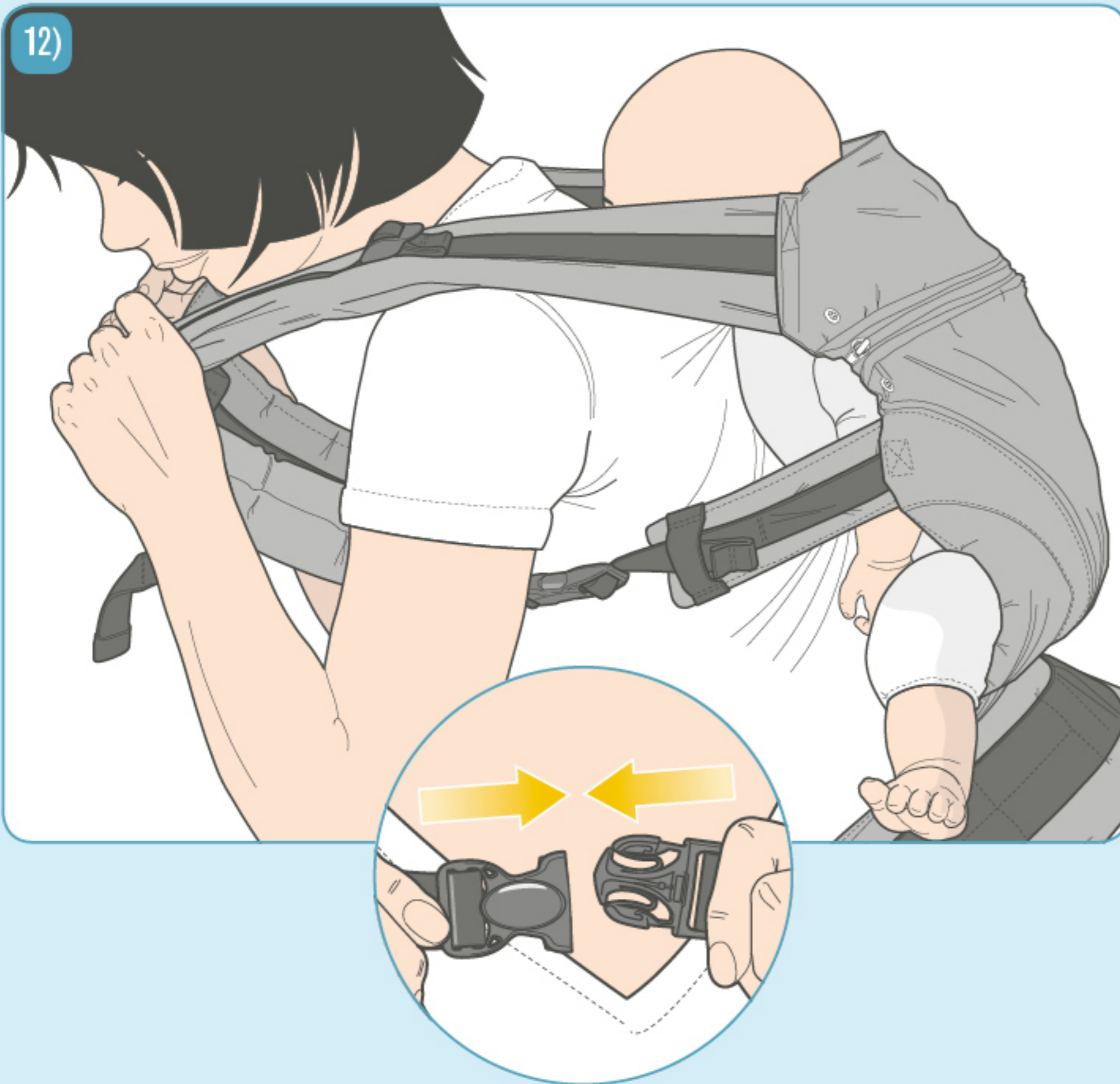



>9 mo.

Back position

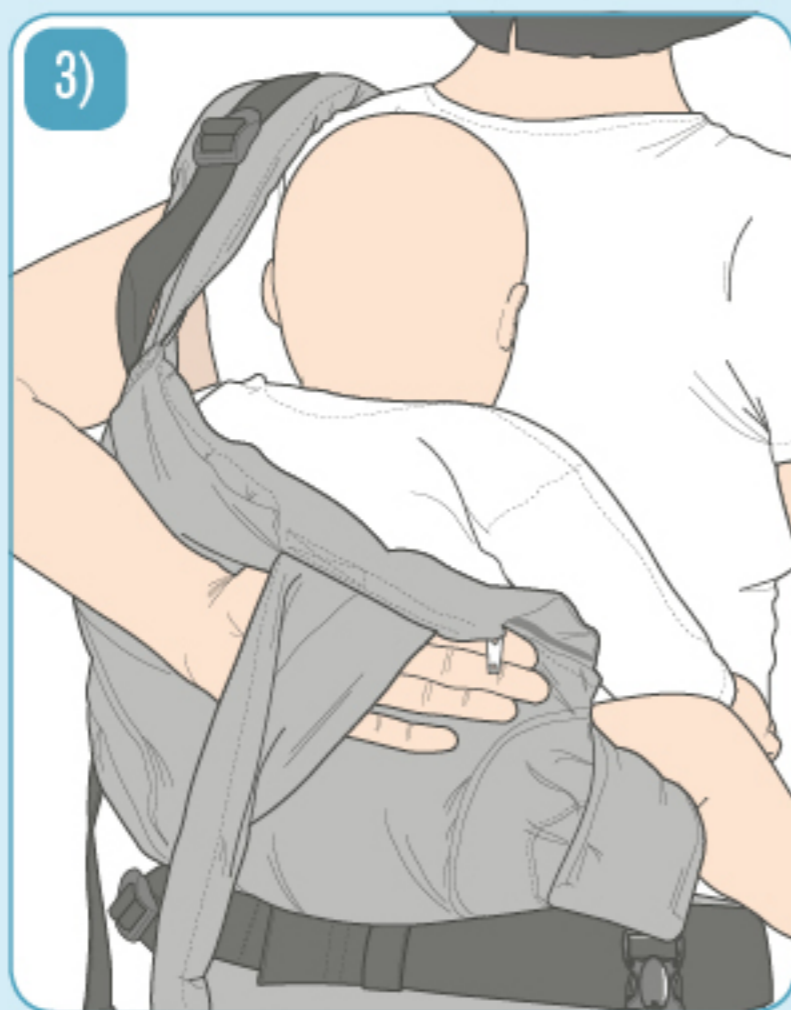

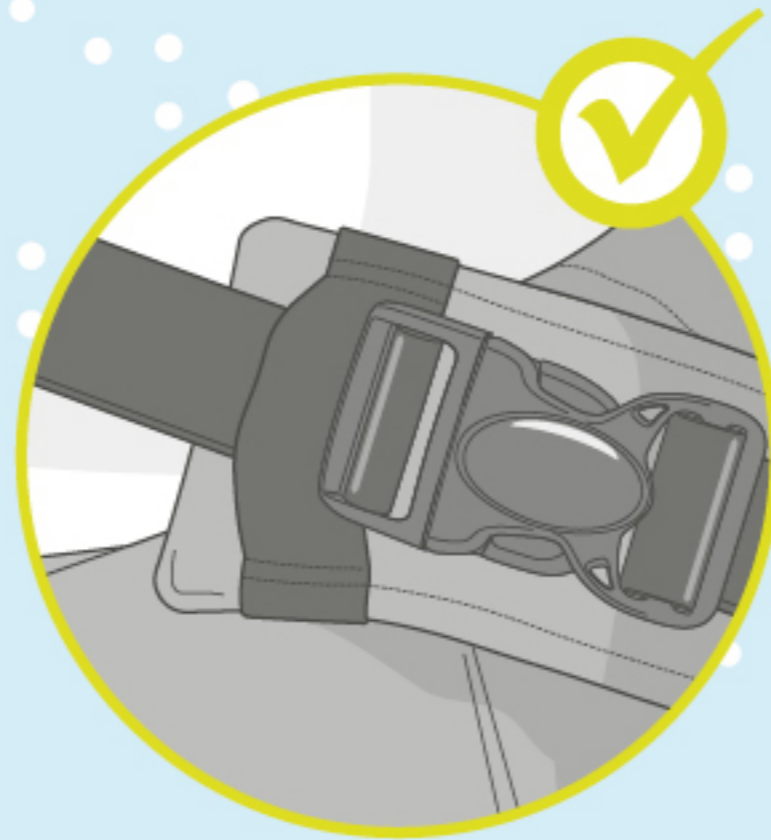
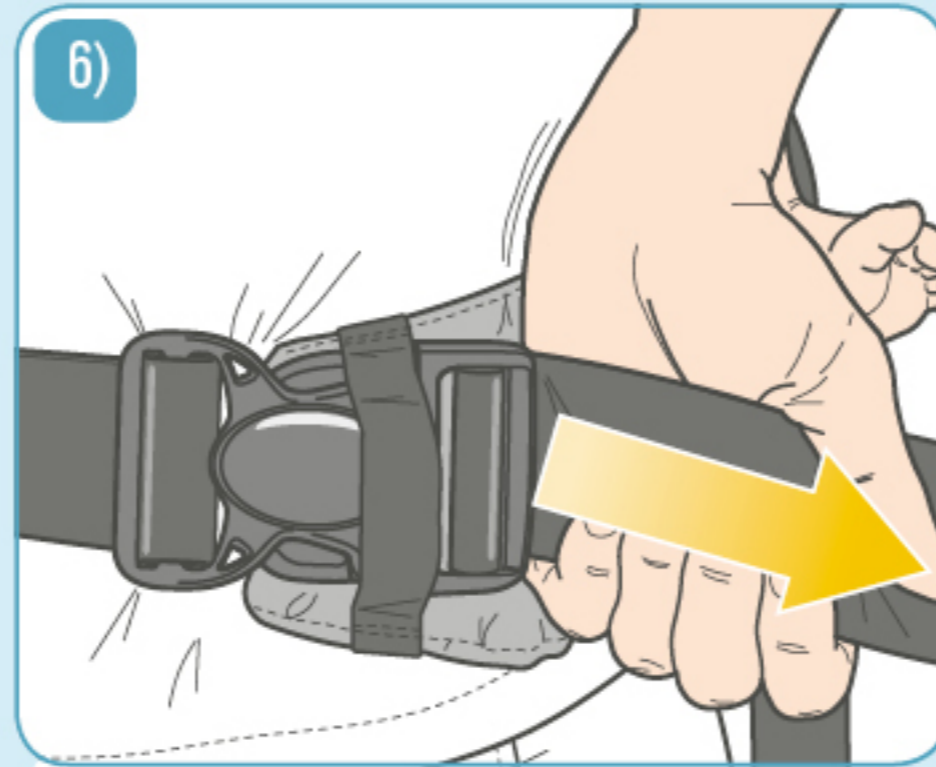
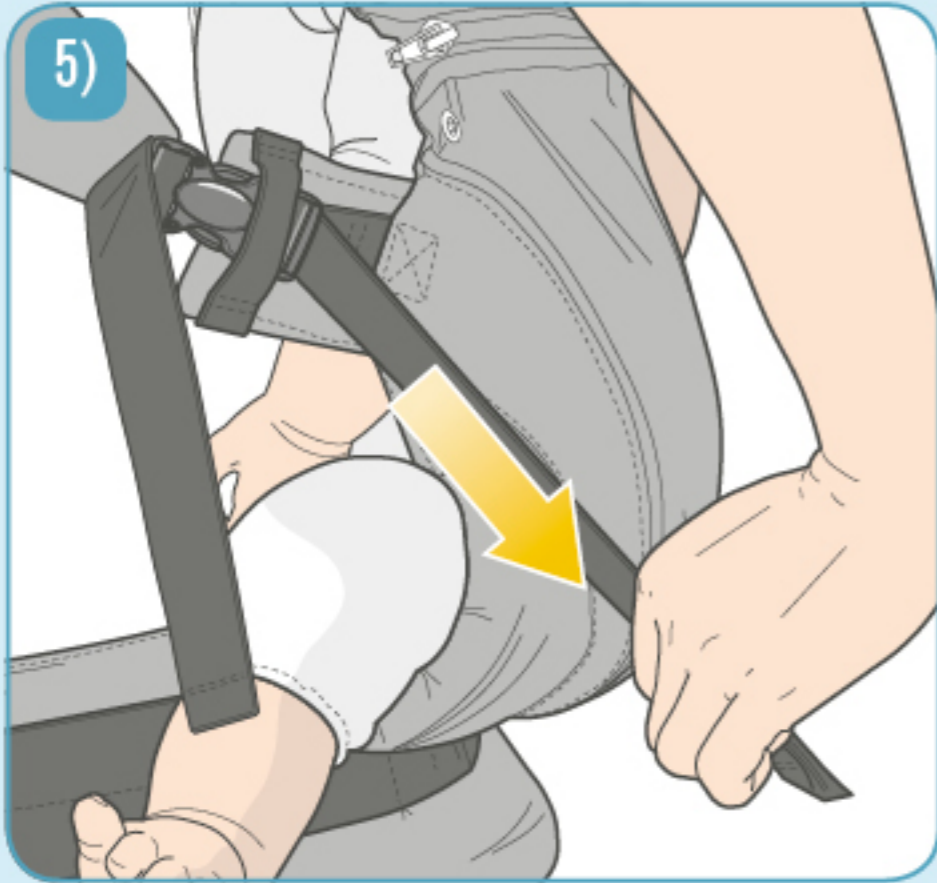

min/max

**3,5/20 kg**  
**7.7/44 lbs**



**manduca**®  
my baby carrier /  
mon porte-bébé **first**

**Design and distribution:**

Wickelkinder GmbH  
Zelterstraße 1  
35043 Marburg  
Germany

Tel. +49 6424 928690  
info@manduca.de