

KidKraft is here to help!

If you have any issues with your item or need any assistance, please contact us.

Email us with the **item number**, description of the problem, **part number** and **batch code**.

(Your batch number is located on the bottom left of this sheet of paper.)

www.kidkraft.com/assembly-instructions

¡En KidKraft estamos para ayudarle!

Si tiene algún problema con su artículo o necesita ayuda, por favor contáctenos. Envíenos un **Email** con el **número del artículo**, descripción del problema, **número de la pieza** y **código de lote**.

(Su código de lote se localiza en la parte inferior izquierda de esta página.)

www.kidkraft.com/assembly-instructions

KidKraft est là pour vous aider!

Si vous avez un problème avec un article ou si vous avez besoin d'assistance, contactez-nous.

Envoyez-nous un **courriel** précisant le **numéro de référence**, la description du problème, le **numéro de référence** de la **pièce** et le **code de lot**.

(Vos numéro de pièce et code de lot sont situés au bas de cette feuille.)

www.kidkraft.com/assembly-instructions

KidKraft hilft Ihnen gerne!

Sie können uns jederzeit kontaktieren, falls Sie Probleme mit Ihrem Artikel haben oder sonst Unterstützung benötigen. Senden Sie uns einfach eine **E-Mail** mit der **Artikelnummer**, eine Beschreibung des Problems sowie der **Teile-** und **Chargennummer**. (Sie finden Ihre Chargennummer unten links auf dieser Seite.)

www.kidkraft.com/assembly-instructions

KidKraft helpt u graag!

Neem alstublieft contact met ons op als u een probleem heeft met uw artikel of hulp nodig heeft. **Email** ons het **artikelnummer**, een omschrijving van het probleem, het **onderdeelnummer** en de **partij-code**.

(De partij-code vindt u onderaan links op deze pagina.)

www.kidkraft.com/assembly-instructions



**Batch Code / Código De Lote /
Pièce et code de lot /
Chargennummer / Partij-code:**





Contact Us! / ¡Contáctanos! / Pour nous contacter / Kontaktieren Sie Uns! / Contacteer Ons!

U.S. / MEXICO

KidKraft
4630 Olin Road
Dallas, Texas 75244
www.kidkraft.com
customerservice@kidkraft.com
1-800-933-0771
972-385-0100

**EUROPEAN REGIONS / REGIÓN DE EUROPA / RÉGION EUROPE /
EUROPAISCHE LANDSTRICHE / REGIO EUROPA**

KidKraft Netherlands BV
Olympisch Stadion 29
1076DE Amsterdam
The Netherlands
www.kidkraft.com
europcustomerservice@kidkraft.com
+31 (0)20 305 8620

CANADA

KidKraft
4630 Olin Road
Dallas, Texas 75244
www.kidkraft.com
canadacustomerservice@kidkraft.com
1-800-933-0771
972-385-0100

AUSTRALIA

KidKraft
Suite 7101,
2 Locomotive Street
Australian Technology Park
Eveleigh, NSW 2015
www.kidkraft.com.au
aucustomerservice@kidkraft.com

.....

**ALL OTHER REGIONS / TODAS LAS DEMÁS REGIONES /
TOUTES LES AUTRES RÉGIONS**

info@kidkraft.com



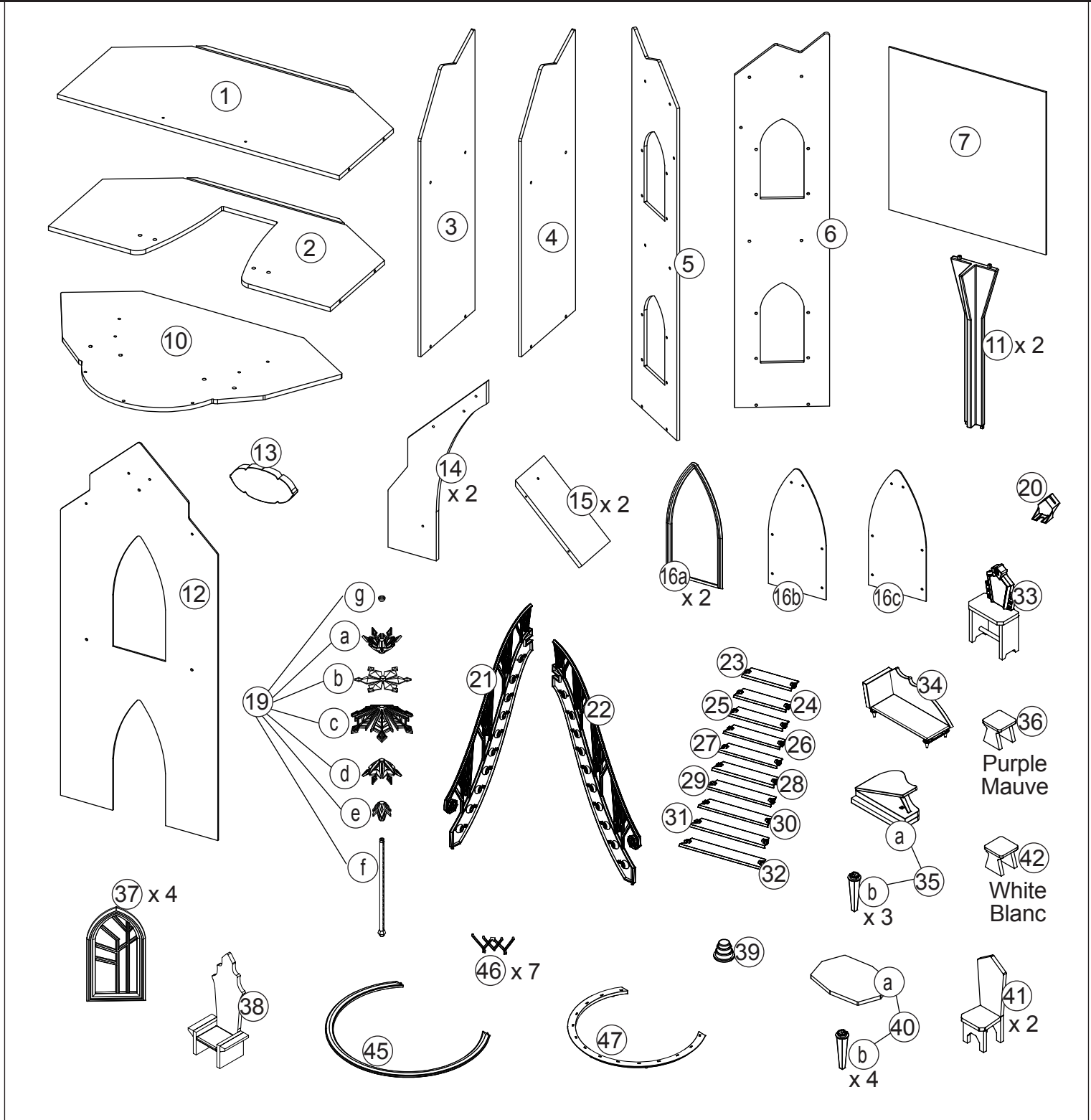

| | | | | | | | |
|---|---|--|-------------|---|---|---|------------|
| A | x 20 | D | x 12 | F-SIL | x 2 | I | x 2 |
|  | 42 mm |  | 9 mm |  24 mm Silver / Plateado / Argentée / Silberfarbene / Zilveren |  22 mm | | |
| B | x 16 | E-BL | x 2 | G | x 7 | J | x 1 |
|  | 12 mm |  18 mm Blue / Azul / Bleu / Blau / Blauw | |  7 mm | |  | |
| C-BL | x 2 | E-SIL | x 6 | H-SIL | x 4 | K | x 1 |
|  | 14 mm Blue / Azul / Bleu / Blau / Blauw |  18 mm Silver / Plateado / Argentée / Silberfarbene / Zilveren | |  12 mm Silver / Plateado / Argentée / Silberfarbene / Zilveren | |  | |
| C-SIL | x 6 | F-BL | x 4 | H-BL | x 4 | | |
|  | 14 mm Silver / Plateado / Argentée / Silberfarbene / Zilveren |  24 mm Blue / Azul / Bleu / Blau / Blauw | |  12 mm Blue / Azul / Bleu / Blau / Blauw | | | |

Step
Paso
Étape
Schritt
Stap

1

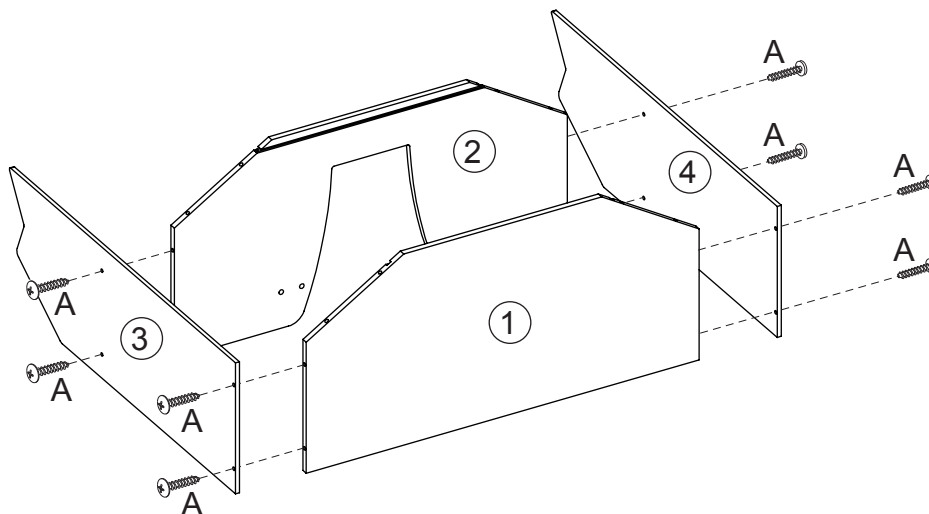

Parts and Hardware
Partes y Piezas Para Instalación
Pièces et matériel
Teile und Befestigungsmaterial
Onderdelen en Schroeven en Gereedschap

All hardware dimensions are approximate.
Todas las dimensiones se las herramientas
son aproximaciones.
Toutes les dimensions du matériel
sont approximatives.

2



Step
Paso
Étape
Schritt
Stap

2

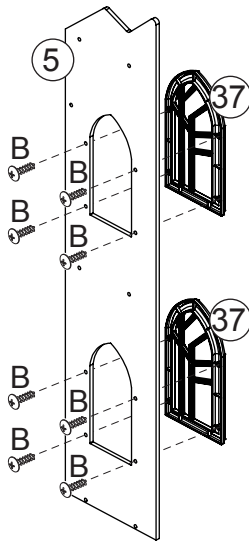

Step
Paso
Étape
Schritt
Stap

3

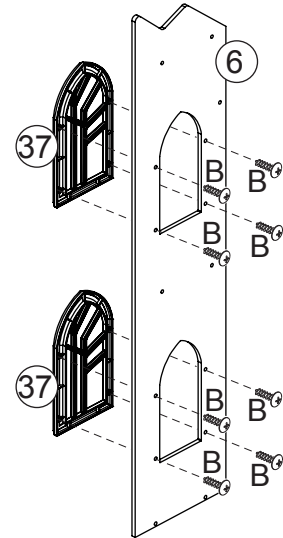

Step
Paso
Étape
Schritt
Stap

4

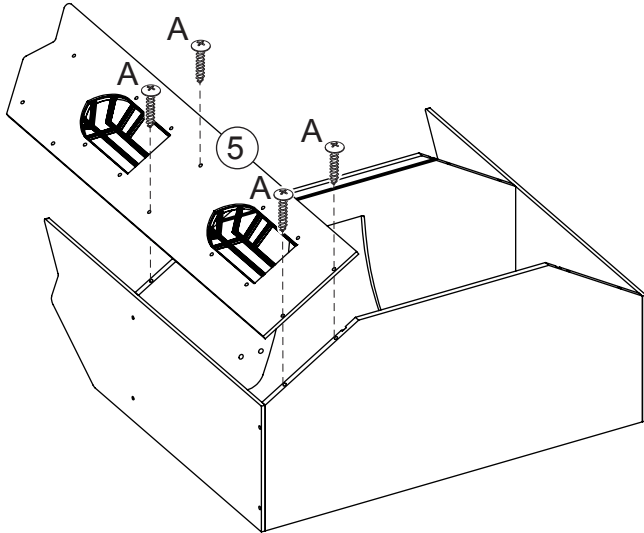

Step
Paso
Étape
Schritt
Stap

5

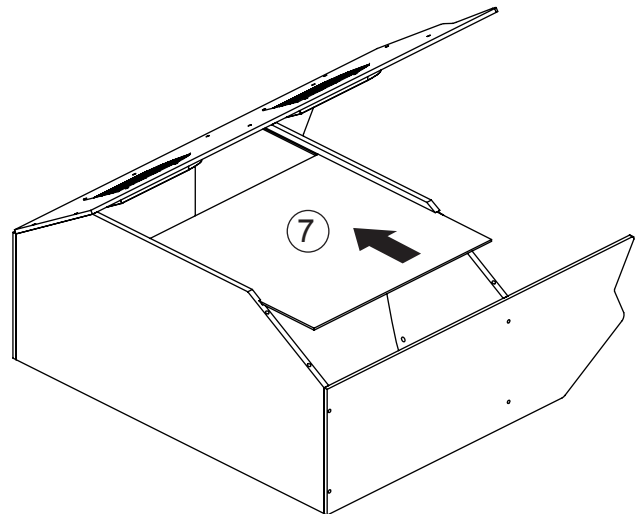

Step
Paso
Étape
Schritt
Stap

6

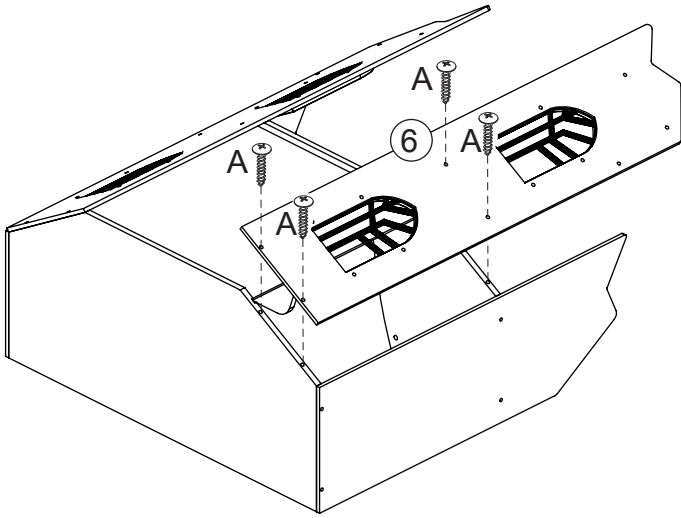

Step
Paso
Étape
Schritt
Stap

7

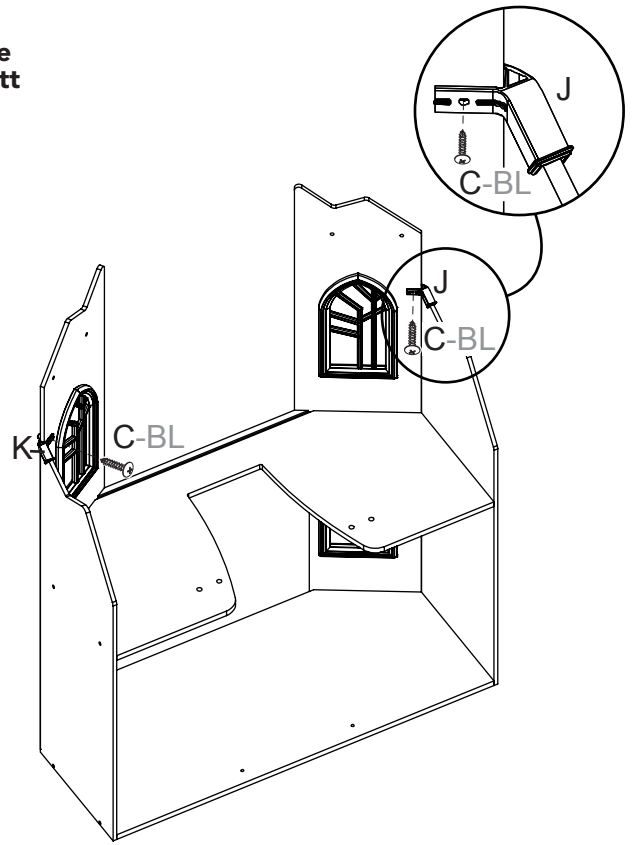

Step
Paso
Étape
Schritt
Stap

8

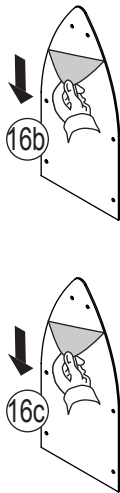

Step
Paso
Étape
Schritt
Stap

9

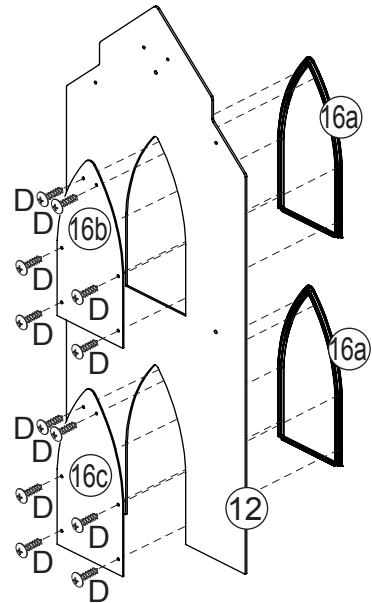

Step
Paso
Étape
Schritt
Stap

10

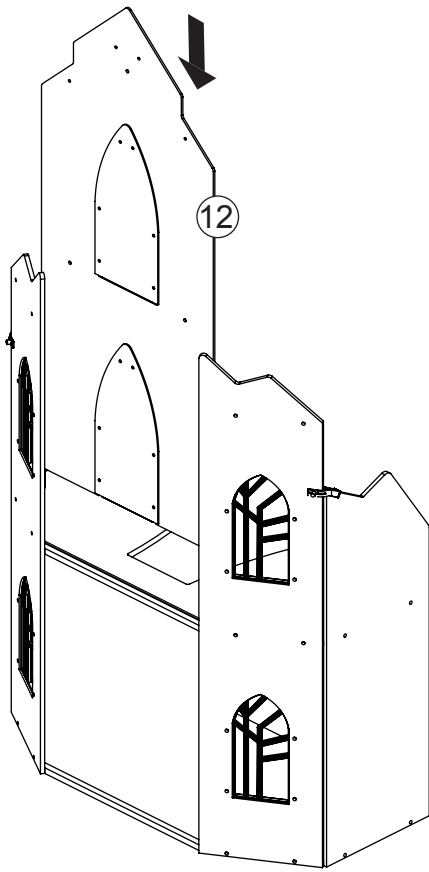

Step
Paso
Étape
Schritt
Stap

11

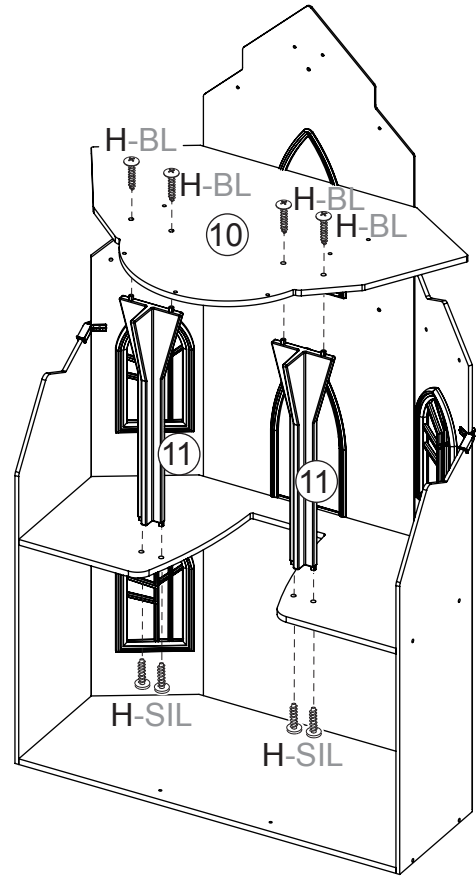

Step
Paso
Étape
Schritt
Stap

12

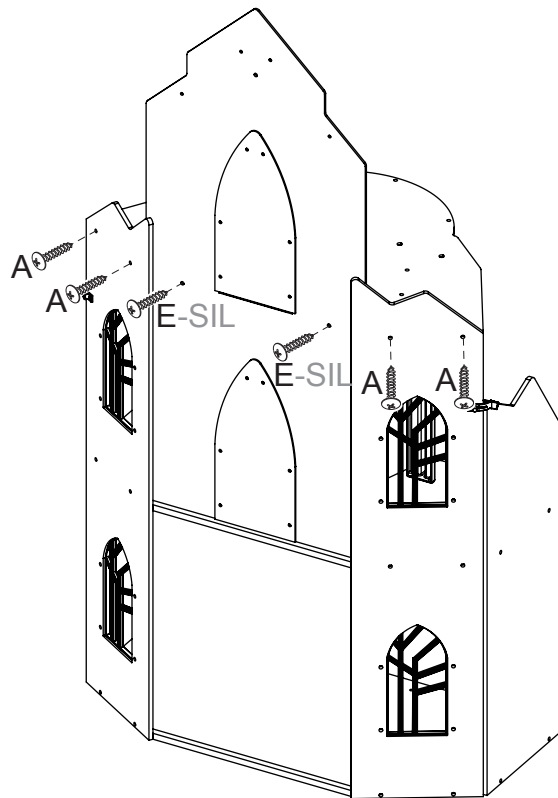

Step
Paso
Étape
Schritt
Stap

13

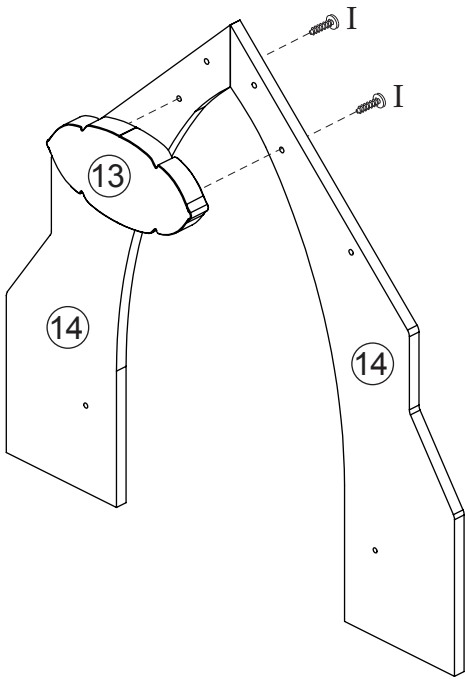

Step
Paso
Étape
Schritt
Stap

14

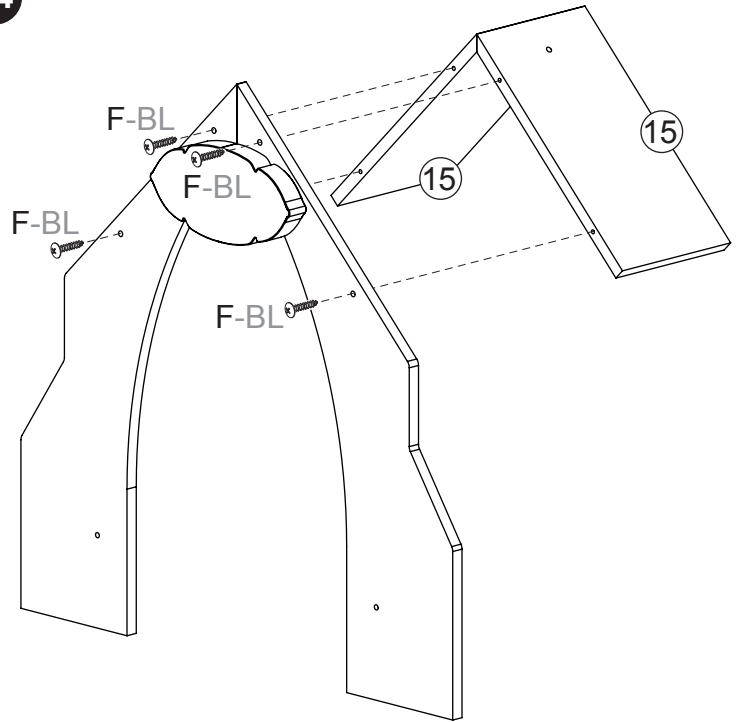

Step
Paso
Étape
Schritt
Stap

15

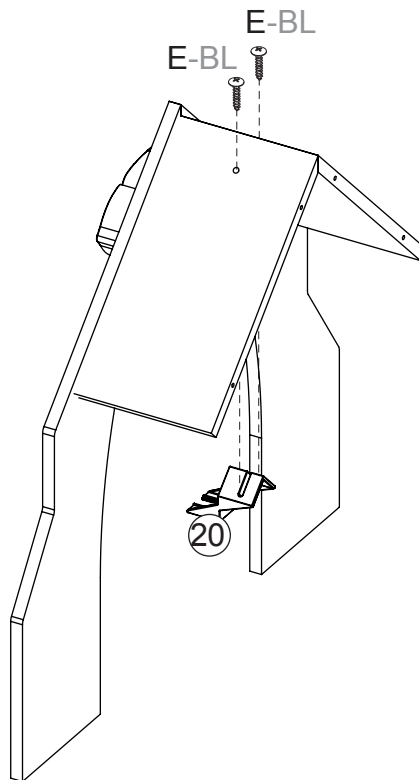

Step
Paso
Étape
Schritt
Stap

16

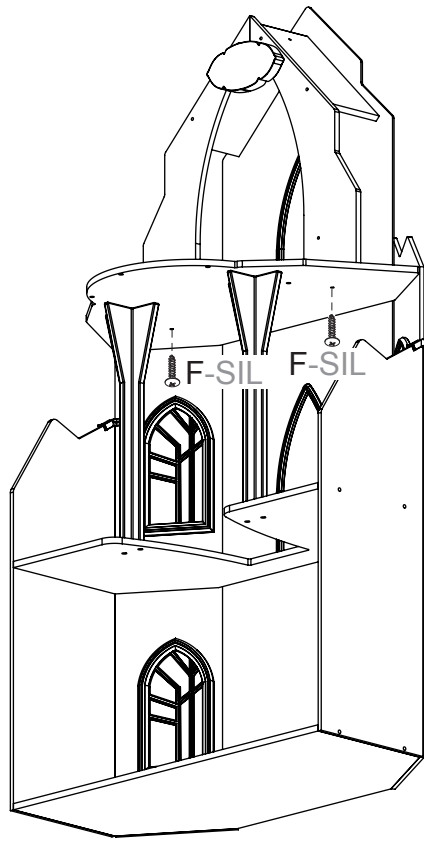

Step
Paso
Étape
Schritt
Stap

17

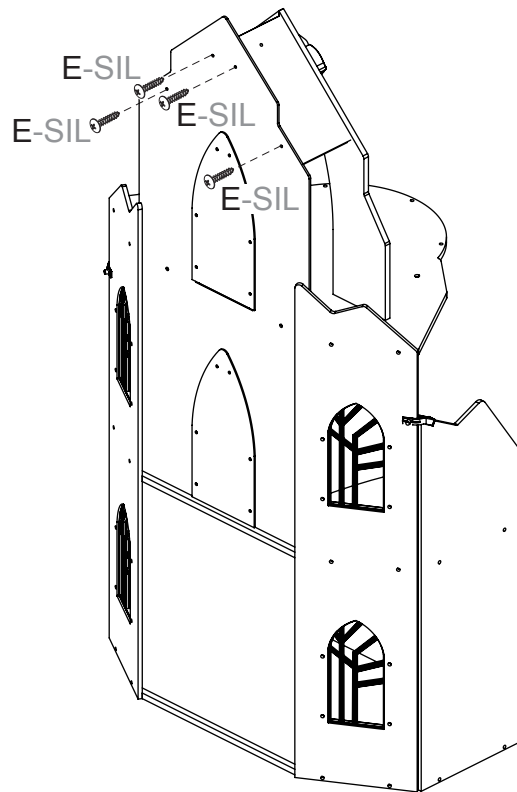

Step
Paso
Étape
Schritt
Stap

18

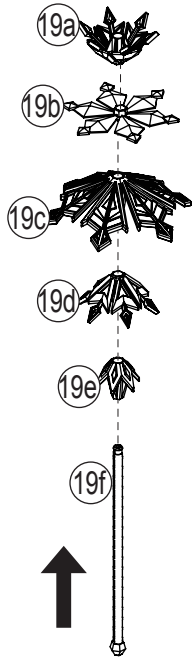

Step
Paso
Étape
Schritt
Stap

19

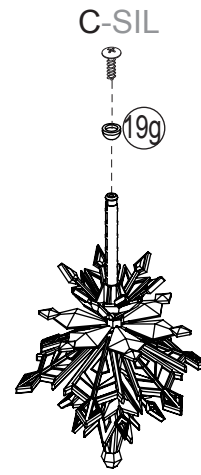

Step
Paso
Étape
Schritt
Stap

20

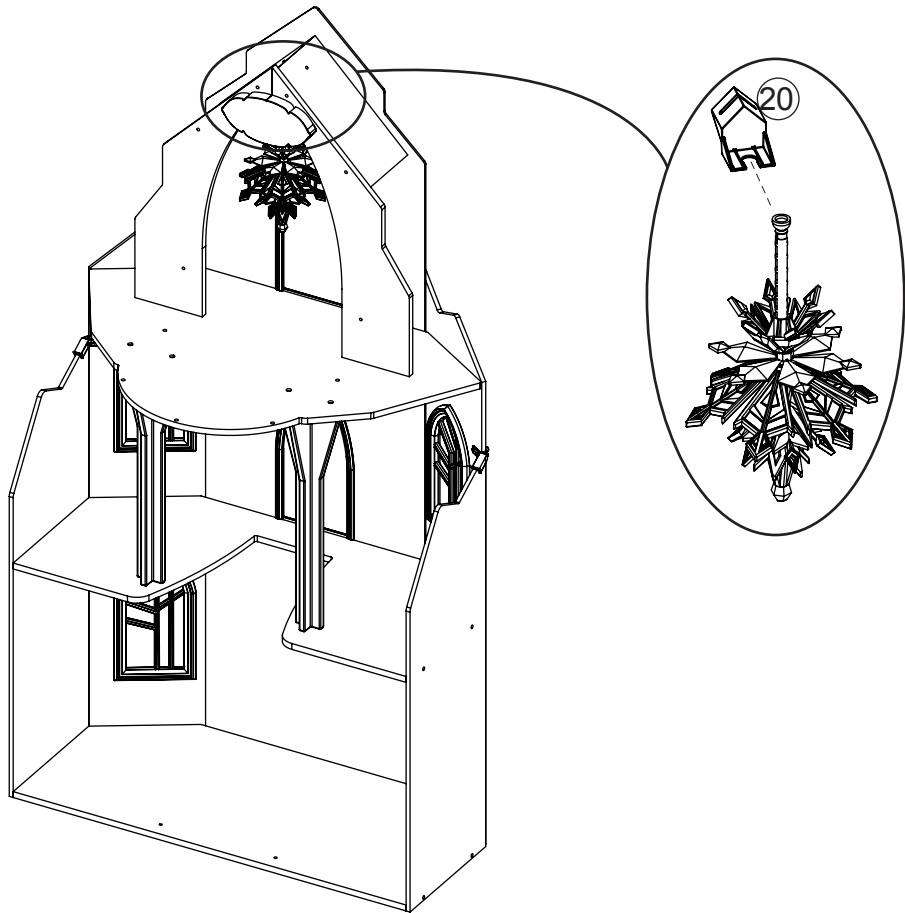

Step
Paso
Étape
Schritt
Stap

21

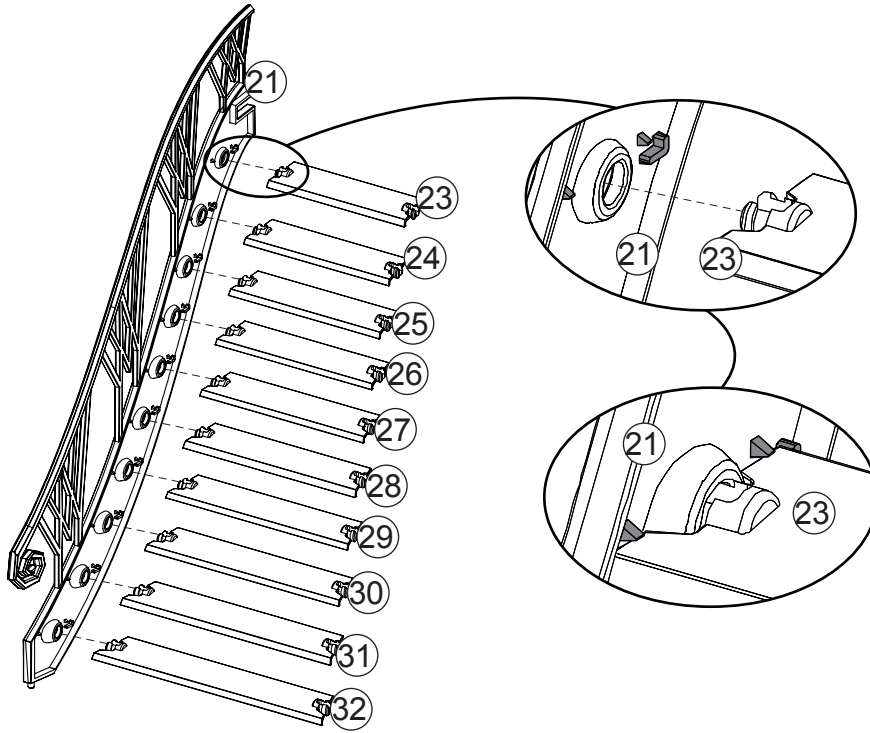

Step
Paso
Étape
Schritt
Stap

22

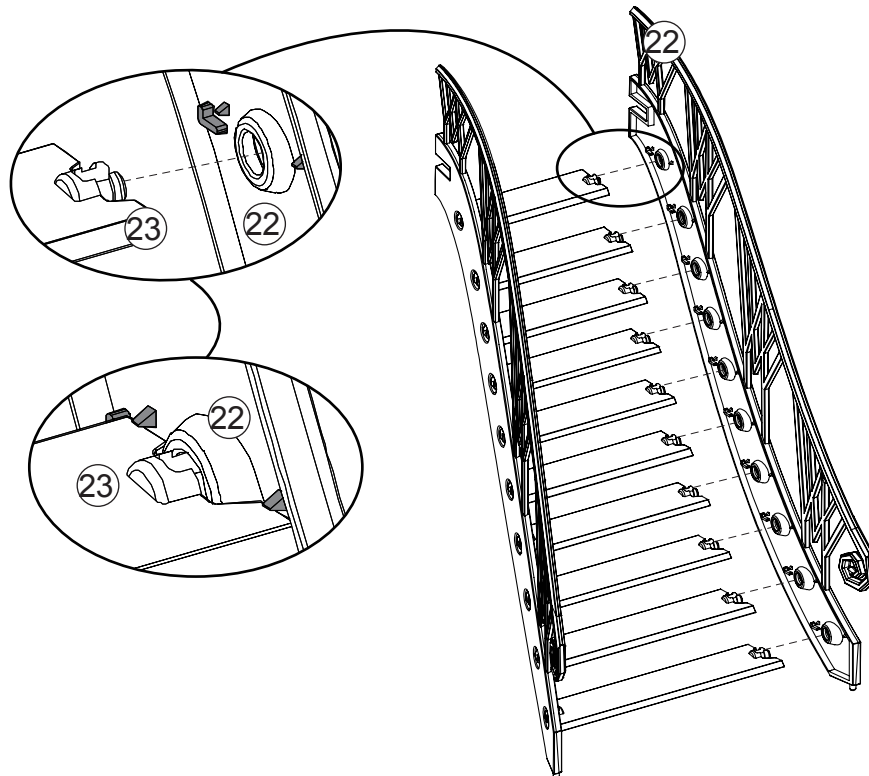

Step
Paso
Étape
Schritt
Stap

23

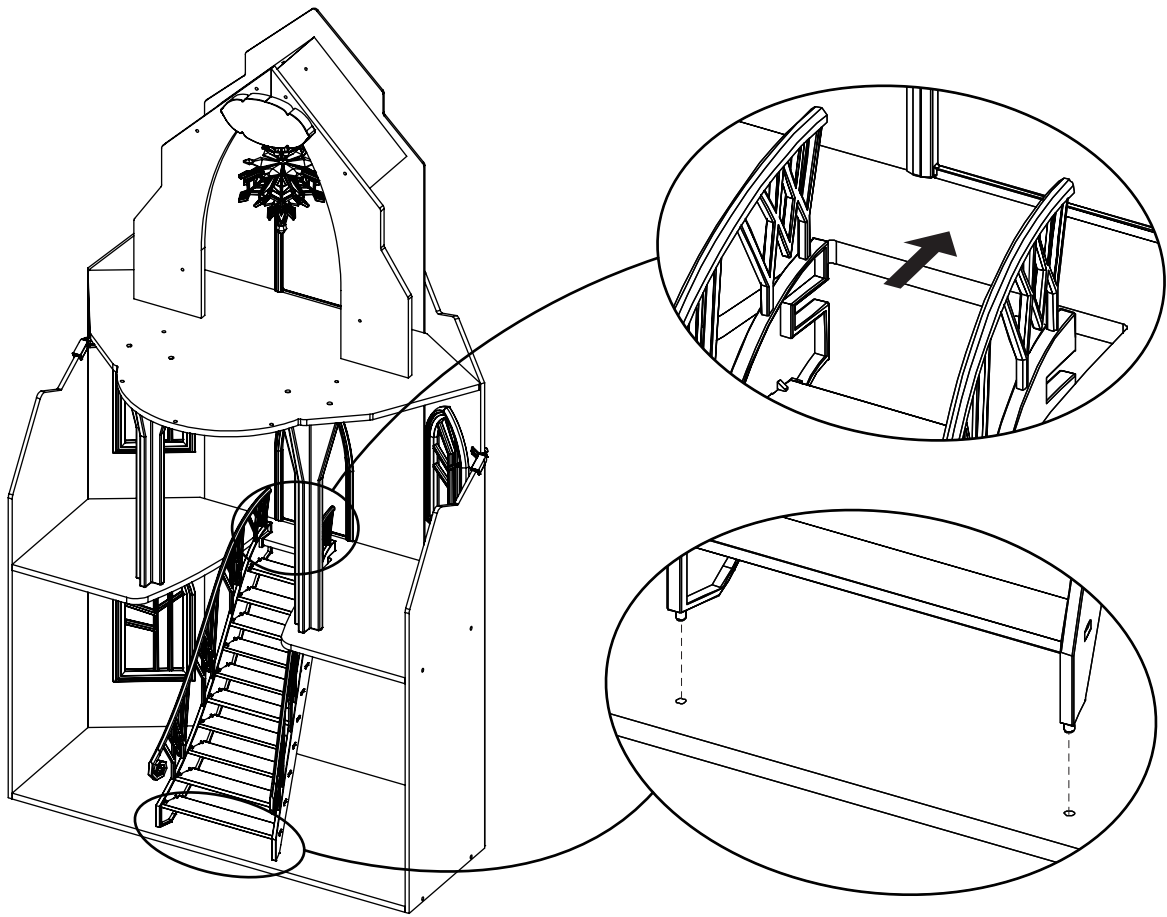

Step
Paso
Étape
Schritt
Stap

24

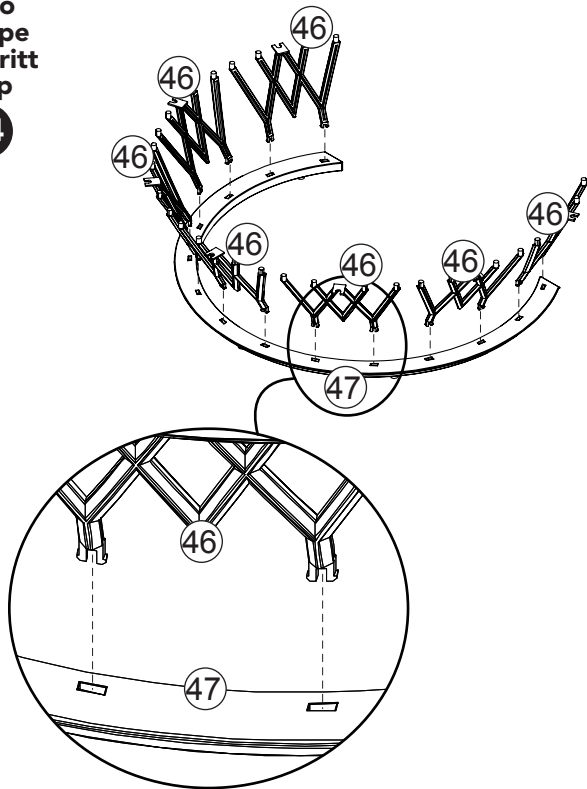

Step
Paso
Étape
Schritt
Stap

25

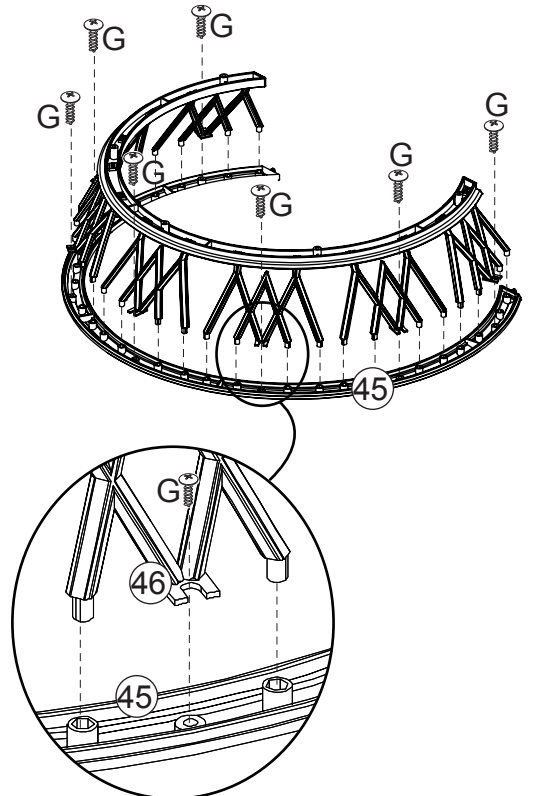

Step
Paso
Étape
Schritt
Stap

26

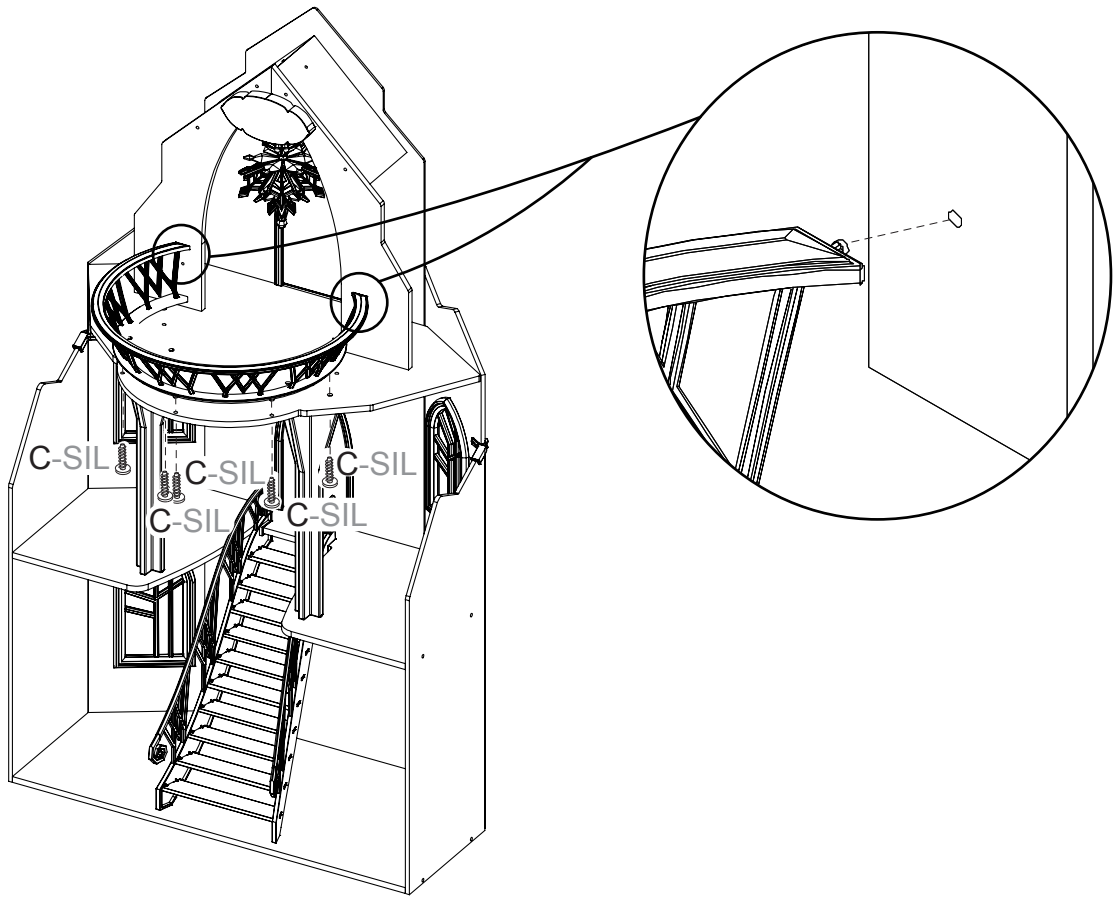

Step
Paso
Étape
Schritt
Stap

27

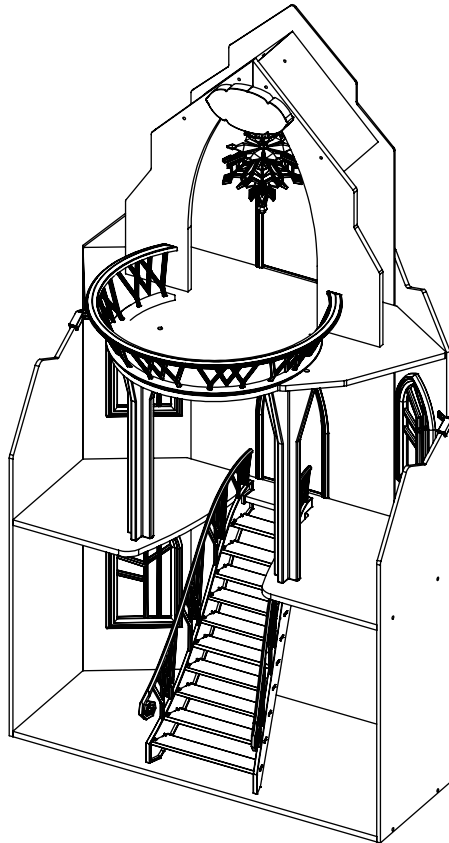

Step
Paso
Étape
Schritt
Stap

28

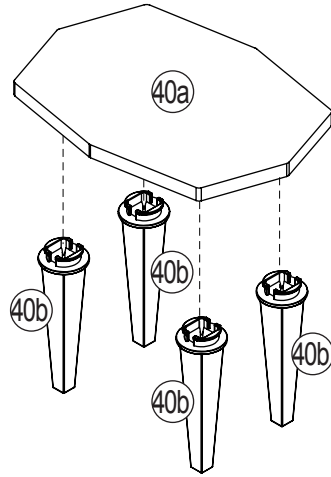

Step
Paso
Étape
Schritt
Stap

29

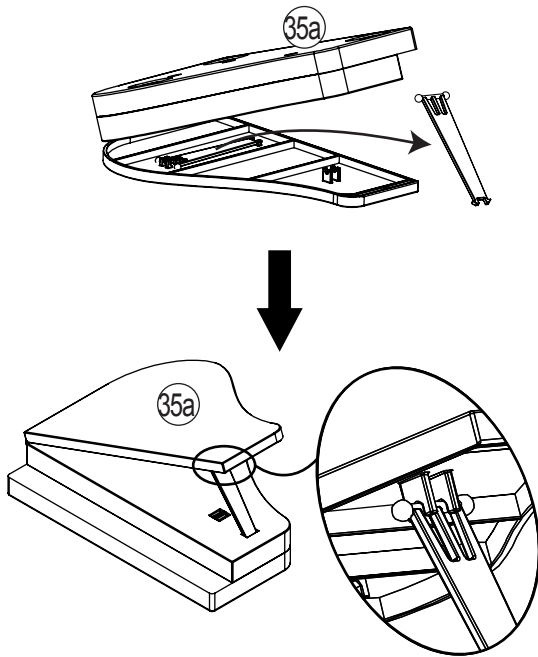

Step
Paso
Étape
Schritt
Stap

30

