

**MONSTER®**

**HOME THEATER  
BLUETOOTH  
SOUNDBAR**

**Quick Start Guide**

Please read this Quick Start Guide carefully  
and keep it for future use.

# Welcome

Premium connectivity that fuels modern lifestyle and empowers innovation. A better everyday experience through amazing products. The user manual will provide everything you need to know about using your new product. All our products are produced and tested to stringent standards of performance and safety. We hope you enjoy your purchase.

# Product Overview

## What's in the box:

- A. 2.0 Channel Soundbar
- B. Remote Control
- C. AAA Batteries (2)
- D. 3.5mm to RCA Cable
- E. Optical Cable
- F. AC Power Adaptor
- G. Wall Mount Kit
- H. HDMI Adaptor
- I. Warranty Card
- J. General Safety Warnings
- K. User Manual

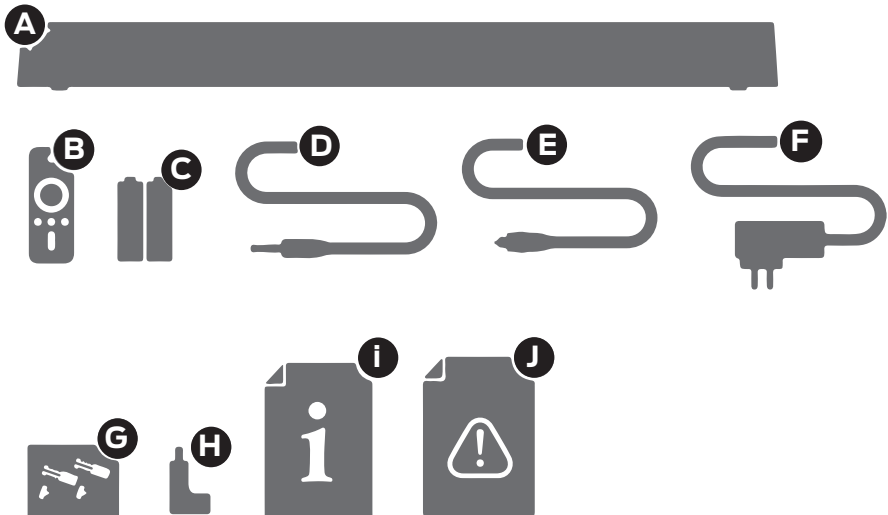

## You will need:

- Phillips-head screwdriver and a drill (for wall mount installation)
- HDMI Cable, if you want to set up and use HDMI CEC. (Otherwise you can use the included optical cable if you don't use HDMI.)

# Wall Mount Installation Kit

The illustration below shows the contents of the wall mount installation kit. These are the parts you will need when wall mounting the Soundbar. Some parts are not shown at the same scale.



1. Plastic anchor (2)



2. Screw (2)

## Important Tips

- Place the Soundbar on a level surface.
- Place the Soundbar away from any source that may generate heat or vibrations.
- Make sure there is enough space around the Soundbar for airflow.
- The remote control works up to 6 metres away from the Soundbar.
- Unplug the Soundbar before cleaning it.
- Clean using a dry cloth only - do not use water or chemicals.
- Use only the power supply provided.
- Keep liquid, children and pets away from the Soundbar at all times.

# Installation

This Soundbar can sit free-standing on a surface, or it can be mounted to a wall.

Place on a secure, flat surface. Make sure the Soundbar is standing on its rubber pads (on the left and right sides on the bottom of the Soundbar) and no other area of the bottom of Soundbar is touching the surface.

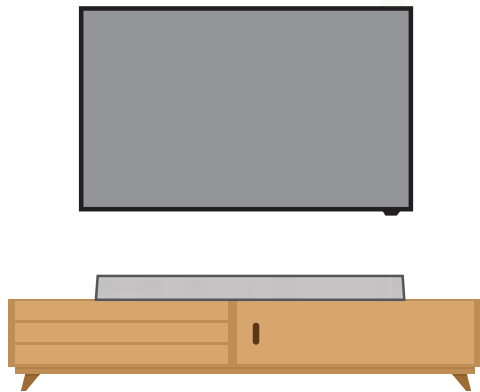

Free-standing

Wall mounting instructions are on the following pages.



- Wall-mounted installation must be carried out by qualified personnel only. Incorrect assembly can result in severe personal injury and property damage! If you intend to install this product yourself, you must check for installations such as electrical wiring and plumbing, which may be hidden inside or behind the wall.
- It is the installer's responsibility to verify and confirm that the wall will safely support the total load of the Soundbar and wall brackets.
- Additional tools (not included) are required for the installation.
- Do not overtighten screws.
- Use an electronic stud finder to check the wall type before drilling and mounting.

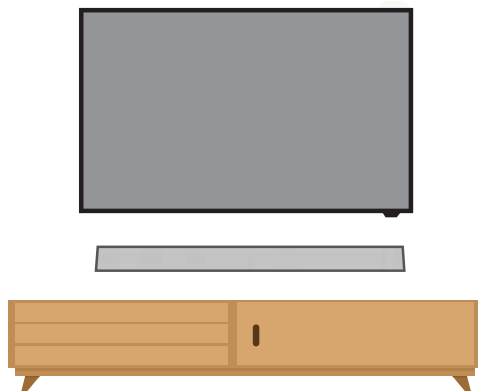

Wall mounted

# Wall Mounting Instructions

1

Use a pencil to make drill hole marks on the wall for the plastic anchors. Make sure the marks are level before drilling. Use a 6mm bit and power drill (not supplied) to drill holes on the marks.

Note: For a wood stud wall, use an electronic stud detector to locate the centre of the framing studs before marking and drilling the holes.

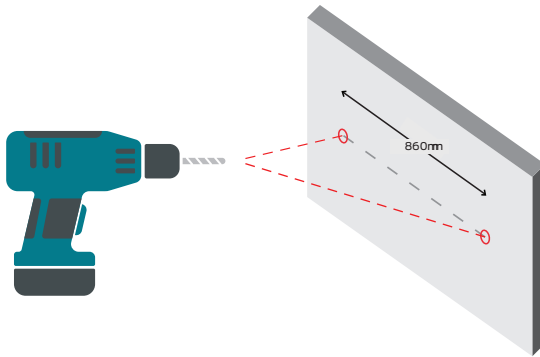

2

Slide the Soundbar onto the fixed screws. Make sure that the Soundbar is secured and attached firmly to the wall.

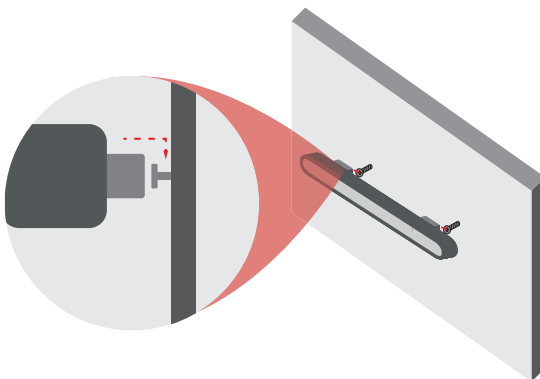

# Connect to Power



Make sure the Soundbar is **switched off** at the power outlet until you have finished connecting your cables.

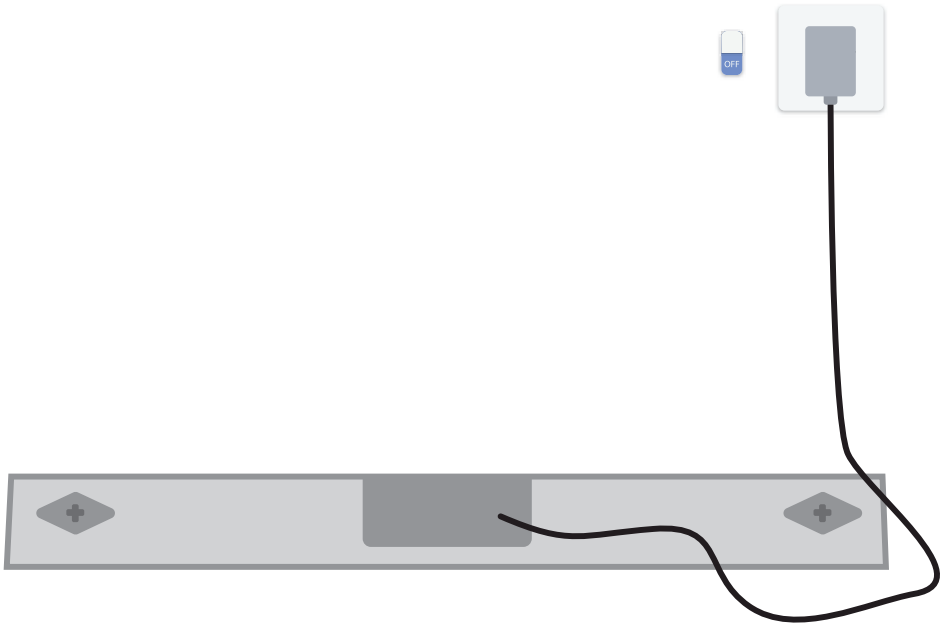

Don't forget to plug in the Soundbar to the power outlet. Leave the power switched off until installation is finished.



# Controls and Connections

## Get to Know your Soundbar

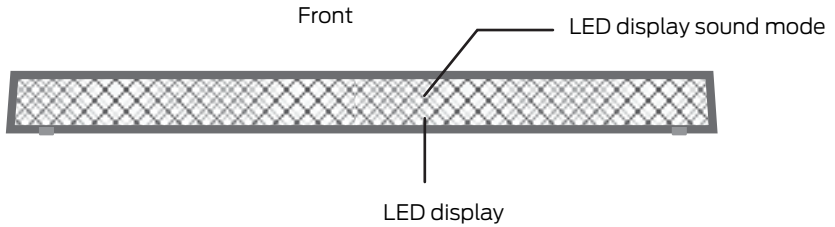

## Buttons on the Soundbar

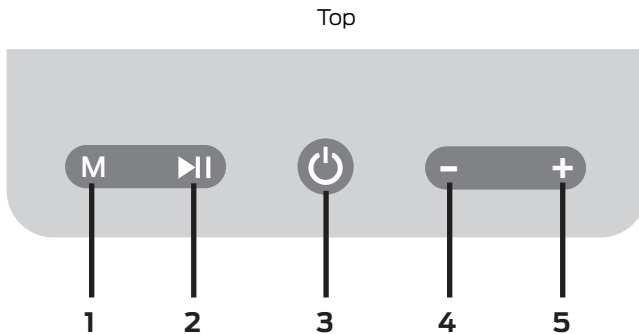

1. **M** : Press to switch between input sources.
2. **▶||**: Press to play/pause current song. Press and hold for 2 seconds to unpair Bluetooth device. Press twice to turn the 3D sound or Bass enhanced sound on/off.
3. **⏻** : Press and hold to turn the Soundbar on/off.
4. **-** : Press and hold to play the previous song. Press to decrease volume level.
5. **+** : Press and hold to play the next song. Press to increase volume level.

# Rear ports on the Soundbar



1	HDMI (ARC)		SOUND	The ARC (Audio Return Channel) function allows you to send audio input from an ARC-compliant TV to an ARC-compliant audio device (e.g. Soundbar) without the need for an additional audio cable connection.
2	OPTICAL		SOUND	Connect an Optical cable (included) to the OPTICAL OUT socket of your device (e.g. TV, DVD player) and the OPTICAL socket on the Soundbar.
3	COAXIAL		SOUND	Connect a coaxial cable (not included) to the COAXIAL socket of your device and the COAXIAL port on the Soundbar.
4	AUDIO IN		SOUND	You can use this to connect Audio to your TV for AV or Component video inputs.
5	POWER		POWER	Please only use the supplied AC power adaptor.

# HDMI (ARC)

To use the ARC function, make sure the Soundbar's TO TV (ARC) socket is connected via HDMI cable (not included) to the HDMI (ARC) socket of your ARC compliant TV. Then just use your TV remote control to adjust the volume output (VOL +/- and MUTE) of the connected audio device. In the TV settings menu, turn on the ARC and CEC function (when CEC is turned on, the Soundbar will turn on/off automatically when the TV is turned on/off).



When you use ARC or Optical connection to your TV or DVD, the audio output in the TV or DVD settings menu must be set to PCM mode (instead of Auto mode, RAW mode or etc.).

# Remote Control

## Setup

Insert the batteries into the battery compartment and aligned properly according to the polarity markings ( + / - ) inside the compartment.

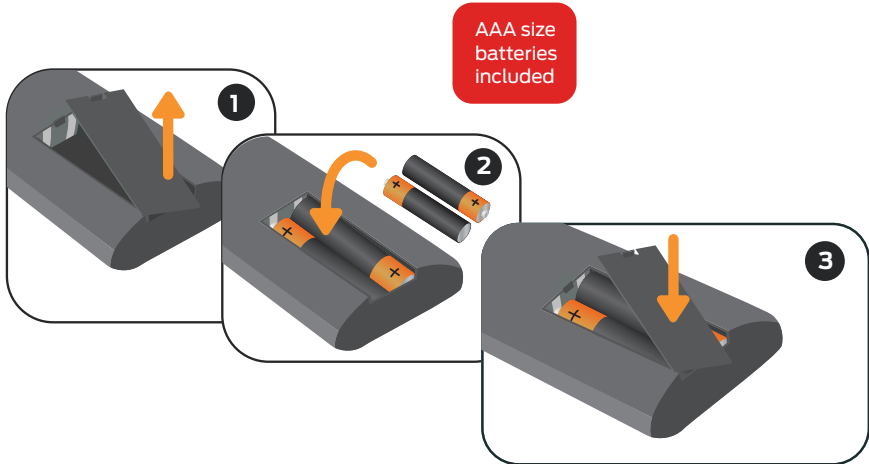

Illustration is for reference only.



### Precautions When Using Batteries

- Do not use old battery with new ones.
- Do not mix different types of batteries (e.g. Manganese and Alkaline).
- Remove the batteries when you plan not to use the remote for a long period of time.
- When discarding used batteries, follow any guidelines for recycling and disposal of batteries that apply in your local area.
- Keep batteries away from children and pets.
- Do not expose batteries to extreme temperatures or fire.

# Using the Remote Control

To use the remote, point it towards the remote sensor at the front of the Soundbar. The remote will not operate if its path is blocked.

The remote has a range of up to about 6 metres from the Soundbar at an angle of up to 30 degrees to either side of the sensor, as illustrated below.

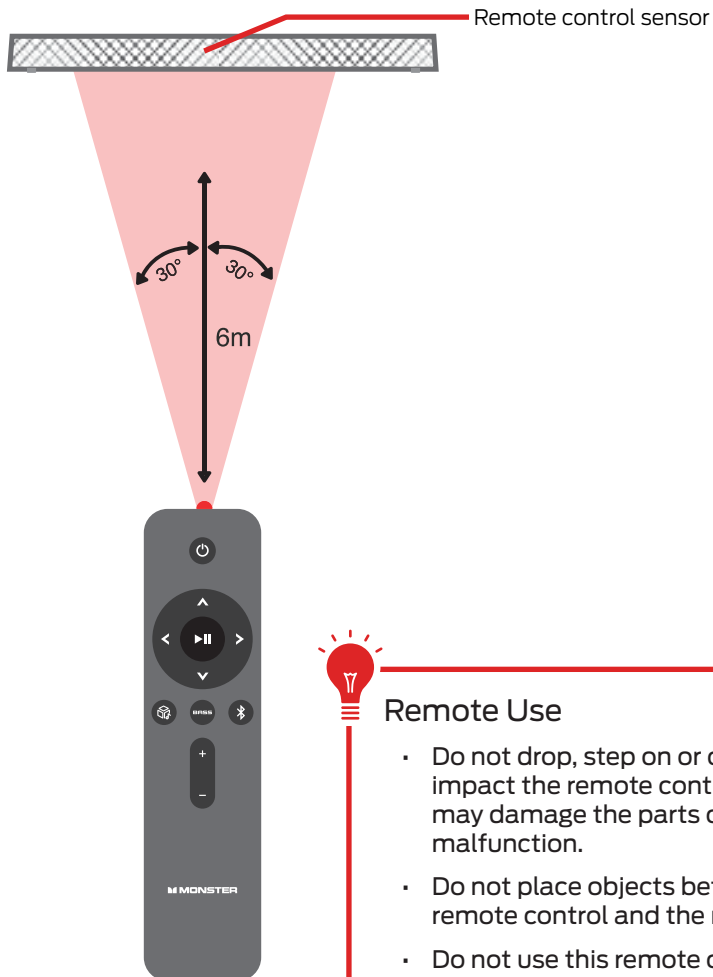





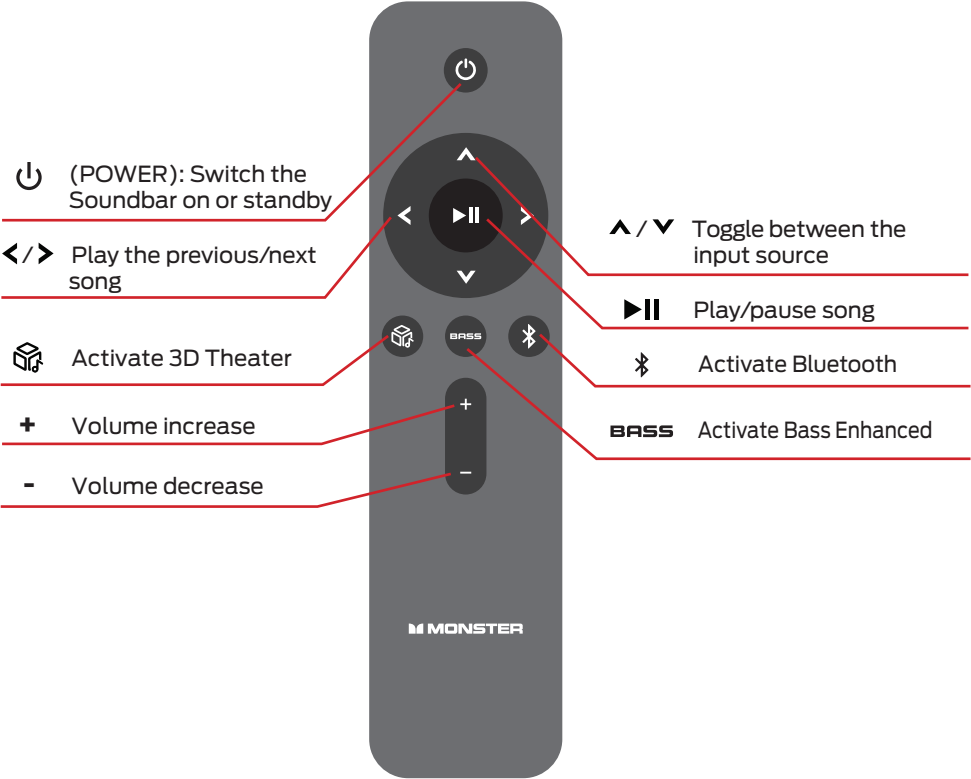

## Remote Use

- Do not drop, step on or otherwise impact the remote control. This may damage the parts or lead to malfunction.
- Do not place objects between the remote control and the remote sensor.
- Do not use this remote control while simultaneously operating a remote control for other devices.

# Remote Overview



# Operation      General Operation

Function	Action
Turn the Soundbar ON	Press and hold the  button on the top of the Soundbar or press the  button on the remote control to switch on the Soundbar.
Turn the Soundbar OFF	Press and hold the  button on the top of the Soundbar or press the  button on the remote control.
Change the input source/mode	Press the <b>M</b> button repeatedly on the Soundbar or press the  /  buttons on the remote to change the input source.
Increase/Decrease the volume	Press to the <b>+/-</b> buttons on the Soundbar or press the <b>+/-</b> buttons on the remote control to adjust the volume level.

## Input Modes



Input	Display	Input	Display
HDMI ARC	<i>hd</i>	COAXIAL	<i>CO</i>
BLUETOOTH	<i>bt</i>	AUX (AUDIO IN)	<i>AU</i>
OPTICAL	<i>OP</i>		

## LED Display Sound Mode



Selected sound mode will be displayed on the LED as below.

		Default (Music)
		3D Theater
		Bass Enhanced



## Using the HDMI (ARC) Input

- You will need an audio source with a HDMI (ARC) audio output and a HDMI (ARC) audio cable (not included).
- Connect the HDMI (ARC) audio cable to the HDMI (ARC) on the audio source and the HDMI ARC input on the Soundbar.
- Use the  button on the Soundbar or remote control to switch on the unit.
- Press the  /  buttons repeatedly on the remote control to switch to HDMI ARC mode or press the **M** button repeatedly on the Soundbar.
- Using the controls on your connected device, make sure the audio settings are set to ARC or HDMI audio. Audio from the connected audio source will now be played through the Soundbar.

## Using the Optical or Coaxial Input

- Use an optical or coaxial cable (an optical cable has been included) to connect the optical/coaxial output on the audio source and the optical / coaxial input on the Soundbar.
- Use the  button on the Soundbar or remote control to switch on the unit.
- Press the  /  buttons repeatedly on the remote control to switch to optical/coaxial mode or press the **M** button repeatedly on the Soundbar.
- Using the controls on your connected device, make sure the audio settings are set to PCM or optical audio. Audio from the connected audio source will now be played through the Soundbar.

## Using the AUX (AUDIO IN) Input

- Use the supplied 3.5mm to RCA cable to connect the AUX output on the audio source and the AUDIO IN inputs on the Soundbar.
- Use the  button on the Soundbar or remote control to switch on the unit.
- Press the  /  buttons repeatedly on the remote control to switch to AUX (AUDIO IN) mode or press the **M** button repeatedly on the Soundbar.
- Audio played through the connected device can now be heard through the speakers.



# Bluetooth® Playback

Function	Action
Volume increase	Press to the <b>+</b> button on the Soundbar or press the <b>+</b> button on the remote control.
Volume decrease	Press to the <b>-</b> button on the Soundbar or press the <b>-</b> button on the remote control.
Play/Pause	Press <b>▶  </b> on the remote or Soundbar.
Skip/Rewind	Press and hold the <b>+</b> / <b>-</b> buttons on the Soundbar or <b>&lt;/&gt;</b> buttons on the remote control.
Un-pair a Bluetooth® device	Press and hold the <b>✂</b> button on the remote for 3 seconds.

# Troubleshooting

Problem	Solution
No power	<ul style="list-style-type: none"><li>• Ensure that the power adaptor is properly connected.</li><li>• Ensure that there is power at the AC outlet.</li><li>• Press and hold the <b>⏻</b> button on the Soundbar or <b>⏻</b> button on the remote to turn the Soundbar on.</li></ul>
Remote control does not work	<ul style="list-style-type: none"><li>• Use the remote control closer to the Soundbar. Aim directly at the sensor on the front of the Soundbar.</li><li>• Insert the battery with its polarities (+/-) aligned as indicated. Please check the battery is installed correctly.</li><li>• Replace the battery.</li></ul>
No response from the Soundbar	<ul style="list-style-type: none"><li>• Disconnect and reconnect the power adaptor, then turn the Soundbar on again.</li></ul>
Soundbar not found in the Bluetooth device list when pairing	<ul style="list-style-type: none"><li>• Ensure you have unpaired the previously paired Bluetooth device from the Soundbar.</li><li>• Ensure the Bluetooth function is activated on your Bluetooth enabled device.</li></ul>
General sound issues	<ul style="list-style-type: none"><li>• Make sure the Soundbar is connected to power and turned on, and that it's set to the correct mode; use the <b>M</b> button on the Soundbar or <b>▲</b> / <b>▼</b> buttons on the remote to change the input mode.</li><li>• If only a specific input mode is not working, it's likely the setting is wrong or the cable used is not working.</li></ul>
No sound from Netflix/other apps	<ul style="list-style-type: none"><li>• Go to the TV settings menu, find Audio Output settings, and change the audio output mode to 'PCM' mode (instead of Auto, RAW, etc.).</li></ul>

Problem	Solution
No sound in HDMI ARC mode	<ul style="list-style-type: none"> <li>• Make sure the input source is set to HDMI ARC; the LED will display 'HDMI'.</li> <li>• Make sure your TV or external device supports ARC function and connect the HDMI cable to the ARC port of the TV or external device.</li> <li>• In the TV or external device setting menu, turn on the ARC function and the CEC function.</li> <li>• In the TV or external device setting menu, find the audio output settings and change the audio output mode to 'PCM' mode (instead of Auto, RAW, etc.).</li> <li>• Make sure both ends of the HDMI cable are fully plugged into the sockets.</li> <li>• If none of these solutions work, try changing the HDMI cable.</li> </ul>
No sound in Optical/ Coaxial mode	<ul style="list-style-type: none"> <li>• Make sure the input source is set to the correct mode; the LED will display 'OPT' or 'CO'.</li> <li>• Increase the volume of the Soundbar to make sure it's not muted.</li> <li>• In the TV or external device settings menu, find the audio output settings and change the audio output mode to 'PCM' mode (instead of Auto, RAW, etc.).</li> <li>• For optical, make sure you remove the small caps on either end of the optical cable, and both ends are fully plugged into the sockets.</li> <li>• If none of these solutions work, try changing the optical or coaxial cable.</li> </ul>
No sound in BT mode	<ul style="list-style-type: none"> <li>• Increase the volume of the Soundbar to make sure it's not muted. Make sure Bluetooth is connected successfully - once connected, the LED will display 'BT'.</li> <li>• Make sure the external Bluetooth device is playing normally and its volume is turned up.</li> </ul>
No sound in AUX (AUDIO IN) mode	<ul style="list-style-type: none"> <li>• Make sure the LED screen is displaying 'AUX'. Turn up the volume on the Soundbar.</li> <li>• Turn up the volume on the external device and make sure it's not paused or muted.</li> <li>• Make sure the audio cable is properly plugged in at both ends.</li> </ul>

# Compliance and Responsible Disposal



## Packaging

The packaging of your product has been selected from environmentally friendly materials and can usually be recycled. Please ensure these are disposed of correctly. Plastic wrapping can be a suffocation hazard for babies and young children, please ensure all packaging materials are out of reach and are safely disposed of. Please recycle these materials rather than throwing them away.

## Product

At the end of its working life, do not throw this product out with your household rubbish. An environmentally friendly method of disposal will ensure that valuable raw materials can be recycled. Electrical and electronic items contain materials and substances which, if handled or disposed of incorrectly, could potentially be hazardous to the environment and human health.