

# TI/TIKKENS

## Active Stylus Pen



### User Manual / Handleiding

#### Product Details

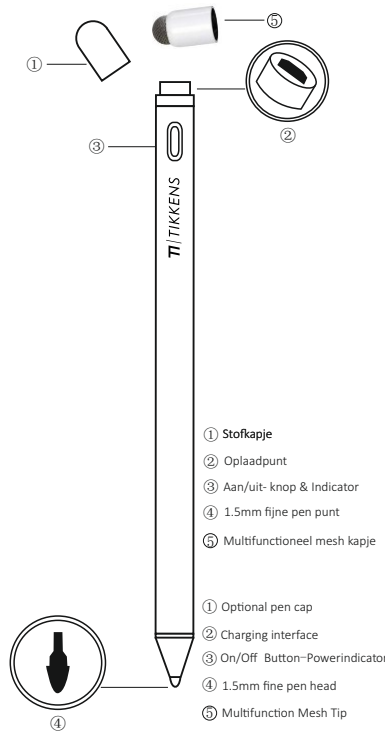

#### Product Specificaties / Product Specifications

Model NO / Model nr. : TISP01  
Material / Materiaal : Aluminium alloy / Aluminium  
Input : 5V-0.2A  
Color / Kleur : Black / White- Zwart / Wit  
Compatible with Capacitive touchscreen devices  
Compatibel met Capacitieve touch screen apparaten

#### Product Eigenschappen

1. Stijlvolle & minimalistische stylus pen met een aluminium Legering. Duurzaam en ergonomisch design.
2. De pen punt bestaat uit hoog geleidend, zacht materiaal. Dit zorgt voor een gladde punt die schade voorkomt.
3. Compatibel met 99% van alle capacitieve touch screen apparaten.
4. De Tikkens stylus pen gaat tot 12h mee.

#### Product Features

1. Stylish and minimalist style, aluminum alloy with piano baking varnish, calm and luxurious, novel and durable.
2. The pen tips are made of pure copper and polished. Artificially create a smooth pen tip to prevent damage to the screen
3. Products compatible with iPad 2018 after model (specific model to see product parameters) can be written, painted, recorded
4. The product lasts for up to 12 hours at full power and does not use automatic power cut for 5 minutes.

#### Apple - Instructies voor gebruik / Instructions

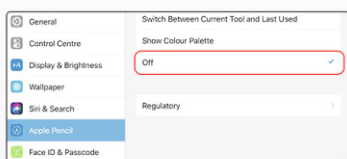

1. Go to Settings > Apple Pencil > Turn off the Apple Pencil.

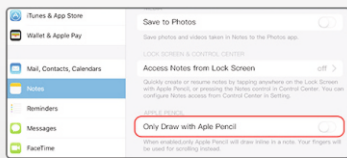

2. Settings > Notes > Turn off "Only Draw with Apple Pencil."

Open settings-memo-turn off the apple pencil doodle function;  
Turn on Settings-Bluetooth and close the connection of the original Apple Pen.

Open het instellingen menu en schakel de Apple pencil optie uit;  
Schakel de bluetooth functie in en sluit de connectie met de originele Apple Pen.

#### Instructies / Instructions

1. Please press the button directly on the top of the pen, the blue light will quickly turn on, the active capacitive pen enters into the working mode.
1. Druk op de knop van de pen om de pen in te schakelen.

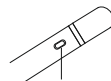

On/Off Button Power Indicator  
Aan/Uit knop & power indicator

2. Start drawing!
2. Start met tekenen



3. When you press the button again, the capacitive pen shuts down.
3. Druk op de knop van de pen om de pen uit te schakelen.

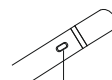

On/Off Button Power Indicator  
Aan/Uit knop & power indicator

#### Opladen / Charging

