

THE SNOOT SCRAPER

USER MANUAL

THE TRIMMER

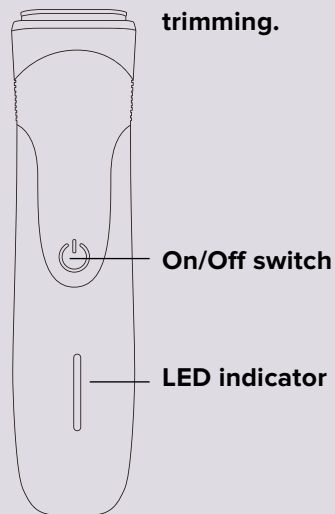
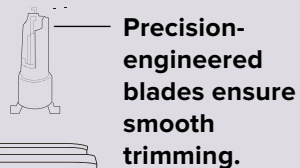
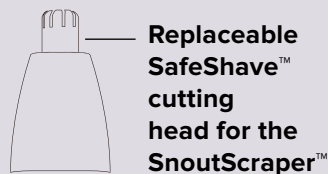

Designed in Amsterdam,
produced in China.

CHARGING

To get the most out of your SnoutScraper™ experience, fully charge your trimmer before the first use by plugging the USB-C adapter in any USB plug.

It takes about 2 hours to fully charge your SnoutScraper™ trimmer.

The LED light indicates the following:

Red light: Plugged in and charging.

White light: Turned on.

- Charge only when you have to. Do not overcharge. It will lower your battery quality.
- Do NOT plug in the USB cable with wet hands or when the device or cable is wet.
- Do not twist, stretch, bend, pull or damage the charging cable.

HOW TO USE

Make sure the device is disconnected from the charger before you use it.

Step 1: Turn the SnoutScraper™ trimmer on.

Step 2: Slowly and carefully move the head of your SnoutScraper™ into your nose or ear and make sure not to press any skin. Also do not overspeed or push in your trimmer too deep.

Step 3: You can hear and feel any hairs being cut. They will fall out of your nose or ear (so clean your bathroom afterwards)

Step 4: Turn off your SnoutScraper™ trimmer and clean your cutting head.

SAFESHAVE™ TECHNOLOGY IS NO GUARANTEE FOR RESULTS. MAKE SURE TO PRACTICE CAUTION AND GET TO KNOW YOUR DEVICE BEFORE YOU PROCEED. BALZY™ IS NOT LIABLE FOR ANY DAMAGE MADE BY MISUSING THE TRIMMER.

TYPE:
SNOOTSCRAPER
ZP- 889

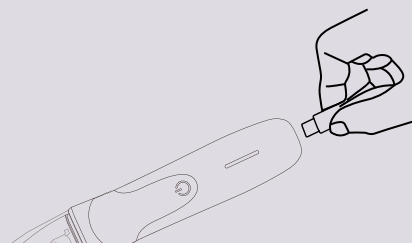

CLEANING

Make sure that the device is turned off and not plugged into the charger before you remove the cutting head. Ignoring this may damage your cutting head.

Step 1: Hold the cutting head firmly and rotate counter-clockwise. Pull the cutting head upwards to remove it from the SnoutScraper™.



Step 2: Blow out any hairs and rinse under running water.



Step 3: Put the cleaned cutting head back on the device and turn clockwise to fasten it to the SnoutScraper™.

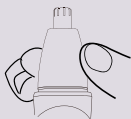

Step 4: Wipe your SnoutScraper™ dry with your towel or cloth.

REPLACE HEAD

Replacing the cutting head
Make sure that the device is turned off and not plugged into the charger before you remove the cutting head. Ignoring this may damage your cutting head.

Step 1: Hold the cutting head firmly and rotate counter-clockwise. Pull the cutting head upwards to remove it from the SnoutScraper™.



Step 2: Put the new cutting head back on the device and turn clockwise to fasten it to the SnoutScraper™.



Step 3: Dispose of your old cutting head safely.

Tip: To ensure a comfortable trimming experience and to keep up with hygienic standards we advise you to replace your cutting heads every 3 months.

CAUTION

- The SnoutScraper™ is a personal hygienic device. Do not use it on kids or animals. Give them a treat instead.
- Keep the SnoutScraper™ trimmer out of reach of children.
- Stop using the SnoutScraper™ trimmer immediately if the blade frame or blades are damaged.
- The SnoutScraper™ is engineered specifically for nose and ear hair. Do not use it for any other purpose.
- Do not use any solvents, thinners or other chemicals to clean the trimmer.

We're more than happy to answer any questions regarding the Snoutscraper

(or our other products)

support@balzygrooming.com
or check [balzygrooming.com](https://www.balzygrooming.com)

BALZY