

A

B

C

D

2 x

E

F

G

H

I

5 x

J

8 x M8 x 20

K

4 x M8 x 25

L

2 x

M

4 x

N

O

1

Diagram 1 shows the assembly of the base plate (E) with casters (I). A cylinder (G) is inserted into the base plate, followed by another cylinder (H). The casters (I) are then attached to the bottom of the base plate.

3

Diagram 3 shows the seat backrest (A) being attached to the seat base (B). Screws (K) are used to secure the backrest to the base. An L-shaped bracket (N) is also shown being attached to the backrest.

2

Diagram 2 shows the backrest mounting plate (F) being attached to the seat backrest (A). Screws (J) are used to secure the plate. A circular inset shows a close-up of the mounting plate with a 'FRONT' arrow indicating orientation. The plate is then attached to the seat base (B) using screws (C).

4

Diagram 4 shows the final assembly of the chair. The seat base (B) is attached to the base plate (E) using screws (L) and washers (M). The armrests (D) are attached to the seat base using screws (L) and washers (M). The L-shaped brackets (O) are attached to the seat base. The final assembly is shown with the seat backrest (A) and base plate (E) attached to the seat base (B).



RESTO | Gaming Chair

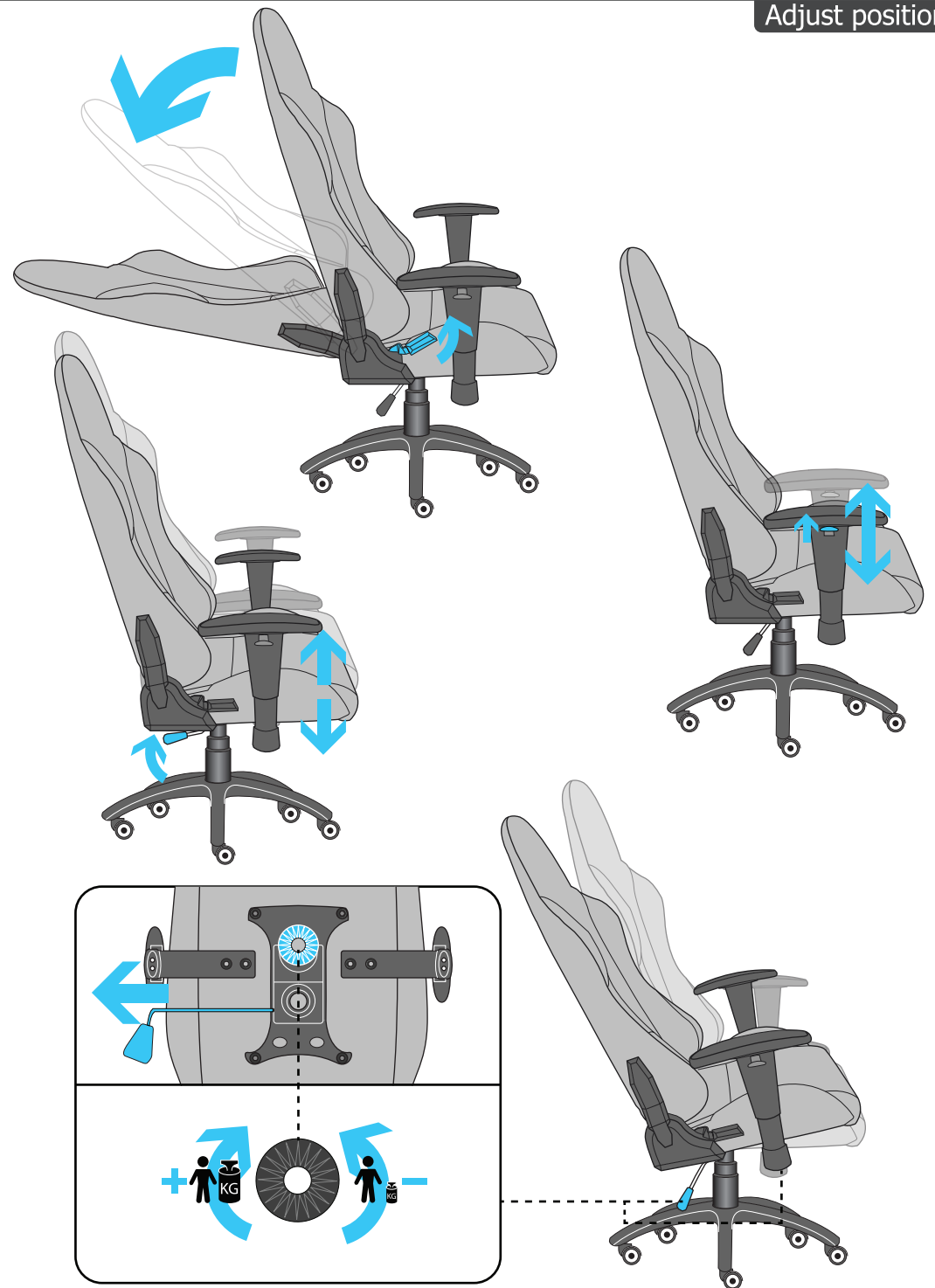

FAQ: www.trust.com/22692/faq