

GRAPHICS CARD INSTALLATION

01
Power Off the computer. Unplug the cable(s) connected to the system, and remove any existing discrete graphics card(s).

02
Remove the system case cover and locate the PCI Express x16 slot on the motherboard. Please refer to your motherboard specifications.

03
Remove the expansion slot cover(s) for the available slot(s) where the graphics card will be installed.

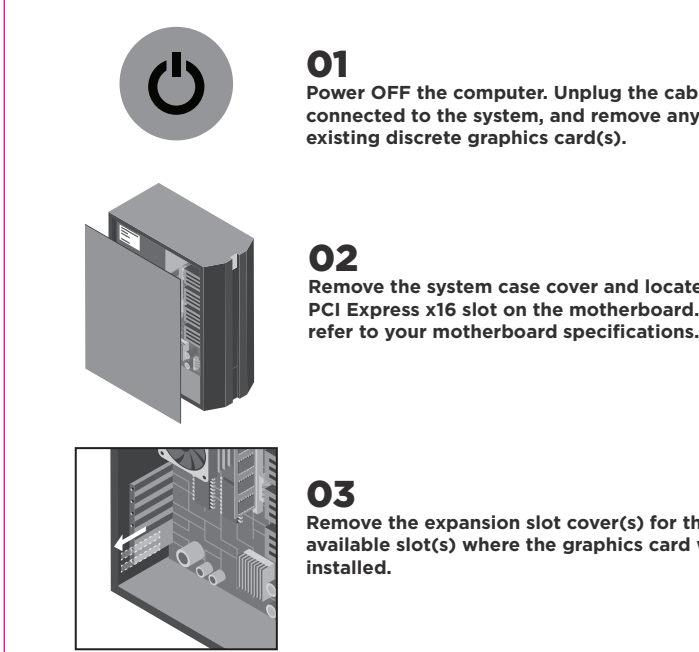

GRAPHICS CARD INSTALLATION

04/05
Insert the card firmly into the expansion slot. Secure the graphics card using the system case screw(s).

06
Connect any required PCI-e power cable(s) from the system power supply to the graphics card. Power requirements may vary by graphics card model.

NOTE: The graphics card requires more than one 8-pin power cable. It is recommended to use separate 8-pin cables to maintain voltage stability.

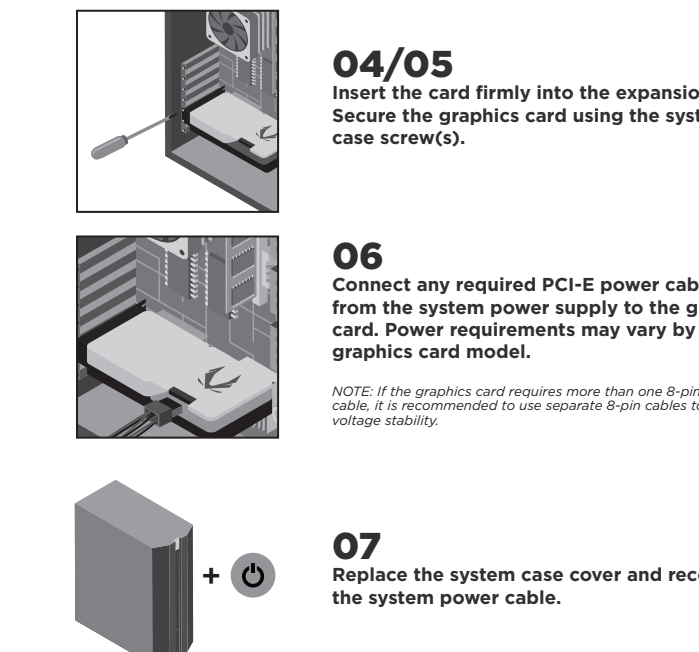

GEFORCE DRIVER INSTALLATION

PLEASE MAKE SURE TO HAVE THE LATEST AVAILABLE DRIVERS INSTALLED FOR YOUR ZOTAC GAMING GEFORCE GRAPHICS CARD FOR OPTIMAL GAMING PERFORMANCE.

NOTE: The latest GeForce Drivers are available at GEFORCE.com. An Internet connection is required to proceed.



DRIVER DOWNLOAD

1) Scan the above QR code to go to the NVIDIA GEFORCE™ Drivers website or enter the URL into your system's internet browser - <https://www.geforce.com/drivers>

2) Follow the onscreen menu to download the GeForce drivers for your graphics card model and OS.

3) Locate the downloaded file on your system and double click it to begin the installation process.

4) Follow the on-screen instructions to complete the installation and restart the system once done.

CONNECT A MONITOR

CONNECTING A DISPLAY TO THE GRAPHICS CARD



MORE YOU NEED TO KNOW

ZOTAC.COM



USEFUL LINKS

PRODUCT REGISTRATION
Register your new product on ZOTAC.COM to get FREE extended product warranty where applicable. Product registration must be successfully submitted within a limited time of new product purchase. Availability and window of time for product registration may vary by product and region.

FIRESTORM UTILITY
Our advanced fine-tuning software utilizes a simplified design to allow easy and immersive control of your ZOTAC and ZOTAC GAMING graphics cards. Monitor GPU performance, adjust the speed of clock, memory and fan, customize fan profile as well as SPECTRA RGB lighting, and do much more.

SUPPORT/CONTACT US
Need any help with your ZOTAC products? Please go to our Support page to find the answers, or simply contact us so we can provide the needed support.

Failure to follow the warranty terms and conditions will result in an automatic void of the ZOTAC warranty. The warranty does not cover normal wear and tear items such as the cooling fan.

Under no circumstances is ZOTAC Technology Ltd. held liable for any lost wages or revenues incurred due to defective or damaged products. ZOTAC Technology Ltd. does not provide any additional warranty for its products except as stated in the warranty terms, whether by implication or merchant liability.

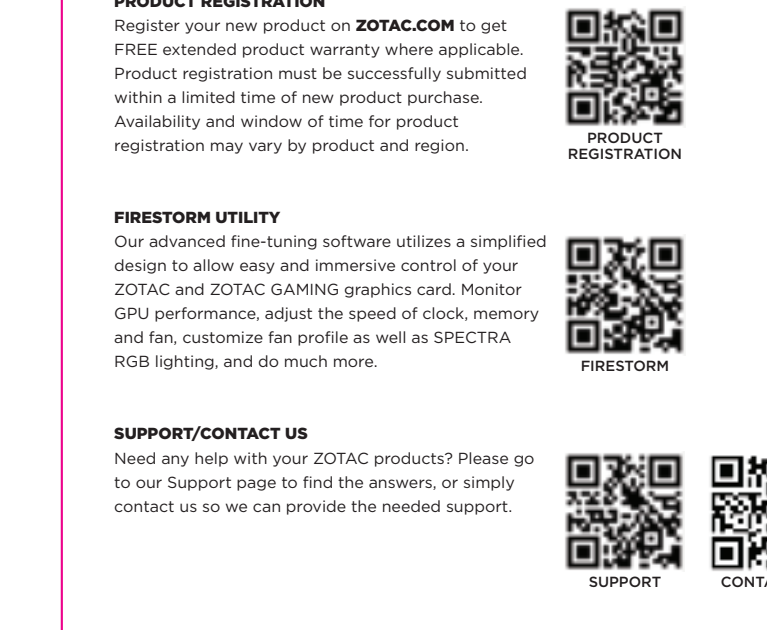

快機安裝指南

基本安裝
1. 關閉主機電源，斷掉連接主機的電線，並斷下與主機內部的任何插卡。
2. 取下系統機殼，找到安裝圖示的 PCI Express x16 插槽，並將主機殼安裝板拆下。
3. 將主機殼安裝板重新安裝到主機殼上。
4. 將主機殼安裝板重新安裝到主機殼上。
5. 將主機殼安裝板重新安裝到主機殼上。
6. 將主機殼安裝板重新安裝到主機殼上。
7. 將主機殼安裝板重新安裝到主機殼上。
8. 將主機殼安裝板重新安裝到主機殼上。
9. 將主機殼安裝板重新安裝到主機殼上。
10. 將主機殼安裝板重新安裝到主機殼上。

安裝 GeForce 驅動程序
請前往 www.geforce.com 下載並安裝最新驅動程序。請前往 www.geforce.com 網站下載、複製提取才能繼續安裝。

快機安裝指南
1. 關閉主機電源，斷掉連接主機的電線，並斷下與主機內部的任何插卡。
2. 取下系統機殼，找到安裝圖示的 PCI Express x16 插槽，並將主機殼安裝板拆下。
3. 將主機殼安裝板重新安裝到主機殼上。
4. 將主機殼安裝板重新安裝到主機殼上。
5. 將主機殼安裝板重新安裝到主機殼上。
6. 將主機殼安裝板重新安裝到主機殼上。
7. 將主機殼安裝板重新安裝到主機殼上。
8. 將主機殼安裝板重新安裝到主機殼上。
9. 將主機殼安裝板重新安裝到主機殼上。
10. 將主機殼安裝板重新安裝到主機殼上。

NOTE: The latest GeForce Drivers are available at GEFORCE.com. An Internet connection is required to proceed.



GUIDE D'INSTALLATION RAPIDE

INSTALLATION DE LA CARTE GRAPHIQUE
1. Éteignez l'ordinateur et débranchez les câbles de l'alimentation et de la terre. Retirez également les cartes d'extension existantes de la carte mère.
2. Retirez le couvercle de votre PC et localisez le slot PCI Express x16 sur la carte mère.
3. Retirez le couvercle de votre PC et localisez le slot PCI Express x16 sur la carte mère.
4. Retirez le couvercle de votre PC et localisez le slot PCI Express x16 sur la carte mère.
5. Retirez le couvercle de votre PC et localisez le slot PCI Express x16 sur la carte mère.
6. Retirez le couvercle de votre PC et localisez le slot PCI Express x16 sur la carte mère.
7. Retirez le couvercle de votre PC et localisez le slot PCI Express x16 sur la carte mère.
8. Retirez le couvercle de votre PC et localisez le slot PCI Express x16 sur la carte mère.
9. Retirez le couvercle de votre PC et localisez le slot PCI Express x16 sur la carte mère.
10. Retirez le couvercle de votre PC et localisez le slot PCI Express x16 sur la carte mère.

INSTALACIÓN DE LA TARJETA GRÁFICA
1. Apague el ordenador y desconecte los cables de alimentación y de tierra. Retire también las tarjetas de expansión existentes de la placa base.
2. Retire la tapa del ordenador y localice el slot PCI Express x16 en la placa base.
3. Retire la tapa del ordenador y localice el slot PCI Express x16 en la placa base.
4. Retire la tapa del ordenador y localice el slot PCI Express x16 en la placa base.
5. Retire la tapa del ordenador y localice el slot PCI Express x16 en la placa base.
6. Retire la tapa del ordenador y localice el slot PCI Express x16 en la placa base.
7. Retire la tapa del ordenador y localice el slot PCI Express x16 en la placa base.
8. Retire la tapa del ordenador y localice el slot PCI Express x16 en la placa base.
9. Retire la tapa del ordenador y localice el slot PCI Express x16 en la placa base.
10. Retire la tapa del ordenador y localice el slot PCI Express x16 en la placa base.

快機安裝指南
1. 關閉主機電源，斷掉連接主機的電線，並斷下與主機內部的任何插卡。
2. 取下系統機殼，找到安裝圖示的 PCI Express x16 插槽，並將主機殼安裝板拆下。
3. 將主機殼安裝板重新安裝到主機殼上。
4. 將主機殼安裝板重新安裝到主機殼上。
5. 將主機殼安裝板重新安裝到主機殼上。
6. 將主機殼安裝板重新安裝到主機殼上。
7. 將主機殼安裝板重新安裝到主機殼上。
8. 將主機殼安裝板重新安裝到主機殼上。
9. 將主機殼安裝板重新安裝到主機殼上。
10. 將主機殼安裝板重新安裝到主機殼上。

NOTE: The latest GeForce Drivers are available at GEFORCE.com. An Internet connection is required to proceed.



GEFORCE DRIVER INSTALLATION

PLEASE MAKE SURE TO HAVE THE LATEST AVAILABLE DRIVERS INSTALLED FOR YOUR ZOTAC GAMING GEFORCE GRAPHICS CARD FOR OPTIMAL GAMING PERFORMANCE.

NOTE: The latest GeForce Drivers are available at GEFORCE.com. An Internet connection is required to proceed.



DRIVER DOWNLOAD

1) Scan the above QR code to go to the NVIDIA GEFORCE™ Drivers website or enter the URL into your system's internet browser - <https://www.geforce.com/drivers>

2) Follow the onscreen menu to download the GeForce drivers for your graphics card model and OS.

3) Locate the downloaded file on your system and double click it to begin the installation process.

4) Follow the on-screen instructions to complete the installation and restart the system once done.

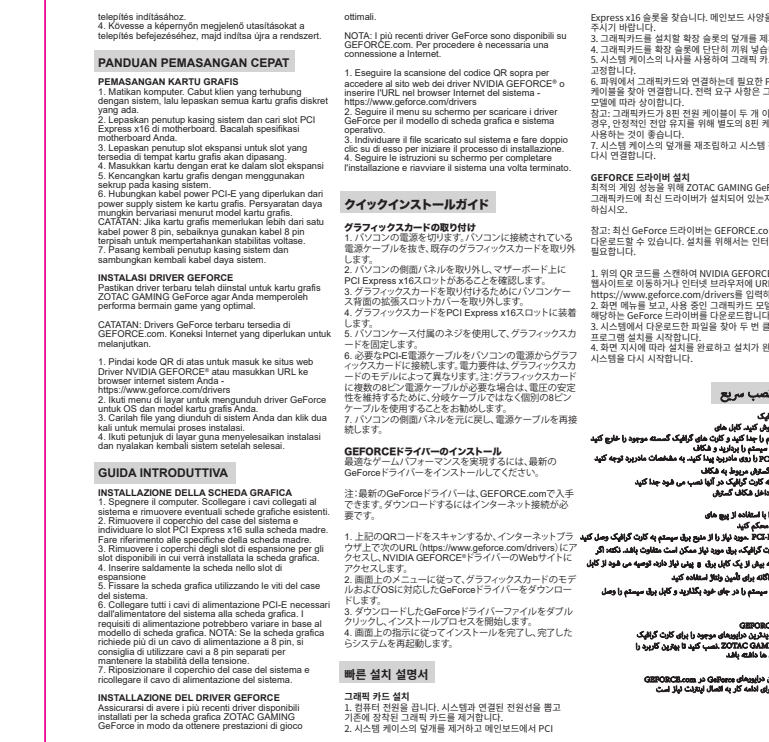

快機安裝指南

基本安裝
1. 關閉主機電源，斷掉連接主機的電線，並斷下與主機內部的任何插卡。
2. 取下系統機殼，找到安裝圖示的 PCI Express x16 插槽，並將主機殼安裝板拆下。
3. 將主機殼安裝板重新安裝到主機殼上。
4. 將主機殼安裝板重新安裝到主機殼上。
5. 將主機殼安裝板重新安裝到主機殼上。
6. 將主機殼安裝板重新安裝到主機殼上。
7. 將主機殼安裝板重新安裝到主機殼上。
8. 將主機殼安裝板重新安裝到主機殼上。
9. 將主機殼安裝板重新安裝到主機殼上。
10. 將主機殼安裝板重新安裝到主機殼上。

安裝 GeForce 驅動程序
請前往 www.geforce.com 下載並安裝最新驅動程序。請前往 www.geforce.com 網站下載、複製提取才能繼續安裝。

快機安裝指南
1. 關閉主機電源，斷掉連接主機的電線，並斷下與主機內部的任何插卡。
2. 取下系統機殼，找到安裝圖示的 PCI Express x16 插槽，並將主機殼安裝板拆下。
3. 將主機殼安裝板重新安裝到主機殼上。
4. 將主機殼安裝板重新安裝到主機殼上。
5. 將主機殼安裝板重新安裝到主機殼上。
6. 將主機殼安裝板重新安裝到主機殼上。
7. 將主機殼安裝板重新安裝到主機殼上。
8. 將主機殼安裝板重新安裝到主機殼上。
9. 將主機殼安裝板重新安裝到主機殼上。
10. 將主機殼安裝板重新安裝到主機殼上。

NOTE: The latest GeForce Drivers are available at GEFORCE.com. An Internet connection is required to proceed.

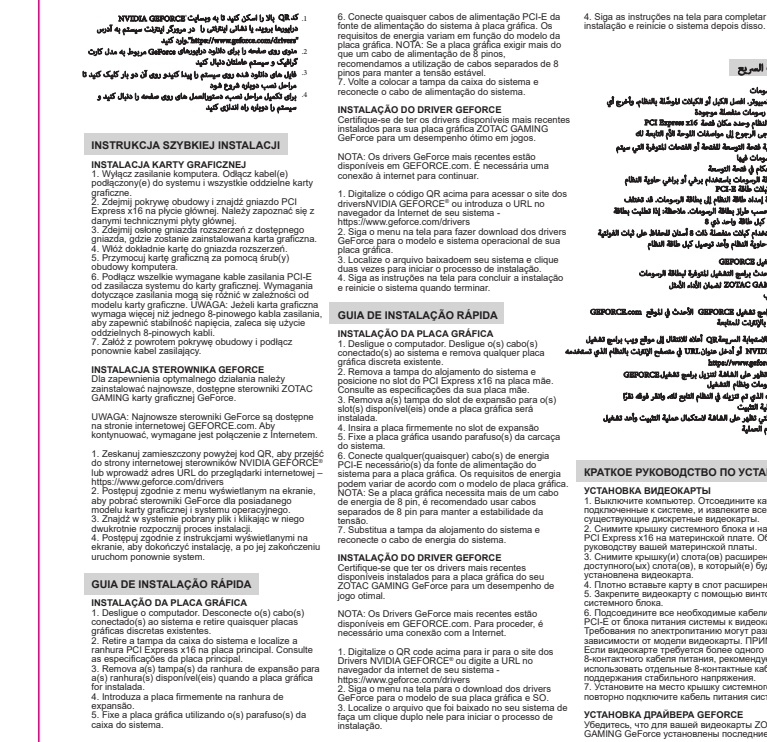

快機安裝指南

基本安裝
1. 關閉主機電源，斷掉連接主機的電線，並斷下與主機內部的任何插卡。
2. 取下系統機殼，找到安裝圖示的 PCI Express x16 插槽，並將主機殼安裝板拆下。
3. 將主機殼安裝板重新安裝到主機殼上。
4. 將主機殼安裝板重新安裝到主機殼上。
5. 將主機殼安裝板重新安裝到主機殼上。
6. 將主機殼安裝板重新安裝到主機殼上。
7. 將主機殼安裝板重新安裝到主機殼上。
8. 將主機殼安裝板重新安裝到主機殼上。
9. 將主機殼安裝板重新安裝到主機殼上。
10. 將主機殼安裝板重新安裝到主機殼上。

安裝 GeForce 驅動程序
請前往 www.geforce.com 下載並安裝最新驅動程序。請前往 www.geforce.com 網站下載、複製提取才能繼續安裝。

快機安裝指南
1. 關閉主機電源，斷掉連接主機的電線，並斷下與主機內部的任何插卡。
2. 取下系統機殼，找到安裝圖示的 PCI Express x16 插槽，並將主機殼安裝板拆下。
3. 將主機殼安裝板重新安裝到主機殼上。
4. 將主機殼安裝板重新安裝到主機殼上。
5. 將主機殼安裝板重新安裝到主機殼上。
6. 將主機殼安裝板重新安裝到主機殼上。
7. 將主機殼安裝板重新安裝到主機殼上。
8. 將主機殼安裝板重新安裝到主機殼上。
9. 將主機殼安裝板重新安裝到主機殼上。
10. 將主機殼安裝板重新安裝到主機殼上。

NOTE: The latest GeForce Drivers are available at GEFORCE.com. An Internet connection is required to proceed.

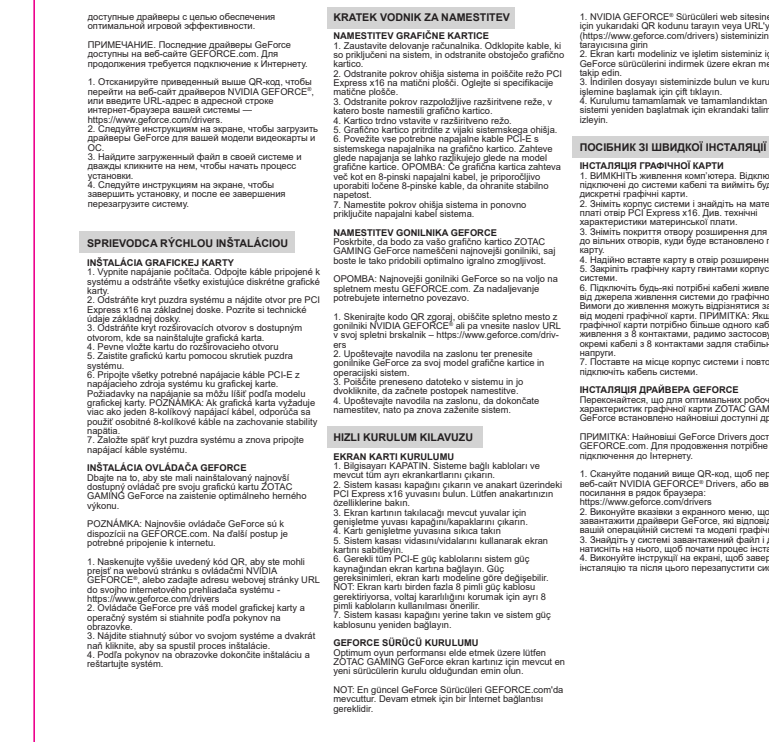

WARRANTY

EXTENDED WARRANTY
ZOTAC products come with a standard warranty period. In addition, customers will be entitled to extended product warranty through an online product registration process within a limited time of new product purchase where applicable. ZOTAC reserves the right to change the terms and conditions without advance notice.

The ZOTAC warranty is only applicable under the following conditions:
• A copy of the original sales receipt is kept.
• Damage to the product was not due to user installation.
• User did not damage the product, including abuse, over-clocking, natural disaster, negligence, misuse, modifications (cooling included), power supply, damage due to the result of other damaged components, etc.
• Product was used for its intended purpose.

All warranty conditions and terms are subject to change without prior notice. For current warranty details, please check our online policies at ZOTAC.COM

NOTE!
ZOTAC Technology Ltd. reserves the right to void the warranty if:
• The product is physically modified, unless otherwise stated.
• If user purchased the card second hand.
• If user fails to produce a copy of the original sales receipt.
• User used the product in a way it was not intended for.

Failure to follow the warranty terms and conditions will result in an automatic void of the ZOTAC warranty. The warranty does not cover normal wear and tear items such as the cooling fan.

Under no circumstances is ZOTAC Technology Ltd. held liable for any lost wages or revenues incurred due to defective or damaged products. ZOTAC Technology Ltd. does not provide any additional warranty for its products except as stated in the warranty terms, whether by implication or merchant liability.



WARRANTY

EXTENDED WARRANTY
ZOTAC products come with a standard warranty period. In addition, customers will be entitled to extended product warranty through an online product registration process within a limited time of new product purchase where applicable. ZOTAC reserves the right to change the terms and conditions without advance notice.

The ZOTAC warranty is only applicable under the following conditions:
• A copy of the original sales receipt is kept.
• Damage to the product was not due to user installation.
• User did not damage the product, including abuse, over-clocking, natural disaster, negligence, misuse, modifications (cooling included), power supply, damage due to the result of other damaged components, etc.
• Product was used for its intended purpose.

All warranty conditions and terms are subject to change without prior notice. For current warranty details, please check our online policies at ZOTAC.COM

NOTE!
ZOTAC Technology Ltd. reserves the right to void the warranty if:
• The product is physically modified, unless otherwise stated.
• If user purchased the card second hand.
• If user fails to produce a copy of the original sales receipt.
• User used the product in a way it was not intended for.

Failure to follow the warranty terms and conditions will result in an automatic void of the ZOTAC warranty. The warranty does not cover normal wear and tear items such as the cooling fan.

Under no circumstances is ZOTAC Technology Ltd. held liable for any lost wages or revenues incurred due to defective or damaged products. ZOTAC Technology Ltd. does not provide any additional warranty for its products except as stated in the warranty terms, whether by implication or merchant liability.

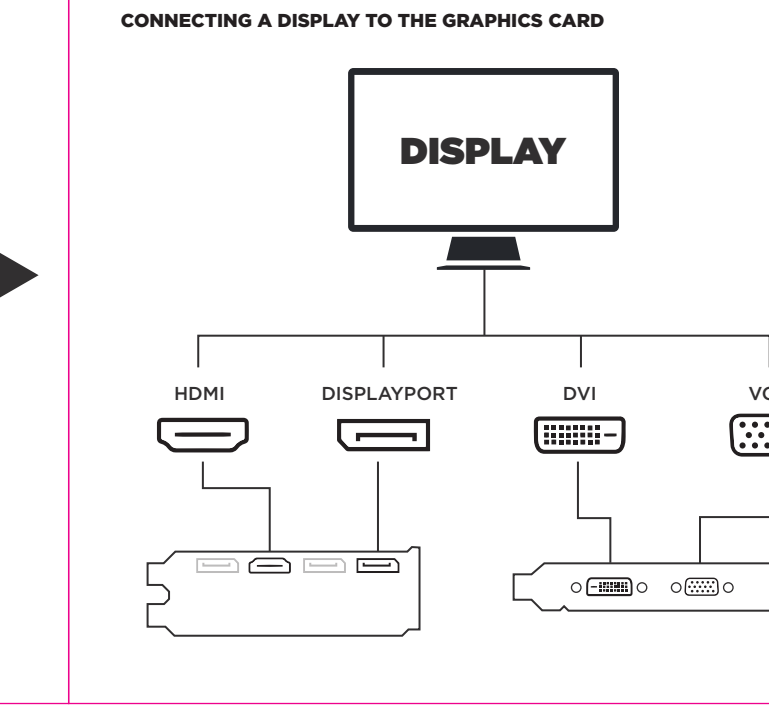

WARRANTY

EXTENDED WARRANTY
ZOTAC products come with a standard warranty period. In addition, customers will be entitled to extended product warranty through an online product registration process within a limited time of new product purchase where applicable. ZOTAC reserves the right to change the terms and conditions without advance notice.

The ZOTAC warranty is only applicable under the following conditions:
• A copy of the original sales receipt is kept.
• Damage to the product was not due to user installation.
• User did not damage the product, including abuse, over-clocking, natural disaster, negligence, misuse, modifications (cooling included), power supply, damage due to the result of other damaged components, etc.
• Product was used for its intended purpose.

All warranty conditions and terms are subject to change without prior notice. For current warranty details, please check our online policies at ZOTAC.COM

NOTE!
ZOTAC Technology Ltd. reserves the right to void the warranty if:
• The product is physically modified, unless otherwise stated.
• If user purchased the card second hand.
• If user fails to produce a copy of the original sales receipt.
• User used the product in a way it was not intended for.

Failure to follow the warranty terms and conditions will result in an automatic void of the ZOTAC warranty. The warranty does not cover normal wear and tear items such as the cooling fan.

Under no circumstances is ZOTAC Technology Ltd. held liable for any lost wages or revenues incurred due to defective or damaged products. ZOTAC Technology Ltd. does not provide any additional warranty for its products except as stated in the warranty terms, whether by implication or merchant liability.



WARRANTY

EXTENDED WARRANTY
ZOTAC products come with a standard warranty period. In addition, customers will be entitled to extended product warranty through an online product registration process within a limited time of new product purchase where applicable. ZOTAC reserves the right to change the terms and conditions without advance notice.

The ZOTAC warranty is only applicable under the following conditions:
• A copy of the original sales receipt is kept.
• Damage to the product was not due to user installation.
• User did not damage the product, including abuse, over-clocking, natural disaster, negligence, misuse, modifications (cooling included), power supply, damage due to the result of other damaged components, etc.
• Product was used for its intended purpose.

All warranty conditions and terms are subject to change without prior notice. For current warranty details, please check our online policies at ZOTAC.COM

NOTE!
ZOTAC Technology Ltd. reserves the right to void the warranty if:
• The product is physically modified, unless otherwise stated.
• If user purchased the card second hand.
• If user fails to produce a copy of the original sales receipt.
• User used the product in a way it was not intended for.

Failure to follow the warranty terms and conditions will result in an automatic void of the ZOTAC warranty. The warranty does not cover normal wear and tear items such as the cooling fan.

Under no circumstances is ZOTAC Technology Ltd. held liable for any lost wages or revenues incurred due to defective or damaged products. ZOTAC Technology Ltd. does not provide any additional warranty for its products except as stated in the warranty terms, whether by implication or merchant liability.

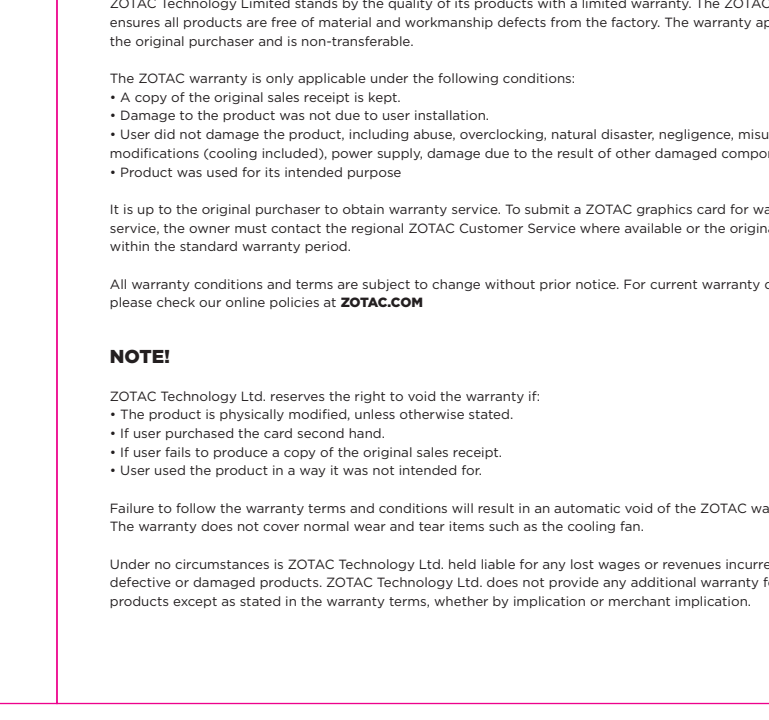

WARRANTY

EXTENDED WARRANTY
ZOTAC products come with a standard warranty period. In addition, customers will be entitled to extended product warranty through an online product registration process within a limited time of new product purchase where applicable. ZOTAC reserves the right to change the terms and conditions without advance notice.

The ZOTAC warranty is only applicable under the following conditions:
• A copy of the original sales receipt is kept.
• Damage to the product was not due to user installation.
• User did not damage the product, including abuse, over-clocking, natural disaster, negligence, misuse, modifications (cooling included), power supply, damage due to the result of other damaged components, etc.
• Product was used for its intended purpose.

All warranty conditions and terms are subject to change without prior notice. For current warranty details, please check our online policies at ZOTAC.COM

NOTE!
ZOTAC Technology Ltd. reserves the right to void the warranty if:
• The product is physically modified, unless otherwise stated.
• If user purchased the card second hand.
• If user fails to produce a copy of the original sales receipt.
• User used the product in a way it was not intended for.

Failure to follow the warranty terms and conditions will result in an automatic void of the ZOTAC warranty. The warranty does not cover normal wear and tear items such as the cooling fan.

Under no circumstances is ZOTAC Technology Ltd. held liable for any lost wages or revenues incurred due to defective or damaged products. ZOTAC Technology Ltd. does not provide any additional warranty for its products except as stated in the warranty terms, whether by implication or merchant liability.

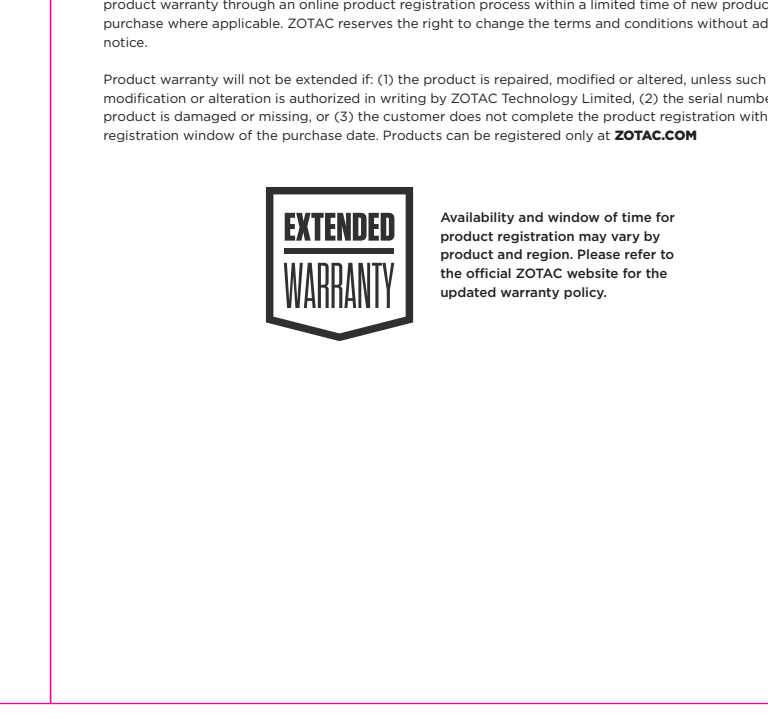

WARRANTY

EXTENDED WARRANTY
ZOTAC products come with a standard warranty period. In addition, customers will be entitled to extended product warranty through an online product registration process within a limited time of new product purchase where applicable. ZOTAC reserves the right to change the terms and conditions without advance notice.

The ZOTAC warranty is only applicable under the following conditions:
• A copy of the original sales receipt is kept.
• Damage to the product was not due to user installation.
• User did not damage the product, including abuse, over-clocking, natural disaster, negligence, misuse, modifications (cooling included), power supply, damage due to the result of other damaged components, etc.
• Product was used for its intended purpose.

All warranty conditions and terms are subject to change without prior notice. For current warranty details, please check our online policies at ZOTAC.COM

NOTE!
ZOTAC Technology Ltd. reserves the right to void the warranty if:
• The product is physically modified, unless otherwise stated.
• If user purchased the card second hand.
• If user fails to produce a copy of the original sales receipt.
• User used the product in a way it was not intended for.

Failure to follow the warranty terms and conditions will result in an automatic void of the ZOTAC warranty. The warranty does not cover normal wear and tear items such as the cooling fan.

Under no circumstances is ZOTAC Technology Ltd. held liable for any lost wages or revenues incurred due to defective or damaged products. ZOTAC Technology Ltd. does not provide any additional warranty for its products except as stated in the warranty terms, whether by implication or merchant liability.

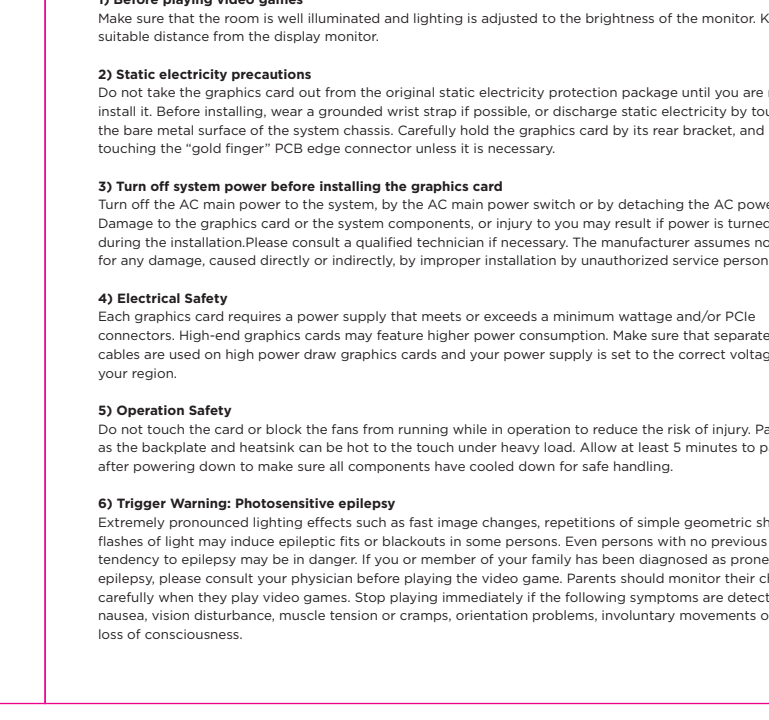

WARRANTY

EXTENDED WARRANTY
ZOTAC products come with a standard warranty period. In addition, customers will be entitled to extended product warranty through an online product registration process within a limited time of new product purchase where applicable. ZOTAC reserves the right to change the terms and conditions without advance notice.

The ZOTAC warranty is only applicable under the following conditions:
• A copy of the original sales receipt is kept.
• Damage to the product was not due to user installation.
• User did not damage the product, including abuse, over-clocking, natural disaster, negligence, misuse, modifications (cooling included), power supply, damage due to the result of other damaged components, etc.
• Product was used for its intended purpose.

All warranty conditions and terms are subject to change without prior notice. For current warranty details, please check our online policies at ZOTAC.COM

NOTE!
ZOTAC Technology Ltd. reserves the right to void the warranty if:
• The product is physically modified, unless otherwise stated.
• If user purchased the card second hand.
• If user fails to produce a copy of the original sales receipt.
• User used the product in a way it was not intended for.

Failure to follow the warranty terms and conditions will result in an automatic void of the ZOTAC warranty. The warranty does not cover normal wear and tear items such as the cooling fan.

Under no circumstances is ZOTAC Technology Ltd. held liable for any lost wages or revenues incurred due to defective or damaged products. ZOTAC Technology Ltd. does not provide any additional warranty for its products except as stated in the warranty terms, whether by implication or merchant liability.

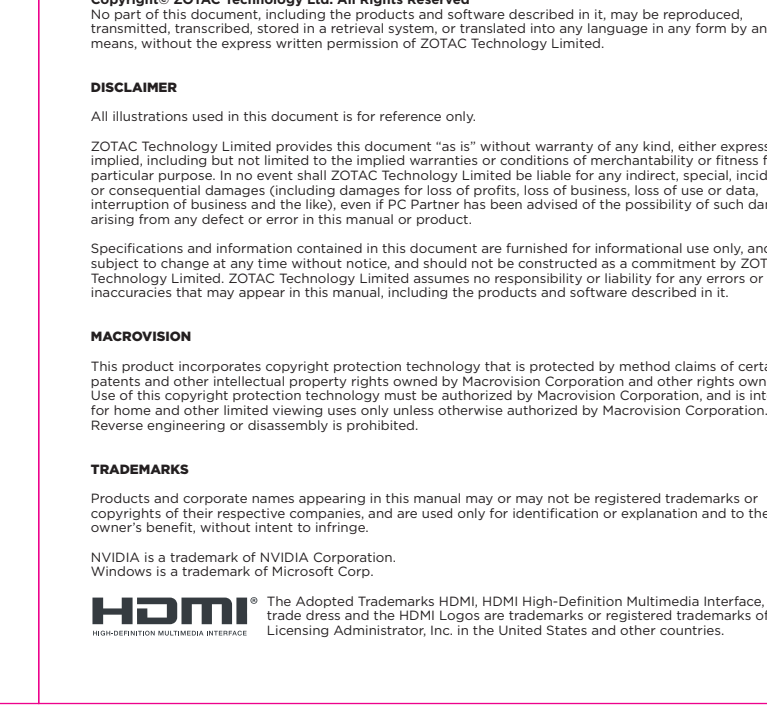

WARRANTY

EXTENDED WARRANTY
ZOTAC products come with a standard warranty period. In addition, customers will be entitled to extended product warranty through an online product registration process within a limited time of new product purchase where applicable. ZOTAC reserves the right to change the terms and conditions without advance notice.

The ZOTAC warranty is only applicable under the following conditions:
• A copy of the original sales receipt is kept.
• Damage to the product was not due to user installation.
• User did not damage the product, including abuse, over-clocking, natural disaster, negligence, misuse, modifications (cooling included), power supply, damage due to the result of other damaged components, etc.
• Product was used for its intended purpose.

All warranty conditions and terms are subject to change without prior notice. For current warranty details, please check our online policies at ZOTAC.COM

NOTE!
ZOTAC Technology Ltd. reserves the right to void the warranty if:
• The product is physically modified, unless otherwise stated.
• If user purchased the card second hand.
• If user fails to produce a copy of the original sales receipt.
• User used the product in a way it was not intended for.

Failure to follow the warranty terms and conditions will result in an automatic void of the ZOTAC warranty. The warranty does not cover normal wear and tear items such as the cooling fan.

Under no circumstances is ZOTAC Technology Ltd. held liable for any lost wages or revenues incurred due to defective or damaged products. ZOTAC Technology Ltd. does not provide any additional warranty for its products except as stated in the warranty terms, whether by implication or merchant liability.

