

<p><b>Double Stand</b> Wrench 1-15</p> <p>Apply pressure on the wrench and the lock cylinder will rotate. The lock cylinder will rotate and the pins will be pushed up. The lock cylinder will rotate and the pins will be pushed up. The lock cylinder will rotate and the pins will be pushed up.</p>	<p><b>Double Stand</b> Wrench 1-15</p> <p>Apply pressure on the wrench and the lock cylinder will rotate. The lock cylinder will rotate and the pins will be pushed up. The lock cylinder will rotate and the pins will be pushed up. The lock cylinder will rotate and the pins will be pushed up.</p>	<p><b>Double Stand</b> Wrench 1-15</p> <p>Apply pressure on the wrench and the lock cylinder will rotate. The lock cylinder will rotate and the pins will be pushed up. The lock cylinder will rotate and the pins will be pushed up. The lock cylinder will rotate and the pins will be pushed up.</p>	<p><b>Double Stand</b> Wrench 1-15</p> <p>Apply pressure on the wrench and the lock cylinder will rotate. The lock cylinder will rotate and the pins will be pushed up. The lock cylinder will rotate and the pins will be pushed up. The lock cylinder will rotate and the pins will be pushed up.</p>	<p><b>Double Stand</b> Wrench 1-15</p> <p>Apply pressure on the wrench and the lock cylinder will rotate. The lock cylinder will rotate and the pins will be pushed up. The lock cylinder will rotate and the pins will be pushed up. The lock cylinder will rotate and the pins will be pushed up.</p>
---	---	---	---	---

1

**Statement:**  
The content is only for reference and shall not be used for other purposes.

\* First, you must know well the structure of padlock. The padlock has 7 pins inside the lock cylinder (the first pin remains stationary). The inner pin is fixed as a lock core. The theory of unlocking is to keep other 6 pins to remain horizontal and then leave the lock cylinder simultaneously. In such a process, what is particularly important is to try the final suitable force repeatedly and make it act on the wrench (along correction direction of lock's natural rotation) with the suitable force, which will ensure the pins after adjustment not to return to the previous position, adjust the position of each pin one by one, keep them on a horizontal level, then twist the lock cylinder and open the lock.

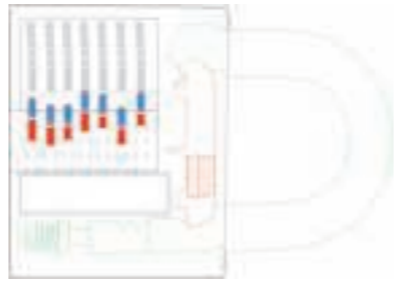

2

2. Hold the lock by left hand, act the force on the wrench with one or two fingers, take a lock tool, hold the lock by left hand and twist the wrench with the fingers gently. When the position of pin A reaches the position of red-line B, it can stay still, which will be deemed as a suitable force. At this time, remember your feeling as it is a force you need. Keep two hands with suitable force and speed. You must wait with patience. You need to look how the pins of padlock control the lock tools.

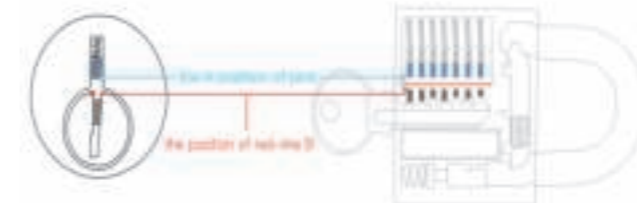

3

3. You need practice for many times. When it is used for the first time, you may need to find how long you can still need to open the lock. However, through practice for several times, you can open the lock within 1 or 2 seconds and you need not look at the pins and the padlock during the opening. By then, you can learn how to open other locks.

**Schematic diagram for torque**

Apply rotating pressure on torque tool and make the lock cylinder in a pressure rotating state, which will make the pin be kept in correct position. It will keep the pins of unlocking in correct positions



Move the A position of pins to the red-line B, adjust the pins one by one from inside to outside (when you are skilled in operating, you can adjust more pins at the same time). As the lock cylinder is kept at the position as shown in Figure by wrench torque, the pins are clipped at C point so as to ensure A position of pins to be overlapped with the red-line B. Adjust the position of pins one by one and open the lock finally.

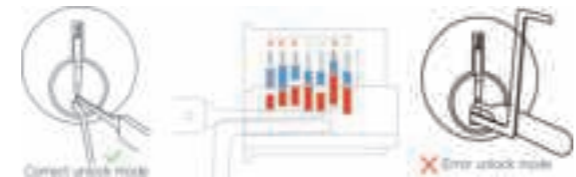

4

The skill of unlocking is just to simulate a key to eject all the pins from A position to the red-line B position with the tool.

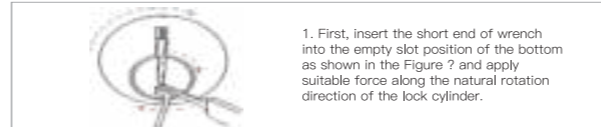

1. First, insert the short end of wrench into the empty slot position of the bottom as shown in the Figure 7 and apply suitable force along the natural rotation direction of the lock cylinder.

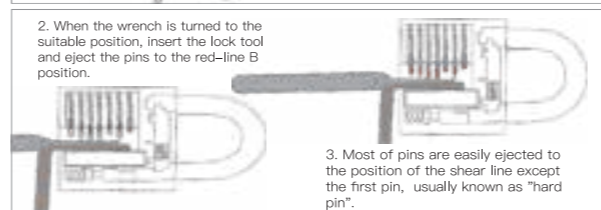

2. When the wrench is turned to the suitable position, insert the lock tool and eject the pins to the red-line B position.

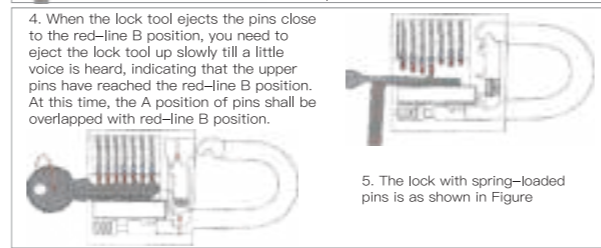

3. Most of pins are easily ejected to the position of the shear line except the first pin, usually known as "hard pin".

4. When the lock tool ejects the pins close to the red-line B position, you need to eject the lock tool up slowly till a little voice is heard, indicating that the upper pins have reached the red-line B position. At this time, the A position of pins shall be overlapped with red-line B position.

5



6. When the key is inserted into the lock, the pins will be pushed up. The lock cylinder is allowed to be turned.

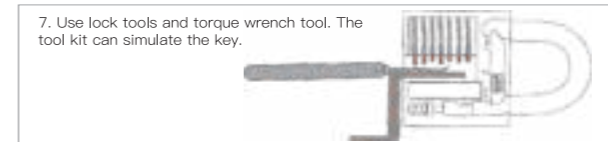

7. Use lock tools and torque wrench tool. The tool kit can simulate the key.

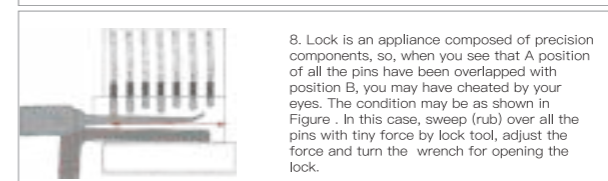

8. Lock is an appliance composed of precision components, so, when you see that A position of all the pins have been overlapped with position B, you may have cheated by your eyes. The condition may be as shown in Figure . In this case, sweep (rub) over all the pins with tiny force by lock tool, adjust the force and turn the wrench for opening the lock.

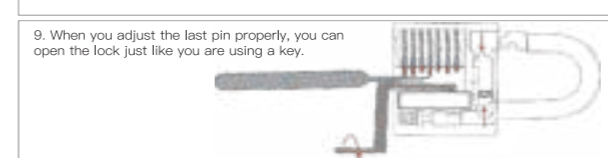

9. When you adjust the last pin properly, you can open the lock just like you are using a key.

6