

Kids Mini Electric scooter User Manual



Caution: Please read the user manual before riding.

Beginner need to be accompanied by parents or adults to practice cycling in pen space. The operator can ride independently only after mastering the kinetic energy and riding skills of the scooter.

Scooter spare parts

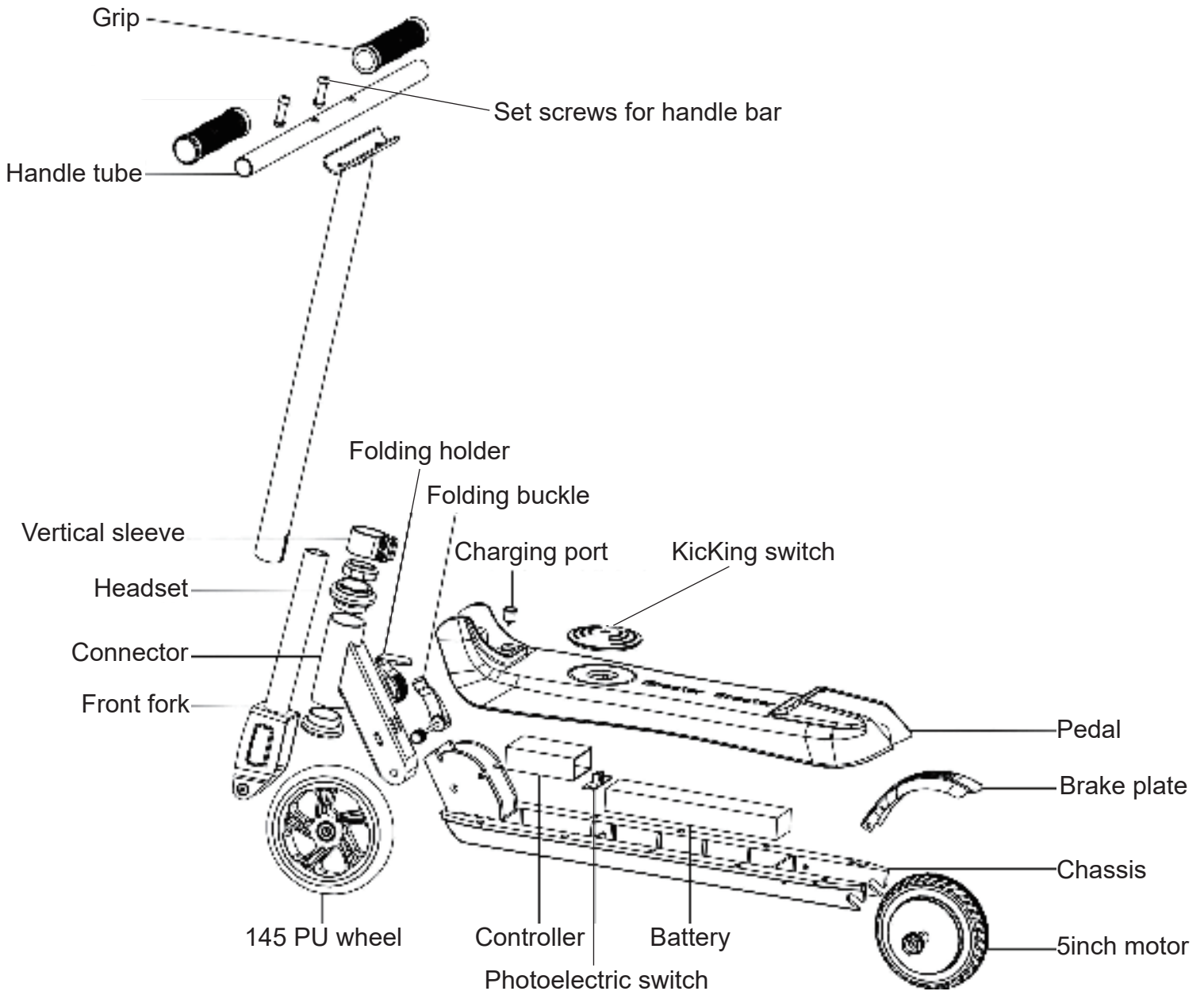

◆ Product folding procedure illustration

1. Unfold instruction

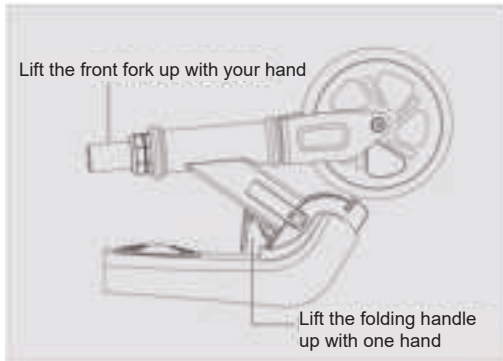

Lift the folding handle up with one hand and lift the front fork tube with another hand, and hear a "click"



Press the folding lock firmly (the folding lock can adjust the tightness)



2. Folding instruction

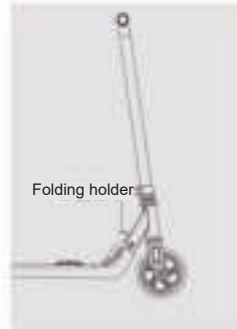

Loosen the buckle

Lift the folding handle up with one hand and pull the standpipe back gently with another hand. Complete the folding when hearing a "click"

Folded

◆ Riding operating instruction

Hold the handle with both hands and gently push it forward. When you hear a "drop", the power of scooter is turned on.

The buzzer emits a "drop" sound, the specific meaning is as follows:

- a. When the scooter is stationary, push it gently and send a "drop" to indicate that the power is on.
- b. When one foot is accelerating, emits a "drop" sound, indicating that the motor is started, and the other foot can be placed on the pedal.
- c. During the riding process, one foot presses the rear wheel brake and sends a "drop", indicating that the motor stops working.
- d. If the scooter emits a continuous sound of "drops, drops, drops", indicating that the battery is low, please charge the scooter in time.

2. Hold the handle with both hands, put one foot on the foot switch, and the other foot pedal back to accelerate. When you hear the "drop" sound, you can put the other foot on the pedal.
3. If you need to slow down, please use one foot to step on the rear wheel brake. Release the brake plate when speed slow down to the desired speed, the scooter continues to travel at the current speed.
4. If you need to stop, please use one foot to step on the rear wheel brake plate. After hearing the "drop", continue to step on the brake plate until the car stops, and the foot leaves the pedal to complete the stop.

Note: during in the middle of operating scooter, one leg is required to step on the power switch. Stationary 10 seconds automatic disconnecting power supply. When leaving the riding switch, the electric motor will not start, the motor will not start when it is off the ground, and the motor drive will be involved when the speed of the taxiing reaches 4 km.

◆ Safety instructions

1. This product is an electric power-assisted scooter for children. It is restricted to one child. It should not be used by adults or two people at the same time. Children must be accompanied by parents or adults when using electric-assisted scooters.
2. When riding this product, please wear a safety helmet and other protective equipment.
3. Do not ride this product in places where it is unsafe such as motor vehicles.

4. or violates regulations
5. Please practice first in the open, master the operation before driving.
6. Do not make dangerous moves or one-handed rides while the scooter is running. Keep your feet on the pedal.
7. Do not try to directly pass the step of 3 cm or more in the gap, which may cause the scooter to subvert, causing the rider to be injured or the car to be damaged; the steps below 3 cm should be avoided as much as possible.
8. When encountering rough or uneven road conditions, please slow down or get off
9. Users must adjust the height of the product to the proper position to ensure safe driving.
10. Do not ride this product on slippery surfaces such as oil or ice on the surface.
11. Do not use this product below -5 ° C
12. Do not use it in a sloping section over 5 degrees. For use over 5 degrees uphill, you need pedal assist.
13. Do not immerse the product in water depths above 5 cm to avoid damage to the electrical parts of the vehicle due to water ingress.
14. In the bad weather such as rain, snow and wind, please avoid riding as much as possible to avoid unnecessary damage caused by unnecessary factors.
15. If the product is fully charged, it will not be used for at least one month, and it must be charged at least once a month. If it is riding to no electricity (the electricity is exhausted), it must be charged once every 7 days.

◆ Battery and charger

Lithium battery

- a. When you get the electric assist scooter for the first time, please fully charge the battery before use it.
- b. Please charge immediately after the car emits a low battery warning tone to avoid damage to the battery and affect your use.
- c. When the battery is not used for a long time, please charge it at least once a month (when the battery is fully charged).
- d. If the battery is not used for a long time, the battery level is lower than the battery protection status and cannot be used. Please contact the dealer quickly.

Note: The battery is damaged due to water, collision and other abnormal factors, and is not covered by the warranty.

Charger

- e. The dedicated charger provided by the company has a charging protection function, and when the battery is 100% fully charged, it will automatically stop charging. Damage caused by other abnormal factors such as water ingress, collision, etc., is not covered by the warranty.
- f. Open the charging rubber cover on the pedal and insert the charger output connector into the charging hole.
- g. Plug the charger input power into the power socket (AC100V-240V)
- h. The charger indicator is red, indicating that it is charging; when the charger indicator turns green, the battery is fully charged.
- i. When charging the battery, please place it in a dry and ventilated environment.

◆ Maintenance

1. Wheel

This product tires use wear-resistant and non-inflatable tires. When the tires appear obvious wear or

rupture, they need to be replaced in time. Please contact the dealer to replace the original tires. Please check if the scooter has loose screws. If it is loose, please tighten it.

2. Battery

The lithium battery charging cycle is at least 500 times, and the normal use can generally reach more than 600 times. When the battery is fully charged, the mileage is only half of the factory mileage, indicating that the battery is aging, it is recommended to replace the new lithium battery.

3. Placement and daily care

Please do not leave the scooter for a long time in the hot sun or other heavily wet places; please keep the scooter clean.

◆ The scope of warranty

Under normal use, if the parts of our electric assisted scooter are in the following order during the warranty period, please contact our company or product distributor, we will provide relevant after-sales service.

Accessories	Quality issues	warranty period
Motor	The motor does not work under normal use	Six months
Controller	Controller failure under normal use	Six months
Charger	Charger failure under normal use	Six months
Lithium battery	Battery failure under normal use	Six months
Scooter body structure	Deformation, breakage, etc.cannot be used under normal use	NO

The above quality problem is free service, no maintenance fee

Note: Please use our products in the correct way. The damage and damage caused by parts under abnormal use are not covered by free maintenance.

During the warranty period, if the following reasons cause the failure, the damage is not within the scope of quality assurance:

- a. Not properly maintained and repaired in accordance with this manual
- b. Use the electric assist scooter for dangerous actions such as stunts etc, resulting in damage or malfunction.
- c. Any disassembly or use of parts outside the factory.
- d. Body and body parts damaged by mistakes, traffic accidents or accidental collisions
- e. Incomplete label, water, part number mismatch
- f. Driving on an abnormal road to damage or malfunction
- g. Commercial rental or improper use.
- h. The irresistible cause of the natural disaster
- i. Exposing this product to the sun for a long time or long-term rain, thus causing rapid aging and failure of the product.

◆ Package attachment

Attachment	Quantity
Q3 Electric-Assisted Scooter	1
Charger	1
Instruction manual	1
Spare tool	1

Note: Actual shipment product performance and parameters are subject to change without notice.

Specifications	
Model No.	Rgogo Q3
Color	Pink/yellow/blue, Customized
Speed	4-6km/h (Riding speed reach 4-6km/h the assist power starts automatically)
Maximum grade	About 5°
Maximum running distance	6±1km
Battery	Chinese battery 22.2V 2.0A
fitting age	Less than 50kg,height 100-160cm
Charger	25.2v0.5A,input 110V-240V (50~60HZ)
Charging Time	About 2h
Motor(Rear Wheel)	24V 5 inch
Front Wheel	145mm PU Wheel
Braking method	Step on the rear fender physical brake(Restart the motor again if it is stepped on)
Dimen	Scooter size About 74x36x90cm

sion	Pedal distance from the ground	About 8.5cm
	Scooter-body ground clearance	About 5cm
Weight	Net Weight	4.7kg
	Gross Weight	5.1kg
Packing		Color box + pearl cotton
Low battery protection		Turn on the "Drip, Drip, Drip" low battery alarm when the remaining battery power is about 15%
Package Size		635*138*200mm