

Product Overview

• Playbone

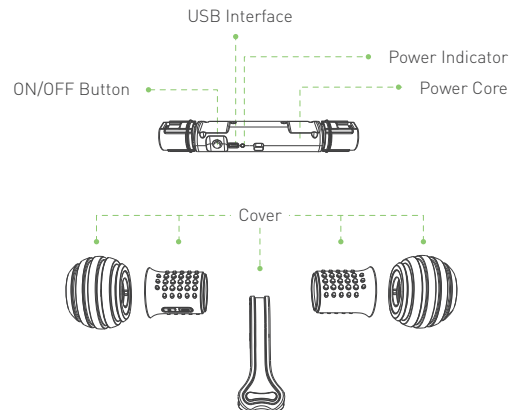

• Accessories



Tech Specs

Dimension (mm)	207 (L) × 117 (W) × 64 (H)
Weight (g)	270
Materials	PC and TPU
Working Voltage (V)	3.7
Wattage (W)	1.6

• Battery

Battery Type	Polymer Lithium-Ion Battery
Capacity (mAh)	850
Charging Time (Hours)	1.5-2
Working Time Per Charge (Hours)	2

How to start the device?

1. The charging port is on one side of the Playbone. Please remove the rubber wheel and sheath, and charge the device until the indicator light turns off;
2. Press the ON/OFF Button and the power indicator light will turn green;
3. Pat the device, put it on the floor and it will move in auto mode.

Note: Turn the device off before recharging.

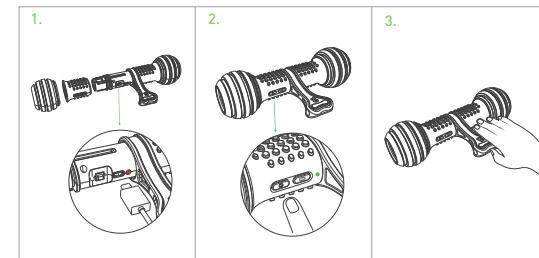

■ NOTES

1. The device is especially designed for pets. This is not a child's toy. Please keep out of reach of children except under adult supervision.
2. Not a chew toy. Do not provide it for heavy chewers. The product is an electronic device. The power is on during the charging period. It is electrically alive even if the switch is off. Please prevent your pet from chewing the USB cable to avoid electrical shock, when it is plugged in. Always unplug the device, when you always unplug the device when it is done charging.
3. The power core part is not washable, please keep it away from water.
4. Check the core of the device regularly to avoid electrical damage.
5. Recommended to use the device where the ambient temperature is between 0°C and 50°C.
6. If the exterior rubber parts are tore up, please buy our replacements with assorted colors available.

Play It to the Bone.

The logo for PETGEEK, featuring the brand name in a bold, white, sans-serif font. It is centered within a light green circle that has a thin white border. The background of the entire page is a solid green color.

PETGEEK

Playbone
User Manual