

CAT FLAP



MADE IN CHINA

Step 5. Before installing the cat door, check the actual position by comparing with the cat door and the drilling holes. After that, you can install the cat door with the screws and tighten the 4 screws. If your door is a glass door, use glass cutting tools, cut it out and fix it with the glass glue.

[Matters Need Attention]

1. If the acrylic door film is left uncut, remove it to the right side and cut the door to the right.
2. If the house door is not solid wood door or solid wood composite door, but the door is thin, please prepare a wooden strip in advance for blocking the door gap. It would be better to have some padding with foam for each hole when cutting the laminar film.
3. If the cat door you purchase has scratches, remember to have a repair for scratches when cutting the laminar film.
4. Remember to protect the acrylic board on the cat door in case of scratching.
5. If the outdoor temperature is under minus 20 degrees Celsius, please do not use the protection film on the cat door to prevent fogging.

[Cat Door Diagram]



[Product Instruction]



[Function Instruction]

A model sensor: No-to-and-by-not (only locked) / Yes-to-and (only unlocked) / No-to-and-by-not (only locked) / Yes-to-and (only unlocked)



[Installation Diagram of the Cat Door]

Tools Required: Router, Electric saw, Drill, Screwsdriver, Tape measure

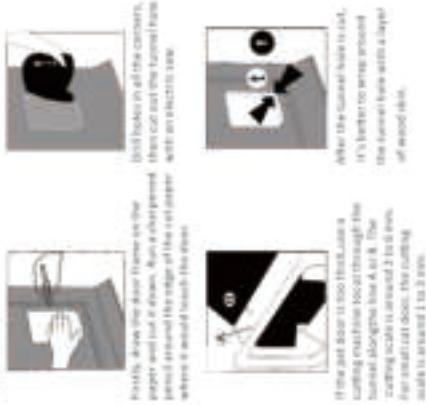

[Description]

Step 1. Before cutting the tunnel hole, check the actual position by comparing with the cat door and the drilling holes. After that, you can install the cat door with the screws and tighten the 4 screws. If your door is a glass door, use glass cutting tools, cut it out and fix it with the glass glue.

Step 2. Before cutting the tunnel hole, check the actual position by comparing with the cat door and the drilling holes. After that, you can install the cat door with the screws and tighten the 4 screws. If your door is a glass door, use glass cutting tools, cut it out and fix it with the glass glue.

Step 3. Before cutting the tunnel hole, check the actual position by comparing with the cat door and the drilling holes. After that, you can install the cat door with the screws and tighten the 4 screws. If your door is a glass door, use glass cutting tools, cut it out and fix it with the glass glue.