

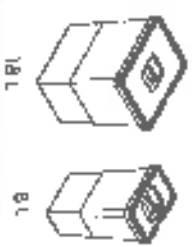

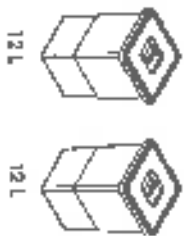
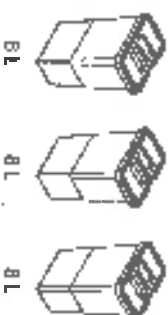
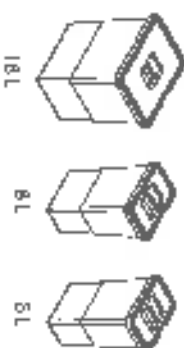
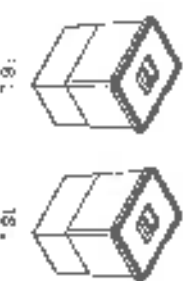
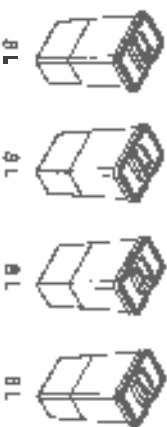
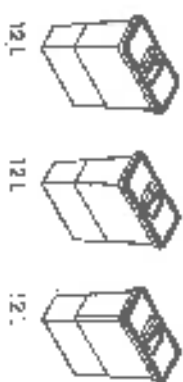

allegrini

1 9 5 4

ECCOFIL - PF01

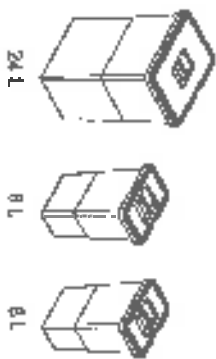
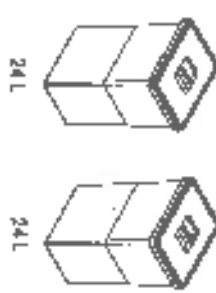
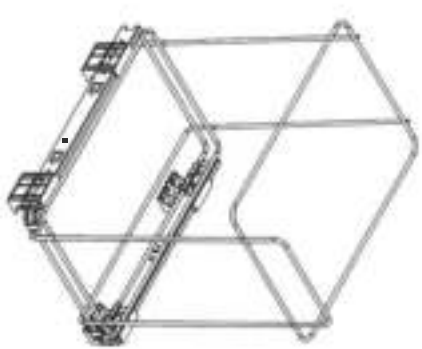
| | |
|--|--|
| <p>PF01 34A1</p>  | <p>PF01 34A2</p>  |
| <p>PF01 34A3</p>  | <p>PF01 34B1</p>  |
| <p>PF01 34B2</p>  | <p>PF01 34B3</p>  |
| <p>PF01 34B4</p>  | <p>PF01 34C1</p>  |
| <p>PF01 44B1</p>  | <p>PF01 44B2</p>  |

| | |
|---|---|
| <p>COMPONENTS - COMPONENTES - ELEMENTS</p> | |
| <p>A (X1)</p>  | <p>B (X4)</p>  |
| <p>C (variable for each model) Variable para cada referencia Variable selon le modèle</p>  | |

Base Drilling Layout - Plan de Perforación - Plan de Parçage

Place the bin in correct position as indicated and fix the 2 fronted screws.
 Ponga el cestillo en la posición correcta como se muestra y fije las 2 tornillos frontales.
 Coloque le panier à la position correcte comme indiqué et fixez les 2 vis frontales.

PRO1 34A : S1 = 200 mm, S2 = 295 mm
 PRO1 34B : S1 = 280 mm, S2 = 295 mm
 PRO1 34C : S1 = 205 mm, S2 = 90 mm
 PRO1 44B : S1 = 270 mm, S2 = 290 mm

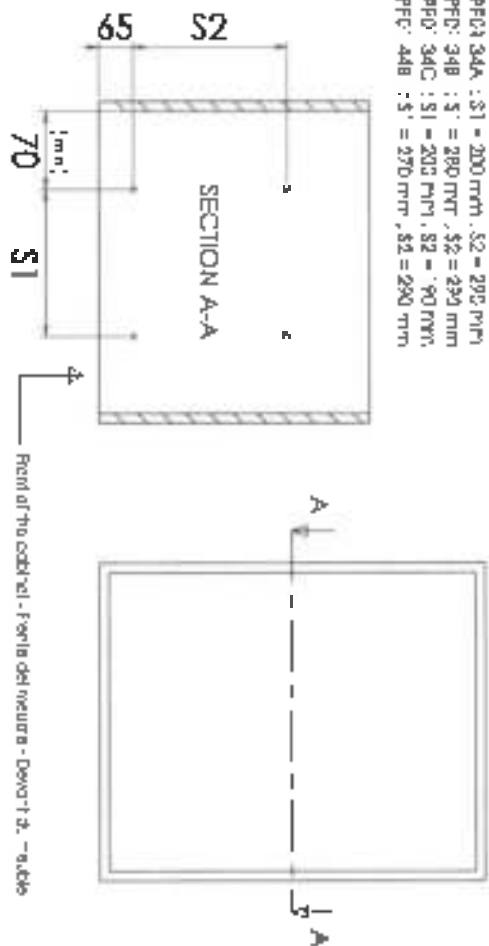

2

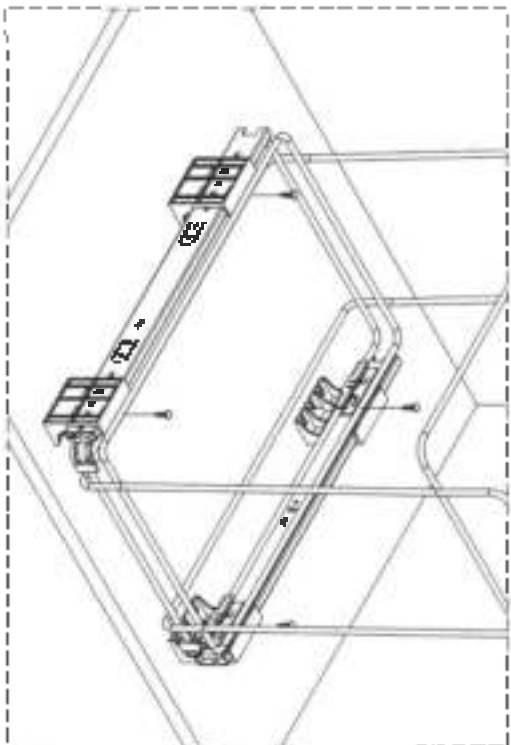

B (X4)

A (X1)

PRO1 34A

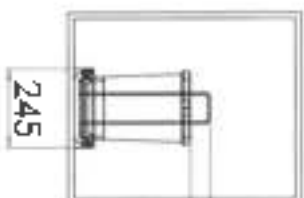
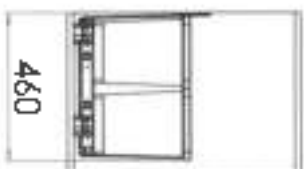
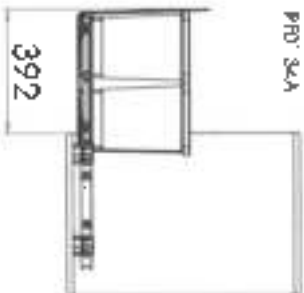

355
410

PRO1 34B

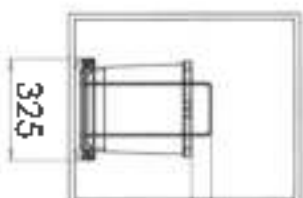
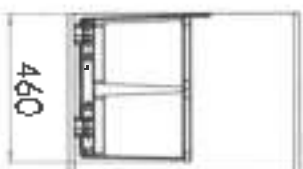
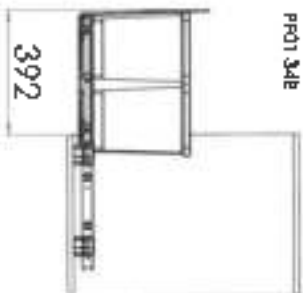

355
410

PRO1 34C

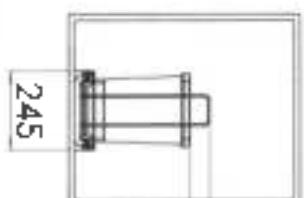
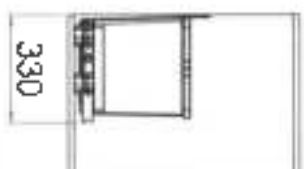
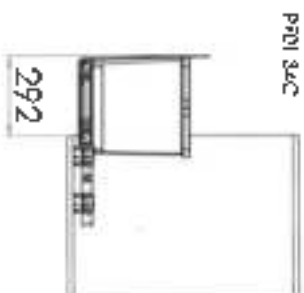

355
410

PRO1 44B

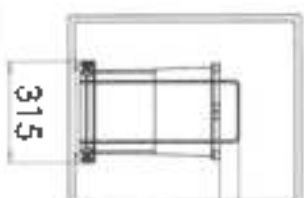
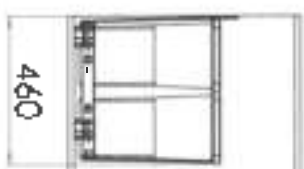

455
515