

Quick Use Guide for Window-cleaning Robot

• Installation and Use

1. Fasten one end of the safety rope climbing buckle to a strong and reliable object, and check whether the end tied to the robot is stable and reliable.



2. Insert the AC power cord plug into the power adapter slot, insert the power adapter DC plug into the host port and tighten the nut clockwise.

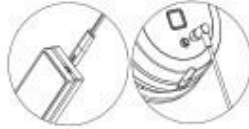

3. Insert the AC twin-core flat plug into the mains supply outlet and turn on the power supply.
 ※ When powered on, the blue light on the power supply and the green light on the robot panel (orange light when in charging status) are on simultaneously.



4. Neatly insert the cleaning cloth into the wiper ring, and then install the wiper ring to the main engine.
 ※ Make sure that the 8 clasps are installed in place to prevent air leakage from affecting the operation of the robot.

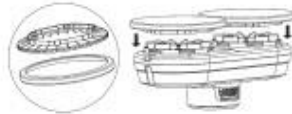

5. Fill the spray bottle with soapy water (highly recommended) or clean water, spray water evenly on the cleaning cloth until it is slightly wet (3-5 times per round).

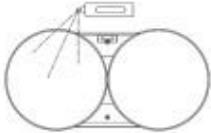

6. Place the robot on the glass, press and hold the on-off key for 3s to start the robot, and press the key again to set the robot to work or press the remote control to operate the robot.

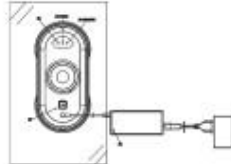

• Notes for Robot Use

1. Choice of dry wipe and wet wipe
 - 1.1 Dry wipe is suitable for dirty outdoor glass: first use dry wipe to wipe off the small particles on the surface and then use wet wipe (as there is dust on the glass, if wet wipe is used, it is easy to stain the cleaning cloth with dust and smudge the glass).
 - 1.2 Wet wipe is suitable for indoor clean glass: spray water evenly on the cleaning cloth until it is slightly wet (3-5 times per round).
2. There are several situations in which a cleaning cloth needs to be sprayed with water (slightly wet):
 - 2.1 Normal cleaning needs;
 - 2.2 The glass is too clean and the frictional resistance is low;
 - 2.3 The glass is too dirty and the frictional resistance is high;
 - 2.4 The weather is too dry and the frictional resistance between the cleaning cloth and the glass is high.
3. Daily maintenance of battery
 In order to maintain the service life of the lithium battery, please charge every 3 months to keep the battery fresh.

Instructions for the use of remote control

• Operation instructions of remote control



- ▲ Move up manually
- ◀ Move left manually
- ▶ Move right manually
- ▼ Move down manually
- OK Confirm pause
- ▲ First move up and then down to clean the glass automatically
- ◀ First move to the left and then down to clean the glass automatically
- ▶ First move to the right and then down to automatically clean the glass
- ▶|| Pause
- A Function to be developed
- B Function to be developed

• Instructions for remote control battery installation

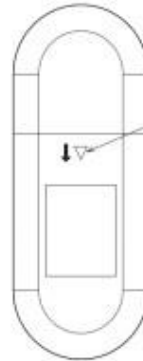

Press the position shown in the picture and push in the direction of the arrow to open the rear cover to install the battery.

Install 2 triple-A batteries according to the sign on the upper shell of the remote control.

