

Operation manual of mobile lamp

Dear user

Thank you very much for buying our products.
Read the instructions carefully before use.
Please keep it safe after reading for future reference.

Summarize

This product is made of environmental protection material,
light and beautiful.
This product is suitable for:
bar, restaurant, indoor, study and other environment

Shell material: acrylic
Switch mode: remote control switch/touch switch
Rated power: 1W
Color temperature: 2500-6500
Rated voltage: 5V
Rated current: 1A

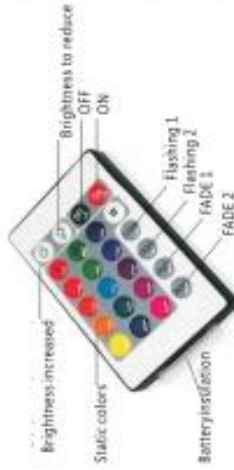
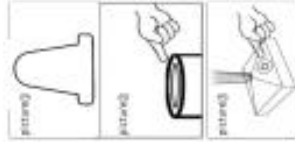

Attention:

- Lamps and lanterns should be used in a cool and ventilated environment.
- Wet paper towel or cotton cloth should be used to wipe the luminaire surface when cleaning the luminaire, and then dry cloth should be used to wipe it. Do not use corrosive liquid (such as gasoline, water, etc.) to wipe the lamp otherwise it will cause discoloration or damage.
- In the case of less use, charge the lamp every once in a while to avoid battery voltage caused by long time storage too low causes irreversible loss of capacity or damage.
- This product cannot be used on an inclined plane higher than 6°, otherwise the lamp may fall on the user's body or head after falling over, causing bodily injury.

Common troubleshooting:

- The following circumstances are caused by force majeure or other factors during logistics transportation.
- The light is not bright
Processing method: Use after charging the lamp
Check whether the insulation piece of the remote control is removed.

Directions for use:

- Before the first use please pull out the insulation at the bottom of the remote control and use it (Picture ①). Ignore this if there is no remote control. When operating, point the remote control at the product.
- Picture ② is the light fixture that can touch and remote control change color touch the top can change color light.