

4. Installation - Windows 10/8/7/Vista

Windows 8
Start here

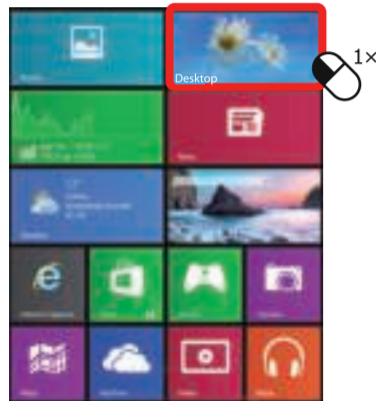

Windows 10/8/7/Vista
Start here

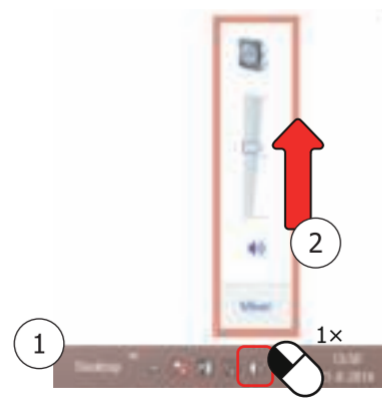

5. Other inputs

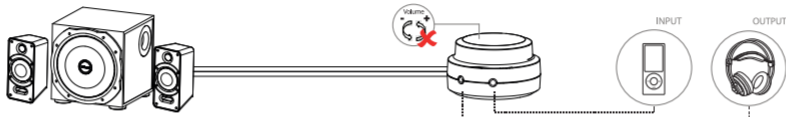

6. ECO Mode



FAQ

Frequently asked questions

<http://www.trust.com/20872/faq>

Trust

120 WATT
2.1 speaker set

BYRON



Quick Installation Guide

1. Setup

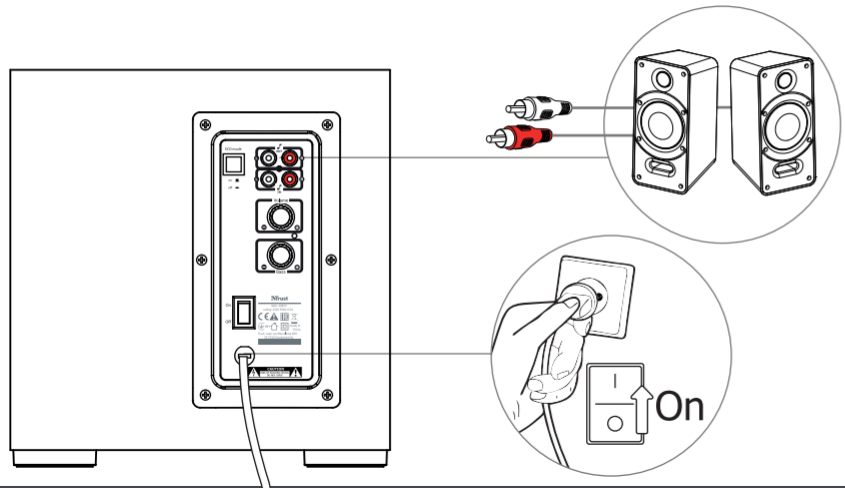

2. Connecting audio

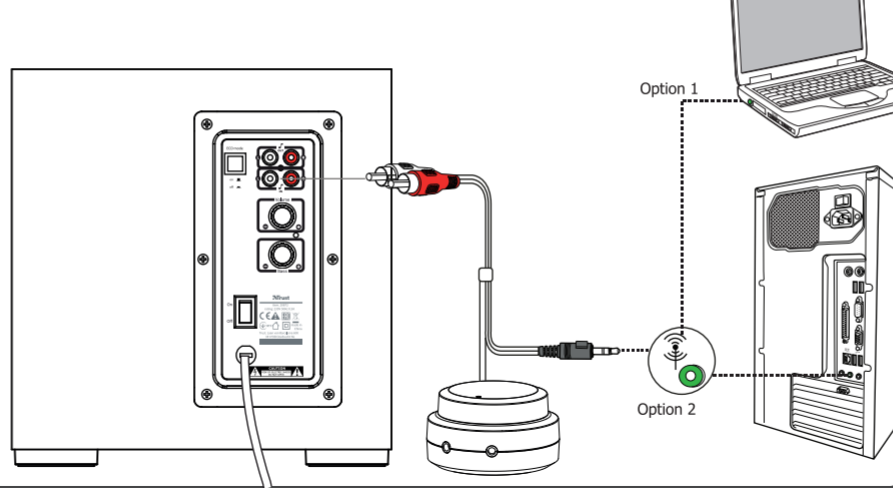

3. Volume control

