

C6497

LED ELECTRIC CALLUS REMOVER

User Manual

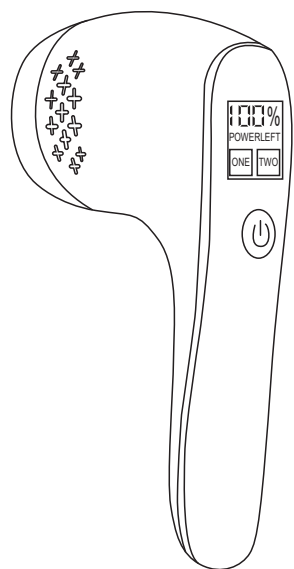

1 PRODUCT STRUCTURE INTRODUCTION

PRODUCT STRUCTURE INTRODUCTION

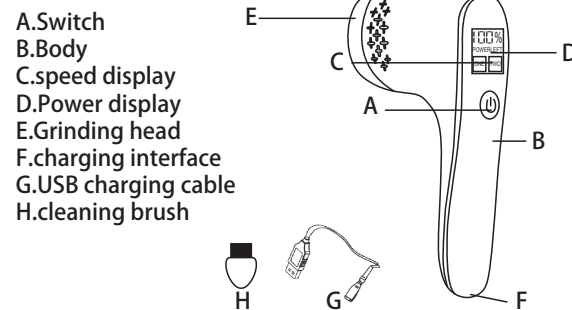

2 PRECAUTIONS

Before using the product, please read this manual carefully and keep it for future reference.

- 1.This electrical product cannot be used as a toy for young children.
- 2.Children and disabled people need the guidance of adults.
- 3.This product can only be used as a household appliance, not for industrial use.
- 4.This product cannot be used in special environments such as corrosive or explosive gases.
- 5.This product cannot be used as a medical appliance.
- 6.Do not disassemble, repair, or modify the product without permission.

01

- 7.Do not store in direct sunlight or where the storage environment is too hot or humid.
- 8.If the power cord is damaged, it must be replaced with a special component purchased from its manufacturer or repair department.
- 9.When charging, please keep away from the water source, and do not charge near water-filled baths, tubs or other liquid containers. After charging is complete, unplug it immediately.
- 10.Please use this product within the description requirements of this manual, and do not use accessories not recommended by the manufacturer.
- 11.Do not throw this product or any foreign objects into the charging socket connector, so that the product is damaged and cannot be used.
- 12.Do not immerse the charging cable in water or other liquids, and do not rinse it under the faucet.
- 13.Do not soak the product in water for a long time.
- 14.The grinding head is only suitable for calluses, hard and thick dead skin, such as heels, please do not use this product on normal skin areas.
- 15.For hygienic reasons, it is recommended that each quartz grinding wheel be used by only one person, preferably not shared with others.
- 16.If you have any skin problems or other medical problems, please use after consulting your doctor.
- 17.When using, do not stay on one skin area for more than 3 seconds, use it while moving.
- 18.Do not use on red, inflamed, infected or blistered skin.

02

- 19.Do not use this product on warts, ulcers or wounds on the skin.
- 20.Stop use immediately if you experience any pain or discomfort. Excessive use of the microdermabrasion tip will cause the skin to be too thin and easily cause skin irritation. If the skin is severely allergic or bleeding, please seek medical attention in time.
- 21.In order to prevent accidents and damage to your body, please keep away from your scalp, hair, eyebrows, eyelashes and clothes, wool, shoelaces, etc. when using microdermabrasion.
- 22.WARNING Do not wash the hand-held part in water until the hand-held part is separated from the power cord.

03

3 INSTRUCTIONS

CHARGE

Note: Please fully charge the product before using it for the first time.

Charging steps: Insert one end of the USB cable into the charging hole of the fuselage, and connect the other end to the mobile phone charger or computer USB jack, etc., the USB output end, the charging indicator light is on, charging for 5 hours, the indicator light stops flashing and charging is complete (charging time). no more than 12 hours).

ASSEMBLING AND DISASSEMBLING GRINDING HEADS

Replace the grinding head according to the following operations. The selection and replacement of the grinding head can be based on the roughness of the skin used and the expected effect. Before replacing the grinding head, make sure that the power supply is disconnected and the machine is turned off.

1. Hold the head of the product with one hand and press the replacement button of the grinding head with the other hand (press the button on the side of the product), the grinding head cover will be opened and taken out. (See Figure 1 and Figure 2)

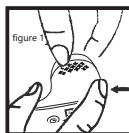

2. When changing the grinding head, put a new grinding head into the product until you hear a 'click' sound. Make sure that the newly installed grinding head is locked in place. If the grinding head is not connected properly,

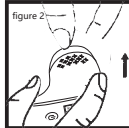

04

do not turn on the product switch.
Note: When unpacking the product, 1 grinding head has been installed on the body.

GRIND CALLUSES

This product is designed for use on dry, rough feet or heels. Do not use on other parts of the body.

- 1.Ensure that the product has sufficient power.
- 2.Make sure that the quartz grinding head has been installed on the product. If you remove and replace the grinding head, please refer to the previous section to prepare for use.
- 3.Clean or soften the skin and dry the moisture from the area of application to ensure the best results. Note: Do not use if there is a wound or bleeding on the skin.
- 4.Press and hold the switch for 3 seconds to turn on
- 5.Gently rotate the head and leave on dry rough skin area for 2-3 seconds. Don't press too hard, let the grinding head gently slide over the skin. If you press it too tightly or use too much force, the product will stop using (over-resistance protection function). During use, you can stop to check whether the keratin removal is satisfactory. If not, you can use it again on this area (for 2-3 seconds) and check again. Until smooth and delicate skin is reproduced.

Warning:Discontinue use immediately if skin becomes sore or inflamed.

- 6.After use, please shut down.
- 7.Rinse the skin or use a damp towel to remove excess cuticles.

05

- 8.After use, clean up the product in time. See cleaning section.
- 9.Please store the product in a dry, ventilated and cool place.

4 CLEAN AND MAINTENANCE

- 1.Remove the grinding head and use a brush to remove horny debris from the foot grinder.
 - 2.The grinding head can be washed with water alone to remove cuticles. When finished, dry the machine with a cloth. This machine can be washed all over the body.
- Note:Before cleaning, make sure the machine is turned off and the charging cable and socket are not connected.

THREE KIND OF GRINDING HEADS

Fine grinding head: suitable for hand calluses, raised dead skin and more delicate skin care.
Medium grinding head: suitable for the care of calluses that have just formed and normal skin.
Coarse grinding head: suitable for thick calluses accumulated over the years and the care of thicker skin.

TECHNICAL PARAMETER
Product name: Electric foot grinder
Charging voltage: 5V ==
Charging current: 0.7A
Charging power: 3.5W
Working voltage: 3.2V-4.2V
Working current: 2A
Working power: 6.4W-8.4W

Please keep this manual in a safe place.



Remarks: Suitable for cleaning under open faucets

06

5 ENVIRONMENTAL PROTECTION AND RECYCLING

The built-in rechargeable battery contains substances that pollute the environment. When you decide to dispose of this product, please remove the battery and dispose of the battery to a government-regulated place or recycling unit.

- 1.Turn on the foot grinder switch until the foot grinder stops working and drains the battery.
- 2.Before disassembling the foot grinder and taking out the battery, you must turn off the switch and disconnect the power supply.
- 3.After removing the battery, never connect the foot grinder to the charger, and be careful not to short-circuit the positive and negative poles of the battery.



07