

Handleiding Instruction Manual



Please read and keep the instruction manual safe, it contains important information. Safety information: Protective equipment should be worn. Not to be used in traffic.



- 1. plastic cover
- 2. nuts and screws
- 3. steel lock
- 4. tools



- 5. front fork
- 6. saddle with seat post
- 7. frame
- 8. handlebar



1. Place the steering wheel on the fork.



2. Tight the clamp.



3. Tight the clamp.

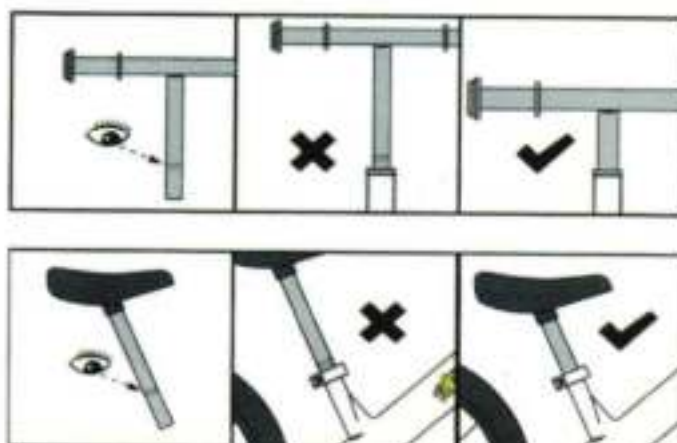

Attention:

Please keep the instruction manual for your records, it contains important information. The product may be further improved, if the actual product is different to the manual shown, please subject to the actual.

Warning:

Protective equipment should be worn when riding this bike.

This bike is not to be used in traffic.

Warning:

a recommendation for adult supervision of young children

To make sure children safe driving, please follow the below warning:

1. Please be careful to play the toy bike and avoid any collisions causing injury to the driver or third parties.
2. This bike is a toy and therefore should not be rode on streets, road, slope, stairway or any other dangerous places, it should be rode on the safe place.
3. Only 1 child is permitted to use the toy bike at a time, maximum loaded 30KG.
4. The toy bike is suitable for 2–6 years children and children must wear shoes when driving.
5. Driving in an improper way may cause damage to the product, always follow the instructions.
6. Children must always hold on to the handlebar when riding the bike.
7. To avoid the danger of causing suffocation, please ensure you dispose of the plastic packaging responsibly and keep out of children's reach.
8. Do not allow children to touch any of the moving parts while the bike is in operation.
9. Please use the moist cloth to clean the bike.
10. Warning ,To be assembled by an adult, this toy bike must be assembled by adult to make sure it is assembled in the correct manner before using.
11. If there is any damage, please stop driving until the toy bike has been repaired by a qualified technician.
12. The children should always follow adult's correct instruction to use the toybike.