



# QUICK START GUIDE GET TOGETHER 2 MINI

Bluetooth® Speaker  
Model: EM-JA021

Haut-parleur Bluetooth®  
Modèle : EM-JA021

Altavoz Bluetooth®  
Modelo: EM-JA021

藍牙喇叭  
型號:EM-JA021

ATTENTION: PLEASE READ QUICK START GUIDE BEFORE USE

ATTENTION: PRIÈRE DE LIRE LE GUIDE DE DÉMARRAGE RAPIDE AVANT UTILISATION

ATENCIÓN: LEA LA GUÍA DE INICIO RÁPIDO ANTES DE USARLO

BEACHTUNG: VOR DEM GEBRAUCH BITTE DIE SCHNELLSTARTANLEITUNG LESEN

ATTENZIONE: LEGGERE LA GUIDA DI AVVIAMENTO RAPIDO PRIMA DEL USO

OPGELET: VOOR HET GEBRUIK DE SNELSTARTGIDS LEZEN

提示：使用前請閱讀快捷使用說明

주의：사용 전에 빠른 시작 가이드를 읽어 주십시오.

注意：ご使用前にクイックスタートガイドを必ずお読みください。

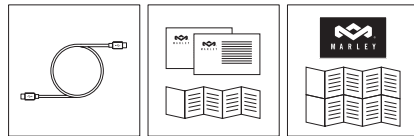
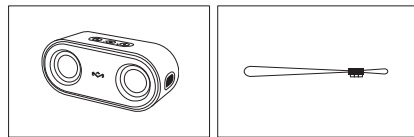

## STATUS 狀態

Bluetooth icon

Pairing Mode  
配對模式

Bluetooth icon

Paired  
配對成功

AUX icon

AUX Mode  
Aux配對模式

Multi Pair Mode - #1  
多重配對功能#1

Multi Pair Mode - #2  
多重配對功能#2

Battery icon

Full Power  
滿電模式

Charging  
充電中

Low Power  
低電量

## LED INDICATION LED指示燈

Blinking Blue LED

On Blue LED

On Red LED

On Blue LED

On Blue LED

Blinking Blue LED

Off Red LED

On Red LED

Blinking Red LED

Blinking Red LED

## COMPONENTS 配件及功能

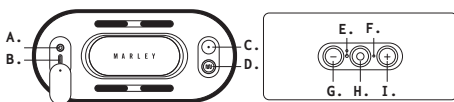

A. AUX In

AUX插口

B. USB-C Charging Port

USB-C充電口

C. Power On/Off

開關機

D. EQ Mode

EQ 模式

E. Battery LED

電池 LED

F. Bluetooth® LED

藍牙 LED

G. Volume Down / Skip Backward

音量減小/上一曲

H. Multi Function Button - MFB

多重功能按鍵

I. Volume Up / Skip Forward

音量增大/下一曲

## BLUETOOTH® 藍牙模式

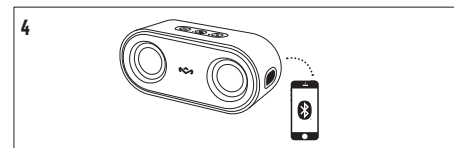
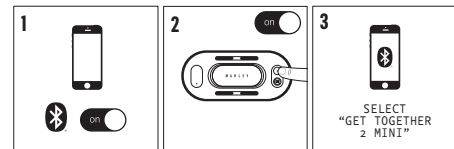

## CONTROLS 按鍵控制

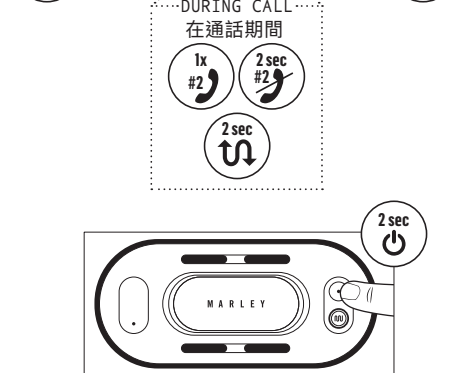
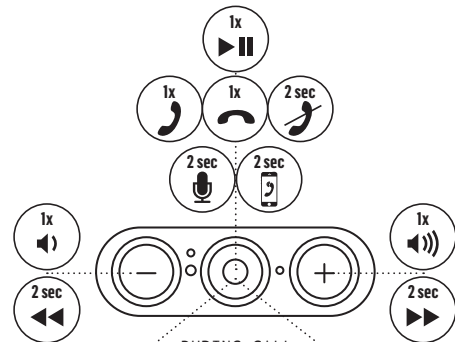

## STEREO PAIR MODE 立體聲配對

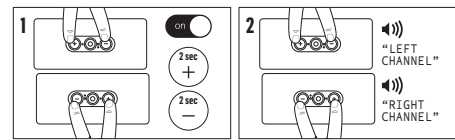

將有語音提示左、右頻道

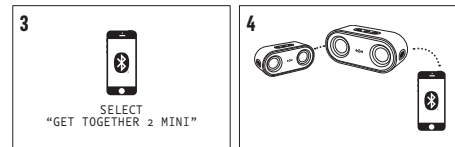

選擇配對設備

## EQ MODE EQ模式

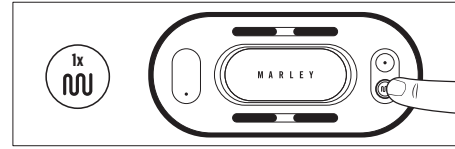

## STATUS 狀態

EQ Mode - Signature Sound  
EQ模式 標準模式

EQ Mode - Bass Boost  
EQ模式 低音增強模式

EQ Mode - Acoustic  
EQ模式 自然聲模式

## LED INDICATION LED指示燈

White 白色的

Green 綠色的

Violet 紫色的

## MULTI PAIR MODE 多重配對功能

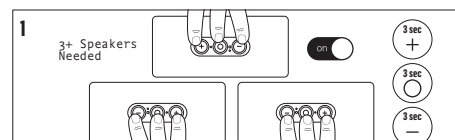

需要 3 個或更多揚聲器

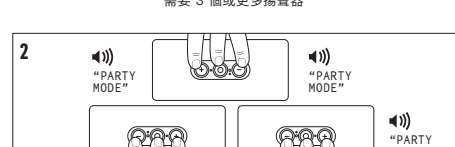

將有語音提示



選擇配對設備

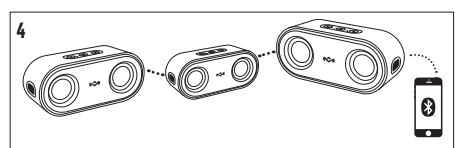

Full instruction and warranty details can be found at <https://www.thehouseofmarley.com/customer-support/instruction-books>

Para obtener libro de instrucciones, detalles de garantía y excepciones, visite <https://www.thehouseofmarley.com/customer-support/instruction-books>

Pour les informations complètes et les détails de garantie, rendez vous sur <https://www.thehouseofmarley.com/customer-support/instruction-books>

Weitere Informationen und Ausnahmen erhalten Sie hier <https://www.thehouseofmarley.com/customer-support/instruction-books>

Istruzioni complete e dettagli sulla garanzia sono disponibili su <https://www.thehouseofmarley.com/customer-support/instruction-books>

Komplette anvisninger og oplysninger om garanti kan findes på <https://www.thehouseofmarley.com/customer-support/instruction-books>

Teljes útmutató és garancianyilatkozat: <https://www.thehouseofmarley.com/customer-support/instruction-books>

Pełna instrukcja i warunki gwarancji są dostępne na stronie: <https://www.thehouseofmarley.com/customer-support/instruction-books>

Uplněn pokyny a detaily záruky najdete na <https://www.thehouseofmarley.com/customer-support/instruction-books>

Правила и условия гарантии полностью изложены по адресу <https://www.thehouseofmarley.com/customer-support/instruction-books>

De volledige handleiding en garantiegegevens kunnen hier worden gevonden: <https://www.thehouseofmarley.com/customer-support/instruction-books>

Fullstendige instruksjoner og garantietaljer kan finnes på <https://www.thehouseofmarley.com/customer-support/instruction-books>

Täydelliset ohjeet ja takuu löytyvät osoitteesta <https://www.thehouseofmarley.com/customer-support/instruction-books>

Fullständiga instruktioner och garantiinformation finns på <https://www.thehouseofmarley.com/customer-support/instruction-books>

Μπορείτε να βρείτε πλήρεις οδηγίες και λεπτομέρειες για την εγγύηση στη διεύθυνση <https://www.thehouseofmarley.com/customer-support/instruction-books>

Instruções completas e informações da garantia podem encontrar-se em <https://www.thehouseofmarley.com/customer-support/instruction-books>

Talimat ve garanti detaylarının tamamina adresinden erişilebilir <https://www.thehouseofmarley.com/customer-support/instruction-books>

如需查看完整说明和质保详情，请访问 <https://www.thehouseofmarley.com/customer-support/instruction-books>

如需完整說明與保固詳情，請瀏覽 <https://www.thehouseofmarley.com/customer-support/instruction-books>

取扱説明書の全文および保証内容の詳細は、<https://www.thehouseofmarley.com/customer-support/instruction-books>

をご覧ください。 자세한 설명과 품질보증서 세부사항은 <https://www.thehouseofmarley.com/customer-support/instruction-books>

에서 확인할 수 있습니다. <https://www.thehouseofmarley.com/customer-support/instruction-books>

# QUICK START GUIDE GET TOGETHER 2 MINI

## COMPLIANCE INFO

Conformité / Conformidad / Beachtung / Conformità / Na-levingsinformatie / 合規信息 / 규정 준수 정보 / コンプライアンス情報

### GET TOGETHER 2 MINI

READ ALL INSTRUCTIONS BEFORE USE AND SAVE THESE INSTRUCTIONS FOR FUTURE REFERENCE.

This equipment has been tested and found to comply with the limits for a Class B digital device, pursuant to part 15 of the FCC Rules. These limits are designed to provide reasonable protection against harmful interference in a residential installation. This equipment generates, uses, and can radiate radio frequency energy and, if not installed and used in accordance with the instructions, may cause harmful interference to radio communications. However, there is no guarantee that interference will not occur in a particular installation. If this equipment does cause harmful interference to radio or television reception, which can be determined by turning the equipment off and on, the user is encouraged to try to correct the interference by one or more of the following measures:

- Reorient or relocate the receiving antenna.
- Increase the separation between the equipment and receiver.
- Connect the equipment into an outlet on a circuit different from that to which the receiver is connected.
- Consult the dealer or an experienced radio/TV technician for help.

This device complies with FCC radiation exposure limits set forth for an uncontrolled environment. This device complies with Part 15 of the FCC Rules. Operation is subject to the following two conditions: (1) this device may not cause harmful interference, and (2) this device must accept any interference received, including interference that may cause undesired operation.

**WARNING: For Australia and New Zealand for charging this equipment, only use Australian approved detachable power supply unit with output ratings corresponding to the marking on the equipment.**

### FCC RF EXPOSURE STATEMENT:

This transmitter must not be co-located or operating in conjunction with any other antenna or transmitter. This device complies with FCC radiation exposure limits set forth for an uncontrolled environment.

### CAUTION!

Any changes or modifications not expressly approved by the party responsible for compliance could void the user's authority to operate the equipment.

### ISEDC STATEMENT

This device complies with Innovation, Science, and Economic Development Canada license-exempt RSS standard(s). Operation is subject to the following two conditions: (1) this device may not cause interference, and (2) this device must accept any interference, including interference that may cause undesired operation of the device.

This Class B digital apparatus complies with Canadian ICES-003.

### ISEDC RF EXPOSURE STATEMENT

The device is compliant with RF exposure guidelines, users can obtain Canadian information on RF exposure and compliance.

### NRCAN STATEMENT

Replacement of a battery with an incorrect type that can defeat a safeguard (for example, in the case of some lithium battery types); Disposal of a battery into fire or a hot oven, or mechanically crushing or cutting of a battery, that can result in an explosion; Leaving a battery in an extremely high temperature surrounding environment that can result in an explosion or the leakage of flammable liquid or gas; A battery subjected to extremely low air pressure that may result in an explosion or the leakage of flammable liquid or gas. High or low extreme temperatures that a battery can be subjected to during use, storage or transportation; and low air pressure at high altitude.

### BATTERY REPLACEMENT STATEMENT IN EUROPE

Your Get Together 2 Mini includes a rechargeable battery designed to last the lifetime of the product. In the unlikely event that you should require a replacement battery, please contact Consumer Relations who will supply details of the warranty and out-of-warranty replacement battery service.

### BATTERY DIRECTIVE

This symbol indicates that batteries must not be disposed of in the domestic waste as they contain substances which can be damaging to the environment and health. Please dispose of batteries in designated collection points.

### WEEE EXPLANATION

This marking indicates that this product should not be disposed with other household wastes throughout the EU. To prevent possible harm to the environment or human health from uncontrolled waste disposal, recycle it responsibly to promote the sustainable reuse of material resources.

Hereby, FKA Brands Ltd, declares that this radio equipment is in compliance with the essential requirements and other relevant provisions of Directive 2014/53/EU. A copy of the Declaration of Conformity can be obtained from [www.thehouseofmarley.co.uk/declaration-of-conformity](http://www.thehouseofmarley.co.uk/declaration-of-conformity)

### FR GET TOGETHER 2 MINI

LIRE TOUTES LES INSTRUCTIONS AVANT UTILISATION. LES CONSERVER POUR POUVOIR LES CONSULTER ULTÉRIEUREMENT.

### DÉCLARATION ISEDC

Le présent appareil est conforme aux CNR d'Innovation, Sciences et Développement économique Canada applicables aux appareils radio exempts de licence. L'exploitation est autorisée aux deux conditions suivantes : (1) l'appareil ne doit pas produire de brouillage, et (2) l'utilisateur de l'appareil doit accepter tout brouillage radioélectrique subi, même si le brouillage est susceptible d'en compromettre le fonctionnement. Cet appareil numérique de classe B est conforme à la norme nmb - 003 du canada.

### LE PRÉSENT APPAREIL EST CONFORME

Après examen de ce matériel aux conformités ou aux limites d'intensité de

champ RF, les utilisateurs peuvent sur l'exposition aux radiofréquences et la conformité et compliance d'acquiescer. les informations correspondantes.

### REMPACEMENT DES PILES

Votre enceinte Get Together 2 Mini comprend une batterie rechargeable conçue pour durer aussi longtemps que le produit. Dans le cas improbable où vous seriez obligé de recourir à une batterie de rechange, veuillez contacter le Service Clientèle qui vous informera sur la garantie de votre produit et le remplacement hors garantie.

### DIRECTIVE RELATIVE AUX PILES ET AUX ACCUMULATEURS

Ce symbole indique que les piles et les accumulateurs ne doivent pas être jetés avec les déchets ménagers car ils contiennent des substances pouvant être préjudiciables pour la santé humaine et l'environnement. Veuillez utiliser les points de collecte mis à disposition pour vous débarrasser des piles et accumulateurs usagés.

### EXPLICATION WEEE

Le symbole indique que le produit ne doit pas être éliminé avec les autres déchets ménagers dans toute l'Union Européenne. L'élimination incontrôlée des déchets pouvant porter préjudice à la santé humaine et à l'environnement, veuillez le recycler de façon responsable. Vous favoriserez ainsi la réutilisation durable des ressources matérielles.

FKA Brands Ltd déclare par la présente que cet équipement radio est conforme aux exigences essentielles et autres dispositions pertinentes de la Directive 2014/53/EU. Pour obtenir un exemplaire de la Déclaration de conformité, s'adresser à [www.thehouseofmarley.co.uk/declaration-of-conformity](http://www.thehouseofmarley.co.uk/declaration-of-conformity)

### NL GET TOGETHER 2 MINI

ALLE INSTRUCTIES LEZEN ALVORENS HET PRODUCT IN GEBRUIK TE NEMEN. DEZE INSTRUCTIES ZORGVULDIG BEWAREN.

### BATTERIJEN VERVANGEN

De Get Together 2 Mini komt met een oplaadbare batterij die is ontworpen om net zolang als het product zelf mee te gaan. In het onwaarschijnlijke geval dat u een nieuwe batterij nodig hebt, kunt u contact opnemen met de klantendienst. De medewerkers van de klantendienst zullen u dan informatie geven over het vervangen van batterijen, al dan niet uit hoofde van garantie.

### RICHTLIJN INZAKE BATTERIJEN

Dit symbool betekent dat batterijen niet met het huisvuil weggevoerd mogen worden, omdat ze stoffen bevatten die schadelijk kunnen zijn voor het milieu en de gezondheid. Lever batterijen op een aangewezen inzamelpunt in.

### UITLEG OVER AEEA

Deze markering geeft aan dat dit product binnen de EU niet met ander huisvuil mag worden weggevoerd. Om eventuele schade aan het milieu of de menselijke gezondheid door het ongecontroleerd wegwerpen van afval te voorkomen, dient dit apparaat op verantwoorde wijze gerecycled te worden om duurzaam hergebruik van materiaalbronnen te bevorderen.

Hierbij verklaart FKA Brands Ltd. dat deze radioapparatuur voldoet aan de essentiële vereisten en andere relevante voorschriften van Directive 2014/53/EU. Een kopie van de conformiteitsverklaring kan worden verkregen via [www.thehouseofmarley.co.uk/declaration-of-conformity](http://www.thehouseofmarley.co.uk/declaration-of-conformity)

### IT GET TOGETHER 2 MINI

LEGGERE INTEGRALMENTE LE PRESENTI ISTRUZIONI PRIMA DELL'USO. CONSERVARE LE PRESENTI ISTRUZIONI PER CONSULTAZIONI SUCCESSIVE. SOSTITUZIONE DELLA BATTERIA

Il tuo sistema Get Together 2 Mini include una batteria ricaricabile la cui durata corrisponde alla vita utile del prodotto. Nella remota eventualità che ti occorra una batteria di ricambio, contatta il Servizio Clienti che ti fornirà i dettagli del servizio relativo alla batteria sostitutiva in garanzia e non in garanzia.

### DIRETTIVA RELATIVA ALLE BATTERIE

Questo simbolo indica che le batterie devono essere smaltite separatamente dai rifiuti domestici poiché contengono sostanze potenzialmente nocive per l'ambiente e la salute umana. Smaltire le batterie negli appositi centri di raccolta.

### SPIEGAZIONE DIRETTIVA RAE

Questo simbolo indica che il prodotto non deve essere smaltito assieme agli altri rifiuti domestici in tutti i Paesi dell'Unione Europea. Al fine di evitare un eventuale danno ambientale e alla salute umana derivante dallo smaltimento dei rifiuti non controllato, riciclare il prodotto in maniera responsabile per promuovere il riutilizzo sostenibile delle risorse materiali.

Con la presente, FKA Brands Ltd dichiara che l'apparecchiatura radio in oggetto è conforme ai requisiti essenziali e ad altre disposizioni pertinenti della Direttiva 2014/53/EU. È possibile richiedere una copia della Dichiarazione di conformità scrivendo all'indirizzo [www.thehouseofmarley.co.uk/declaration-of-conformity](http://www.thehouseofmarley.co.uk/declaration-of-conformity)

### SP GET TOGETHER 2 MINI

LEA TODAS LAS INSTRUCCIONES ANTES DE USAR. GUARDE ESTAS INSTRUCCIONES PARA REFERENCIA FUTURA.

### REEMPLAZO DE BATERIAS

Su Get Together 2 Mini incluye una batería recargable diseñada para funcionar durante la vida útil del producto. En el improbable caso de que necesite un reemplazo de batería, comuníquese con Servicios al Cliente, donde le suministrarán los detalles del servicio de reemplazo de baterías con garantía y sin garantía.

### DIRECTIVA RELATIVA A LAS PILAS

Este símbolo indica que las pilas no se deben eliminar con la basura doméstica ya que contienen sustancias que pueden ser perjudiciales para el medio ambiente y la salud. Deshágase de las pilas en los puntos de recogida que existen para ese fin.

### EXPLICACIÓN RAE

Este símbolo indica que este artículo no se debe tirar a la basura con

otros residuos domésticos en ningún lugar de la UE. A fin de prevenir los efectos perjudiciales que la eliminación sin control de los residuos puede tener sobre el medio ambiente o la salud de las personas, le rogamos que los recicle de forma responsable para fomentar la reutilización sostenible de los recursos materiales.

Por la presente, FKA Brands Ltd declara que este dispositivo de radio está en conformidad con los requisitos esenciales y otras disposiciones relevantes de la directiva 2014/53/EU. Si desea una copia de la declaración de conformidad, solicítela a [www.thehouseofmarley.co.uk/declaration-of-conformity](http://www.thehouseofmarley.co.uk/declaration-of-conformity)

### FIN GET TOGETHER 2 MINI

LUE KAIKKI OHJEET ENNEN KÄYTTÖÄ. SÄILYTÄ NÄMÄ OHJEET TULEVAA TARVETTA VARTEN. TÄRKEÄT VAROTOIMENPITEET:

### AKUN VAIHTO

Get Together 2 Mini-kauitumissa on ladattava akku, joka on suunniteltu kestämään yhtä pitkään kuin itse kauitin. Jos akku kuitenkin täytyy vaihtaa, ota yhteyttä asiakashalvueluun, mistä saat tiedot takuun piiriin kuuluvan akun ja takuun ulkopuolisen akun korvaavasta toimituspalvelusta.

### AKKUJA KOSKEVA DIREKTIVI

Tämä symboli tarkoittaa, että akkuja ei saa hävittää talousjätteiden mukana, koska ne sisältävät aineita, jotka voivat olla vahingollisia ympäristölle ja terveydelle. Vie akut niille tarkoitettuihin keräyspisteisiin.

### WEEE-SELITYS

Tämä merkki tarkoittaa, että tätä tuotetta ei saa hävittää muiden talousjätteiden mukana missään EU-maassa. Kontrollioimattomasta jätteiden hävittämisestä mahdollisesti aiheutuvien ympäristöhaittojen tai terveysvaarojen estämiseksi hävitä tämä tuote vastuullisesti edistääksesi materiaaliavarojen uudelleenkäyttöä.

FKA Brands Ltd. vakuuttaa, että tämä radiolaitte on direktiivin 2014/53/EU vaatimusten ja niiden siihen liittyvien säädösten mukainen. Kopion vaatimustenmukaisuusvakuutuksesta voi tilata lähettämällä sähköpostia osoitteeseen [www.thehouseofmarley.co.uk/declaration-of-conformity](http://www.thehouseofmarley.co.uk/declaration-of-conformity)

### DE GET TOGETHER 2 MINI

LESEN SIE SICH VOR DER BENUTZUNG ALLE HINWEISE GUT DURCH. BEWAHREN SIE DIESE HINWEISE GUT AUF.

### BATTERIEWECHSEL

Ihr Get Together 2 Mini enthält eine wiederaufladbare Batterie, die für die gesamte Lebensdauer der Lautsprecher halten sollte. In dem unwahrscheinlichen Fall, dass Sie die Batterie ersetzen müssen, wenden Sie sich bitte an unseren Kundendienst, der Sie über die Einzelheiten zum Ersatz der Batterie im Garantiefall und außerhalb der Garantie informieren wird.

### BATTERIE RICHTLIJNE

Dieses Symbol weist darauf hin, dass die Batterien nicht mit dem

gewöhnlichen Hausmüll entsorgt werden dürfen, da sie Stoffe enthalten, die sich auf Umwelt und Gesundheit schädlich auswirken können. Entsorgen Sie die Batterien bitte an den hierfür vorgesehenen Sammelstellen.

### WEEE-ERKLÄRUNG

Diese Kennzeichnung weist darauf hin, dass dieses Produkt innerhalb der EU nicht mit anderem Hausmüll entsorgt werden soll. Damit durch unkontrollierte Abfallentsorgung verursachte mögliche Umwelt- oder Gesundheitsschäden verhindert werden können, entsorgen Sie dieses Produkt bitte ordnungsgemäß und fördern Sie damit eine nachhaltige Wiederverwendung der Rohstoffe.

Hiermit erklärt die FKA Brands Ltd., dass dieses Funkgerät in Übereinstimmung mit den wesentlichen Anforderungen und anderen entsprechenden Bestimmungen der Richtlinie 2014/53/EU geliefert wird. Eine Kopie der Konformitätserklärung ist über [www.thehouseofmarley.co.uk/declaration-of-conformity](http://www.thehouseofmarley.co.uk/declaration-of-conformity)

### TR GET TOGETHER 2 MINI

KULLANMADAN ÖNCE TÜM TALİMATLARI OKUYUN. BU TALİMATLARI DAHA SONRA BAŞVURMAK ÜZERE SAK.

### PİL DEĞİŞTİRME

Get Together 2 Mini'nizda, ürünün ömrü boyunca yetecek şekilde tasarlanmış şarj edilebilir pil bulunmaktadır. Pili değiştirmenizin gerekmesi durumunda, lütfen, size garanti kapsamı ve garanti kapsamı dışında olan pil değiştirme hizmet detaylarını verecek Müşteri Hizmetleriyle temasa geçin.

### PİL DIREKTİFİ

Bu sembol, çevreye ve sağlığa karşı zararlı olabilen maddeler içerebileceği için pillerin ev atılıyla atılmaması gerektiği gösterir. Lütfen, pilleri belirtilen toplama noktalarna atın.

### WEEE AÇIKLAMASI

Bu işaret bu ürünün AB genelinde diğer ev atıklarıyla birlikte atılmaması gerektiğini belirtir. Kontrolsüz atığın çevre veya insan sağlığına olası zararları engellemek için sorumlu bir şekilde geri dönüştürülmesini ve malzeme kaynaklarının sürdürülebilir şekilde yeniden kullanılmasını sağlar.

İş bu vesileyle, FKA Brands Ltd, bu telsiz ekipmanının 2014/53/EU Yönergesinin temel gereksinimleri ve diğer ilgili hükümlerle uyumlu olduğunu beyan eder. Uygunluk Beyanı'nın bir kopyası [www.thehouseofmarley.co.uk/declaration-of-conformity](http://www.thehouseofmarley.co.uk/declaration-of-conformity)

### SV GET TOGETHER 2 MINI

LÄS ALLA INSTRUKTIONERNA FÖRE ANVÄNDNING. SPARA DESSA INSTRUKTIONER FÖR FRAMTIDA REFERENS.

### BYTE AV BATTERI

Din Get Together 2 Mini inkluderar ett återuppladdningsbart batteri som är designat att vara under produktens livslängd. Om du osannolikt skulle

[TheHouseofMarley.com](http://TheHouseofMarley.com)



BOB MARLEY™  
MARLEY™  
BOBMARLEY.COM

©Fifty-Six Hope Road Music Ltd., 2011-2021.  
Right of Publicity and Persona Rights.  
Fifty-Six Hope Road Music Ltd.

Marley, the Marley logo, Bob Marley and the Bob Marley logo are registered trademarks of Fifty-Six Hope Road Music Limited and any use of such marks by The House of Marley is under license. The Bluetooth® word mark and logos are registered trademarks owned by Bluetooth® SIG, Inc. and any use of such marks by The House of Marley is under license.





設備通風孔不可為報紙、桌巾或窗簾等堵住。本產品最高使用溫度：40℃

### 更換電池

Get Together 2 Mini 隨帶一個可充電電池。設備使用期內無需更換電池。當您因某種特殊原因需要更換電池時，請與客服聯繫。客服人員將為您提供詳盡的保修期內和保修期後更換電池的服務說明。

警告 (重要事項)		警告 (重要事項)	
警告 (重要事項)			
警告 1	警告 2	警告 3	警告 4
警告 5	警告 6	警告 7	警告 8
警告 9	警告 10	警告 11	警告 12
警告 13	警告 14	警告 15	警告 16
警告 17	警告 18	警告 19	警告 20
警告 21	警告 22	警告 23	警告 24
警告 25	警告 26	警告 27	警告 28
警告 29	警告 30	警告 31	警告 32
警告 33	警告 34	警告 35	警告 36
警告 37	警告 38	警告 39	警告 40
警告 41	警告 42	警告 43	警告 44
警告 45	警告 46	警告 47	警告 48
警告 49	警告 50	警告 51	警告 52
警告 53	警告 54	警告 55	警告 56
警告 57	警告 58	警告 59	警告 60
警告 61	警告 62	警告 63	警告 64
警告 65	警告 66	警告 67	警告 68
警告 69	警告 70	警告 71	警告 72
警告 73	警告 74	警告 75	警告 76
警告 77	警告 78	警告 79	警告 80
警告 81	警告 82	警告 83	警告 84
警告 85	警告 86	警告 87	警告 88
警告 89	警告 90	警告 91	警告 92
警告 93	警告 94	警告 95	警告 96
警告 97	警告 98	警告 99	警告 100

警告：請勿自行折機更換電池，如果更換錯誤的電池可能會產生爆炸。廢舊電池的處理

此符號表示電池不得與家庭勸色一起丟棄，因為電池含有對環境和健康有害的成分。請將廢舊電池送至指定的收集處。歐共體廢棄電子電器設備指南(WEEE)解釋

此標識表示在歐共體內本產品不得與家庭勸色一起丟棄。無控制的勸色丟棄有害環境或健康，必須避免。請盡力回收廢舊設備，使其持續得以再生利用。

FKA分銷有限公司在此聲明，此無線設備符合2014/53/EU指南的基本要求和它相關條款。請訪問www.thehouseofmarley.co.uk/declaration-of-conformity 以獲取合規聲明的副本。

NCC WARNING MESSAGE LP0002低功率射頻器材技術規範\_章節3.8.2 取得審驗證明之低功率射頻器材，非經核准，公司、商號或使用者均不得擅自變更頻率、加大功率或變更原設計之特性及功能。低功率射頻器材之使用不得影響飛航安全及干擾合法通信；經發現有干擾現象時，應立即停用，並改善至無干擾時方得繼續使用。前述合法通信，指依電信管理法規定作業之無線電通信。低功率射頻器材須忍受合法通信或工業、科學及醫療用電波輻射性電機設備之干擾。

進口商：思博特有限公司 位置：臺北市松山區南京東路5段200號13樓之9 TEL:02-25996605#25

### ID GET TOGETHER 2 MINI

BACA SEMUA PETUNJUK SEBELUM PENGGUNAAN DAN SIMPAN PETUNJUK INI UNTUK RUJUKAN DI MASA MENDATANG.

PENGGANTIAN BATERAI Get Together 2 Mini Anda mencakup baterai isi ulang yang dirancang untuk bisa dipakai selama masa pakai produk. Apabila Anda memerlukan baterai pengganti, hubungi Layanan Pelanggan yang akan memberikan detail tentang layanan baterai pengganti garansi dan di luar garansi.

ARAHAN BATERAI Simbol ini menunjukkan bahwa baterai tidak boleh dibuang bersama sampah rumah tangga karena mengandung zat yang dapat merusak lingkungan dan kesehatan. Buang baterai di tempat pengumpulan yang telah ditentukan.

PENJELASAN WEEE Tanda ini menunjukkan bahwa produk ini tidak boleh dibuang bersama sampah rumah tangga lain di seluruh UE. Untuk mencegah kemungkinan bahaya pada lingkungan atau kesehatan manusia dari pembuangan limbah yang tidak terkendali, daur ulang produk ini secara bertanggung jawab untuk mempromosikan penggunaan kembali sumber daya bahan secara berkelanjutan. FKA Brands Ltd dengan ini menyatakan bahwa peralatan radio ini mematuhi persyaratan penting dan ketentuan relevan lainnya dari Arahan 2014/53/EU. Salinan Pernyataan Kepatuhan bisa diperoleh dari www.thehouseofmarley.co.uk/declaration-of-conformity

### KR GET TOGETHER 2 MINI

사용 전에 모든 지침을 읽고 이후 참조할 수 있도록 보관해 두십시오. 배터리 교체 GET TOGETHER 2 MINI에는 제품의 수명을 지속하도록 설계된 재충전 배터리가 포함되어 있습니다. 드물지만 배터리를 교체해야 하는 경우에는 고객 서비스 부서에 문의하여 보증 및 보증 외 배터리 교체 서비스에 대한 상세 정보를 확인하십시오. 배터리 지침 이 기호는 배터리가 환경 및 건강에 해를 끼칠 수 있는 물질을 함유하고 있으므로 가정용 쓰레기로 폐기해서는 안 된다는 것을 나타냅니다. 배터리를 지정된 수거 장소에 버리십시오.

WEEE 설명 이 표시는 이 제품을 EU 전역에서 다른 가정용 쓰레기와 함께 폐기해서는 안 된다는 것을 나타냅니다. 통제되지 않은 쓰레기 폐기로 인해 환경이나 인체에 해를 끼치지 않도록 하려면 책임감을 갖고 재활용하여 물질 자원의 지속 가능한 재사용을 촉진하십시오.

FKA BRANDS LTD는 이 무선 장비가 DIRECTIVE 2014/53/EU의 필수 요건 및 기타 관련 조항을 준수함을 선언합니다. 적합성 선언서(DECLARATION OF CONFORMITY) 사본은 www.thehouseofmarley.co.uk/declaration-of-conformity 에서 얻을 수 있습니다.

제12조 DGT의 허가 없이 회사, 기업 또는 사용자는 주파수를 변경하거나 송신을 개선하거나 원래 특성은 물론 성능을 공인된 저전력 무선 주파수 장치로 바꿀 수 없습니다.

제14조 저전력 무선 주파수 장치는 항공기 보안에 영향을 미치거나 합법적 통신을 간섭해서는 안 됩니다. 이를 발견한 경우 사용자는 간섭을 하지 않을 때까지 즉시 작동을 중지해야 합니다. 앞서 말한 합법적 통신이라 함은 무선 통신이 전기통신법에 따라 작동된다는 뜻입니다. 저전력 무선 주파수 장치는 합법적 통신 또는 ISM 전파 방출 장치의 간섭에 민감해야 합니다



To prevent possible hearing damage, do not listen at high volume levels for long periods.

Con el fin de evitar lesiones auditivas, se aconseja no escuchar a un volumen excesivamente alto durante un período prolongado.

Afin d'éviter tout dommage auditif possible, ne pas écouter à un volume sonore élevé pendant une période prolongée.

Um mögliche Hörschäden zu vermeiden, stellen Sie die Lautstärke nicht über einen längeren Zeitraum sehr hoch ein.

Per evitare possibili danni all'udito, non ascoltare audio a livelli elevati di volume per lunghi periodi.

Marley and the Marley logo are registered trademarks of Fifty-Six Hope Road Music Limited and the use of such marks by House of Marley is under license. The Bluetooth® word mark and logos are registered trademarks owned by Bluetooth® SIG, Inc. and any use of such marks by The House of Marley is under license.

Operating frequency bands: 2402 - 2480MHz CE BT Max Power Transmitted Power: EM-JA021 = 2.54dBm

Distributed by House of Marley, LLC 3000 N Pontiac Trail Commerce Township, MI 48390 USA

Distributed in the UK by FKA Brands Ltd, Tonbridge, TN110GP, UK.

Distributed in Canada by Homedics Group Canada 6460 Kennedy Road, Unit C, Mississauga ON, L5T 2X4 Canada

Distributed in the EU by FKA Brands Ltd, 29 Earlsfort Terrace, Dublin 2. IE

Distributed in Australia by HoMedics Australia Pty Ltd, 14 Kingsley Close, Rowville Victoria 3178

Distributed in New Zealand by CDB Media Ltd, 4 Lovell Court, Albany, Auckland, New Zealand 0800 232 633

QSG-EMJA021

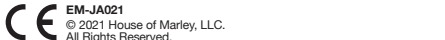

EMJA021

