

ONIKUMA

K10 HIGH
PRO PERFORMANCE
PROFESSIONAL GAMING HEADSET

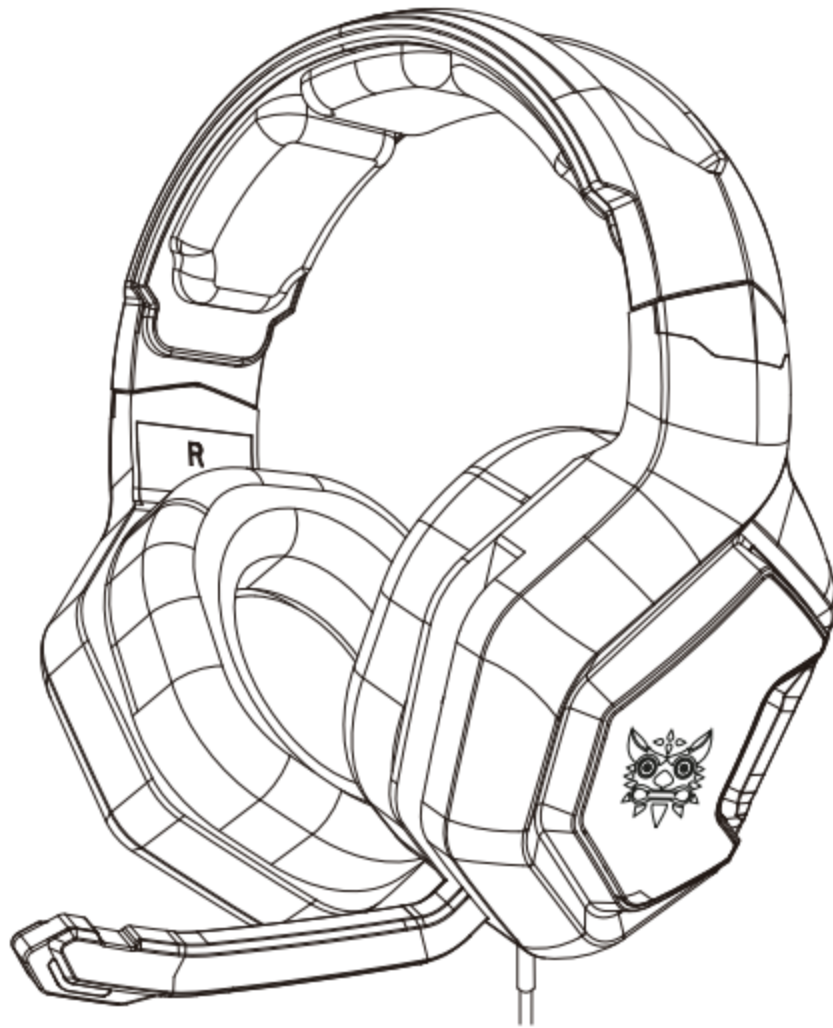

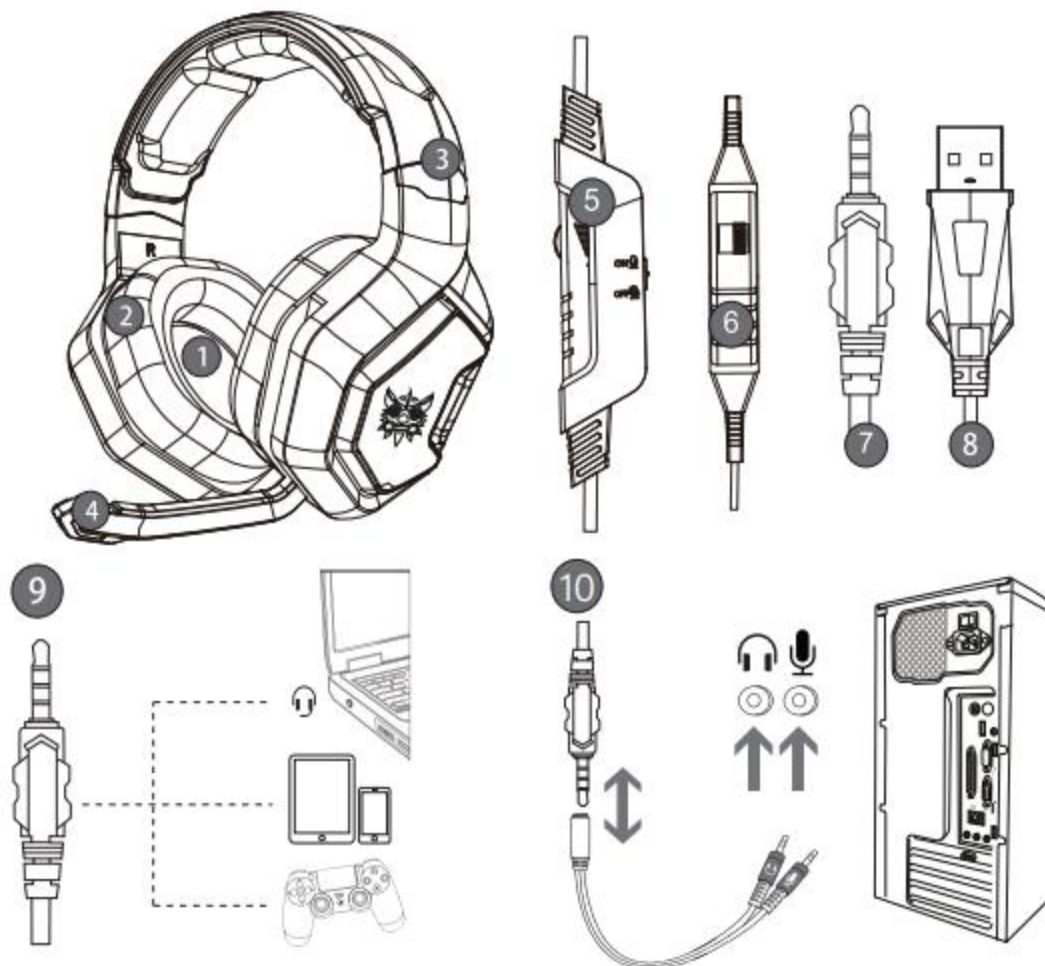

Product introduction

1. High-quality sound production unit offers high, medium and low audio experience;
2. Skin type protein earmuff, environmental protection, wearproof and comfortable to wear;
3. Lightweight design, self-adjusting head beam design, the best game wearing experience;
4. High sensitivity microphone delivers more accurate, clear and smooth voice;
5. Volume control button
6. Microphone on-off button
7. 3.5MM International standard (CTIA) device interface (right channel + / ground - /left channel + / microphone+)
8. USB interface for power supply for the LED lights
9. Used for single hole interface
10. Used for one-to-two tieline

Product parameters

Speaker size	50mm	Microphone impedance	2.2K Ω
Impedance	32 $\Omega \pm 15\%$	Directionality	omni-directional
Sensitivity	106dB ± 3 dB	Cable length	2.2M $\pm 15\%$
Frequency range	20-20K H Z	LED working voltage	DC5V $\pm 5\%$
Microphone	6.0x2.7mm	Working current	≤ 100 mA
Microphone sensitivity	-42dB ± 3 dB	Headset jack	USB+3.5mm

Range of application and operating instructions

1. The headset is applicable to 3.5MM quadropole single plug audio device such as laptop, tablet PC, mobile phone, etc. With the bisected adapter cable of 3.5mm interface, the 3.5mm dual plug of the computer can be used.
2. Generally, the cable end or microphone end is designed on the left-side, so wear the cable end or microphone end on the left ear when wearing headset.
3. When using the headset on computer, please make sure the headset microphone switch is turned on; then make sure the computer microphone switch is turned on. Please find the "speaker" icon in the computer taskbar, and double-click to enter the volume control for settings. And enter into the "voice" for settings on the "Control Panel".
4. Please make sure the headset volume adjustment button is at the minimum volume, and can be adjusted to the appropriate volume.
5. Please use the headset to enjoy the game
6. Support the 32-bit and 64-bit Win7 / Win8 / Win8.1 / Win10/XP.

Frequently asked questions

1. When playing music by headset , there is accompaniment but no singing?
A) The headset plug is quadropolar single plug type. The international (CTIA) standard 3.5 mm interface: pin connection is left channel - right channel – ground wire – microphone, which is the most popular connection in the market and the largest application. If the international standard headset is connected to a non-international standard interface, there will arise the phenomenon of background sound only. If the audio device is non-international standard, the adapter cable is needed.
2. When playing music with headset, there is sound but the voice chatting can't work?
A) When using the headset, please make sure that the tone control microphone switch of headset is turned on, and make sure that the microphone works normally;
B) The headset plug is quadropolar, single plug type with the function of audio/voice combination, and is applicable to single-hole audio device. Please make sure that if your device fits the audio/voice combination interface;
C) The headset plug is quadropolar, single plug type, while your device may be of tripolar interface.
D) With the bisected adapter cable of 3.5mm interface , you can use the 3.5mm dual plug (headphone and microphone jack) interface of the computer. You can enjoy beautiful music and voice chatting at the same time.

3. When playing music with the headset, there arises the phenomenon of noise, small volume, unclear sound, or one side with sound and the other side without sound?

- A) Please check if the plug is well inserted into the interface device;
- B) The headset plug is quadrupolar, single plug type, while your device may be of tripolar interface.;

4. When using the headset, there is current sound?

- A) Please check if the plug is well inserted into the interface device;
- B) There are electric or strong magnetic field at hand, please take away them (such as the mobile phone, fan ...);
- C) Please check if the microphone boost of the computer microphone is turned on. Please open the control panel → sound → record → level → microphone boost to adjust the microphone boost mode.

Matters needing attention

- A) Please enjoy music at a moderate volume to prevent adverse effects on the hearing;
- B) Please be careful to wear when driving or cycling so as not to affect safety;
- C) Product specifications are subject to change without notice;
- D) If disassemble the headset without authorization, we can not guarantee the quality.

Packing list

- 1) Gaming headset
- 2) Operating instructions