

THANK YOU

Thank you for your purchase of the Klipsch® Music Center kmc1! The kmc1 combines legendary Klipsch technology with *Bluetooth*® and aptX™ technology for truly hi-fidelity music playback from your favorite music device. With a *Bluetooth*® connected phone you can also conveniently answer, converse and terminate, or ignore incoming calls, from the kmc1. Its contemporary styling compliments any décor and you can take it almost anywhere with both AC and battery-power options.

AC POWER

To operate on AC power first select the one plug adapter (3 total supplied) that fits your AC outlet and insert into the supplied AC adapter. Plug other end of the AC adapter into back of the kmc1 marked DC IN, then plug AC adaptor into a functioning wall socket. On AC power, if no streaming or connected audio is detected for one hour the kmc1 will automatically go into READY mode.

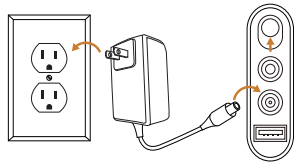

BATTERY POWER

The kmc1 has a built-in rechargeable lithium-ion battery capable of up to 16 hours of playing time. ALLOW 8 HOURS OF INITIAL CHARGE TIME BEFORE FIRST TIME BATTERY USE. Charging occurs when kmc1 is plugged into active AC outlet. Pushing UTILITY button down with kmc1 on (other than during a *Bluetooth*-connected phone call) will show current battery strength. The kmc1 operates on battery power unless AC power is utilized. On battery power, if no streaming or connected audio is detected for five minutes, the kmc1 will automatically go into READY mode. To put the unit back into ON mode simply press the ON / READY button on top. Turn off rear power switch to conserve battery.

USB CHARGING

NOTE: The USB jack is only for CHARGING most music players, phones, and tablets. Using the USB connection end of the charging cable for your device (not included), connect to the USB input on rear of the kmc1 to charge your device. You can charge your device using either AC or battery power for the kmc1. **NOTE:** Using the USB input to charge your device while the kmc1 is on battery power will reduce battery life. If the battery in the kmc1 is too weak, the USB connection will not charge your device.

ILLUMINATED CONTROL FUNCTIONS

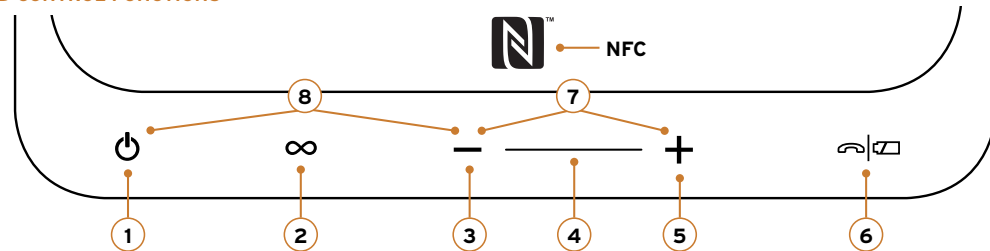

1. **ON / READY** - Tap to turn on. Hold to put in READY mode. Solid Red indicates ON, flashes if batteries are weak
2. **BLUETOOTH**

No Connection	Hold to Pair Tap to Exit
Connected	Hold to Disconnect

3. **VOLUME DOWN**

4. **VOLUME LEVEL / BATTERY LEVEL INDICATOR**
5. **VOLUME UP**
6. **UTILITY** - Answer/Terminate or Ignore a phone call from a *Bluetooth*-connected phone OR check battery level
7. **SOURCE SELECT** - Pressing + and - together toggles between *Bluetooth* mode and AUX (3.5mm input) for playback
8. **MUTE** - Briefly push ON/READY and VOLUME DOWN together to MUTE sound during music playback then briefly push same two buttons together again to unmute sound back to original level.

ANALOG MUSIC SOURCE

Any device with a standard 3.5mm headphone output can be connected to the AUX input (on back) with a mini-to-mini cable (included). Make sure volume on kmc1 is just above minimum, adjust volume on your device to max and play music. Use SOURCE SELECT to switch to AUX input if necessary. Adjust volume with the volume buttons on the kmc1 to desired level.

BLUETOOTH MUSIC SOURCE

Any paired *Bluetooth* device within a 30 foot (9.1 m) range of the kmc1 can wirelessly stream music. For a *Bluetooth* connected device, set the kmc1's volume to max and adjust the volume to the desired level using the *Bluetooth* streaming device.

PHONE CONVERSATIONS

You can answer/terminate or ignore a phone call from any paired *Bluetooth* phone. An incoming phone call will pause music and send your connected phone's ring tone through the kmc1. To answer, briefly press the UTILITY button on the kmc1. Then listen and talk using the kmc1 as you would a speakerphone. Adjust volume using the volume + and - buttons on the kmc1 to desired level. Mute the kmc1's microphone during a phone call (so the caller cannot hear you) by briefly pressing the ON / READY and VOLUME DOWN buttons together. Unmute the microphone by

briefly pressing the same two buttons again. Terminate the call by briefly pressing the UTILITY button again. To ignore a call, press and hold the UTILITY button until the incoming call stops.

PAIRING BLUETOOTH DEVICES

Press and hold the *Bluetooth* button (∞) until it flashes (~ 3 seconds). Do not touch any other buttons on the kmc1 during this process. Activate the *Bluetooth* feature on your device, setting it up to pair with "Klipsch kmc1". Once paired, the kmc1 will automatically select *Bluetooth* as the source. We recommend following the volume setting instructions in the *Bluetooth* Music Source section before playing any music. If the last paired *Bluetooth* device is not available or not playing it will automatically choose the AUX (3.5mm input) as the source. The kmc1 can store up to 8 paired *Bluetooth* devices.

CARE AND CLEANING

Your kmc1 music center has a durable finish that only requires dry dusting or cleaning with a dry cloth. Avoid the use of abrasive or solvent-based cleaners and harsh detergents. Adhesive tape will clean up the rubber device area. Do not rub hard. Window cleaner and a paper towel will clean the surface well.

TROUBLESHOOTING

kmc1 will not power on

- Make sure plug adapter is secured tightly to the AC adapter
- Make sure AC adapter is plugged tightly into DC input
- Make sure AC adapter is plugged into a live outlet
- Make sure power switch is turned on
- If no AC connection make sure the battery is sufficiently charged (POWER ON/OFF LED will dim/brighten every 5 seconds when the kmc1 is running out of battery power)

Device will not pair with *Bluetooth* mode

- Make sure kmc1 is in pairing mode (∞ flashing blue)
- Make sure you are within 30 feet (9.1 m) of kmc1 while pairing; move closer/make sure you are in the same room
- Make sure your volume settings are correct

Device does not play in *Bluetooth* mode or AUX input

- Make sure volume on device is up to maximum/kmc1 volume is up at least half way and not MUTED
- If using AUX input, make sure connections are tight
- Touch + and - buttons together to select correct input
- If ∞ solid blue touch and hold + and - together to switch inputs

The *Bluetooth*® word mark is a registered trademark owned by *Bluetooth* SIG, Inc. and any use of such mark by Klipsch Group, Inc. is under license. The "aptX"™ software is copyright CSR plc or its group companies. All rights reserved. The aptX™ mark and the aptX logo are trade marks of CSR plc or one of its group companies and may be registered in one or more jurisdictions. Klipsch is a wholly-owned subsidiary of Vox International Corporation. ©2012, Klipsch Group, Inc. The N Mark is a trademark or registered trademark of NFC Forum, Inc. in the United States and in other countries.



Klipsch is a trademark of Klipsch Group, Inc., registered in the U.S. and other countries. All other trademarks are property of their respective owners. Klipsch is a wholly-owned subsidiary of Vox International Corporation. ©2012, Klipsch Group, Inc.

Klipsch[®]
music center

