

WTT ASSEMBLY INSTRUCTION

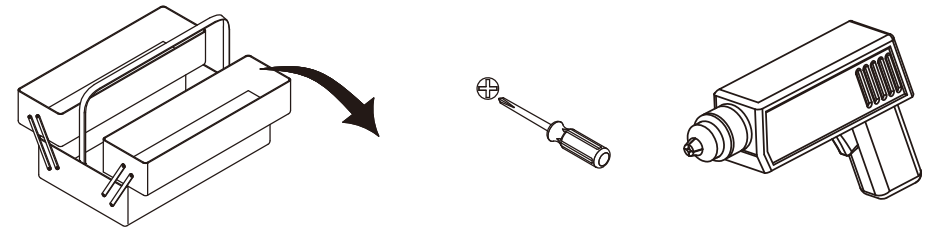
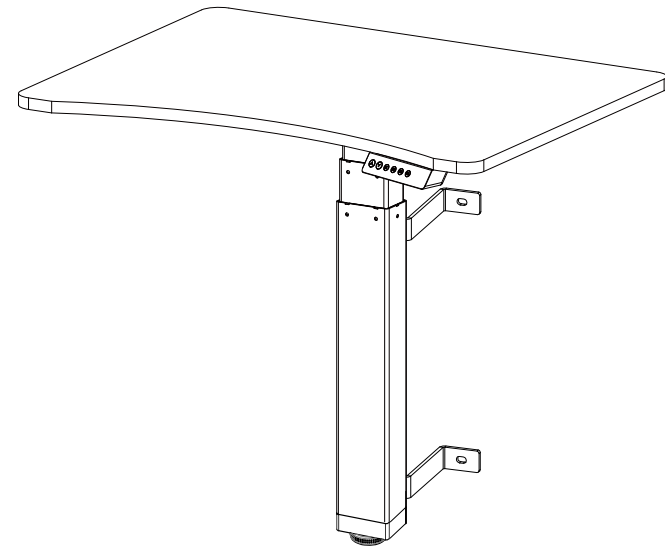

WICHTIG - FÜR SPÄTERE VERWENDUNG
AUFBEWAHREN - SORGFÄLTIG LESEN

AVIS - Ces instructions doivent être sauvegardées
Pour utilisation future - Les instructions doivent
être suivies

IMPORTANTE, conservar estas instrucciones
para futuro uso. Siga estas instrucciones atentamente

VIGTIGT- Samlevejledningen skal opbevares
i arkiv til senere brug- Skal gennemlæses nøje

NOTICE - These instructions must be saved
for future use - Instructions must be followed

CHECK LIST

NO.	1	2	3	4	5	6	7
QTY.	1	1	2	2	1	1	1

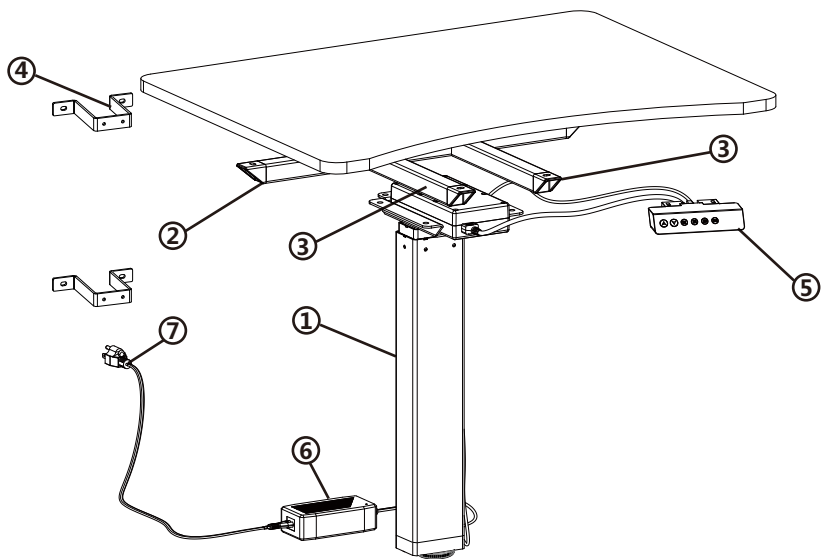

A (6pcs)



M8x10mm

B (2pcs)



ST4.2x16mm

C(4pcs)



M6*10

D



M5

Handset Instruction

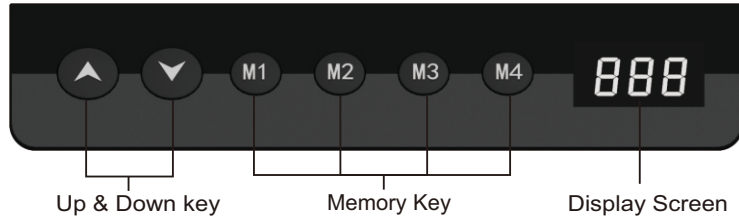

The whole handset surface is a button panel. If there is no press within 30 seconds, the screen is locked and M1/M2/M3/M4 keys are locked correspondingly., you should press Up or Down key first, it can be used when the display screen light up.

■ Up or Down Key

To adjust the height of the desk, keep pressing on "up" or "down" until it fits your best position.

■ Display screen

Display the height value of the desk.

■ Memory Key (M1/ M2/ M3/ M4)

After setting memory keys, the desk can lift automatically to memory height.

※ How to set memory mode

Please keep pressing M1/M2/M3/M4 key for 5 seconds, until "be" sound, the memory height is successfully saved. Then press M1/M2/M3/M4, the desk moves to memory height automatically.

■ Safety function

When the desktop is on the rise or down, encountered reverse resistance, the desk will rebound.

■ Setting solution for desk function

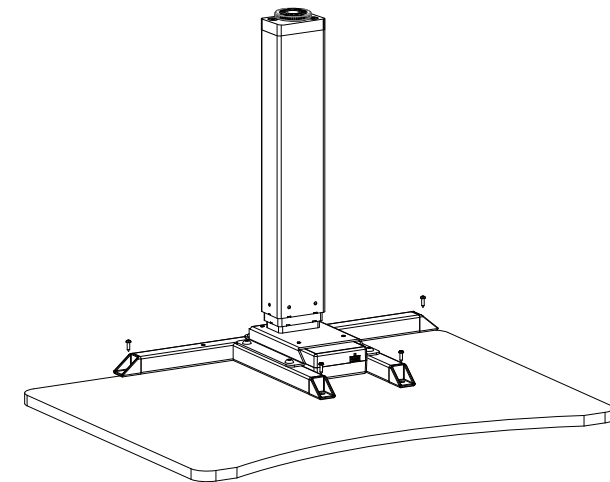
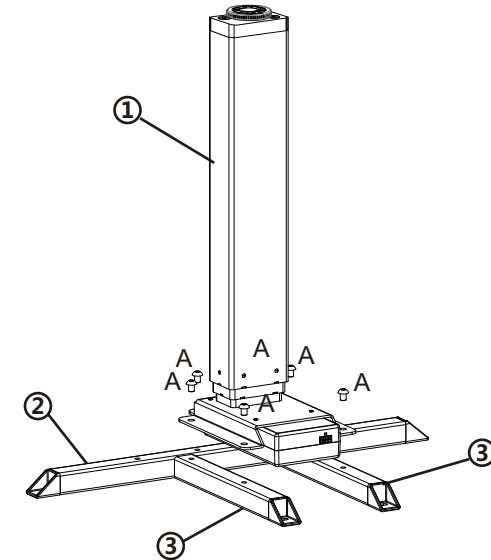
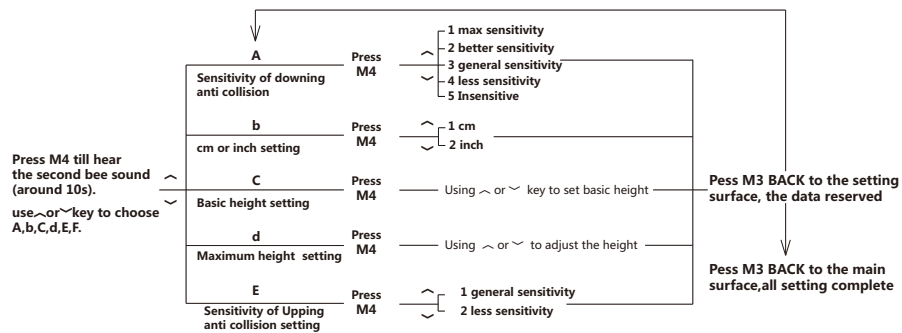

3 B(2pcs)
ST4.2x16mm

OR

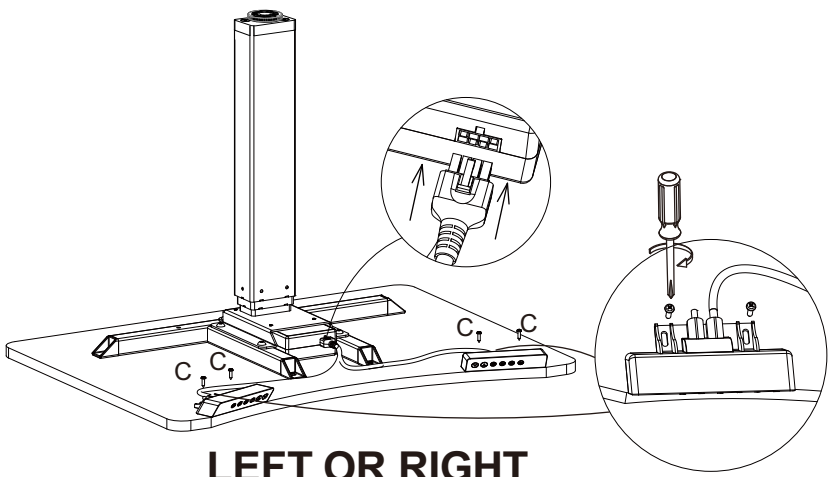
4 C (4pcs)
M6*10

D
M5

4 - 6

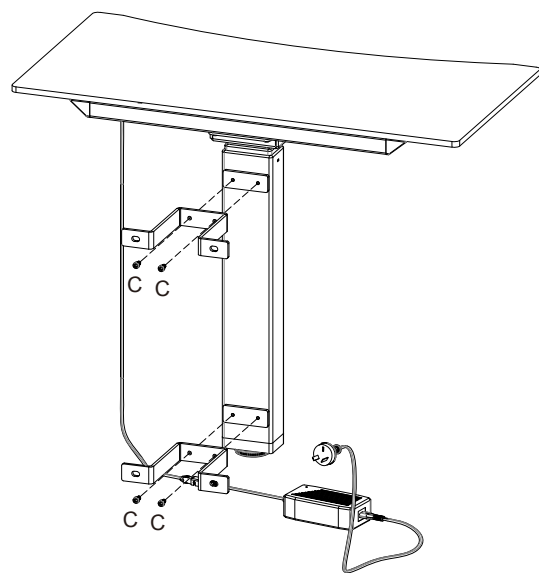
5

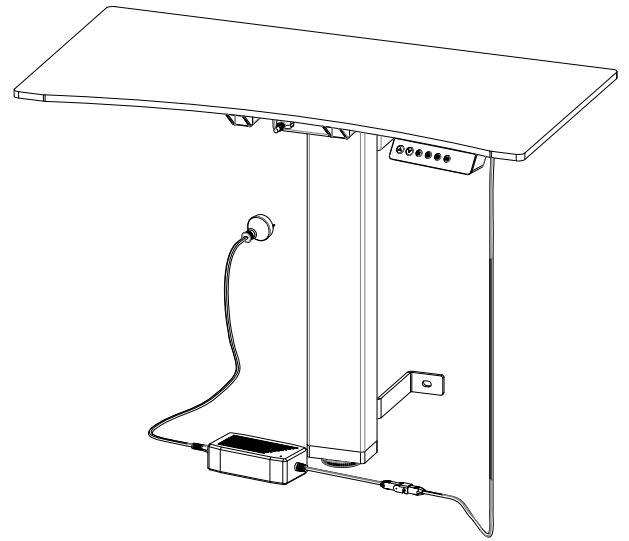

5 - 6